

SEE ENTRANCE DETAIL AND SCHEDULES FOR ADDITIONAL INFORMATION

THE TOP 1 1/2" OF HMA SHOULDERS SHALL BE PAVED MONOLITHICALLY WITH THE HMA SURFACE COURSE OF PAVEMENT.

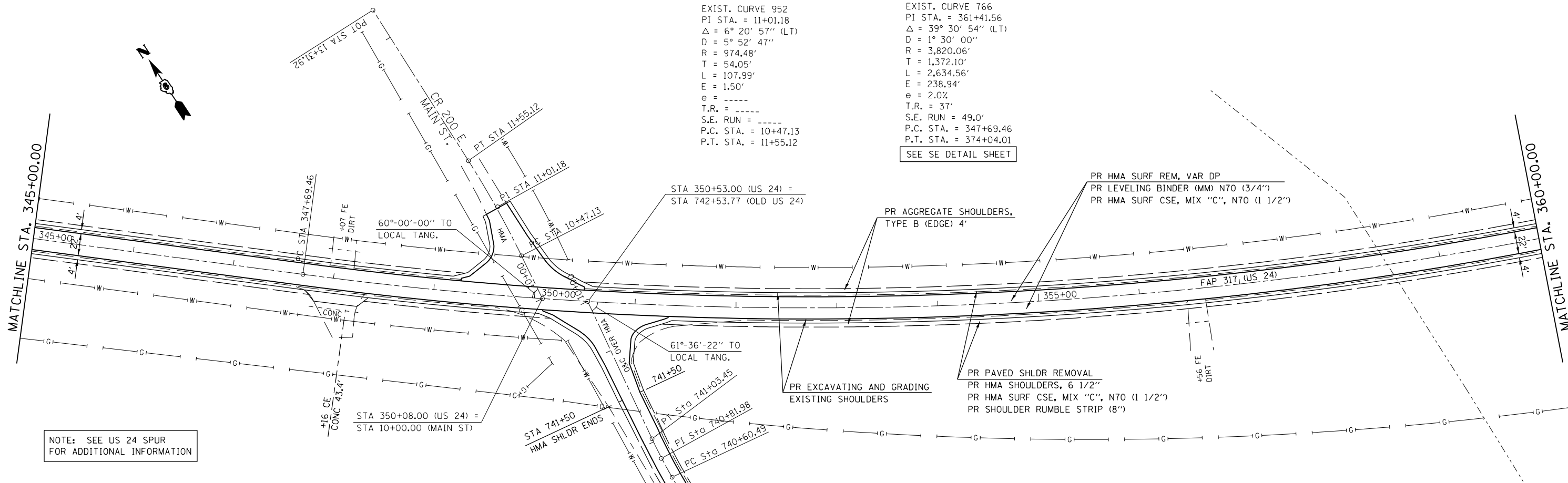

EXIST. CURVE 952  
 PI STA. = 11+01.18  
 $\Delta = 6^\circ 20' 57''$  (LT)  
 $D = 5^\circ 52' 47''$   
 $R = 974.48'$   
 $T = 54.05'$   
 $L = 107.99'$   
 $E = 1.50'$   
 $e = \text{-----}$   
 $T.R. = \text{-----}$   
 $S.E. \text{ RUN} = \text{-----}$   
 $P.C. \text{ STA.} = 10+47.13$   
 $P.T. \text{ STA.} = 11+55.12$

EXIST. CURVE 766  
 PI STA. = 361+41.56  
 $\Delta = 39^\circ 30' 54''$  (LT)  
 $D = 1^\circ 30' 00''$   
 $R = 3,820.06'$   
 $T = 1,372.10'$   
 $L = 2,634.56'$   
 $E = 238.94'$   
 $e = 2.0\%$   
 $T.R. = 37'$   
 $S.E. \text{ RUN} = 49.0'$   
 $P.C. \text{ STA.} = 347+69.46$   
 $P.T. \text{ STA.} = 374+04.01$

SEE SE DETAIL SHEET

NOTE: SEE US 24 SPUR FOR ADDITIONAL INFORMATION

FILE NAME =	USER NAME = sparksgw	DESIGNED -	REVISED -	<b>STATE OF ILLINOIS DEPARTMENT OF TRANSPORTATION</b>	<b>FAP 317 (US 24) PLAN SHEET 50 SCALE</b>			F.A.P. RTE.	SECTION	COUNTY	TOTAL SHEETS	SHEET NO.
ei:\pwwork\pwwork\sparksgw\10215228\0672884-sht-plan.dgn		DRAWN -	REVISED -		317	6RS-4	BROWN	23	16			
PLOT SCALE = 100.0000' / in.		CHECKED -	REVISED -		SCALE: 1"=50'			CONTRACT NO. 72884				
PLOT DATE = Feb-06-2012 03:00:05PM		DATE -	REVISED -		SHEET NO. OF SHEETS STA. TO STA.		ILLINOIS FED. AID PROJECT					