

**PLAN VIEW OF STRUCTURE
STA. 78+68.17**

ILLUSTRATION SHOWN DEPICTS BOTH
EAST & WEST SIDES OF STRUCTURE

⊕ SUGGESTED LOCATION FOR
PROPOSED GUARDRAIL POST

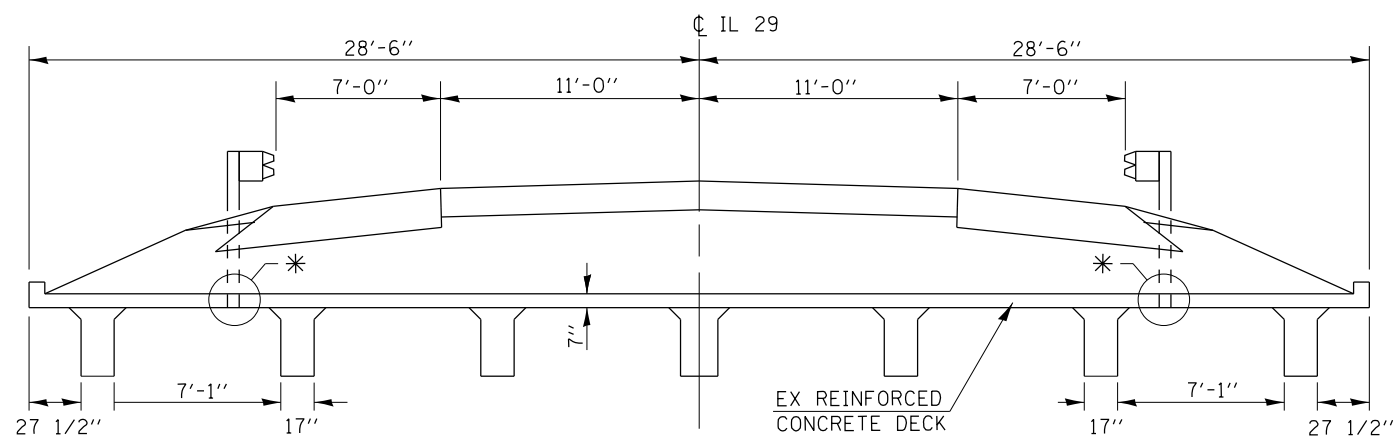

* — INSTALL PROPOSED GUARDRAIL POSTS
ACCORDING TO HIGHWAY STD. 630101-09

**CROSS SECTION OF STRUCTURE
STA. 78+68.17**

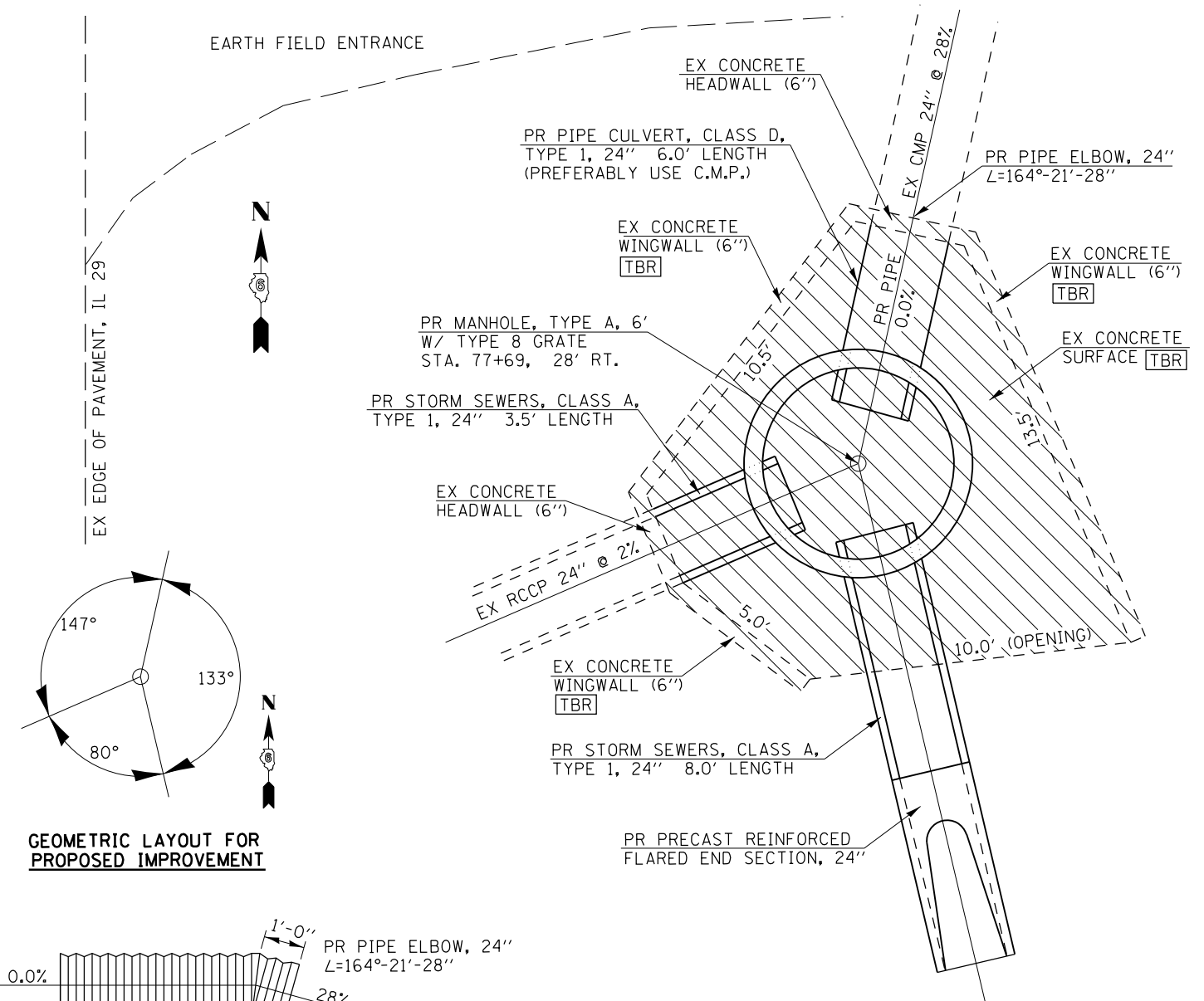

**GEOMETRIC LAYOUT FOR
PROPOSED IMPROVEMENT**

**PLAN VIEW FOR PROPOSED STORM SEWER WORK
STA. 77+69, RIGHT**

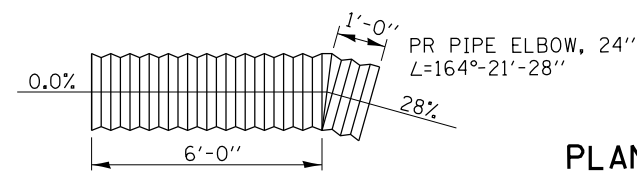

PROPOSED PIPE PROFILE

NOTE:
ALL EARTHWORK INVOLVED IN THE IMPROVEMENT AT THIS
LOCATION SHALL BE INCLUDED IN THE COST FOR THE ITEMS
INVOLVED.

BILL OF MATERIAL		
ITEM	UNIT	QUANTITY
CONCRETE REMOVAL	CU YD	4.9
PRECAST REINFORCED FLARED END SECTIONS, 24"	EACH	1
STORM SEWERS, CLASS A, TYPE 1, 24"	FOOT	11.5
PIPE CULVERTS, CLASS D, TYPE 1, 24"	FOOT	6.0
MANHOLES, TYPE A, 6'-DIAMETER, TYPE 8 GRATE	EACH	1
CONCRETE COLLAR	CU YD	0.9
PIPE ELBOW, 24"	EACH	1
SEEDING, CLASS 2	ACRE	.03

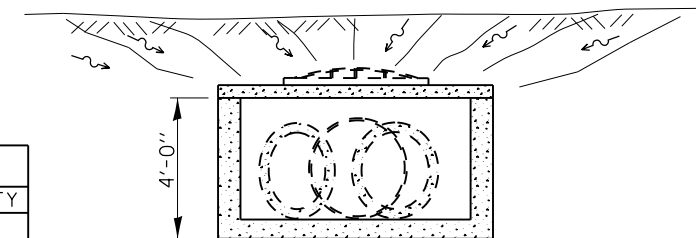

SECTIONAL VIEW FOR PROPOSED MANHOLE

PR MANHOLE, TYPE A, 6'
W/ TYPE 8 GRATE
STA. 77+69, 28' RT.

••(EIRS-4, (G)RS-6, I & (F)RS-3, I-1)
••MASON, MENARD

FILE NAME =	USER NAME = Slegliert	DESIGNED - RTS	REVISED -
c:\pwork\work\pwork\slg\slg\0283522\Tim's working file.dgn		DRAWN - RTS	REVISED -
	PLOT SCALE = 100.0000' / 1"	CHECKED -	REVISED -
	PLOT DATE = Mar-15-2012 08:57:23AM	DATE - 02-09-12	REVISED -

**STATE OF ILLINOIS
DEPARTMENT OF TRANSPORTATION**

**GUARDRAIL AT CULVERT DETAILS
STA. 78 + 68.17**

SCALE: SHEET 2 OF 2 SHEETS STA. TO STA.

F.A.P. RTE.	SECTION	COUNTY	TOTAL SHEETS	SHEET NO.
658	.	**	106	63
CONTRACT NO. 72F04				
ILLINOIS FED. AID PROJECT				