

- Notes:  
 ① For Sections A-A, B-B and View C-C, see sheet 20 of 53.  
 ② a16(E), a17(E) and a19(E) bar spacings measured along  $\phi$  Roadway.  
 ③ Tilt #9 b7(E) bars as required to maintain clearance.

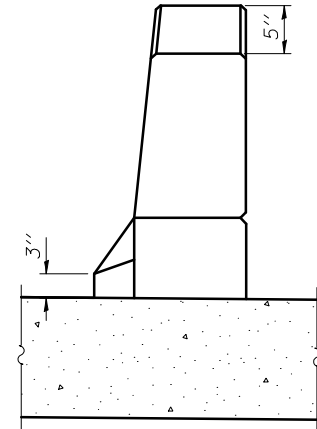
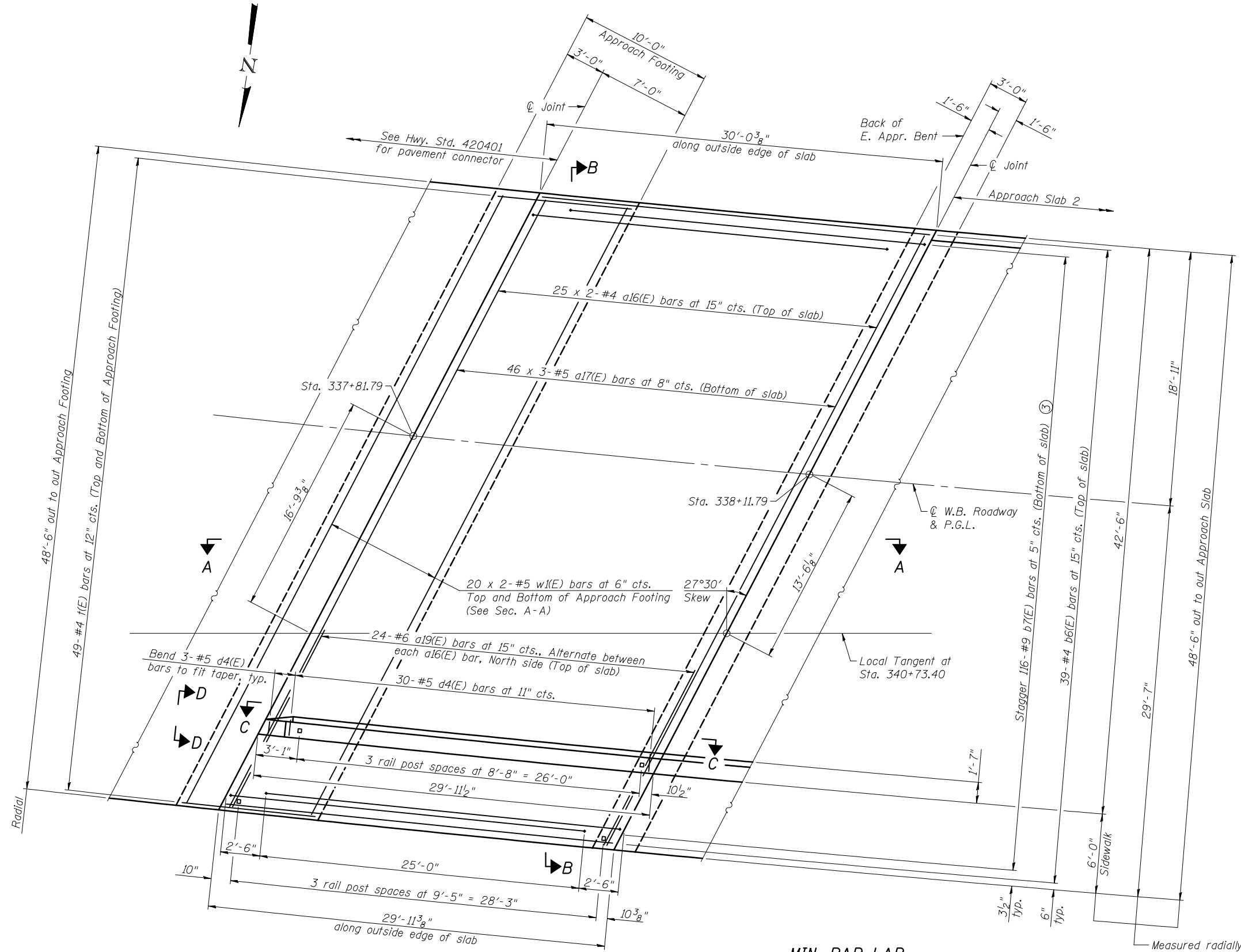

VIEW D-D

**MIN. BAR LAP**

- #4 bar = 2'-4"
- #5 bar = 2'-11"

PLAN

**HAUER ASSOCIATES**  
 Engineering + Architecture

11400  
 Eastport Business Center 1  
 100 Lamar Court, Suite 1  
 Columbia, IL 62234  
 Tel: 618.545.2200  
 Fax: 618.545.7200  
 www.hauerassociates.com

11400  
 Lakeside One Building  
 720 Olive, Suite 1000  
 St. Louis, MO 63101  
 Tel: 314.588.5281  
 Fax: 314.588.5905

USER NAME =	DESIGNED - MAG	REVISED -
	CHECKED - JAD	REVISED -
PLOT SCALE =	DRAWN - MAG	REVISED -
PLOT DATE =	CHECKED - JAD	REVISED -

**STATE OF ILLINOIS  
 DEPARTMENT OF TRANSPORTATION**

**BRIDGE APPROACH SLAB 1 DETAILS  
 STRUCTURE NO. 039-0076 (W.B.)**

SHEET NO. 18 OF 53 SHEETS

F.A.P. RTE.	SECTION	COUNTY	TOTAL SHEETS	SHEET NO.
331	(12-1)B-1	JACKSON	200	130
CONTRACT NO. 78056				

ILLINOIS FED. AID PROJECT