

DETAILS OF CONCRETE COLLAR

PIPE TO PIPE

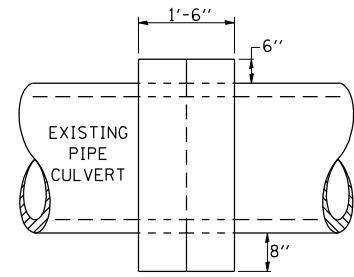

SIDE VIEW

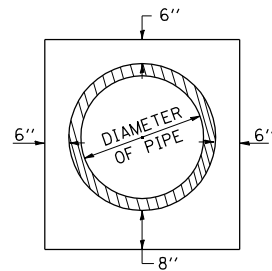

END VIEW

TABULATION

DIAMETER OF PIPE	CL SI CONC CU YDS EST
12"	0.24
15"	0.29
18"	0.32
24"	0.44
30"	0.56
36"	0.66
42"	0.80
48"	0.93
54"	1.07
60"	1.22
72"	1.55

THE CONCRETE COLLAR SHALL BE PAID FOR AT THE CONTRACT UNIT PRICE PER CUBIC YARD FOR **CONCRETE COLLAR**, AS SHOWN ON THE PLANS, WHICH PRICE SHALL INCLUDE THE REMOVAL OF SUCH PORTIONS THE EXISTING HEADWALLS AS MAY BE REQUIRED.

CLASS SI CONCRETE SHALL BE USED THROUGHOUT.

STD. 9-79

SEEDING & MULCHING

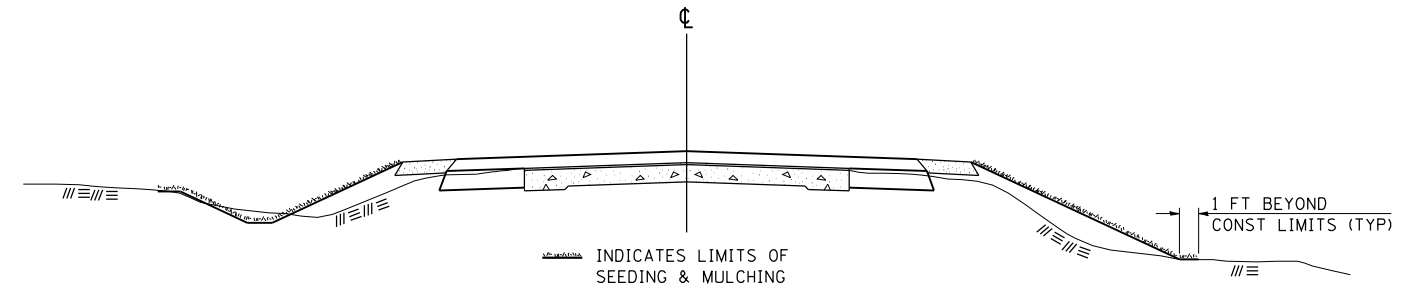

GENERAL NOTES

IN GENERAL, ALL EARTH SURFACES DISTURBED DURING CONSTRUCTION OPERATIONS SHALL BE SEEDED AND MULCHED UPON COMPLETION OF ALL GRADING OPERATIONS.

FERTILIZER NUTRIENTS AND LIMESTONE SHALL BE APPLIED TO ALL SEEDED AREAS.

THE RATES OF APPLICATION OF FERTILIZER, MULCH AND LIMESTONE SHALL BE AS SPECIFIED IN THE SPECIAL PROVISIONS.

SECTIONS 250 AND 251 OF THE STANDARD SPECIFICATIONS SHALL GOVERN THIS WORK EXCEPT AS SPECIFIED HEREIN OR AS NOTED IN THE SPECIAL PROVISIONS.

STD. 9-12

TYPICAL LIMITS OF POROUS GRANULAR EMBANKMENT AT 100-2023

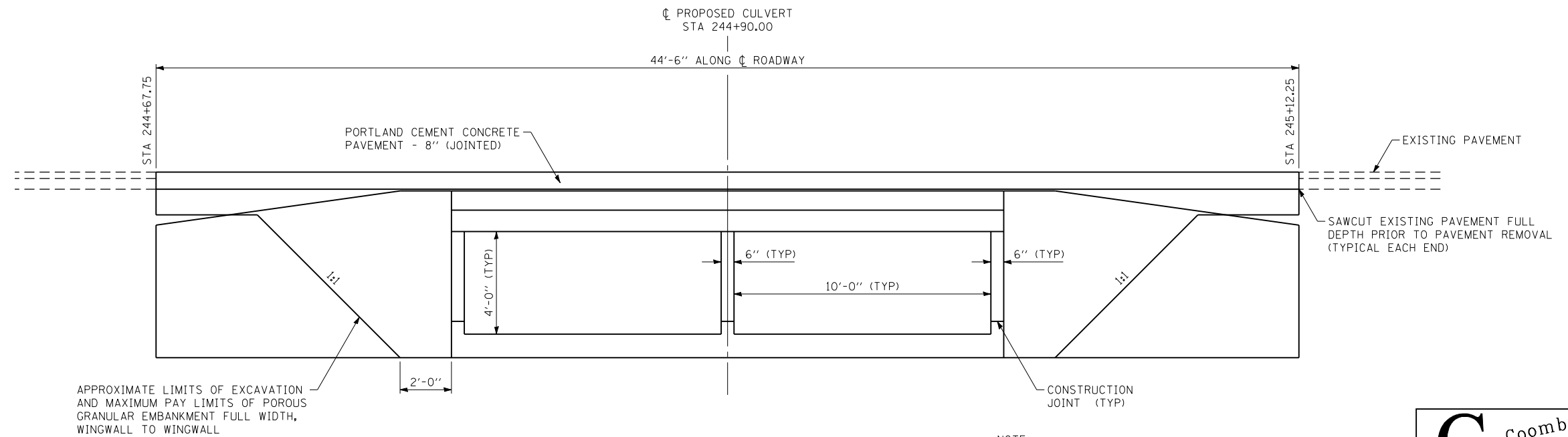

NOTE:
POROUS GRANULAR EMBANKMENT SHALL BE CA 7 OR CA 11 WITH THE TOP 1' CONSISTING OF CA 10

CB Coombe-Bloxdorf P.C.
- CIVIL ENGINEERS -
- STRUCTURAL ENGINEERS -
- LAND SURVEYORS -
Design Firm License No. 184-002703

FILE NAME =	USER NAME = CFC...	DESIGNED -	REVISED -
...\\d978090-sht-015-std-9-79.dgn		DRAWN -	REVISED -
CB PROJECT NO 08055-15	PLOT SCALE = 5.000000' / IN.	CHECKED - GLS	REVISED -
	PLOT DATE = 12/23/2011	DATE - / /	REVISED -

**STATE OF ILLINOIS
DEPARTMENT OF TRANSPORTATION**

**STANDARD 9-12 AND 9-79
TYPICAL LIMITS OF POROUS GRANULAR EMBANKMENT**

SCALE: SHEET NO. OF SHEETS STA. TO STA.

S.B.I.	SECTION	COUNTY	TOTAL SHEETS	SHEET NO.
13B	6B-1	WILLIAMSON	19	15
CONTRACT NO. 78090				
ILLINOIS FED. AID PROJECT				