

PROP. ALIGNMENT
 POT STA. = 4+27.98
 (Section Line)

Lorena M. Robinson, Trustee

PROP. CURVE CURVE1
 PI Sta. = 13+12.30 E = 20.02'
 $\Delta = 18^\circ 09' 51''$ (LT) $\theta = 4.02'$
 $D = 3^\circ 37' 58''$ T.R. = 35'
 $R = 1,577.20'$ S.E. RUN = 94'
 $T = 252.12'$ P.C. STA = 10+60.18
 $L = 500.01'$ P.T. STA = 15+60.19

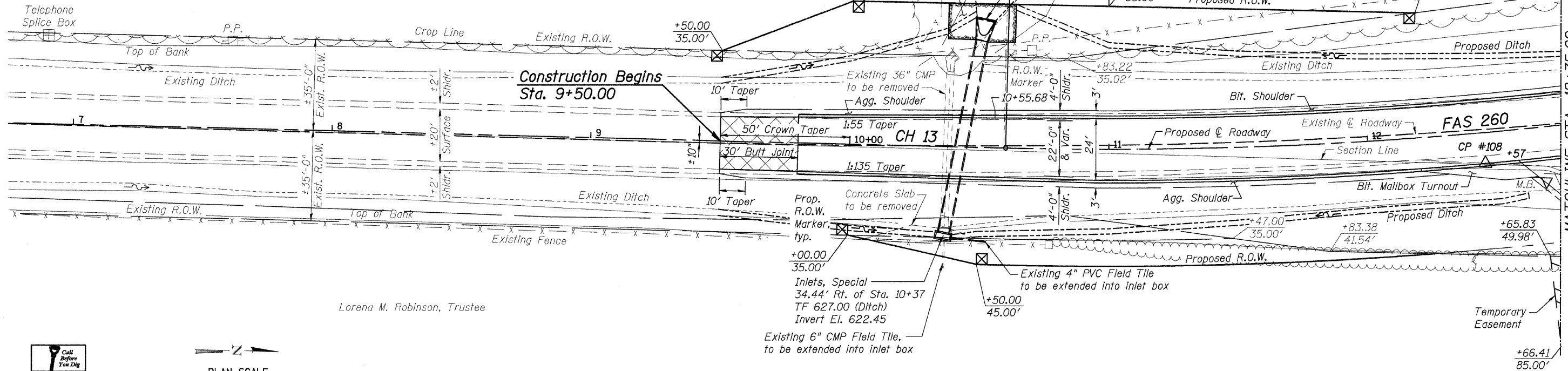

Lorena M. Robinson, Trustee

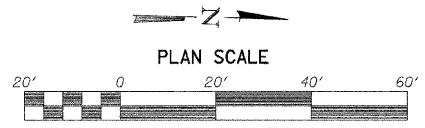

DATE	
BY	
REVISIONS	
NO.	
DATE	
BY	
REVISIONS	
NO.	
DATE	
BY	
REVISIONS	
NO.	

DATE	
BY	
REVISIONS	
NO.	
DATE	
BY	
REVISIONS	
NO.	
DATE	
BY	
REVISIONS	
NO.	

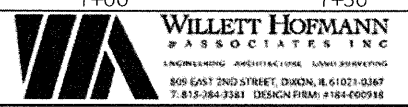
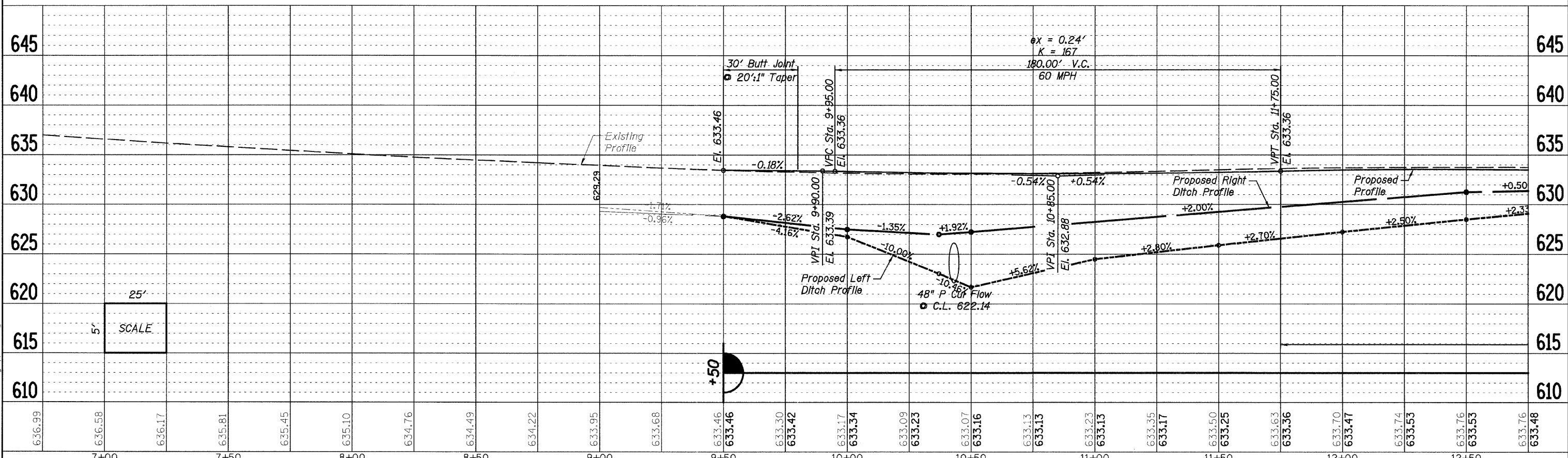

DESIGNED - B.S.K.	REVISED -
CHECKED - M.A.C.	REVISED -
DRAWN - R.D.A.	REVISED -
CHECKED - B.S.K.	REVISED -

LASALLE COUNTY
C.H. 13 OVER TOMAHAWK CREEK
STATION 20+00

PLAN & PROFILE
STRUCTURE NO. 050-3604
 SHEET NO. 1 OF 5 SHEETS STA. 6+75.00 TO STA. 12+75.00

F.A.S. RTE.	SECTION	COUNTY	TOTAL SHEETS	SHEET NO.
260	10-00651-00-BR	LASALLE	51	11
WHA* 1156D08	CONTRACT NO. 87466			
ILLINOIS FED. AID PROJECT BRS-0260105				