

DATE	
BY	
FINAL SURVEY	
SURVEYED	
PLOTTED	
TEMPLATE	
NOTE BOOK	
AREAS CHECKED	
NO.	

DATE	
BY	
ORIGINAL SURVEY	
SURVEYED	
PLOTTED	
TEMPLATE	
NOTE BOOK	
AREAS CHECKED	
NO.	

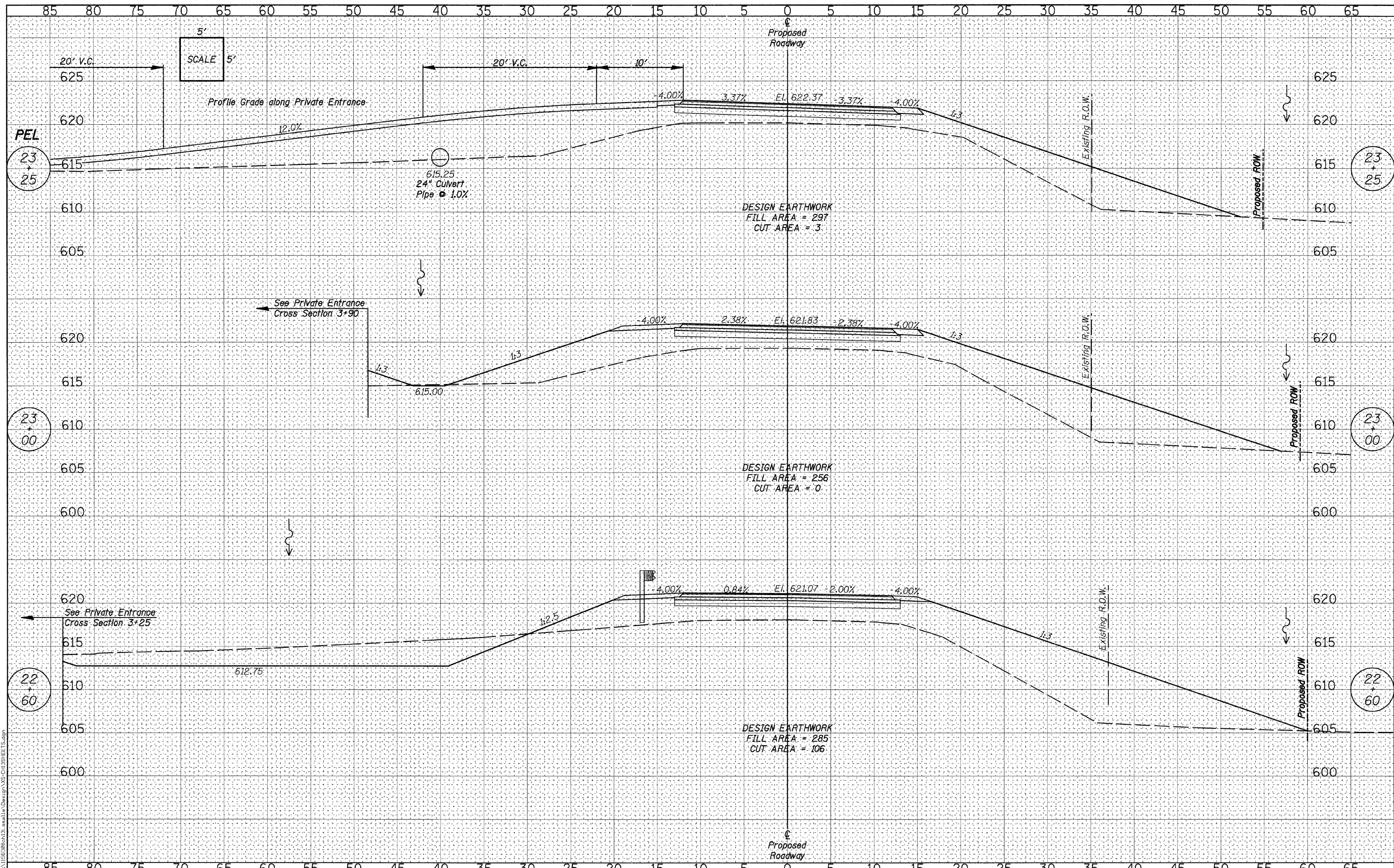

FILE = S:\Projects\1156108\ch13_0511a\Design\AS-CrossSection13.dgn

WILLET HOFMANN ASSOCIATES INC.
 ENGINEERING ARCHITECTURE LAND SURVEYING
 809 EAST 2ND STREET, DUNON, IL 61023-0457
 T. 815-284-3381 DESIGN FIRM #184-060218

DESIGNED	- J.M.K.	REVISED	-
CHECKED	- G.F.S.	REVISED	-
DRAWN	- J.M.K.	REVISED	-
CHECKED	- G.F.S.	REVISED	-

LASALLE COUNTY
C.H. 13 OVER TOMAHAWK CREEK
STATION 20+00

CROSS SECTIONS - C.H. 13	
STRUCTURE NO. 050-3604	
SHEET NO. 9 OF 13 SHEETS	STA. 22+60 TO STA. 23+25

F.A.S. RTE.	SECTION	COUNTY	TOTAL SHEETS	SHEET NO.
260	10-00651-00-BR	LASALLE	51	44
WHA* 1156D08		CONTRACT NO. 87466		
ILLINOIS FED. AID PROJECT BRS-0260105				