

FINAL SURVEY	REVISIONS	BY	DATE
NOTE BOOK	PLOTTED		
NO.	TEMPLATE		
	AREAS		
	CHECKED		

ORIGINAL SURVEY	REVISIONS	BY	DATE
NOTE BOOK	PLOTTED		
NO.	TEMPLATE		
	AREAS		
	CHECKED		

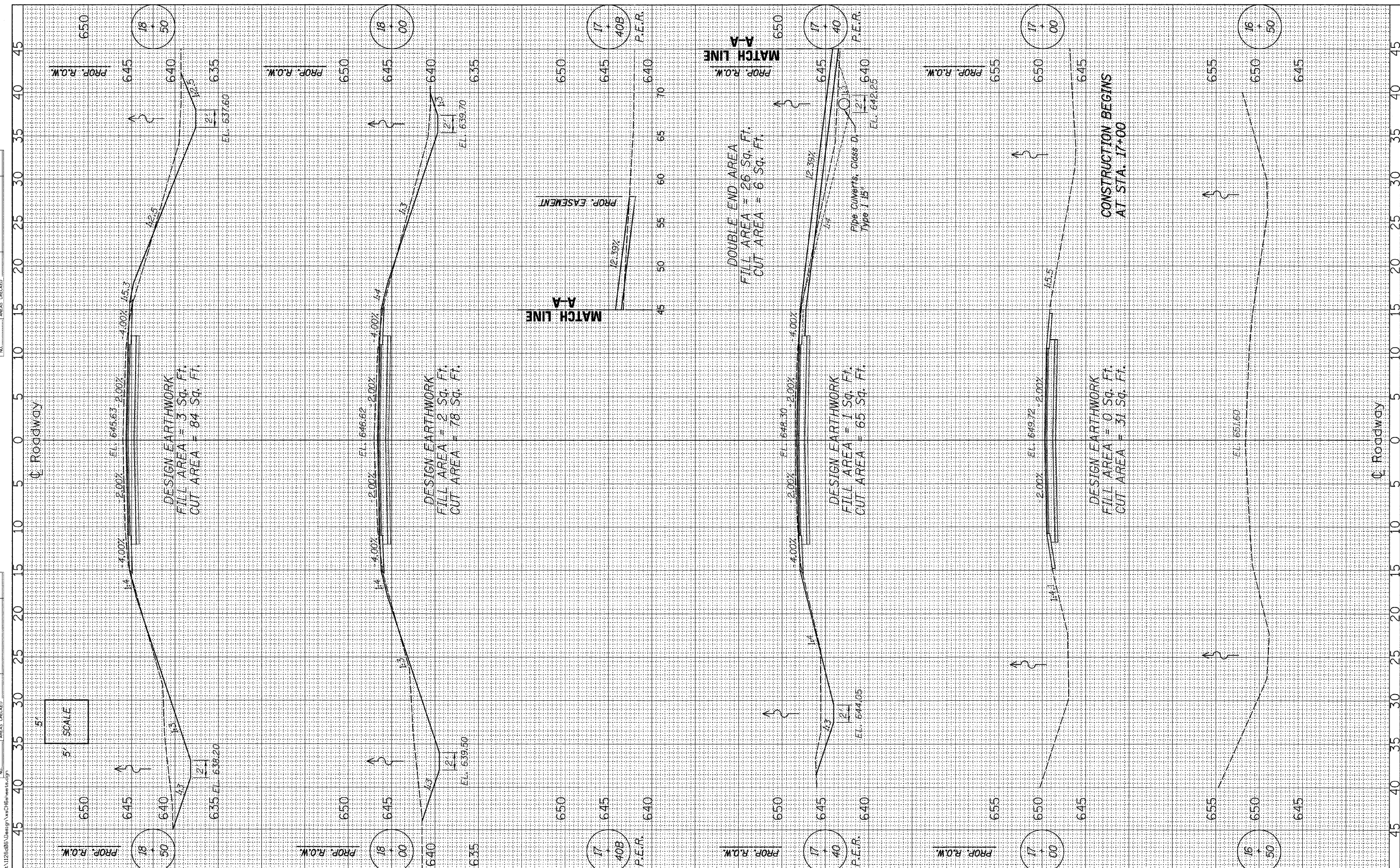

**WILLETT HOFMANN ASSOCIATES INC.**  
 ENGINEERING ARCHITECTURE LAND SURVEYING  
 839 EAST 2ND STREET, OAKTON, IL 61021-6367  
 T: 815-294-3381 DESIGN FIRM: #164-000918

DESIGNED -	MICHAEL WAGNER	REVISED -	
DRAWN -	RON ALLEN	REVISED -	
CHECKED -	BRIAN CONVERSE	REVISED -	
DATE -	AUGUST 2011	REVISED -	

**MERCER COUNTY**  
**F.A.S. 217 (C.H. 6) OVER MAIDS RUN**  
**STATION 20+05**

<b>CROSS SECTIONS</b>		
<b>STRUCTURE NO. 066-3031</b>		
SCALE: 1" = 5'	SHEET NO. 1 OF 3 SHEETS	STA. 16+50.00 TO STA. 18+50.00

F.A.S. RTE.	SECTION	COUNTY	TOTAL SHEETS	SHEET NO.
217	05-00096-00-BR	MERCER	21	18
WHA* 1128D06		CONTRACT NO. 89432		
ILLINOIS FED. AID PROJECT BRS-021102				