

CO. HWY.#	SECTION	COUNTY	TOTAL SHEETS	SHEET NO.
21	11-00041-03-RS	McLEAN	8	1

INDEX OF SHEETS

- 1. Cover Sheet
- 2-3. Typical Cross Sections
- 4-6. Plan View Sheets
- 7. Typical Details
- 8. Intersection Detail

STATE STANDARD DETAILS

- 606001-04 CONCRETE CURB TYPE B AND COMBINATION CONCRETE CURB AND GUTTER
- 701001-02 OFF-RD OPERATIONS, 2L, 2W, MORE THAN 15' AWAY
- 701006-03 OFF-RD OPERATIONS, 2L, 2W, 15' TO 24" FROM PAVEMENT EDGE
- 701011-02 OFF-RD MOVING OPERATIONS, 2L, 2W, DAY ONLY
- 701201-04 LANE CLOSURE, 2L, 2W, DAY ONLY, FOR SPEEDS ≥ 45 MPH
- 701301-04 LANE CLOSURE, 2L, 2W, SHORT TIME OPERATIONS
- 701306-03 LANE CLOSURE, 2L, 2W, SLOW MOVING OPERATIONS DAY ONLY, FOR SPEEDS ≥ 45 MPH
- 701326-04 LANE CLOSURE, 2L, 2W, PAVEMENT WIDENING, FOR SPEEDS ≥ 45 MPH
- 701901-02 TRAFFIC CONTROL DEVICES
- 781001-03 TYPICAL APPLICATIONS RAISED REFLECTIVE PAVEMENT MARKERS
- B.L.R. 23-4 TRAFFIC BARRIER TERMINAL TYPE 1
- B.L.R. 26-3 STEEL PLATE BEAM GUARDRAIL 29" HEIGHT

SUMMARY OF QUANTITIES

ITEM NUMBER	ITEM	UNIT	QUANTITY
35501308	HOT-MIX ASPHALT BASE COURSE, 6"	SQ YD	444
40600100	BITUMINOUS MATERIALS (PRIME COAT)	GAL	3,000
40600300	AGGREGATE (PRIME COAT)	TON	75
40600625	LEVELING BINDER (MACHINE METHOD), N50	TON	1,125
40600982	HMA SURFACE REMOVAL - BUTT JOINT	SQ YD	1,037
40600990	TEMPORARY RAMP	SQ YD	34
40603080	HMA BINDER COURSE, IL-19.0, N50	TON	3,000
40603310	HMA SURFACE COURSE, MIX "C", N50	TON	2,200
40800010	BITUMINOUS MATERIALS (PRIME COAT)	GAL	115
40800030	AGGREGATE (PRIME COAT)	TON	3
40800050	INCIDENTAL HOT-MIX ASPHALT SURFACING	TON	115
44300100	AREA REFL CRACK CNTRL TREATMENT, SYSTEM A	SQ YD	29,150
48101200	AGGREGATE SHOULDERS, TYPE B	TON	2,650
60609800	COMB. CONCRETE CURB & GUTTER, TYPE M-6.18	Foot	300
* 63000001	SPBGR, TYPE A, 6' POSTS	Foot	37.5
* X6330227	VERT. ADJ. OF TRAFF. BARRIER TERM, TYPE 1	EACH	2
67100100	MOBILIZATION	L.S.	1
X7010216	TRAFFIC CONTROL & PROTECTION (SPECIAL)	L.S.	1
* 78100100	RAISED REFLECTIVE PAVEMENT MARKER	EACH	157
* LR631020	TRAFFIC BARRIER TERMINAL, TYPE 1	EACH	2
* Z0000200	ADJUST EXISTING GUARD RAIL	Foot	450

* SPECIALTY ITEMS

UTILITIES CORN BELT & FRONTIER

THESE PLANS ARE NOT TO SCALE

J.U.L.I.E.
JOINT UTILITY LOCATION INFORMATION FOR EXCAVATION
1-800-892-0123

CONTRACT NO. 91466

STATE OF ILLINOIS
DEPARTMENT OF TRANSPORTATION
DIVISION OF HIGHWAYS

**PROPOSED
HIGHWAY PLANS**

McLEAN COUNTY F.A.S. ROUTE 489
SEC: 11-00041-03-RS
PROJECT: RS-0489(108)
LEROY-LEXINGTON RD (CH 21)
RESURFACE
JOB NO: C-95-312-12
FUNDING: STR FUNDS

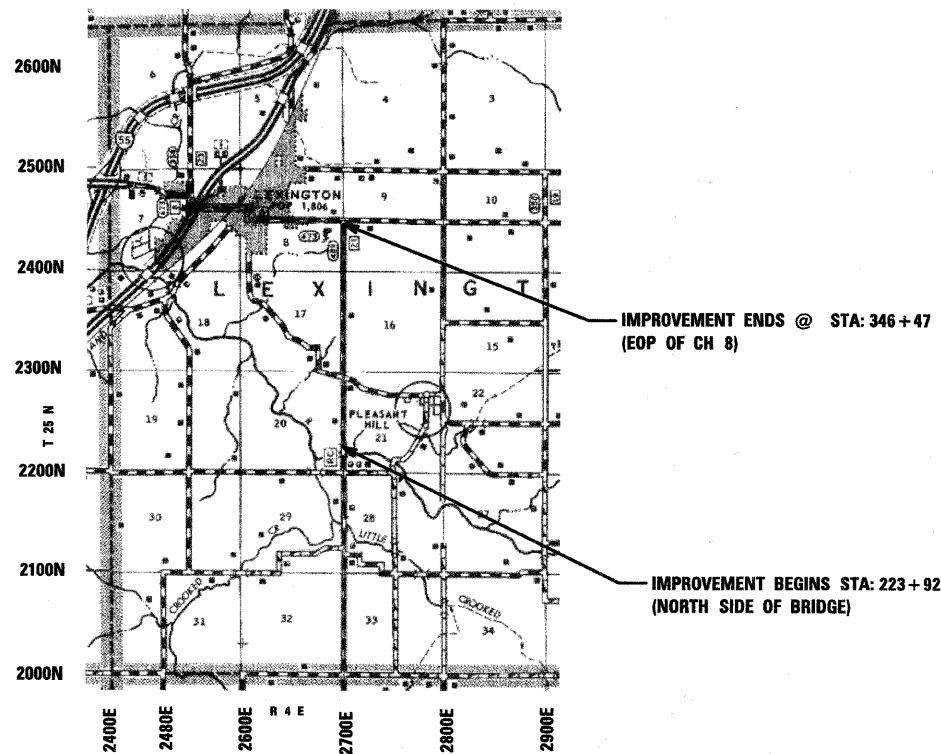

NOTE: THE TOTAL LENGTH OF THE PROPOSED PROJECT IS 12,255 FEET WITH A NET LENGTH OF 12,255 FEET (2.32 MILES)

NOTE: THESE PLANS MEET THE MINIMUM REQUIREMENTS FOR A 3R IMPROVEMENT.

NOTE: CURRENT ADT: 610
FUNCTIONAL CLASSIFICATION: MAJOR COLLECTOR



ILLINOIS PROFESSIONAL ENGINEER #57636
EXPIRES 11-30-13

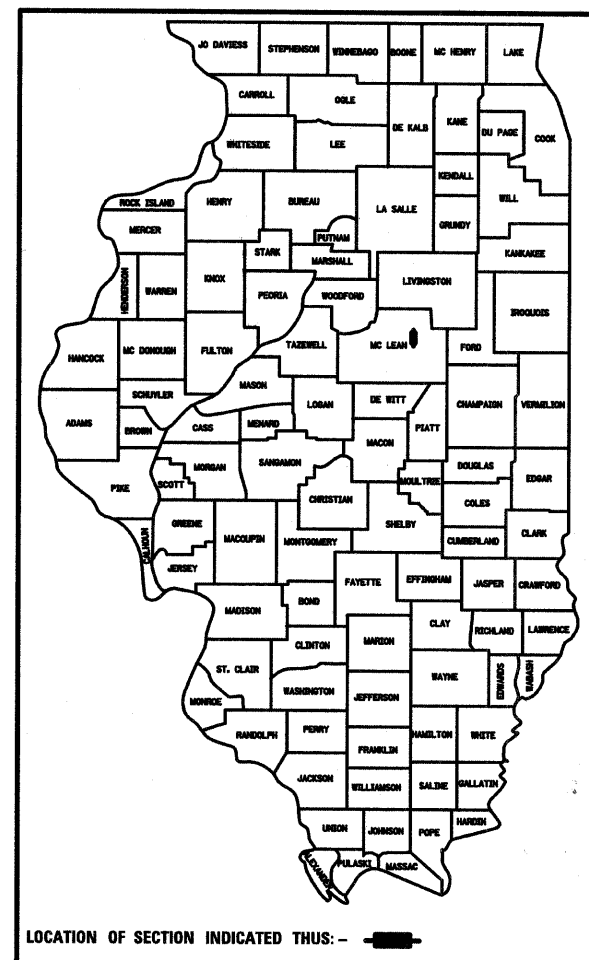

STATE OF ILLINOIS
DEPARTMENT OF TRANSPORTATION
DIVISION OF HIGHWAY

Approved 1/6/2012
E. J. [Signature]
County Engineer

Passed January 23, 2012
[Signature]
District Five Engineer of
Local Roads & Streets

Releasing For
Bid Based on
Limited Review
JANUARY 25, 2012
[Signature]
Deputy Director of Highways,
Region Three Engineer

**PRINTED BY THE AUTHORITY
OF THE STATE OF ILLINOIS**