

SECTION 8, T.12N., R.10W., 2nd P.M.

F.A.S.	SECTION	COUNTY	TOTAL SHEETS	SHEET NO.
680	10-00101-00-SP	EDGAR	132	24

EDGAR COUNTY, ILLINOIS CONTRACT NO. 91467

PROPOSED ϕ CURVE DATA
 PI STA. = 115+84.21
 Δ = 56° 54' 26" (RT)
 D = 6° 49' 09"
 R = 840.23'
 T = 455.33'
 L = 834.53'
 E = 115.44'
 e = 0.08 FT/FT
 T.R. = 36'
 S.E. RUN = 176'
 P.C. STA. = 111+28.89
 P.T. STA. = 119+63.42
 S.E. ATTAINED:
 STATION 109+68.30 TO STATION 111+80.30
 STATION 119+11.17 TO STATION 121+23.17

EXIST. ϕ CURVE DATA
 PI STA. = 133+58.44
 Δ = 6° 20' 09" (LT)
 D = 0° 30' 25"
 R = 11,300.00'
 T = 625.42'
 L = 1,249.57'
 E = 17.29'
 P.C. STA. = 127+33.01
 P.T. STA. = 139+82.58

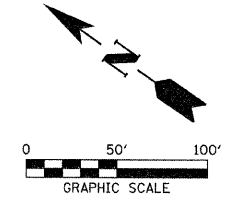

WILLIAM C McCLAIN

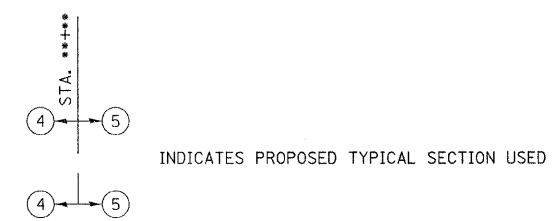
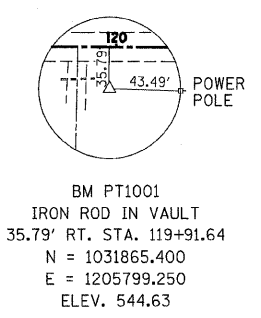
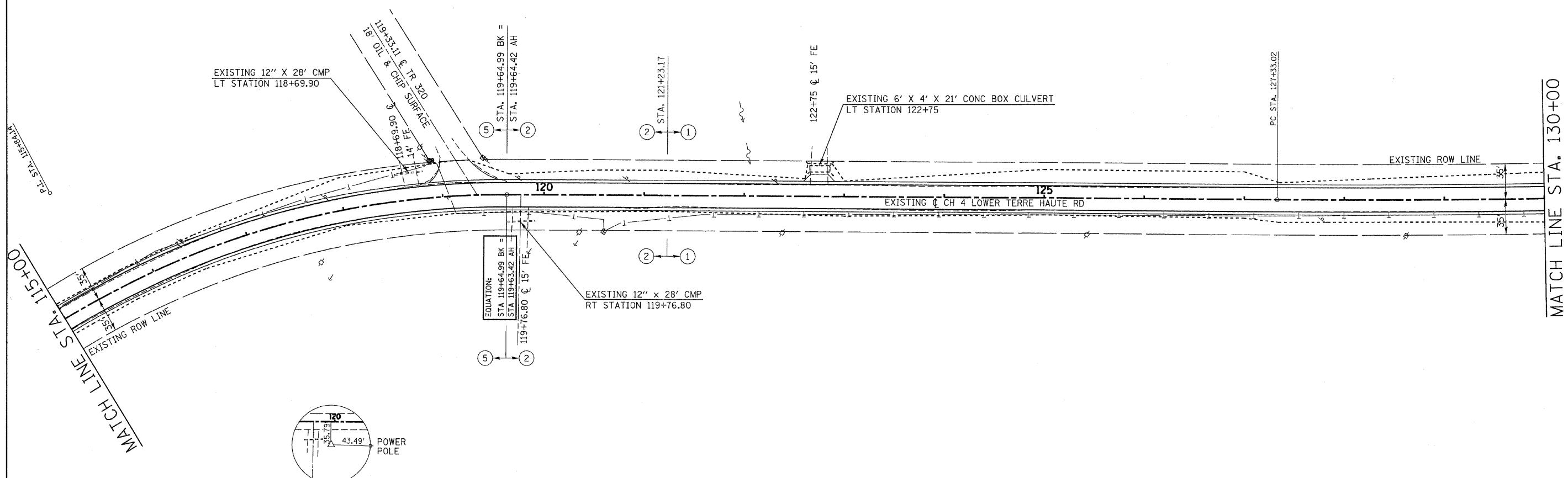

FILE NAME = 118338-ah-hw-plans.dgn
 PLOT DATE = 1/19/2012
 SCALE: 1" = 50'



SECTION 8, T.12N., R.10W., 2nd P.M.