

**SECTION 17, T.12N., R.10W., 2nd P.M.**

**SECTION 16, T.12N., R.10W., 2nd P.M.**

F.A.S.	SECTION	COUNTY	TOTAL SHEETS	SHEET NO.
680	10-00101-00-SP	EDGAR	132	28
EDGAR COUNTY, ILLINOIS		CONTRACT NO. 91467		

EXIST.  $\odot$  CURVE DATA  
 PI STA. = 175+79.98  
 $\Delta$  = 21° 29' 31" (RT)  
 D = 4° 51' 58"  
 R = 1,177.43'  
 T = 223.46'  
 L = 441.66'  
 E = 21.02'  
 $e$  = 0.08 FT/FT  
 T.R. = 38.30'  
 S.E. RUN = 187'  
 P.C. STA. = 173+56.53  
 P.T. STA. = 177+98.19  
S.E. ATTAINED:  
 STATION 172+32.77 TO STATION 174+58.07  
 STATION 177+41.87 TO STATION 179+67.16

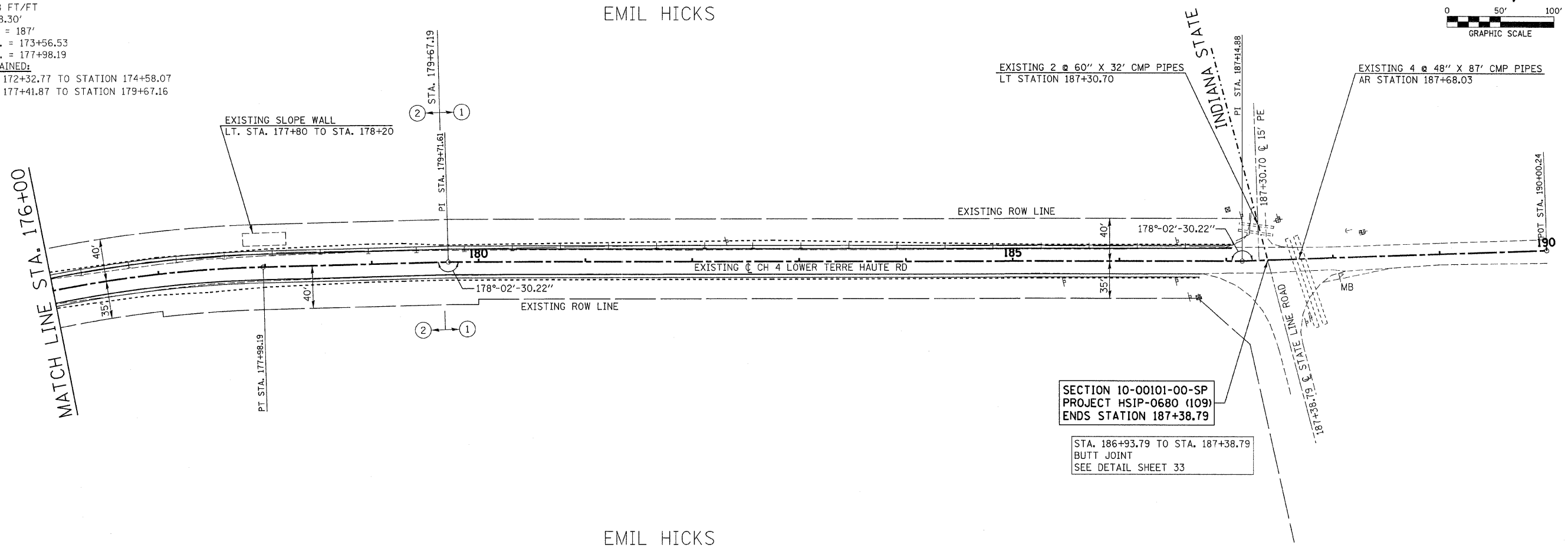
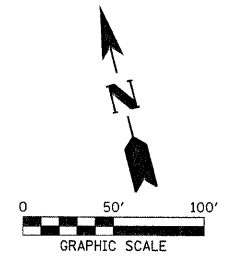

SECTION 10-00101-00-SP  
 PROJECT HSIP-0680 (109)  
 ENDS STATION 187+38.79

STA. 186+93.79 TO STA. 187+38.79  
 BUTT JOINT  
 SEE DETAIL SHEET 33

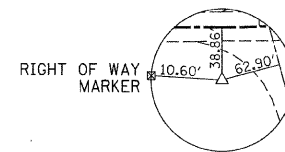

BM PT1003  
 IRON ROD  
 38.86' RT. STA. 186+83.44  
 N = 1027821.879  
 E = 1210430.035  
 ELEV. 509.56

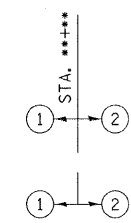

INDICATES PROPOSED TYPICAL SECTION USED

**SECTION 17, T.12N., R.10W., 2nd P.M.**

**SECTION 16, T.12N., R.10W., 2nd P.M.**