



LEG 1

EROSION CONTROL LEGEND

-  DITCH CHECK
-  INLET AND PIPE PROTECTION
-  PERIMETER EROSION CONTROL BARRIER

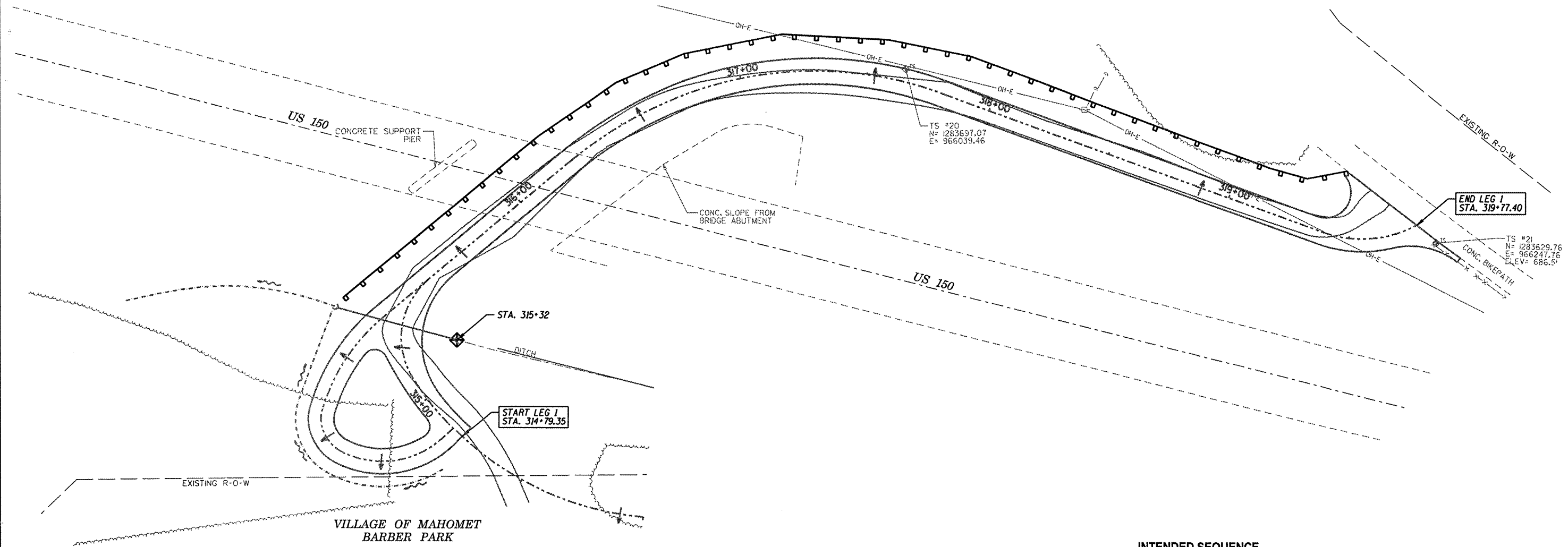
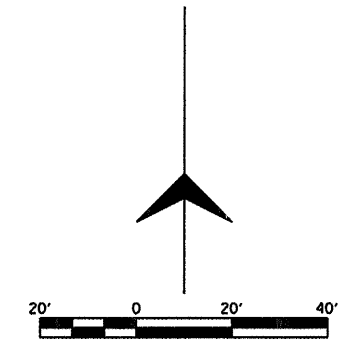

DESCRIPTION	DATE	REVISION

PROJECT TITLE: VILLAGE OF MAHOMET & CC FOREST PRESERVE
 LAKE OF THE WOODS ROAD
 MULTI-PURPOSE PATHWAY
 SHEET TITLE: EROSION CONTROL SHEET - BARBER PARK



Sodemann and Associates, Inc.
 501 WEST 53RD STREET
 POST OFFICE BOX 53
 CHAMPAIGN, ILLINOIS 61824-0557
 TEL 217 352-7688 FAX 217 352-7922
 ENGINEERING / ANALYSIS / MANAGEMENT

DES. CMO	DRN. MSJ	CHK. EBH	APP. SRS
PROJECT NO. 1009			
DATE 12-12-2011			
SHEET			
20			
OF 61 SHEETS			

INTENDED SEQUENCE

1. PLACEMENT OF PERIMETER EROSION CONTROL BARRIER PRIOR TO THE COMMENCEMENT OF ANY WORK. SEE STANDARD 280001
2. PLACE INLET AND PIPE PROTECTION AS STORM SEWERS AND CULVERTS ARE CONSTRUCTED. PLACE DITCH CHECKS AS SOON AS GRADING IS COMPLETED.
3. ALL EROSION CONTROL DEVICES SHALL BE INSPECTED WEEKLY TO ENSURE THEY ARE WORKING PROPERLY. ANY REPAIRS REQUIRED SHALL BE DONE SO IMMEDIATELY.
4. SEEDING SHALL BE DONE AS SOON AS POSSIBLE WHEN FINAL GRADING IS COMPLETE. SPECIAL ATTENTION IS CALLED TO ARTICLE 250.07 REGARDING SEEDING DATES.
5. ALL TEMPORARY EROSION CONTROL DEVICES SHALL BE REMOVED AT THE COMPLETION OF THE PROJECT WHEN PERMANENT VEGETATION HAS BEEN ESTABLISHED.