

COUNTY	ROUTE	SECTION	SHT. NO.
ADAMS	FAS 1800	08-00211-01-SC	12/2
LT. STA. 178+50 TO STA. 177+00			

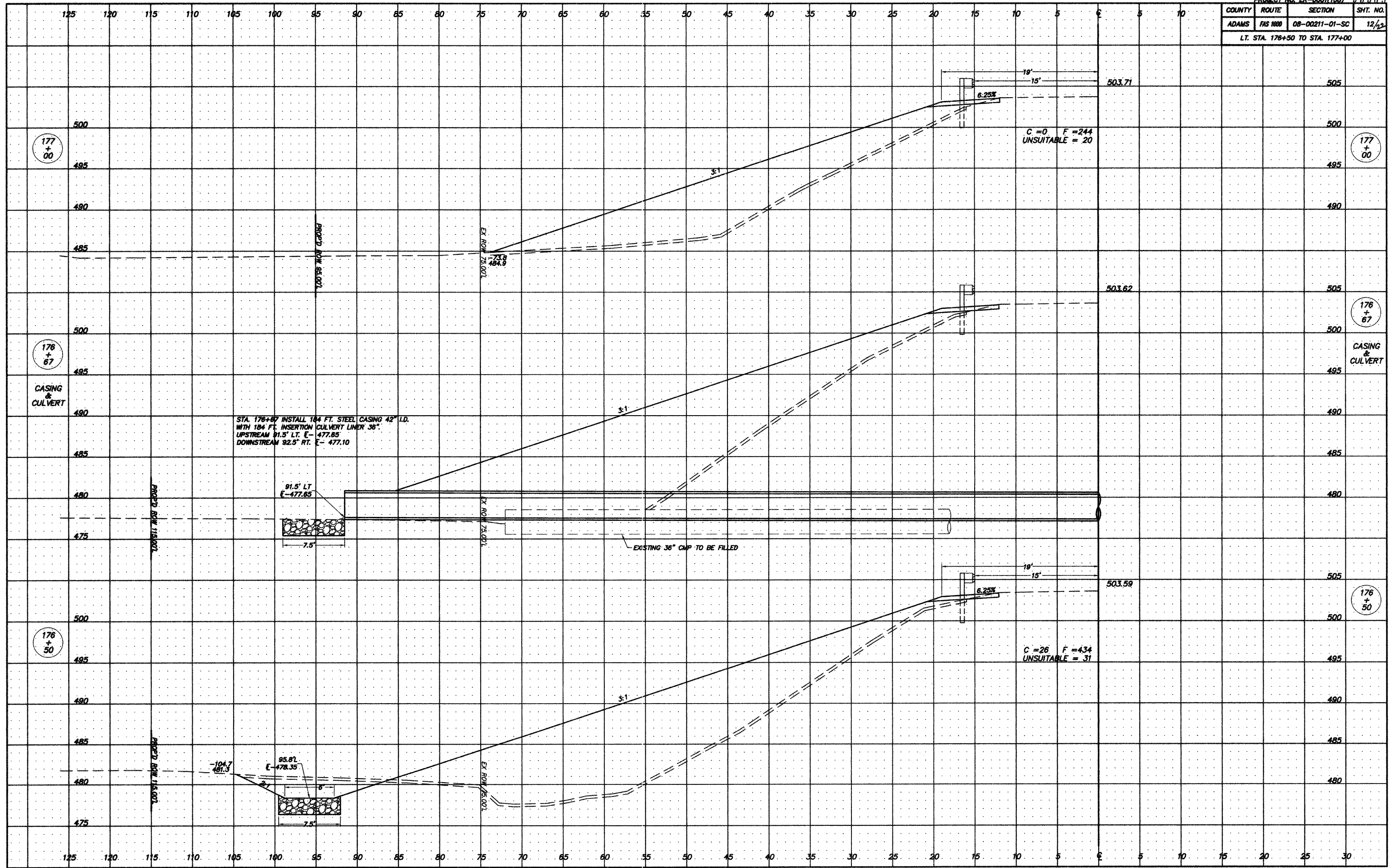

STA. 178+67 INSTALL 184 FT. STEEL CASING 42" I.D. WITH 184 FT. INSERTION CULVERT LINER 36" UPSTREAM 91.5' LT. E- 477.85 DOWNSTREAM 92.5' RT. E- 477.10

C=0 F=244 UNSUITABLE=20

C=26 F=434 UNSUITABLE=31

EXISTING 36" CMP TO BE FILLED

177+00

177+00

176+67

176+67

176+50

176+50

CASING & CULVERT

CASING & CULVERT