

COUNTY	ROUTE	SECTION	SHT. NO.
ADAMS	FAS 1800	08-00211-01-SC	19/2

RT. STA. 176+00 TO STA. 176+67

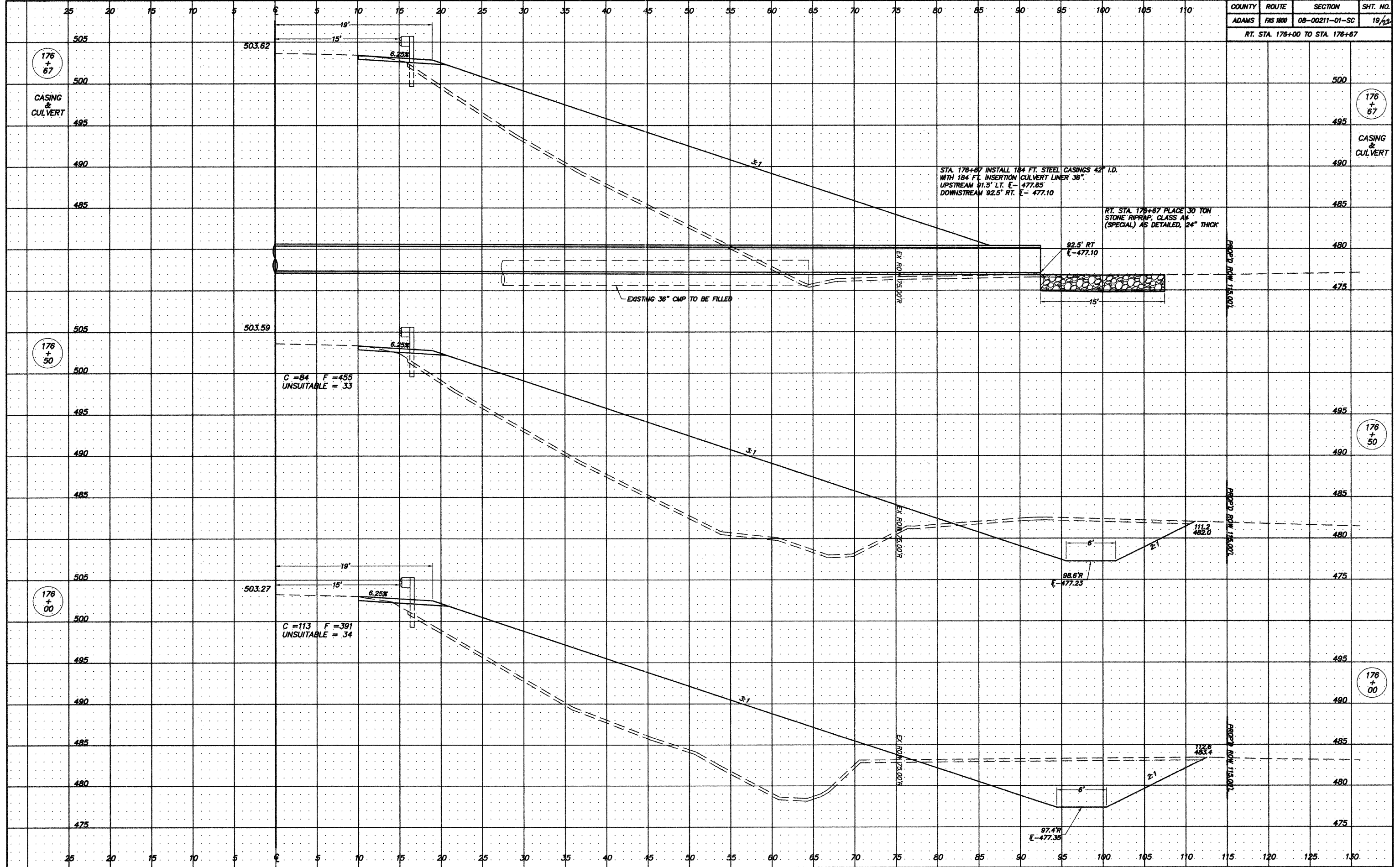

176 + 67

CASING & CULVERT

176 + 67

CASING & CULVERT

STA. 176+67 INSTALL 104 FT. STEEL CASINGS 42" I.D. WITH 104 FT. INSERTION CULVERT LINER 36". UPSTREAM 91.5' LT. E- 477.85 DOWNSTREAM 92.5' RT. E- 477.10

RT. STA. 176+67 PLACE 30 TON STONE RIPRAP, CLASS AA (SPECIAL) AS DETAILED, 24" THICK

EXISTING 36" CMP TO BE FILLED

176 + 50

C = 84 F = 455
UNSUITABLE = 33

176 + 50

176 + 00

C = 113 F = 391
UNSUITABLE = 34

176 + 00