

FOR UTILITY LOCATION PURPOSES, THIS PROJECT IS LOCATED IN SW. QUARTER OF SECTION 16, TOWNSHIP 5 NORTH, RANGE 9 WEST OF THE THIRD PRINCIPAL MERIDIAN.

UTILITY INFORMATION CAN BE OBTAINED BY CALLING J.U.L.I.E. AT (800) 892-0123

THE FOLLOWING UTILITY COMPANIES HAVE FACILITIES WITHIN THE LIMITS OF THIS PROJECT:

AMEREN IP  
2600 N. CENTER STREET  
MARYVILLE, ILLINOIS 62062  
(618) 346-1273 (GAS)

AMERITECH  
203 GOETHE  
COLLINSVILLE, ILLINOIS 62234  
(618) 346-6400

AMEREN UE  
700 OAKWOOD AVENUE  
ALTON, ILLINOIS 62002  
(618) 463-4051 (ELECTRIC)

VILLAGE OF EAST ALTON STREET DEPT.  
119 WEST MAIN  
EAST ALTON, ILLINOIS 62024  
(618) 259-7522

CHARTER COMMUNICATIONS  
508 NIAGRA AVENUE  
EAST ALTON, ILLINOIS 62024  
(618) 251-2660

VILLAGE OF EAST ALTON WATER DEPT.  
119 WEST MAIN  
EAST ALTON, ILLINOIS 62024  
(618) 259-4646

OLIN CORPORATION  
427 N. SHAMROCK  
EAST ALTON, ILLINOIS 62024  
(618) 258-2000 (GAS & WATER)

VILLAGE OF EAST ALTON SEWER DEPT.  
119 WEST MAIN  
EAST ALTON, ILLINOIS 62024  
(618) 254-2728

04-27-12 LETTING ITEM 192

STATE OF ILLINOIS

DEPARTMENT OF TRANSPORTATION

DIVISION OF HIGHWAYS

FEDERAL AID HIGHWAY

MAIN STREET - PHASE 2

SECTION-08-00045-00-PV

FAU ROUTE 8967

PROJECT M-5011 (306)

VILLAGE OF EAST ALTON, ILLINOIS

MADISON COUNTY

JOB C-98-334-10

SECTION	COUNTY	TOTAL SHEETS	SHEET NO.
*	MADISON	17	1

FEDERAL AID PROJECT

\* 08-00045-00-PV

CONTRACT NO. 97472

INDEX TO SHEETS

1. COVER SHEET
2. GENERAL NOTES AND LEGENDS
3. SUMMARY OF QUANTITIES, CONTROL POINTS & PATCHING SCHEDULE
4. EXISTING TYPICAL SECTIONS
- 5.-6. PROPOSED TYPICAL SECTIONS
7. PROPOSED TYPICAL SECTIONS AT SIDEROADS
- 8.-10. PLAN AND PROFILE
- 11.-13. REMOVAL ITEMS
14. TRAFFIC CONTROL PLAN
15. PAVEMENT MARKING & SIGNING PLAN
16. CONSTRUCTION DETAILS
17. ENTRANCE DETAILS

HIGHWAY STANDARDS

280001-06	604006-04
420111-03	604021-02
424001-06	606001-04
424006	701006-03
424011	701011-02
424016	701301-04
424021	701501-06
424026	701801-05
442101-07	701901-02
602301-03	720001-01
602306-03	720006-03
602601-02	728001-01
602701-02	780001-03
604001-03	

SCALES

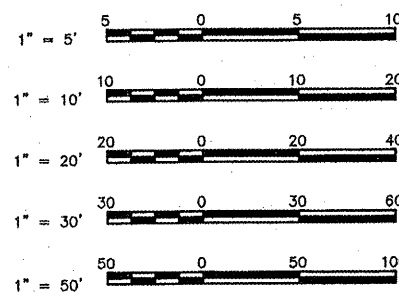

FULL SIZE PLANS HAVE BEEN PREPARED USING STANDARD ENGINEERING SCALES. REDUCED SIZED PLANS WILL NOT CONFORM TO STANDARD SCALES. IN MAKING MEASUREMENTS ON REDUCED PLANS THE ABOVE SCALES MAY BE USED.

FUNCTIONAL CLASSIFICATION: URBAN MINOR ARTERIAL  
DESIGN SPEED = 30 M.P.H.  
ADT = 7,000

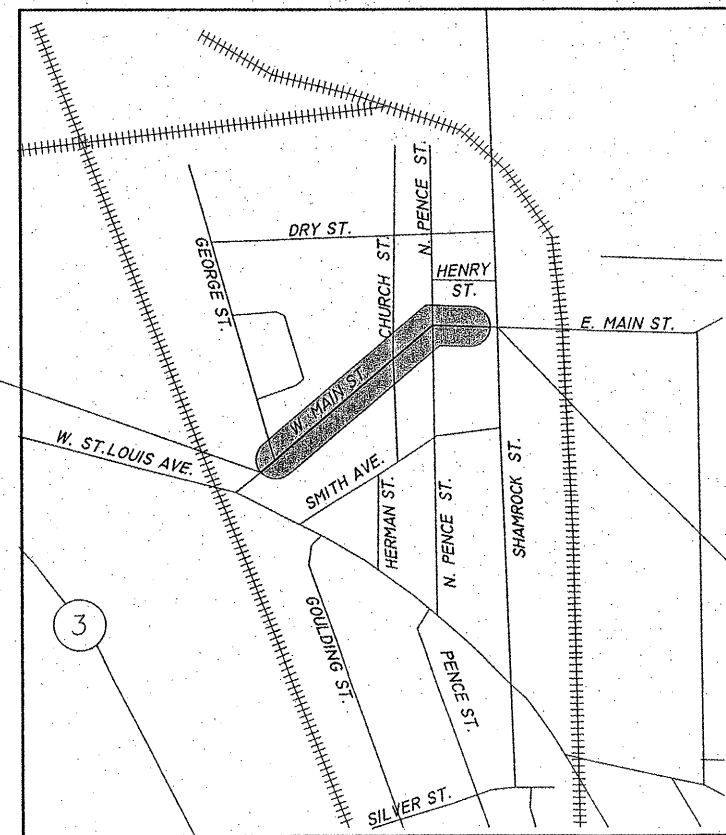

LOCATION MAP

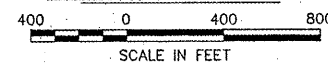

LENGTH OF PROJECT = 1,162.99 FEET = 0.220 MILES

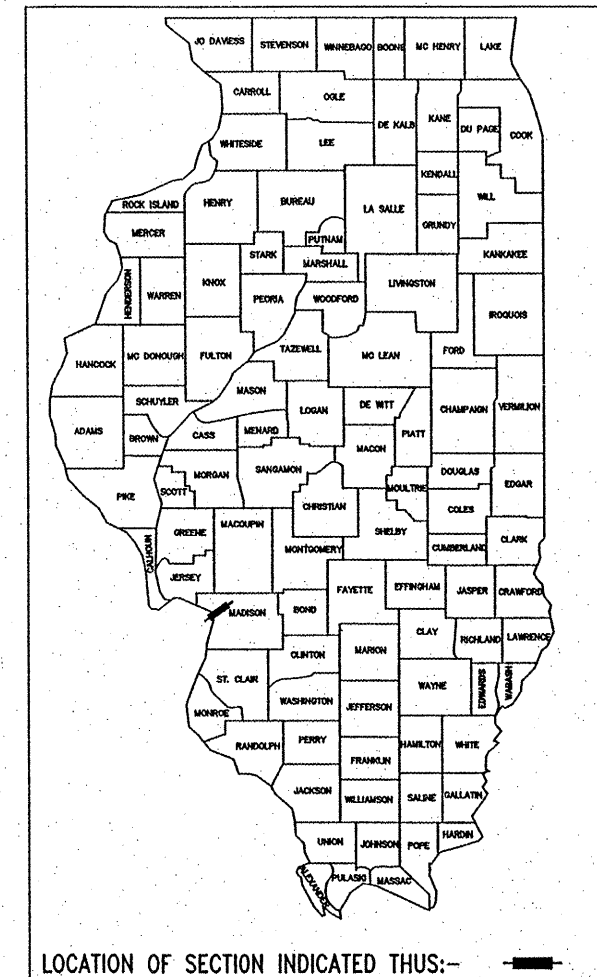

LOCATION OF SECTION INDICATED THUS:-

STATE OF ILLINOIS DEPARTMENT OF TRANSPORTATION	
APPROVED	February 7, 2012 <i>James Bright</i> MAYOR FRED BRIGHT
PASSED	3-12, 2012 <i>J. Blahney</i> DISTRICT ENGINEER OF LOCAL ROADS & STREETS
RELEASING FOR BID BASED UPON LIMITED REVIEW	3-12, 2012 <i>Omer Osman</i> OMER OSMAN DEPUTY DIRECTOR OF HIGHWAYS REGION FIVE ENGINEER
STATE OF ILLINOIS DEPARTMENT OF TRANSPORTATION PRINTED BY AUTHORITY OF THE STATE OF ILLINOIS	

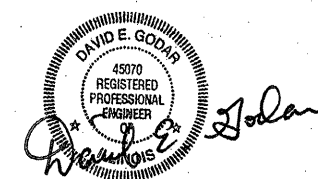

DATE SIGNED 2-7-2012  
EXPIRATION DATE 11-30-2013



Sheppard Morgan & Schwaab, Inc.  
CONSULTING ENGINEERS & LAND SURVEYORS  
215 Market Street  
Alton, Illinois 62002  
P.O. Box E  
618/462-9765

10 Central Industrial Dr  
Suite 3  
Northgate Center  
Granite City, IL 62040  
618/877-8700

**STANDARD SYMBOL LEGEND**

**STANDARD LINE TYPE LEGEND**

**GENERAL NOTES**

**EXISTING**

**PROPOSED**

**EXISTING FEATURES**

**PROPOSED FEATURES**

- EXISTING GUY POLE - -○-
- EXISTING LIGHT POLE - -X
- EXISTING POWER POLE - -○-
- EXISTING TELEPHONE POLE - -○-
- EXISTING GUY WIRE - -
- EXISTING TRANSMISSION TOWER - □
- EXISTING ELECTRIC SPLICE BOX - □<sup>E</sup>
- EXISTING TELEPHONE SPLICE BOX - □<sup>TV</sup>
- EXISTING CABLE SPLICE BOX - □<sup>TV</sup>
- EXISTING WATER HYDRANT - FH
- EXISTING GAS METER - ⊕
- EXISTING WATER METER - ⊕
- EXISTING WATER VALVE - ⊕
- EXISTING GAS VALVE - ⊕
- EXISTING FIRE HYDRANT - ⊕<sup>FH</sup>
- EXISTING SANITARY MANHOLE TOP - ⊕
- EXISTING STORM MANHOLE TOP - ○
- EXISTING TELEPHONE MANHOLE TOP - ⊕
- EXISTING SANITARY CLEAN OUT - ⊕
- CONTROL POINT - ΔXXX
- BENCHMARK - B.M.
- TEST PIT / NUMBER - T.P.# X
- BORING / NUMBER - B.# X
- RIGHT-OF-WAY MARKER - MON
- AXLE FOUND - AXLE
- BOLT FOUND - BOLT
- CHISELED "X" FOUND - X
- PIN FOUND - IP
- PINCH PIPE FOUND - IP
- PK NAIL FOUND - PK
- RAILROAD SPIKE FOUND - RR
- STONE FOUND - STONE
- BRASS MONUMENT FOUND - MON
- IRON PIPE FOUND - IP
- MONUMENT FOUND - MON
- REBAR FOUND - RBR
- EXISTING MAILBOX - F
- EXISTING FENCE POST - ⊕
- EXISTING GATE POST - ⊕
- EXISTING FLAG POLE - ○
- EXISTING GUARD POST - GP
- EXISTING ADVERTISING SIGN - S
- EXISTING TRAFFIC SIGN - S
- EXISTING PARKING METER - ⊕
- EXISTING RAILROAD MILE POST - MP
- EXISTING RAILROAD SIGNAL CONTROLLER - S
- EXISTING RAILROAD CROSSING GATE - S
- EXISTING TRAFFIC SIGNAL - S
- EXISTING TRAFFIC SIGNAL CONTROLLER - S
- EXISTING HANDHOLE - S
- EXISTING DOUBLE HANDHOLE - S
- EXISTING MAST ARM BASE - S
- EXISTING DECIDUOUS TREE / SIZE - XX"
- EXISTING EVERGREEN TREE / SIZE - XX"
- EXISTING STUMP / SIZE - PXX"
- EXISTING BUSH - S
- EXISTING SHRUB - S
- EXISTING TREE TO BE REMOVED - X

- PROPOSED GUY POLE - -○-
- PROPOSED LIGHT POLE - -X
- PROPOSED POWER POLE - -○-
- PROPOSED TELEPHONE POLE - -○-
- PROPOSED GUY WIRE - -
- PROPOSED TRANSMISSION TOWER - □
- PROPOSED ELECTRIC SPLICE BOX - □<sup>E</sup>
- PROPOSED TELEPHONE SPLICE BOX - □<sup>TV</sup>
- PROPOSED CABLE SPLICE BOX - □<sup>TV</sup>
- PROPOSED WATER HYDRANT - FH
- PROPOSED GAS METER - ⊕
- PROPOSED WATER METER - ⊕
- PROPOSED WATER VALVE - ⊕
- PROPOSED GAS VALVE - ⊕
- PROPOSED FIRE HYDRANT - ⊕<sup>FH</sup>
- PROPOSED SANITARY MANHOLE TOP - ⊕
- PROPOSED STORM MANHOLE TOP - ○
- PROPOSED TELEPHONE MANHOLE TOP - ⊕
- PROPOSED SANITARY CLEAN OUT - ⊕
- PROPOSED MAILBOX - F
- PROPOSED GUARD POST - GP
- PROPOSED ADVERTISING SIGN - S
- PROPOSED TRAFFIC SIGN - S
- PROPOSED RAILROAD MILE POST - MP
- PROPOSED RAILROAD SIGNAL CONTROLLER - S
- PROPOSED RAILROAD CROSSING GATE - S
- PROPOSED TRAFFIC SIGNAL - S
- PROPOSED TRAFFIC SIGNAL CONTROLLER - S
- PROPOSED HANDHOLE - S
- PROPOSED DOUBLE HANDHOLE - S
- PROPOSED MAST ARM BASE - S
- PROPOSED DECIDUOUS TREE / SIZE - XX"
- PROPOSED EVERGREEN TREE / SIZE - XX"
- PROPOSED BUSH - S
- PROPOSED PLANT - \*
- PROPOSED EDGE OF PAVEMENT ELEVATION - + 512.00 EP
- PROPOSED PAVEMENT ELEVATION - + 505.50 P
- PROPOSED CURB ELEVATION - + 550.25 TC
- PROPOSED SIDEWALK ELEVATION - + 515.15 SW
- PROPOSED FLOWLINE ELEVATION - + 501.58 FL
- PROPOSED CURB RAMP - S
- PROPOSED DETECTABLE WARNING - S
- PROPOSED LANDING - L

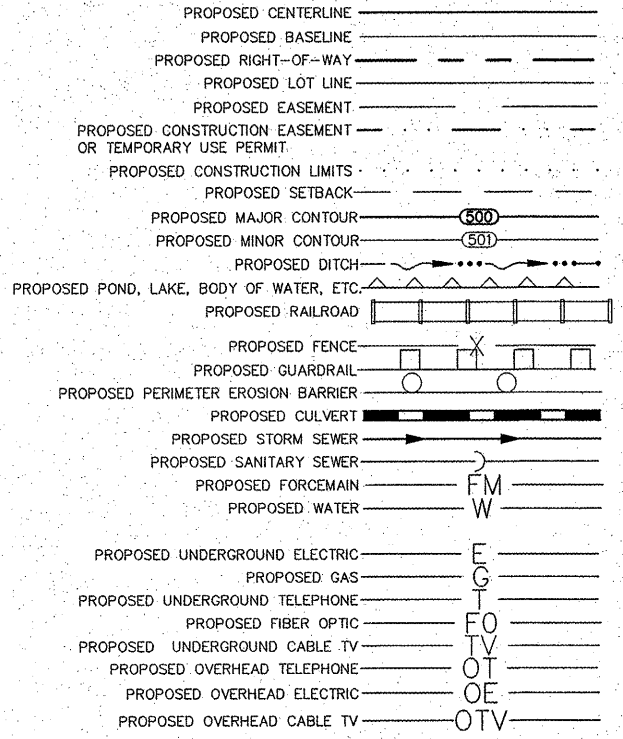
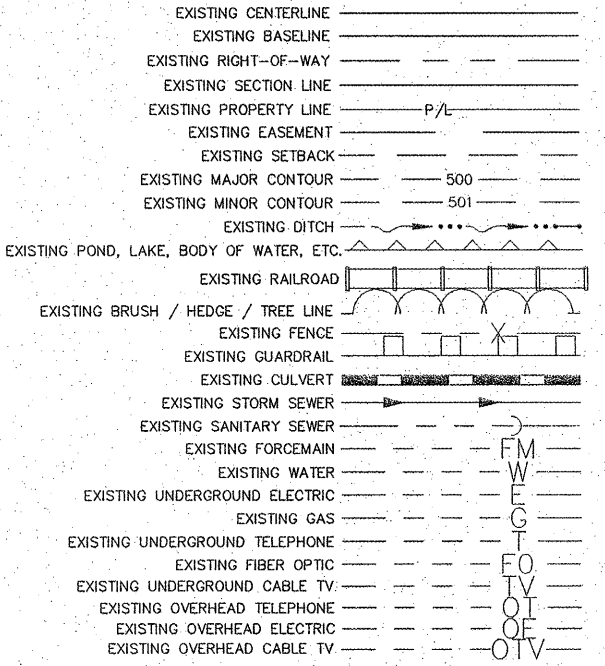

**ABBREVIATIONS**

ADT	AVERAGE DAILY TRAFFIC	OL	OPEN LID
BK	BACK	PC	POINT OF CURVE
BM	BENCH MARK	PE	PRIVATE ENTRANCE
BVCE	BEGIN VERTICAL CURVE ELEVATION	PI	POINT OF INTERSECTION
BVCS	BEGIN VERTICAL CURVE STATION	PK	PK NAIL
C&G	CURB AND GUTTER	PP	POWER POLE
C/L	CENTER LINE	PRCF	PRECAST REINFORCED CONCRETE FLARED
CE	COMMERCIAL ENTRANCE	PT	POINT OF TANGENT
CI	CAST IRON	PVC	POINT OF VERTICAL CURVE
CL	CLOSED LID	R	RADIUS
CM	CONCRETE MONUMENT	RBR	REBAR
CMP	CORRUGATED METAL PIPE	RDMH	RESTRICTED DEPTH MANHOLE
CONC	CONCRETE	ROW	RIGHT OF WAY
CT	CRIMP TOP PIPE	RR	RAIL ROAD
CU YD	CUBIC YARD	RRPM	RAISED REFLECTIVE PAVEMENT MARKER
DE	DRAINAGE EASEMENT	RT	RIGHT
DIP	DUCTILE IRON PIPE	S	SOUTH
E	EAST	SE	SOUTHEAST
ELEV	ELEVATION	SL	SECTION LINE
EP	EDGE OF PAVEMENT	SS1	STORM SEWER TYPE 1
EQN STA	EQUATION STATION	SS2	STORM SEWER TYPE 2
ES	EDGE OF SHOULDER	SS3	STORM SEWER TYPE 3
FE	FIELD ENTRANCE	STA	STATION
FH	FIRE HYDRANT	SW	SOUTHWEST
FL	FLOW LINE	TB	TRENCH BACKFILL
FT	FOOT	TBR	TO BE REMOVED
FWD	FORWARD	TC	TOP OF CURB
GP	GUARD POST	TCE	TEMPORARY CONSTRUCTION EASEMENT
HDPE	HIGH DENSITY POLYETHYLENE	TPM	TEMPORARY PAVEMENT MARKING
HMA	HOT-MIX ASPHALT	TPPM	THERMOPLASTIC PAVEMENT MARKING
IP	IRON PIPE	TUP	TEMPORARY USE PERMIT
LT	LEFT	TY	TYPE
MON	MONUMENT	TYP	TYPICAL
MP	MILE PIPE	VC	VERTICAL CURVE
N	NORTH	VCP	VITRIFIED CLAY PIPE
NE	NORTHEAST	W	WEST
NW	NORTHWEST	WMA	WATER MAIN QUALITY
O&C	OIL AND CHIP		

1. THIS PROJECT SHALL BE CONSTRUCTED ACCORDING TO THE "STANDARD SPECIFICATIONS FOR ROAD AND BRIDGE CONSTRUCTION" ADOPTED JANUARY 1, 2012 AND THE SPECIAL PROVISIONS OF THE PROJECT CONTRACT.
2. THE PLANS SHOW THE APPROXIMATE LOCATION OF KNOWN UTILITIES, BUT DO NOT SHOW HOUSE OR SERVICE CONNECTIONS. UTILITY INFORMATION PROVIDED IS BASED ON INFORMATION OBTAINED FROM UTILITY COMPANIES AND SHALL NOT BE CONSIDERED TO BE ACCURATE OR COMPLETE. THE CONTRACTOR SHALL USE ALL DUE PRECAUTION NOT TO DAMAGE OR DISTURB ANY UTILITIES AND THE ENTIRE COST OF MAKING REPAIRS TO, OR REPLACEMENT OF, ANY DAMAGED LINE WILL BE THE RESPONSIBILITY OF THE CONTRACTOR.
3. PROPOSED ELEVATIONS SHOWN ON THE PLANS AS +/- ARE APPROXIMATE. EXACT ELEVATIONS SHALL BE DETERMINED BY THE ENGINEER IN THE FIELD. IF APPLICABLE, ELEVATIONS SHALL BE DETERMINED PRIOR TO FABRICATION OF THE DRAINAGE STRUCTURES.
4. FOR SIMPLICITY, STORM SEWER LENGTHS SHOWN ON THE PLANS ARE FROM CENTER TO CENTER OF STRUCTURES. ACTUAL PIPE REQUIRED WILL BE LESS. MEASUREMENT FOR PAYMENT PURPOSES SHALL BE ACCORDING TO ARTICLE 550.09 OF THE STANDARD SPECIFICATIONS.
5. THE OFFSETS FOR ALL ROUND INLETS AND MANHOLES ARE GIVEN TO THE CENTER OF THE OPENING REQUIRED FOR THE FRAME AND GRATE OR LID THAT IS SPECIFIED. THE OFFSETS FOR ALL SQUARE BOX INLETS AND SQUARE FLUSH INLETS ARE GIVEN TO THE CENTER OF THE BASE OF THE STRUCTURE. OFFSETS FOR ALL CONCRETE FLARED END SECTIONS ARE GIVEN TO THE CENTER OF THE END OF THE END SECTION.
6. SEE TYPICAL SECTION SHEETS FOR TYPICAL SECTION NOTES.
7. PLAN QUANTITIES FOR HOT-MIX ASPHALT ITEMS WERE CALCULATED BASED ON USING 112 LBS. / SQ. YD. / IN.
8. UNLESS OTHERWISE PROVIDED FOR HEREIN, THE CONTRACTOR SHALL PROTECT AND RESTORE EXISTING TRAFFIC SIGNS IN ACCORDANCE WITH ARTICLE 107.25 OF THE STANDARD SPECIFICATIONS. AT LOCATIONS WHERE NEW SIGNS REPLACE EXISTING SIGNS, THE CONTRACTOR SHALL REMOVE THE EXISTING SIGNS AND DELIVER THEM TO THE LOCAL STREET DEPARTMENT LOCATED AT 331 PLAYGROUND COURT, EAST ALTON, ILLINOIS. THE COST OF THIS WORK WILL BE CONSIDERED AS INCLUDED IN THE UNIT BID PRICES OF THE CONTRACT AND NO ADDITIONAL COMPENSATION WILL BE ALLOWED.
9. SIDEWALK REMOVAL AND REPLACEMENT SHALL BE SEQUENCED AS NEEDED TO ALWAYS ALLOW AN ACCESSIBLE ROUTE TO PRIVATE PROPERTY AND BUSINESSES.

**COMMITMENTS**

NONE

REVISIONS

**SMS** Sheppard, Morgan & Schwab, Inc.  
 CONSULTING ENGINEERS AND LAND SURVEYORS  
 215 Market Street P.O. Box E, Alton, IL 62002 6184249765 E-mail: mail@smsengineers.com  
 10 Central Industrial Drive, Granite City, IL 62040 618877-4700 E-mail: mail@smsengineers.com  
 DESIGN FIRM # 184-000992

VILLAGE OF EAST ALTON, ILLINOIS  
 SECTION 08-00045-00-PV  
 MAIN ST. - PHASE 2  
 GENERAL NOTES AND LEGENDS

DWG. NO.	PHS 1-DETAILS GEN NOTES.dwg
REF. BK.	PG.
JOB NO.	237334
DSN. BY:	DEG
DWN. BY:	CDP
CHK. BY:	DEG
DATE:	DEC., 2011

SUMMARY OF QUANTITIES

CONTRACT NO. 97472

CONSTRUCTION TYPE CODE			
CODE NO.	ITEM	UNIT	TOTAL QUANTITY
20201200	REMOVAL AND DISPOSAL OF UNSUITABLE MATERIAL	CU. YD.	10
20800150	TRENCH BACKFILL	CU. YD.	4.1
25000115	SEEDING, CLASS 1B	ACRE	0.2
25000400	NITROGEN FERTILIZER NUTRIENT	POUND	19
25000500	PHOSPHORUS FERTILIZER NUTRIENT	POUND	19
25000900	POTASSIUM FERTILIZER NUTRIENT	POUND	19
25100115	MULCH, METHOD 2	ACRE	0.2
28000500	INLET AND PIPE PROTECTION	EACH	3
31100300	SUBBASE GRANULAR MATERIAL, TYPE A4*	SQ. YD.	93
31101000	SUBBASE GRANULAR MATERIAL, TYPE B	TON	21
35400800	HIGH-EARLY-STRENGTH PORTLAND CEMENT CONCRETE BASE COURSE WIDENING 8"	SQ. YD.	74
40200800	AGGREGATE SURFACE COURSE, TYPE B	TON	2
40600100	BITUMINOUS MATERIAL S (PRIME COAT)	GALLON	541
40600300	AGGREGATE (PRIME COAT)	TON	11
40600400	MIXTURE FOR CRACKS, JOINTS, AND FLANGEWAYS	TON	1
40600837	POLYMERIZED LEVELING BINDER (MACHINE METHOD), N70	TON	400
40600982	HOT-MIX ASPHALT SURFACE REMOVAL - BUTT JOINT	SQ. YD.	162
40600985	PORTLAND CEMENT CONCRETE SURFACE REMOVAL - BUTT JOINT	SQ. YD.	231
40600990	TEMPORARY RAMP	SQ. YD.	46
40603540	POLYMERIZED HOT-MIX ASPHALT SURFACE COURSE, MX"D, N70	TON	454
40800050	INCIDENTAL HOT-MIX ASPHALT SURFACING	TON	10.3
42300200	PORTLAND CEMENT CONCRETE DRIVEWAY PAVEMENT, 6"	SQ. YD.	56
42300400	PORTLAND CEMENT CONCRETE DRIVEWAY PAVEMENT, 8"	SQ. YD.	167
42400100	PORTLAND CEMENT CONCRETE SIDEWALK 4"	SQ. FT.	4,790
42400800	DETECTABLE WARNINGS	SQ. FT.	237
44000100	PAVEMENT REMOVAL	SQ. YD.	68.2
44000156	HOT-MIX ASPHALT SURFACE REMOVAL, 1 1/2"	SQ. YD.	905
44000200	DRIVEWAY PAVEMENT REMOVAL	SQ. YD.	310
44000300	CURB REMOVAL	FOOT	140
44000500	COMBINATION CURB AND GUTTER REMOVAL	FOOT	1001
44000600	SIDEWALK REMOVAL	SQ. FT.	4598
44200934	CLASS B PATCHES, TYPE II, 8 INCH	SQ. YD.	320.9
44200942	CLASS B PATCHES, TYPE III, 8 INCH	SQ. YD.	75.2
44200944	CLASS B PATCHES, TYPE IV, 8 INCH	SQ. YD.	742.4
44201299	DOWEL BARS 1 1/2"	EACH	1216
44213100	PAVEMENT FABRIC	SQ. YD.	818
44213200	SAWCUTS	FOOT	3776
44213204	TIE BARS 3/4"	EACH	111
550A0010	STORM SEWERS, CLASS A, TYPE 1 4"	FOOT	29
55100100	STORM SEWER REMOVAL 4"	FOOT	5
55100500	STORM SEWER REMOVAL 12"	FOOT	23
59300100	CONTROLLED LOW-STRENGTH MATERIAL	CU. YD.	11
60235700	INLETS, TYPE A, TYPE 3 FRAME AND GRATE	EACH	1
60240210	INLETS, TYPE B, TYPE 1 FRAME, OPEN LID	EACH	1
60266600	VALVE BOXES TO BE ADJUSTED	EACH	7
60300350	MANHOLE FRAMES TO BE ADJUSTED	EACH	1
60500080	REMOVING INLETS	EACH	2
60600605	CONCRETE CURB, TYPE B	FOOT	229
67100100	MOBILIZATION	L. SUM	1
70300100	SHORT TERM PAVEMENT MARKING	FOOT	428
70300220	TEMPORARY PAVEMENT MARKING - LINE 4"	FOOT	3265
70300240	TEMPORARY PAVEMENT MARKING - LINE 6"	FOOT	749
70300280	TEMPORARY PAVEMENT MARKING - LINE 12"	FOOT	190
70300280	TEMPORARY PAVEMENT MARKING - LINE 24"	FOOT	66
70301000	WORK ZONE PAVEMENT MARKING REMOVAL	SQ. FT.	141
72000100	SIGN PANEL - TYPE 1	SQ. FT.	43.4
72800100	TELESCOPING STEEL SIGN SUPPORT	FOOT	88
78000200	THERMOPLASTIC PAVEMENT MARKING - LINE 4"	FOOT	3285
78000400	THERMOPLASTIC PAVEMENT MARKING - LINE 6"	FOOT	749
78000600	THERMOPLASTIC PAVEMENT MARKING - LINE 12"	FOOT	190
78000650	THERMOPLASTIC PAVEMENT MARKING - LINE 24"	FOOT	66
78300100	PAVEMENT MARKING REMOVAL	SQ. FT.	16
20012450	CONCRETE STEPS	CU. YD.	0.4
20056648	STORM SEWERS, TYPE 1, WATER MAIN QUALITY PIPE, 12"	FOOT	77
X0323389	STORM SEWER CONNECTION	EACH	3
X0327294	STORM SEWERS TO BE GROUTED	CU. YD.	0.4
X5091785	PIPE HANDRAIL, SPECIAL	FOOT	8
X8025600	MANHOLES TO BE ADJUSTED, (SPECIAL)	EACH	3
X8061700	COMBINATION CONCRETE CURB AND GUTTER, TYPE B (SPECIAL)	FOOT	962
X7010216	TRAFFIC CONTROL AND PROTECTION, (SPECIAL)	L. SUM	1
X0008455	INLET BOX, SPECIAL	EACH	1

\* DENOTES SPECIALTY ITEMS

STATION TO STATION	LENGTH (FEET)	WIDTH (FEET)	CLASS "B" PATCHES, 8 INCH (SQ. YD.)				PAVEMENT FABRIC	DOWEL BARS 1 1/2"	TIE BARS 3/4"	SAW CUTS
			TYPE I	TYPE II	TYPE III	TYPE IV				
12+81.03 - 13+13 LT.	32	VAR.				60.2	60.2	28	16	147
12+81.03 - 13+13 RT.	32	VAR.				58.2	58.2	28	16	113
13+29 - 13+37 RT.	8	16.5		14.7				28		73.5
13+38.50 - 13+47.50 LT.	9	16.5			16.5		16.5	28		76.5
13+75 - 13+81 RT.	6	16.5		11.0				28		67.5
13+75 - 13+81 LT.	6	16.5		11.0				28		61.5
14+08 - 14+14 LT.	6	16.5		11.0				28		67.5
14+60 - 14+72 RT.	12	16.5			22.0		22.0	28		85.5
14+78 - 14+84 LT.	6	16.5		11.0				28		67.5
14+78 - 14+84 RT.	6	16.5		11.0				28		61.5
15+06 - 15+28 RT.	22	16.5				40.3	40.3	28	11	115.5
15+50 - 15+56 LT.	6	16.5		11.0				28		67.5
15+50 - 15+56 RT.	6	16.5		11.0				28		61.5
15+75 - 15+81 LT.	6	16.5		11.0				28		67.5
15+88 - 15+95 RT.	7	16.5		12.8				28		70.5
16+00 - 16+22 LT.	22	16.5				40.3	40.3	28	11	115.5
16+07 - 16+14 RT.	7	16.5		12.8				28		70.5
16+41 - 16+61 LT.	20	16.5				36.7	36.7	28		109.5
16+42 - 16+81 RT.	39	16.5				71.5	71.5	28	19	88.5
16+74 - 16+91 LT.	17	16.5				31.1	31.1	28		100.5
17+14 - 17+21 LT.	7	16.5		12.8				28		70.5
17+43 - 17+50 LT.	7	16.5		12.8				28		70.5
17+44 - 17+50 RT.	6	16.5		11.0				28		61.5
17+77 - 17+84 RT.	7	16.5		12.8				28		70.5
18+39 - 18+45 LT.	6	16.5		11.0				28		61.5
18+38 - 18+45 RT.	7	16.5		12.8				28		70.5
18+75 - 18+84 LT.	9	16.5			16.5		16.5	28		67.5
18+75 - 18+86 RT.	11	16.5			20.2		20.2	28		82.5
18+97 - 19+13 RT.	16	16.5				29.3	29.3	28		97.5
19+07 - 19+13 LT.	6	16.5		11.0				28		61.5
19+39 - 19+45 LT.	6	16.5		11.0				28		67.5
19+74 - 19+80 RT.	6	16.5		11.0				28		67.5
21+03 - 21+09 LT.	6	15		10.0				24		63
21+27 - 21+33 LT.	6	15.5		10.3				28		64.5
21+44 - 21+77 LT.	33	VAR.				52.7	52.7	28	16	142
22+02 - 22+46 LT.	44	VAR.				181.7	181.7	42	22	231
22+02 - 22+46 RT.	44	VAR.				94.7	94.7	26	N/A	146
22+71 - 22+77 LT.	6	12		8.0				20		54
22+71 - 22+77 RT.	6	12		8.0				20		48
22+89 - 22+99 RT.	10	12		13.3				20		66
23+07 - 23+13 LT.	6	12		8.0				20		54
23+07 - 23+13 RT.	6	12		8.0				20		48
GEORGE ST. LT.	14.5	VAR.				33.4	33.4	24		89
GEORGE ST. RT.	14.5	VAR.				32.3	32.3	24		106
JOB ST. RT.	14	VAR.		10.1				10		61.5
CHURCH ST. RT.	6	16		10.7				14		66
<b>TOTALS:</b>			<b>0.0</b>	<b>320.9</b>	<b>75.2</b>	<b>742.4</b>	<b>817.6</b>	<b>1216</b>	<b>111</b>	<b>3776</b>

PAVEMENT PATCHING NOTES

- LOCATION STATIONS ARE APPROXIMATE. ACTUAL LOCATIONS WILL BE MARKED BY THE ENGINEER DURING CONSTRUCTION.
- WHERE EXISTING MANHOLES ARE LOCATED WITHIN A PAVEMENT PATCH, A PAVEMENT ROUNDOUT PER HIGHWAY STANDARD 420111 SHALL BE CONSTRUCTED IN THE PATCH. THE COST OF THE ROUNDOUT, CIRCULAR FORM TIE BARS AND REINFORCEMENT BARS SHALL BE INCLUDED IN THE COST OF MANHOLES TO BE ADJUSTED (SPECIAL). SEE THE SPECIAL PROVISIONS.
- THE PATCHING SHOWN AT THE INTERSECTION OF PENCE STREET IS A LARGE AREA. THE CONTRACTOR SHALL CONSTRUCT THESE PATCHES AS SEPARATE PATCHES WITH JOINTS NO WIDER THAN 16 FEET.
- PATCHES MAY BE POURED MONOLITHIC WITH ADJACENT CURB AND GUTTER OR P.C.C. BASE COURSE WIDENING.

BENCHMARK INFORMATION

SITE BENCHMARK:  
R.R. SPIKE IN SOUTH SIDE OF PP @  
N.W. CORNER OF MAIN ST. AND SHAMROCK  
STA. 24+15±, ELEV. = 443.30

SURVEY CONTROL POINTS			
VERTICAL CONTROL (BENCH MARKS)			
CONTROL POINT	LOCATION	ELEVATION	DESCRIPTION
BM "1"	STA. 24+15±, 20.8'± LT.	443.30	TOP OF R.R. SPIKE P.P.
BM "10"	STA. 19+31±, 20.8'± LT.	443.17	TOP OF R.R. SPIKE P.P.
BM "11"	STA. 14+43±, 19.4'± LT.	441.70	TOP OF R.R. SPIKE P.P.
BM "12"	STA. 11+99±, 37.8'± RT.	432.82	"X" ON NORTH BOLT FH.

HORIZONTAL CONTROL				
CONTROL POINT	NORTHING	EASTING	ELEVATION	DESCRIPTION
CP #1000	807250.8040	2312494.8770	441.93*	TOP OF CUT CROSS
CP #1001	807284.4510	2312866.5830	439.19*	TOP OF CUT CROSS
CP #1010	807299.3270	2312291.2250	442.27*	TOP OF CUT CROSS
CP #1011	807148.2110	2312149.9860	441.36*	TOP OF CUT CROSS
CP #1012	807055.9080	2311954.1870	441.04*	TOP OF CUT CROSS
CP #1013	806887.9590	2311859.2150	442.54*	TOP OF CUT CROSS
CP #1014	806705.8460	2311562.1600	434.15*	TOP OF CUT CROSS
CP #1015	806597.2080	2311433.5300	429.12*	TOP OF CUT CROSS

\* ELEVATIONS SHOULD BE CHECKED FROM A BENCHMARK.

REVISIONS					

**SMS** Sheppard, Morgan & Schwaab, Inc.  
 CONSULTING ENGINEERS AND LAND SURVEYORS  
 215 Market Street, P.O. Box E, Alton, IL 62002 618462-2755 Email: mail@smsengineers.com  
 10 Central Industrial Drive, Granite City, IL 62040 618877-8700 Email: mail@smsengineers.com  
 DESIGN FIRM # 184-0C0692

VILLAGE OF EAST ALTON, ILLINOIS  
 SECTION 08-00045-00-PV  
 MAIN ST. - PHASE 2  
 SUMMARY OF QUANTITIES, CONTROL POINTS  
 AND PATCHING SCHEDULE

DWG. NO.	
EA MAIN ST. PHS 2 SCHEDULES.DWG	
REF. BK.	PG. -
JOB NO.	227832.1
DSN. BY:	DEG
DWN. BY:	CAD
CHK. BY:	DEG
DATE:	DEC., 2011
SCALE:	NO SCALE
SHEET	3 OF 17

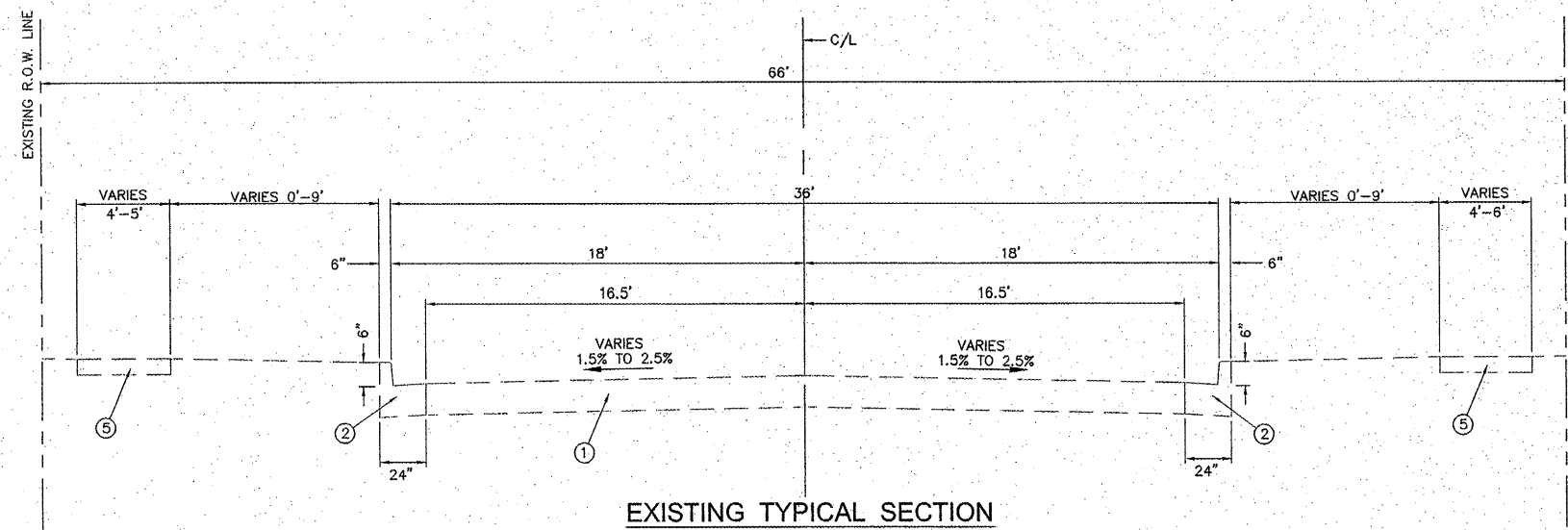

EXISTING TYPICAL SECTION  
MAIN ST.  
STA. 12+81.03 TO STA. 20+99.18

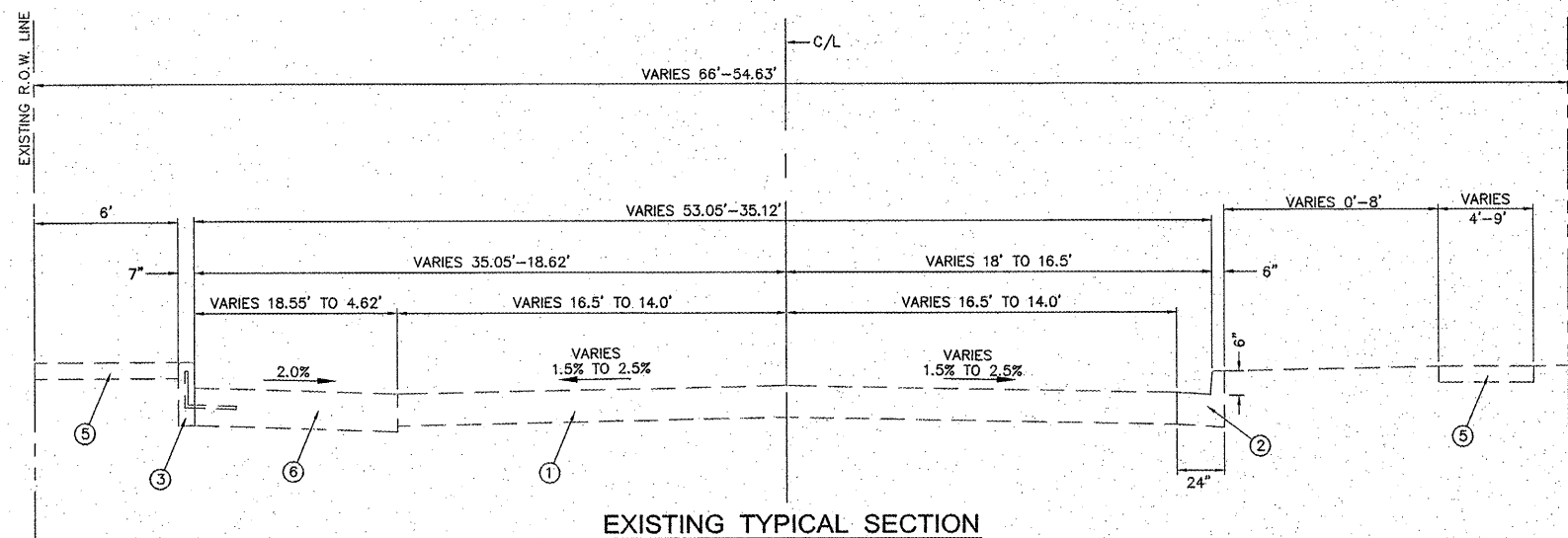

EXISTING TYPICAL SECTION  
MAIN ST.  
STA. 20+99.18 TO STA. 22+41.85

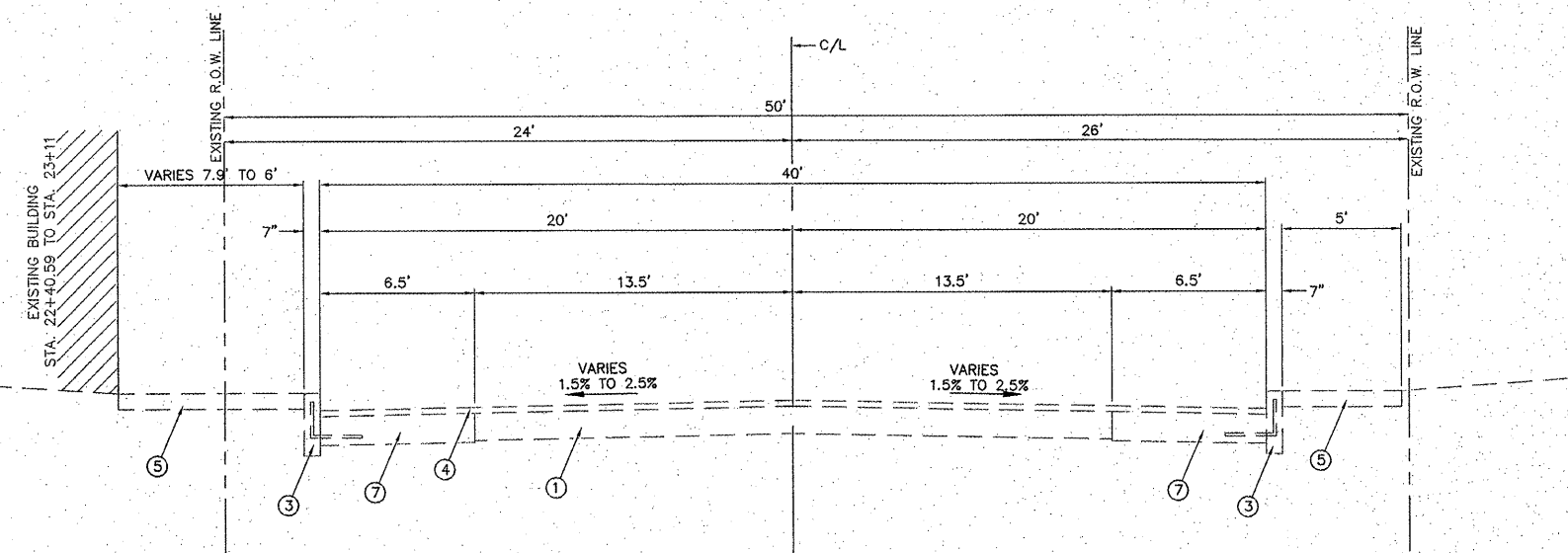

EXISTING TYPICAL SECTION  
MAIN ST.  
STA. 22+41.85 TO STA. 24+44.02

PAVING LEGEND

- ① EXISTING P.C.C. PAVEMENT, 7 1/2"
- ② EXISTING COMBINATION CONCRETE CURB AND GUTTER
- ③ EXISTING CONCRETE CURB (DOWELED)
- ④ EXISTING HOT-MIX ASPHALT SURFACE, 1 3/4"
- ⑤ EXISTING P.C.C. SIDEWALK, 4"
- ⑥ EXISTING P.C.C. PAVEMENT WIDENING, 9"
- ⑦ EXISTING P.C.C. PAVEMENT WIDENING, 8"

NO.	DESCRIPTION

**SMS ENGINEERS**  
 Sheppard, Morgan & Schwab, Inc.  
 CONSULTING ENGINEERS AND LAND SURVEYORS  
 215 Market Street, P.O. Box E, Alton, IL 62002 618462-9755 E-mail: ms@smsengineers.com  
 10 Central Industrial Drive, Granite City, IL 62040 618877-8700 E-mail: ms@smsengineers.com  
 DESIGN FIRM # 184-OC0932

VILLAGE OF EAST ALTON, ILLINOIS  
 SECTION 08-00045-00-PV  
 MAIN ST. - PHASE 2  
 EXISTING TYPICAL SECTIONS

DWG. NO.	EA MAIN ST. PHS 2 TYPICAL DWG
REF. BK.	PG. -
JOB NO.	227832.1
DSN. BY:	DEG
DWN. BY:	CAD
CHK. BY:	DEG
DATE:	DEC. 2011
SCALE:	NO SCALE
SHEET	4 OF 17

**TYPICAL SECTION NOTES**

- 1 SEE PLANS FOR LOCATIONS TO BE REMOVED AND REPLACED.
- 2 TIE BARS THAT ARE PLACED IN CONCRETE SHALL BE 30" LONG AT 30" CENTERS. TIE BARS THAT ARE DRILLED AND GROUTED SHALL BE 24" LONG AT 24" CENTERS.

**PAVING LEGEND**

- 1 EXISTING P.C.C. PAVEMENT, 7 1/2"
- 2 EXISTING COMBINATION CONCRETE CURB AND GUTTER
- 3 EXISTING CONCRETE CURB (DOWELED)
- 4 EXISTING HOT-MIX ASPHALT SURFACE, 1 3/4"
- 5 EXISTING P.C.C. SIDEWALK, 4"
- 6 EXISTING P.C.C. PAVEMENT WIDENING, 9"
- 7 EXISTING P.C.C. PAVEMENT WIDENING, 8"
- 8 PROPOSED HMA SURFACE REMOVAL, 1-3/4"
- 9 PROPOSED BITUMINOUS MATERIALS (PRIME COAT)
- 10 PROPOSED AGGREGATE (PRIME COAT)
- 11 PROPOSED LEVELING BINDER (MACHINE METHOD) (1 1/2")
- 12 PROPOSED HMA SURFACE COURSE (1 1/2")
- 13 PROPOSED P.C.C. SIDEWALK, 4"
- 14 PROPOSED P.C.C. SURFACE REMOVAL - BUTT JOINT
- 15 PROPOSED AGGREGATE SURFACE COURSE, TYPE B (WEDGE)
- 16 PROPOSED HMA SURFACE REMOVAL - BUTT JOINT
- 17 PROPOSED H-E-S P.C.C. BASE COURSE WIDENING 8"
- 18 PROPOSED COMBINATION CONCRETE CURB AND GUTTER, TYPE B (SPECIAL)
- 19 PROPOSED SUBBASE GRANULAR MATERIAL, TYPE A 4"
- 20 PROPOSED 1/2" WIDE EXPANSION JOINT
- 21 PROPOSED INCIDENTAL HMA SURFACING (8")
- 22 PROPOSED CONCRETE CURB, TYPE B
- 23 No. 6 TIE BARS SEE NOTE 2

**STRUCTURAL DESIGN DATA**

MAIN STREET -- PHASE 2

PAVEMENT DESIGN: MODIFIED AASHTO DESIGN FOR OVERLAYS ON EXISTING RIGID / COMPOSITE PAVEMENTS

CLASS OF ROAD: CLASS II

DESIGN PERIOD: 20 YEARS

TRAFFIC DATA: 2013 ADT=7,140  
2023 ADT=7,890 (SDT)  
2033 ADT=8,710

STRUCTURAL DESIGN TRAFFIC: PV (94%) = 7,417  
SU (3%) = 237  
MU (3%) = 237

TRAFFIC FACTOR: 1.68

IMMEDIATE BEARING: IBV = 10

STRUCTURAL NUMBER: S<sub>nc</sub> = 3.15

HMA OVERLAY THICKNESS REQUIRED: D<sub>s</sub> = 3.0"

PROPOSED OVERLAY: HMA LEVELING BINDER = 1 1/2"  
HMA SURFACE = 1 1/2"  
TOTAL HMA = 3"

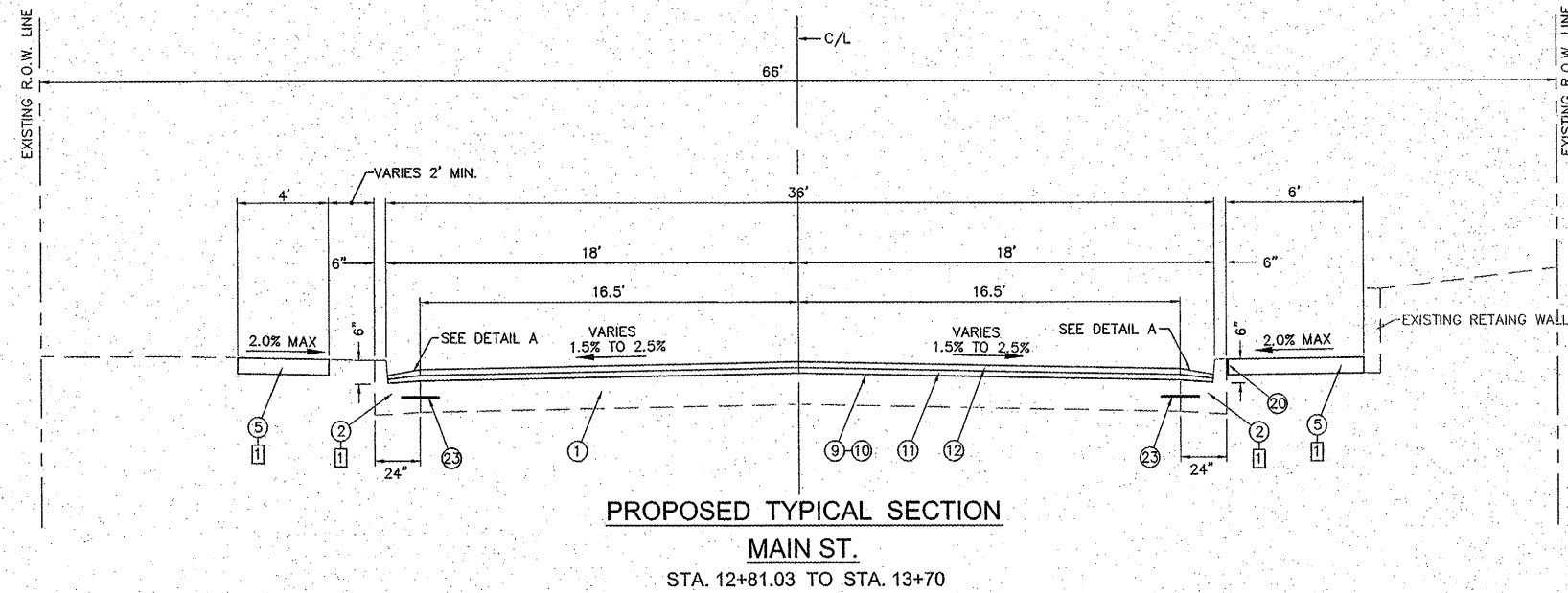

**PROPOSED TYPICAL SECTION  
MAIN ST.  
STA. 12+81.03 TO STA. 13+70**

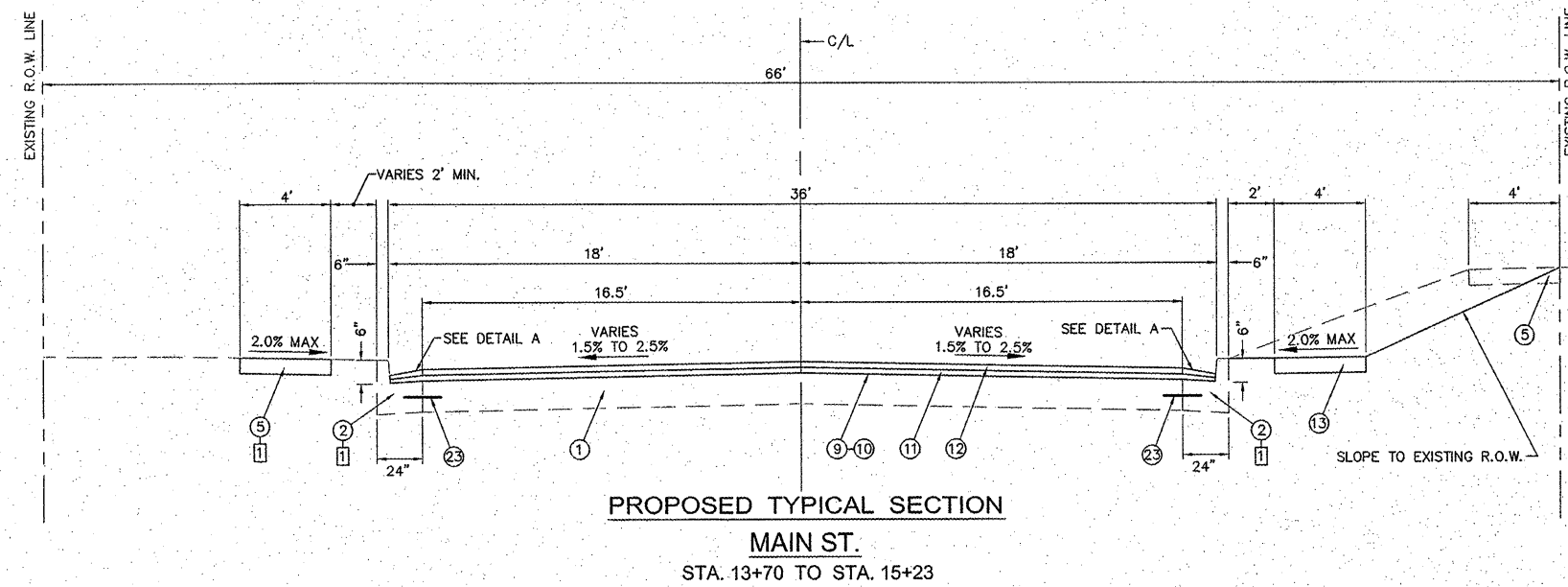

**PROPOSED TYPICAL SECTION  
MAIN ST.  
STA. 13+70 TO STA. 15+23**

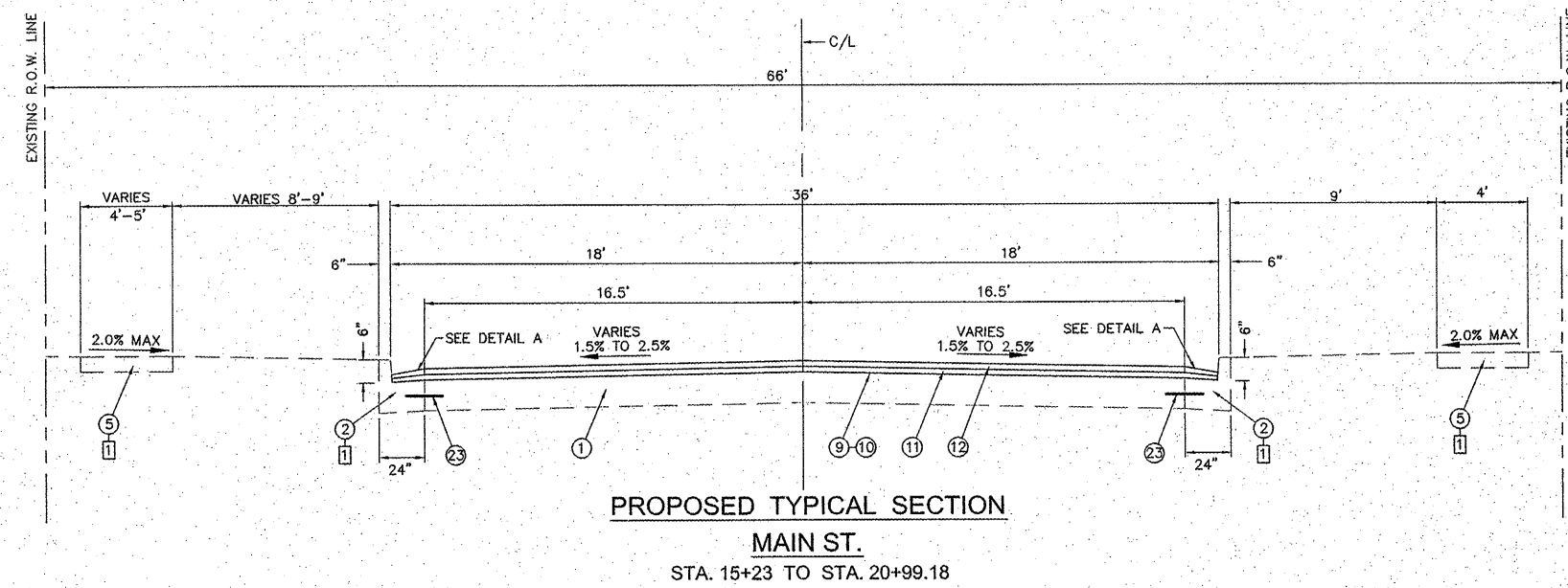

**PROPOSED TYPICAL SECTION  
MAIN ST.  
STA. 15+23 TO STA. 20+99.18**

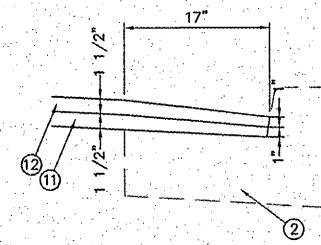

**DETAIL A**

MIX DESIGNS			
MIXTURE USE	SURFACE	LEVEL BINDER	INCIDENTAL
AC/PG	SBS	SBS	
MAX. RAP %	PG 70-22	PG 70-22	PG 64-22
DESIGN AIR VOIDS	4% @ N <sub>oes</sub> = 70	4% @ N <sub>oes</sub> = 70	4% @ N <sub>oes</sub> = 70
MIX COMPOSITION (GRADATION MIXTURE)	IL - 9.5 OR IL12.5	IL - 9.5	IL - 9.5 OR IL 12.5
FRICTION AGG	MIX D	MIX C	MIX D
* SEE SPECIAL PROVISIONS			

REVISIONS

Sheppard, Morgan & Schwaab, Inc.  
CONSULTING ENGINEERS AND LAND SURVEYORS  
216 Market Street, P.O. Box E, Alton, IL 62002 618/462-9755 E-mail: mail@smsengineers.com  
10 Central Industrial Drive, Granite City, IL 62040 618/877-8700 E-mail: mail@smsengineers.com  
DESIGN FIRM # 184-000992

**SMS ENGINEERS**

VILLAGE OF EAST ALTON, ILLINOIS  
SECTION 08-00045-00-PV  
MAIN ST. - PHASE 2  
PROPOSED TYPICAL SECTIONS

DWG. NO.  
EA MAIN ST. PHS 2 TYPICAL.DWG  
REF. BK. - PG. -  
JOB NO. 227832.1  
DSN. BY: DEG  
DWN. BY: CAD  
CHK. BY: DEG  
DATE: DEC. 2011  
SCALE: NO SCALE  
SHEET 5 OF 17

**TYPICAL SECTION NOTES**

- 1 SEE PLANS FOR LOCATIONS TO BE REMOVED AND REPLACED.
- 2 TIE BARS THAT ARE PLACED IN CONCRETE SHALL BE 30" LONG AT 30" CENTERS. TIE BARS THAT ARE DRILLED AND GROUTED SHALL BE 24" LONG AT 24" CENTERS.

**PAVING LEGEND**

- 1 EXISTING P.C.C. PAVEMENT, 7 1/2"
- 2 EXISTING COMBINATION CONCRETE CURB AND GUTTER
- 3 EXISTING CONCRETE CURB (DOWELED)
- 4 EXISTING HOT-MIX ASPHALT SURFACE, 1 3/4"
- 5 EXISTING P.C.C. SIDEWALK, 4"
- 6 EXISTING P.C.C. PAVEMENT WIDENING, 9"
- 7 EXISTING P.C.C. PAVEMENT WIDENING, 8"
- 8 PROPOSED HMA SURFACE REMOVAL, 1-3/4"
- 9 PROPOSED BITUMINOUS MATERIALS (PRIME COAT)
- 10 PROPOSED AGGREGATE (PRIME COAT)
- 11 PROPOSED LEVELING BINDER (MACHINE METHOD) (1 1/2")
- 12 PROPOSED HMA SURFACE COURSE (1 1/2")
- 13 PROPOSED P.C.C. SIDEWALK, 4"
- 14 PROPOSED P.C.C. SURFACE REMOVAL - BUTT JOINT
- 15 PROPOSED AGGREGATE SURFACE COURSE, TYPE B (WEDGE)
- 16 PROPOSED HMA SURFACE REMOVAL - BUTT JOINT
- 17 PROPOSED H-E-S P.C.C. BASE COURSE WIDENING 8"
- 18 PROPOSED COMBINATION CONCRETE CURB AND GUTTER, TYPE B (SPECIAL)
- 19 PROPOSED SUBBASE GRANULAR MATERIAL, TYPE A 4"
- 20 PROPOSED 1/2" WIDE EXPANSION JOINT
- 21 PROPOSED INCIDENTAL HMA SURFACING (8")
- 22 PROPOSED CONCRETE CURB, TYPE B
- 23 No. 6 TIE BARS SEE NOTE 2

**STRUCTURAL DESIGN DATA**

MAIN STREET - PHASE 2

PAVEMENT DESIGN: MODIFIED AASHTO DESIGN FOR OVERLAYS ON EXISTING RIGID / COMPOSITE PAVEMENTS

CLASS OF ROAD: CLASS II  
 DESIGN PERIOD: 20 YEARS

TRAFFIC DATA: 2013 ADT=7,140  
 2023 ADT=7,890 (SDT)  
 2033 ADT=8,710

STRUCTURAL DESIGN TRAFFIC: PV (94%) = 7,417  
 SU (3%) = 237  
 MU (3%) = 237

TRAFFIC FACTOR: 1.68  
 IMMEDIATE BEARING: IBV = 10  
 STRUCTURAL NUMBER: SNc = 3.15

HMA OVERLAY THICKNESS REQUIRED:  $D_o = 3.0"$

PROPOSED OVERLAY: HMA LEVELING BINDER = 1 1/2"  
 HMA SURFACE = 1 1/2"  
 TOTAL HMA = 3"

MIX DESIGNS			
MIXTURE USE	SURFACE	LEVEL BINDER	INCIDENTAL
AC/PG	PG 64-22	PG 64-22	PG 64-22
MAX RAP %			
DESIGN AIR VOIDS	4% @ $N_{des} = 70$	4% @ $N_{des} = 70$	4% @ $N_{des} = 70$
MIX COMPOSITION (GRADATION MIXTURE)	IL - 9.5 OR IL12.5	IL - 9.5	IL - 9.5 OR IL 12.5
FRICTION AGG	MIX D	MIX C	MIX D
* SEE SPECIAL PROVISIONS			

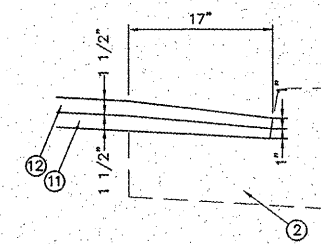

**DETAIL A**

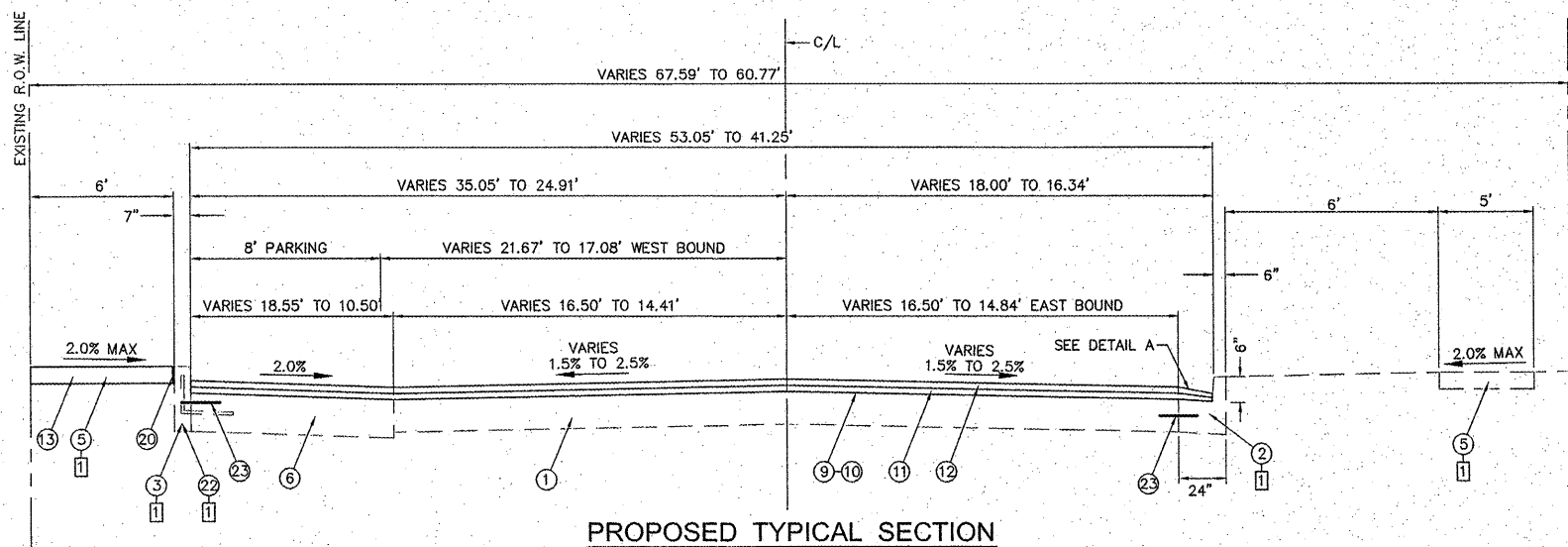

**PROPOSED TYPICAL SECTION  
 MAIN ST.  
 STA. 20+99.18 TO STA. 21+60.37**

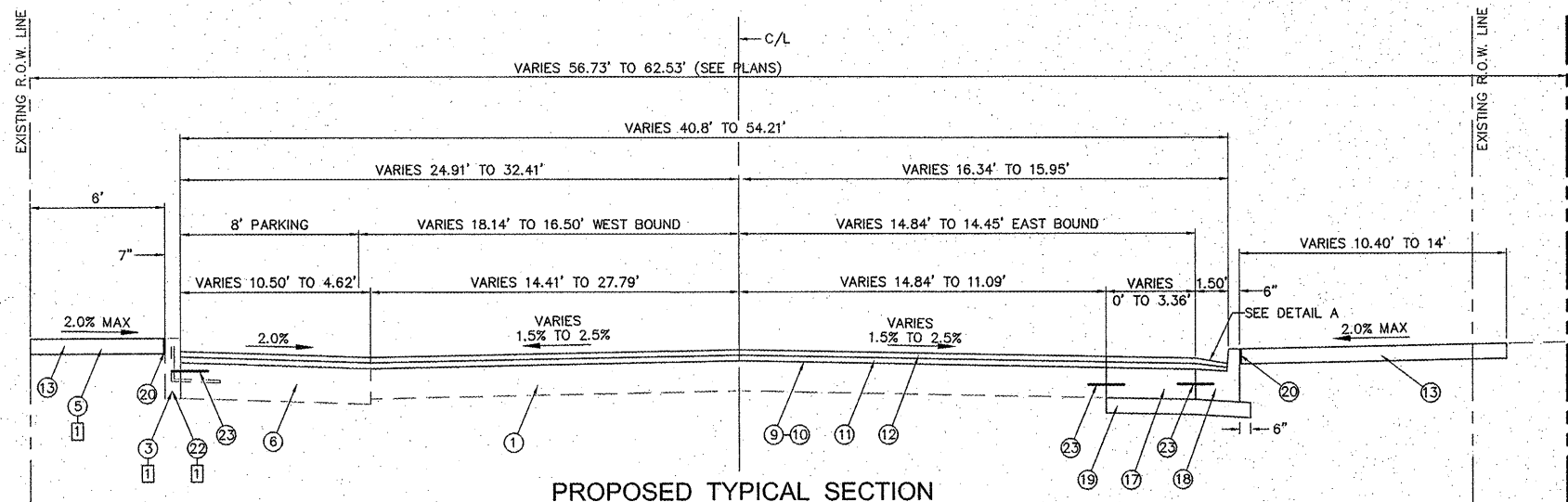

**PROPOSED TYPICAL SECTION  
 MAIN ST.  
 STA. 21+60.37 TO STA. 22+41.85**

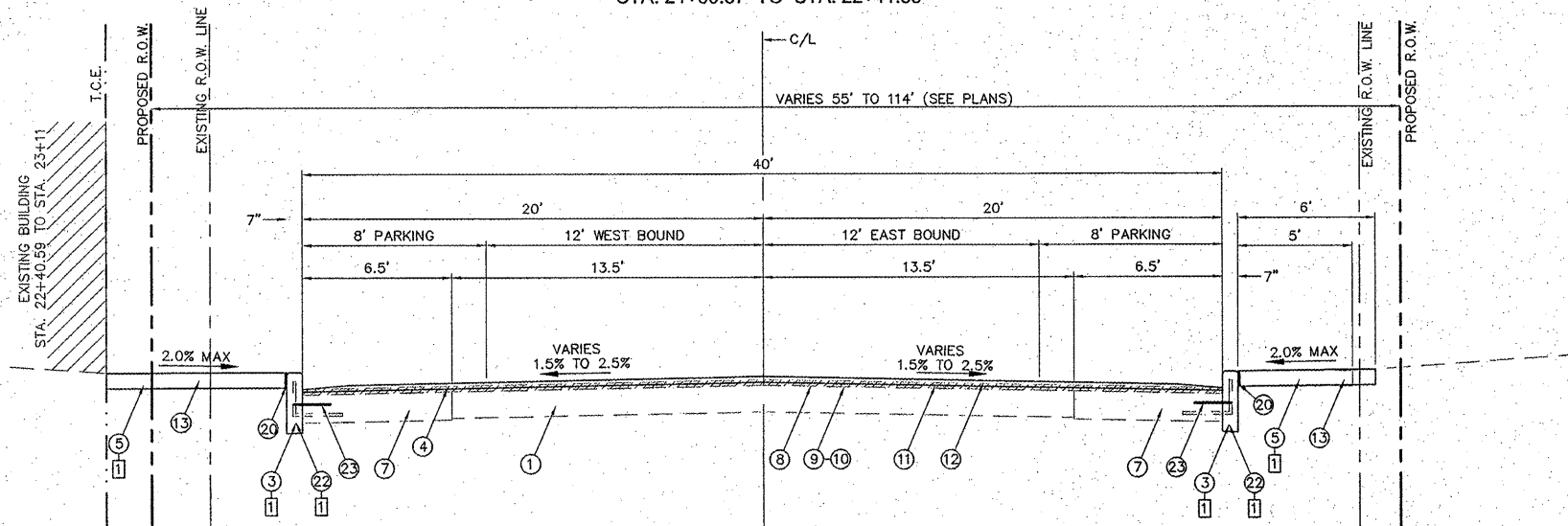

**PROPOSED TYPICAL SECTION  
 MAIN ST.  
 STA. 22+41.85 TO STA. 24+44.02**

REVISIONS

**SMS** Sheppard, Morgan & Schwab, Inc.  
 CONSULTING ENGINEERS AND LAND SURVEYORS  
 215 Market Street, P.O. Box E, Alton, IL 62002 618/662-9755 E-mail: mail@smsengineering.com  
 10 Central Industrial Drive, Geneva, IL 60135 618/877-4700 E-mail: mail@smsengineering.com  
 DESIGN FIRM # 181-000932

VILLAGE OF EAST ALTON, ILLINOIS  
 SECTION 08-00045-00-PV  
 MAIN ST. - PHASE 2  
 PROPOSED TYPICAL SECTIONS

DWG. NO.  
 EA MAIN ST. PHAS 2 TYPICAL.DWG  
 REF. BK. PG.  
 JOB NO. 227832.1  
 DSN. BY: DEG  
 DWN. BY: CAD  
 CHK. BY: DEG  
 DATE: DEC., 2011

SCALE: NO SCALE

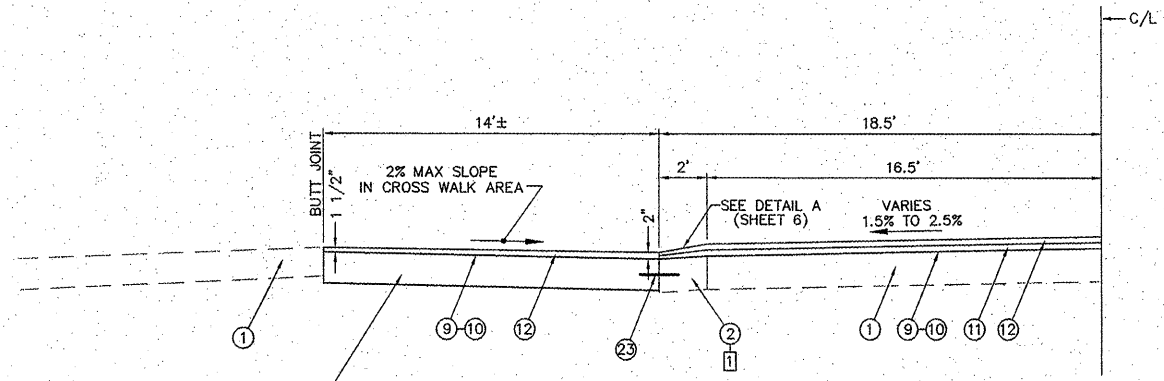

**PROPOSED TYPICAL SECTION  
AT SIDE ROAD  
GEORGE ST. (LEFT)**

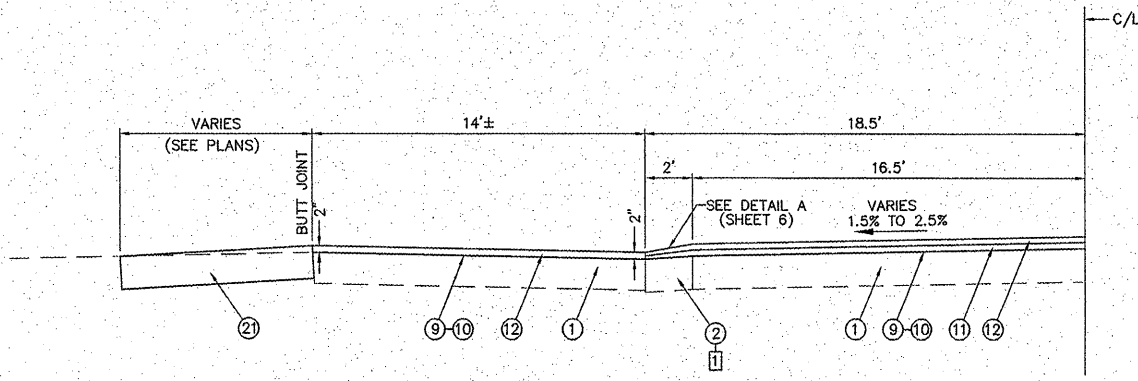

**PROPOSED TYPICAL SECTION  
AT SIDE ROAD  
ALLEY (LEFT)**

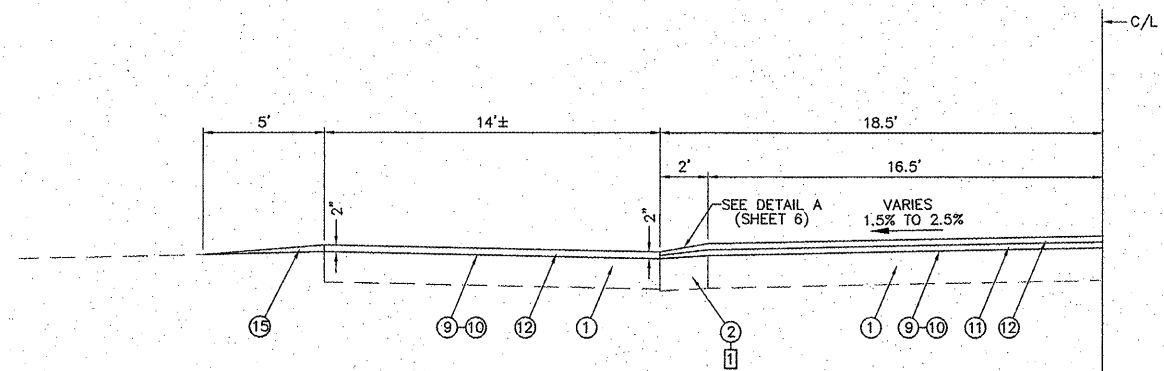

**PROPOSED TYPICAL SECTION  
AT SIDE ROAD  
JOB ST. (LEFT)**

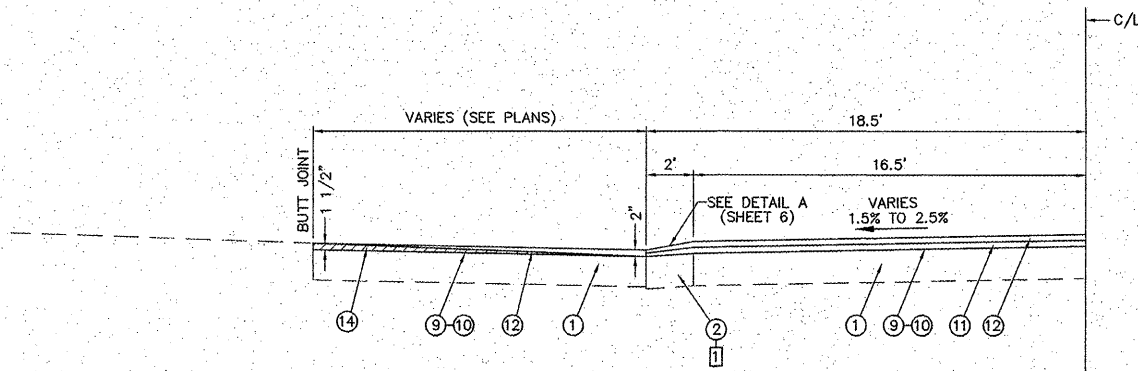

**PROPOSED TYPICAL SECTION  
AT SIDE ROAD  
CHURCH ST. (LEFT)  
CHURCH ST. (RIGHT)**

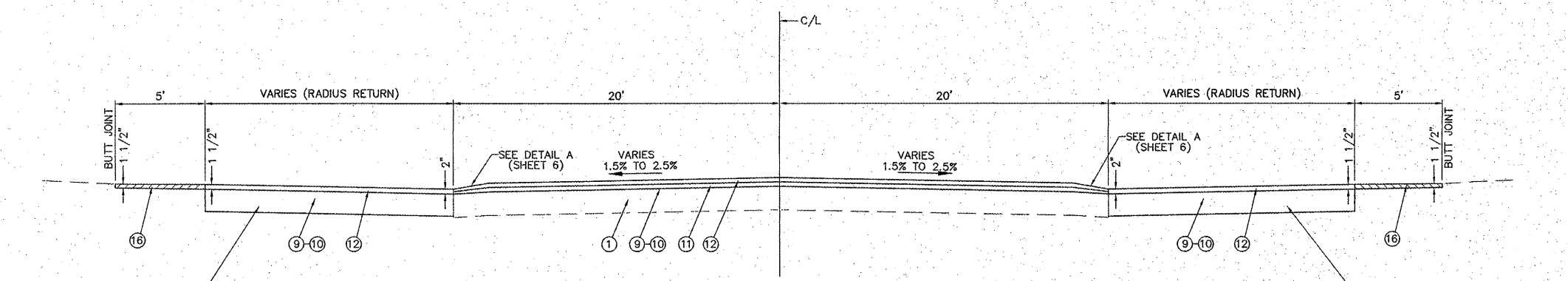

**PROPOSED TYPICAL SECTION  
AT SIDE ROAD  
PENCE ST. (LEFT & RIGHT)**

**TYPICAL SECTION NOTES**

- 1 SEE PLANS FOR LOCATIONS TO BE REMOVED AND REPLACED.
- 2 TIE BARS THAT ARE PLACED IN CONCRETE SHALL BE 30" LONG AT 30" CENTERS. TIE BARS THAT ARE DRILLED AND GROUTED SHALL BE 24" LONG AT 24" CENTERS.

**PAVING LEGEND**

- 1 EXISTING P.C.C. PAVEMENT, 7 1/2"
- 2 EXISTING COMBINATION CONCRETE CURB AND GUTTER
- 3 EXISTING CONCRETE CURB (DOWELED)
- 4 EXISTING HOT-MIX ASPHALT SURFACE, 1 3/4"
- 5 EXISTING P.C.C. SIDEWALK, 4"
- 6 EXISTING P.C.C. PAVEMENT WIDENING, 9"
- 7 EXISTING P.C.C. PAVEMENT WIDENING, 8"
- 8 PROPOSED HMA SURFACE REMOVAL, 1-3/4"
- 9 PROPOSED BITUMINOUS MATERIALS (PRIME COAT)
- 10 PROPOSED AGGREGATE (PRIME COAT)
- 11 PROPOSED LEVELING BINDER (MACHINE METHOD)
- 12 PROPOSED HMA SURFACE COURSE
- 13 PROPOSED P.C.C. SIDEWALK, 4"
- 14 PROPOSED P.C.C. SURFACE REMOVAL - BUTT JOINT
- 15 PROPOSED AGGREGATE SURFACE COURSE, TYPE B (WEDGE)
- 16 PROPOSED HMA SURFACE REMOVAL - BUTT JOINT
- 17 PROPOSED H-E-S P.C.C. BASE COURSE WIDENING 8"
- 18 PROPOSED COMBINATION CONCRETE CURB AND GUTTER, TYPE B (SPECIAL)
- 19 PROPOSED SUBBASE GRANULAR MATERIAL, TYPE A 4"
- 20 PROPOSED 1/2" WIDE EXPANSION JOINT
- 21 PROPOSED INCIDENTAL HMA SURFACING (8")
- 22 PROPOSED CONCRETE CURB, TYPE B
- 23 No. 6 TIE BARS SEE NOTE 2

REVISIONS

**SMS ENGINEERS**  
**Sheppard, Morgan & Schwaab, Inc.**  
 CONSULTING ENGINEERS AND LAND SURVEYORS  
 215 Walnut Street, P.O. Box E, Alton, IL 62002 618-662-9755 E-mail: mms@smsengineers.com  
 40 Central Industrial Drive, Danmoxie, Ill. 62040 618-677-4700 E-mail: mms@smsengineers.com  
 DESIGN FIRM # 184-00392

VILLAGE OF EAST ALTON, ILLINOIS  
 SECTION 08-00045-00-PV  
 MAIN ST. - PHASE 2  
 PROPOSED TYPICAL SECTIONS AT SIDE ROADS

DWG. NO.	EA MAIN ST. PHS 2 SIDEROADS.DWG
REF. BY:	PG.
JOB NO.	227B32.1
DSN. BY:	DEG
DWN. BY:	CAD
CHK. BY:	DEG
DATE:	DEC, 2011
SCALE:	NO SCALE
SHEET	7 OF 17

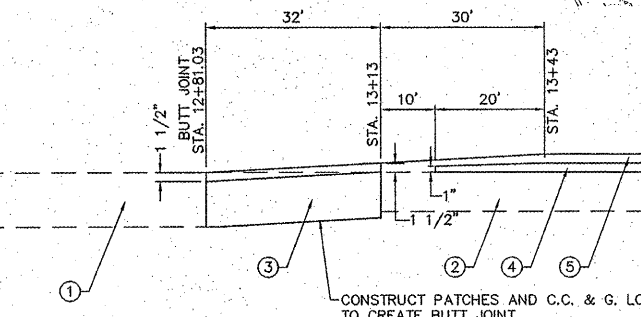
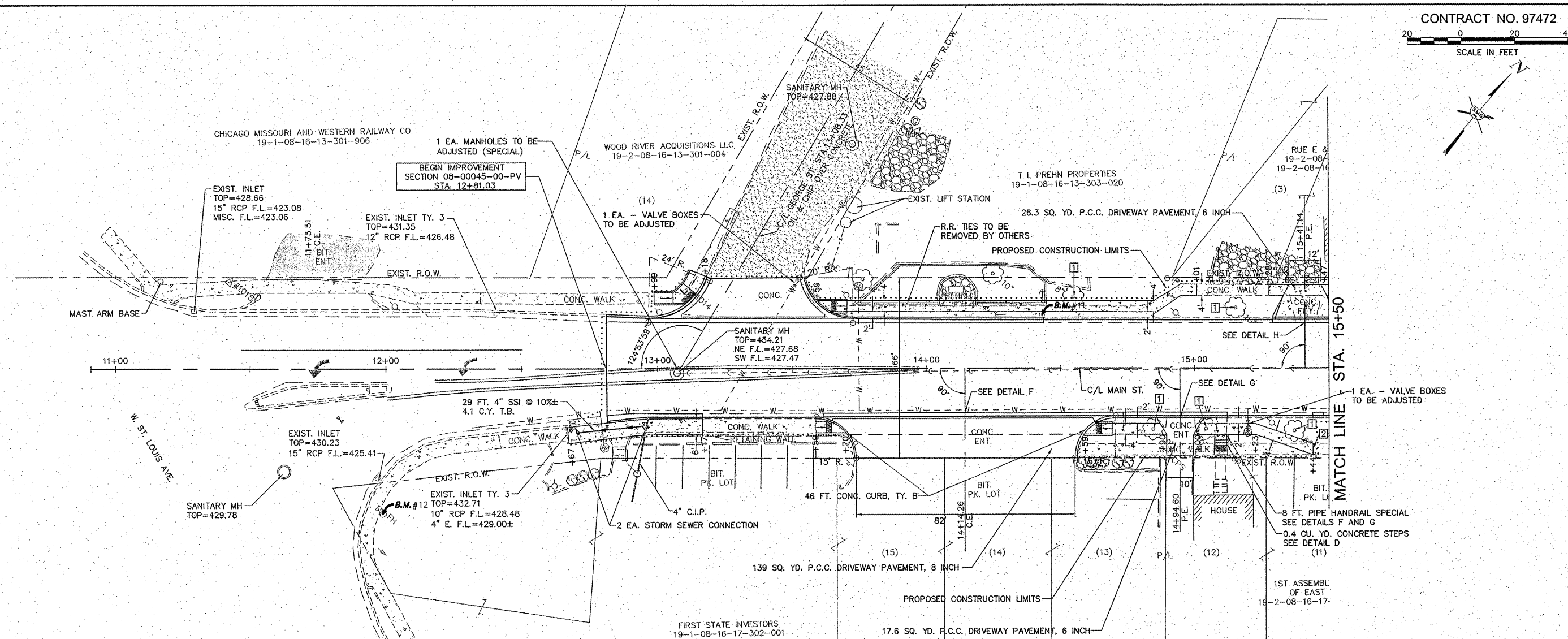
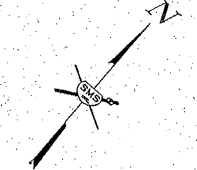

- BUTT JOINT DETAIL**  
 MAIN ST. STA. 12+81.03 TO STA. 13+43
- ① EXISTING P.C.C. PAVEMENT
  - ② EXISTING P.C.C. PAVEMENT, 7 1/2"
  - ③ PROPOSED CLASS B PATCHES, 8"
  - ④ PROPOSED HMA LEVELING BINDER, 1-1/2"
  - ⑤ PROPOSED HMA SURFACE COURSE, 1-1/2"

**OTHER QUANTITIES**  
 (TOTAL THIS SHEET)

- 1,368 SQ. FT. P.C.C. SIDEWALK 4 INCH
- 43 SQ. FT. DETECTABLE WARNINGS
- 305 FOOT C.C.C. & G., TYPE B (SPECIAL)

- NOTES:
- ① TREE TO BE REMOVED BY OTHERS
  - ② SIDEWALK PROFILE GRADE NOT TO EXCEED 5.0%

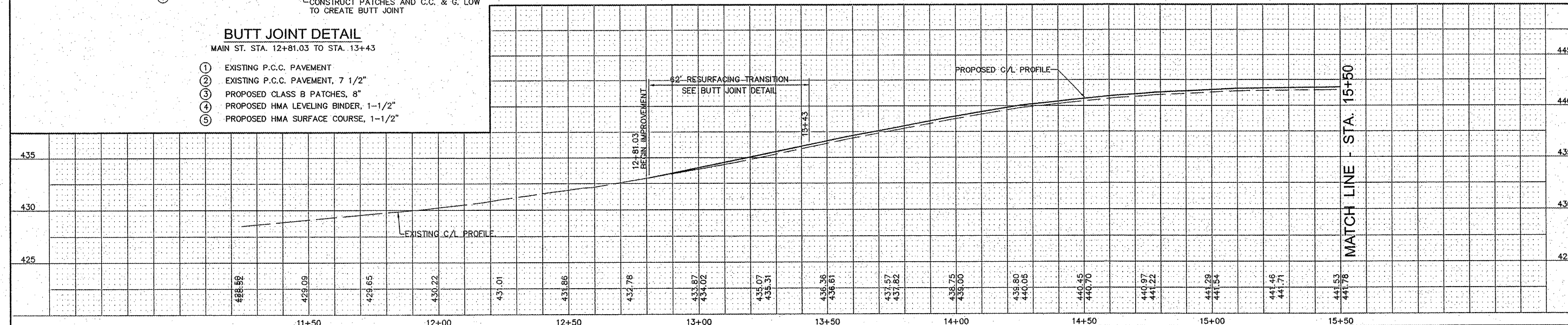

REVISIONS

**SMS ENGINEERS**  
 Sheppard, Morgan & Schwaab, Inc.  
 CONSULTING ENGINEERS AND LAND SURVEYORS  
 215 Market Street, P.O. Box E, Alton, IL 62002 618-942-9755 E-mail: mail@smsengineers.com  
 10 Central Industrial Drive, Suite 3, Granite City, IL 62040 618-977-5700 E-mail: mail@smsengineers.com  
 DESIGN FIRM # 184-000992

VILLAGE OF EAST ALTON, ILLINOIS  
 SECTION 08-00045-00-PV  
 MAIN STREET - PHASE 2  
 PLAN AND PROFILE



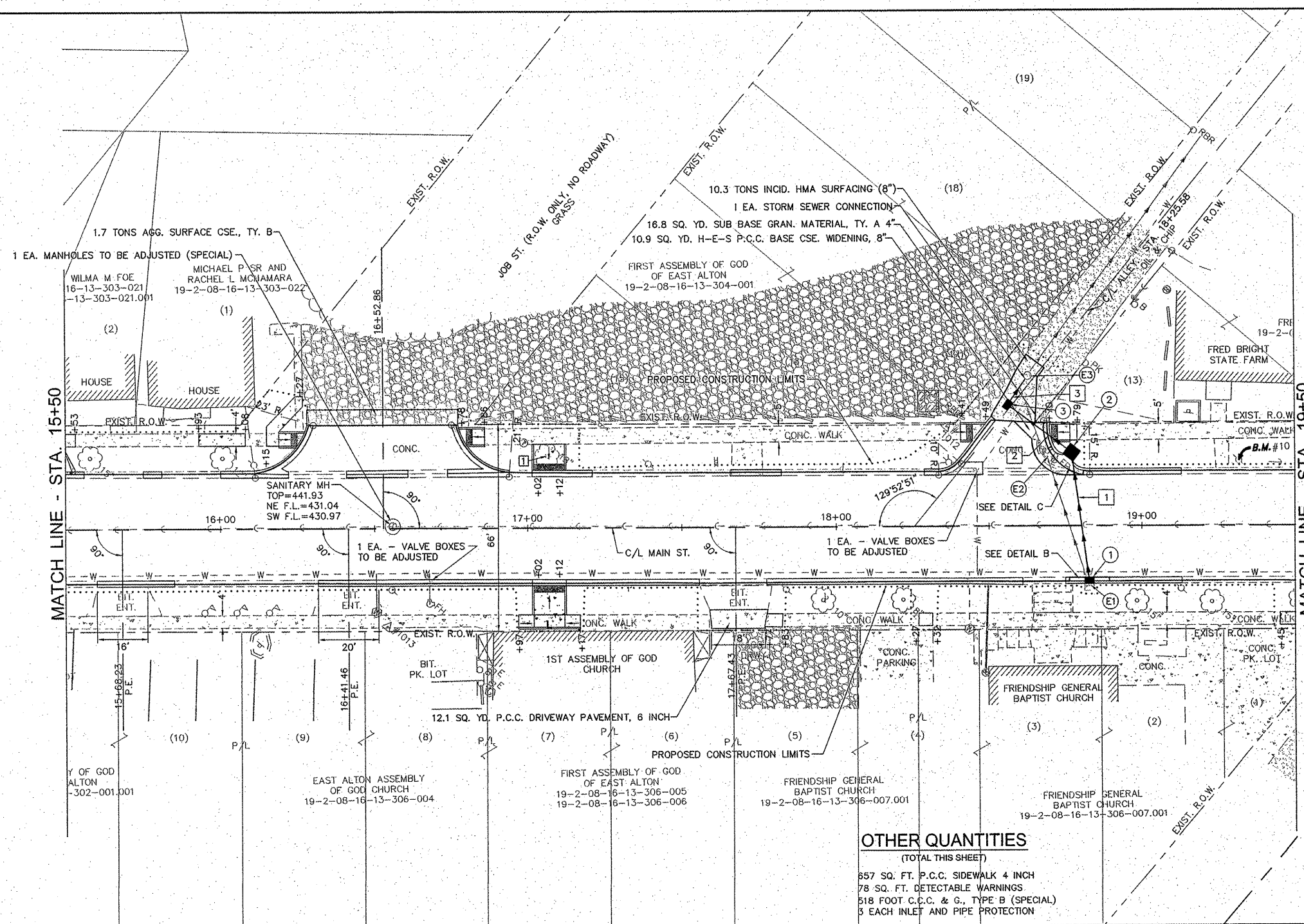
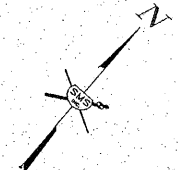

**DRAINAGE STRUCTURES**

- ① INLET, TY. A-3  
 STA. 18+82.77, 17.46' RT.  
 T.C. = 441.04  
 12" N.W. F.L. = 437.50
- ② INLET BOX, SPECIAL  
 STA. 18+77.15, 23.46' LT.  
 T.C. = 440.34  
 12" S.E. F.L. = 437.32  
 12" W. F.L. = 437.22
- ③ INLET, TY. B-1, OPEN LID  
 STA. 18+56.28, 38.60' LT.  
 RIM = 440.50  
 12" E. F.L. = 437.10  
 12" N. F.L. = 437.00
- ⓔ1 1 EA. REMOVING INLETS  
 3' X 3' O.D. INLET  
 TOP=440.94  
 F.L.=437.59
- ⓔ2 1 EA. REMOVING INLETS  
 DAMAGED INLET  
 TOP=440.39  
 S.E. F.L.=437.18  
 N.W. F.L.=437.43
- ⓔ3 EXISTING INLET  
 TOP = 440.14  
 N. F.L. = 436.79  
 12" S. F.L. = 436.95

**STORM SEWERS**

- ① ① TO ② 41 FT. 12" SS1 WMQ @ 0.45%  
 5.7 CU. YD. CLSM
- ② ② TO ③ 26 FT. 12" SS1 WMQ @ 0.45%  
 3.6 CU. YD. CLSM
- ③ ③ TO ⓔ3 10 FT. 12" SS1 WMQ @ 0.45%  
 1.7 CU. YD. CLSM

NOTES:  
 [T] TREE TO BE REMOVED BY OTHERS

**OTHER QUANTITIES**  
 (TOTAL THIS SHEET)

857 SQ. FT. P.C.C. SIDEWALK 4 INCH  
 78 SQ. FT. DETECTABLE WARNINGS  
 518 FOOT C.C.C. & G., TYPE B (SPECIAL)  
 5 EACH INLET AND PIPE PROTECTION

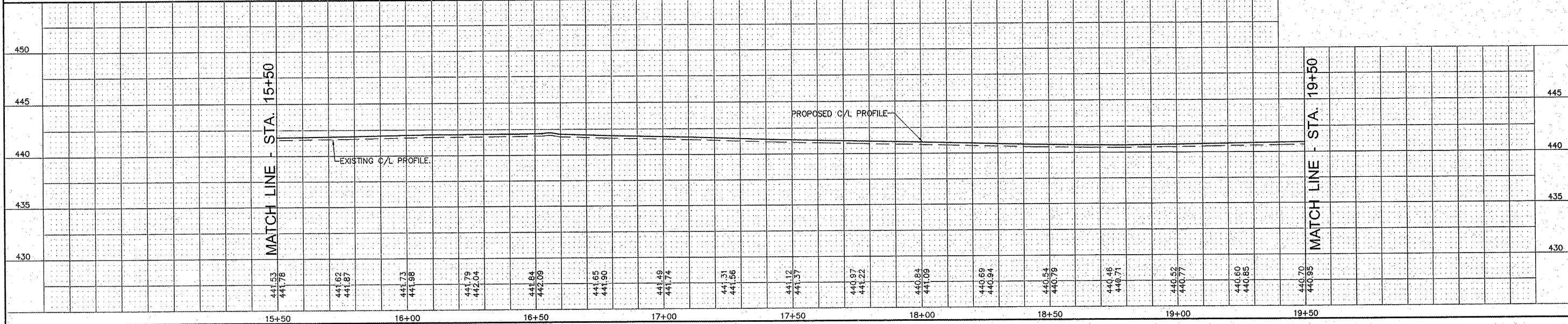

REVISIONS  
 SHEPPARD, MORGAN & SCHWAAB, INC.  
 CONSULTING ENGINEERS AND LAND SURVEYORS  
 215 Market Street, P.O. Box E, Alton, IL 62002, 618/462-2755, E-mail: mail@smsengineers.com  
 10 Central Industrial Drive, Suite 3, Granite City, IL 62040, 618/877-5200, E-mail: mail@smsengineers.com  
 DESIGN FIRM # 184-000992  
**SMS ENGINEERS**  
 VILLAGE OF EAST ALTON, ILLINOIS  
 SECTION 08-00045-00-PV  
 MAIN STREET - PHASE 2  
 PLAN AND PROFILE  
 DWG. NO. EA MAIN ST PHS 2 PP2.DWG  
 REF. BK. PG.  
 JOB NO. 227832.1  
 DSN. BY: DEG  
 DWN. BY: CDP  
 CHR. BY: DEG  
 DATE: DEC. 2011  
 SCALE: 1" = 20' H.  
 1" = 5' V.  
 SHEET 9 OF 17

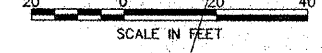

**OTHER QUANTITIES**  
(TOTAL THIS SHEET)

- 2,760 SQ. FT. P.C.C. SIDEWALK 4 INCH
- 116 SQ. FT. DETECTABLE WARNINGS
- 139 FOOT C.C.C. & G., TYPE B (SPECIAL)

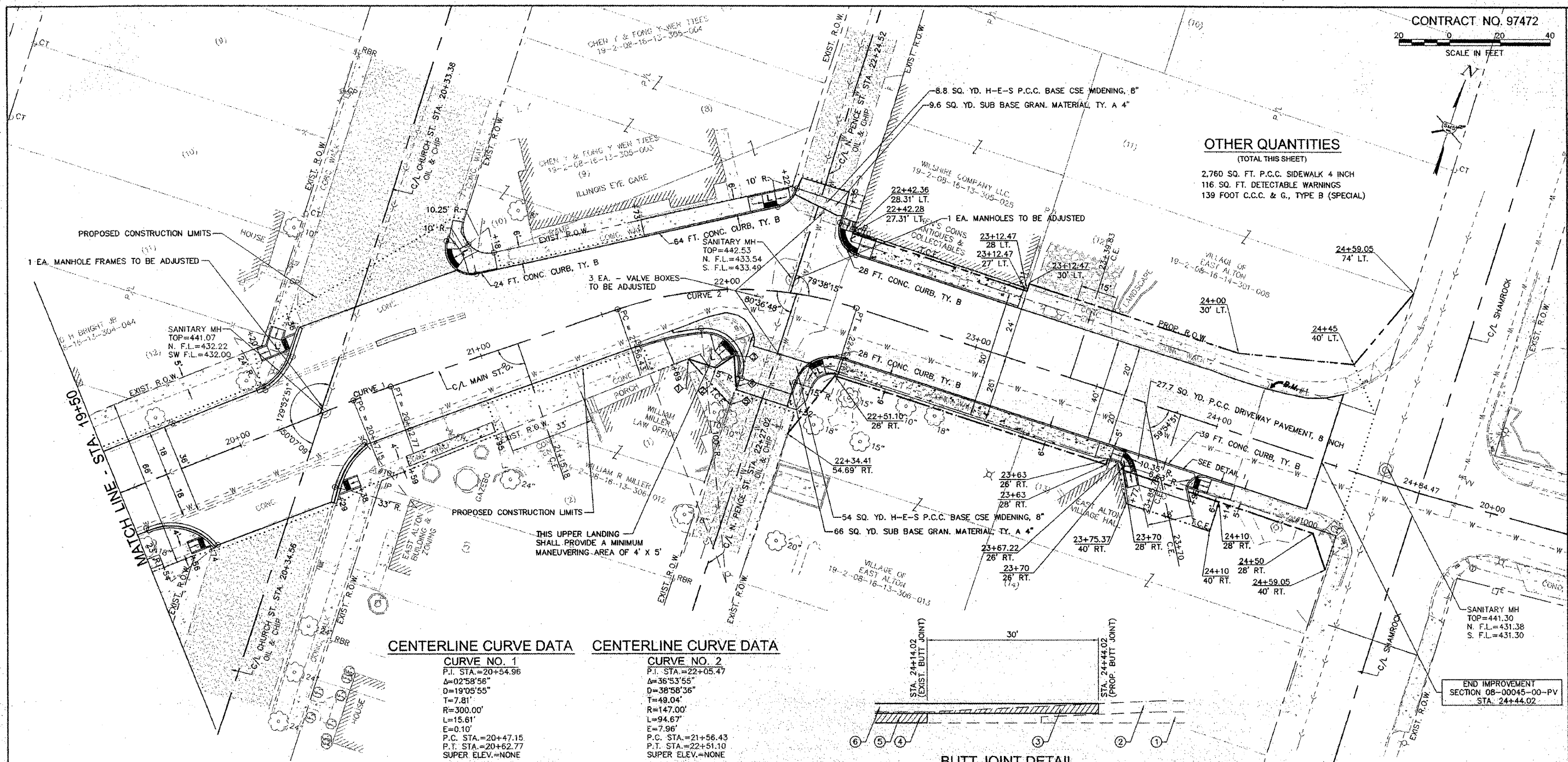

**CENTERLINE CURVE DATA**

CURVE NO. 1	CURVE NO. 2
P.I. STA.=20+54.96	P.I. STA.=22+05.47
Δ=02°58'56"	Δ=36°53'55"
D=19°05'55"	D=38°58'36"
T=7.81'	T=49.04'
R=300.00'	R=147.00'
L=15.61'	L=94.67'
E=0.10'	E=7.96'
P.C. STA.=20+47.15	P.C. STA.=21+56.43
P.T. STA.=20+62.77	P.T. STA.=22+51.10
SUPER ELEV.=NONE	SUPER ELEV.=NONE

**BUTT JOINT DETAIL**

MAIN ST. STA. 24+14.02 TO STA. 24+44.02

- ① EXISTING HMA BINDER, 1-3/4"
- ② EXISTING HMA SURFACE, 1-1/2"
- ③ PROPOSED HMA SURFACE REMOVAL - BUTT JOINT
- ④ PROPOSED HMA SURFACE REMOVAL, 1-3/4"
- ⑤ PROPOSED HMA LEVELING BINDER, 1-1/2"
- ⑥ PROPOSED HMA SURFACE COURSE, 1-1/2"

END IMPROVEMENT SECTION 08-00045-00-PV STA. 24+44.02

PROPOSED RIGHT-OF-WAY STATION / OFFSET

① STA. 21+80.41, 25.58' RT.
② STA. 21+93.05, 30.44' RT.
③ STA. 22+02.12, 26.03' RT.
④ STA. 22+02.86, 38.22' RT.
⑤ STA. 21+99.43, 45.16' RT.

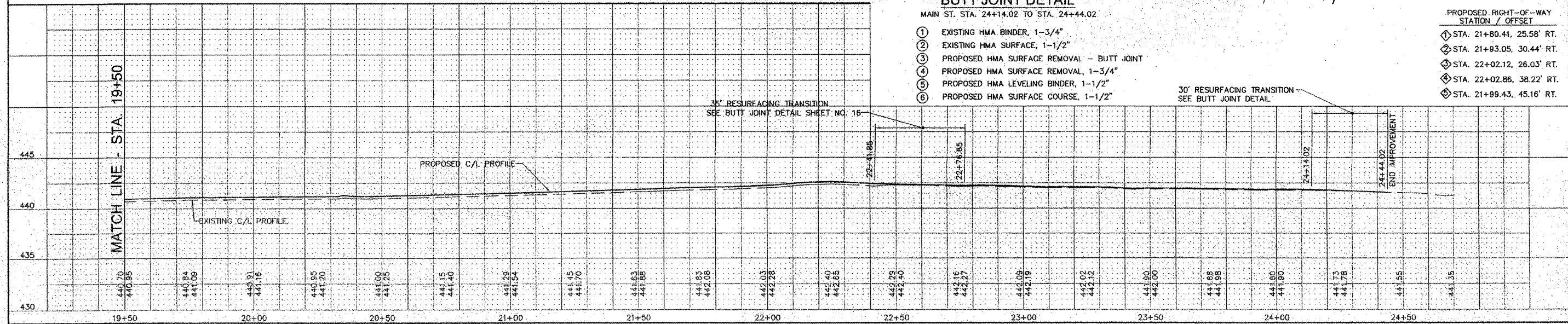

REVISIONS

NO.	DESCRIPTION

**SMS ENGINEERS**  
Sheppard, Morgan & Schwaab, Inc.  
CONSULTING ENGINEERS AND LAND SURVEYORS

100 North Street, P.O. Box 4, East Alton, Illinois 62024  
Tel: 618-242-1234 Fax: 618-242-1235 E-mail: sms@smsengineers.com  
100 North Street, P.O. Box 4, East Alton, Illinois 62024  
Tel: 618-242-1234 Fax: 618-242-1235 E-mail: sms@smsengineers.com  
DESIGN FIRM # 184-000892

VILLAGE OF EAST ALTON, ILLINOIS  
SECTION 08-00045-00-PV  
MAIN STREET - PHASE 2  
PLAN AND PROFILE

DWG. NO. EX MAIN ST PHS 2 PPS.DWG  
REV. BY: PC  
JOB NO. 227832.1  
DSN. BY: DEG  
DWN. BY: CDP  
CHK. BY: DEG  
DATE: DEC. 2011  
SCALE: 1" = 20' H.  
1" = 5' V.  
SHEET 10 OF 17

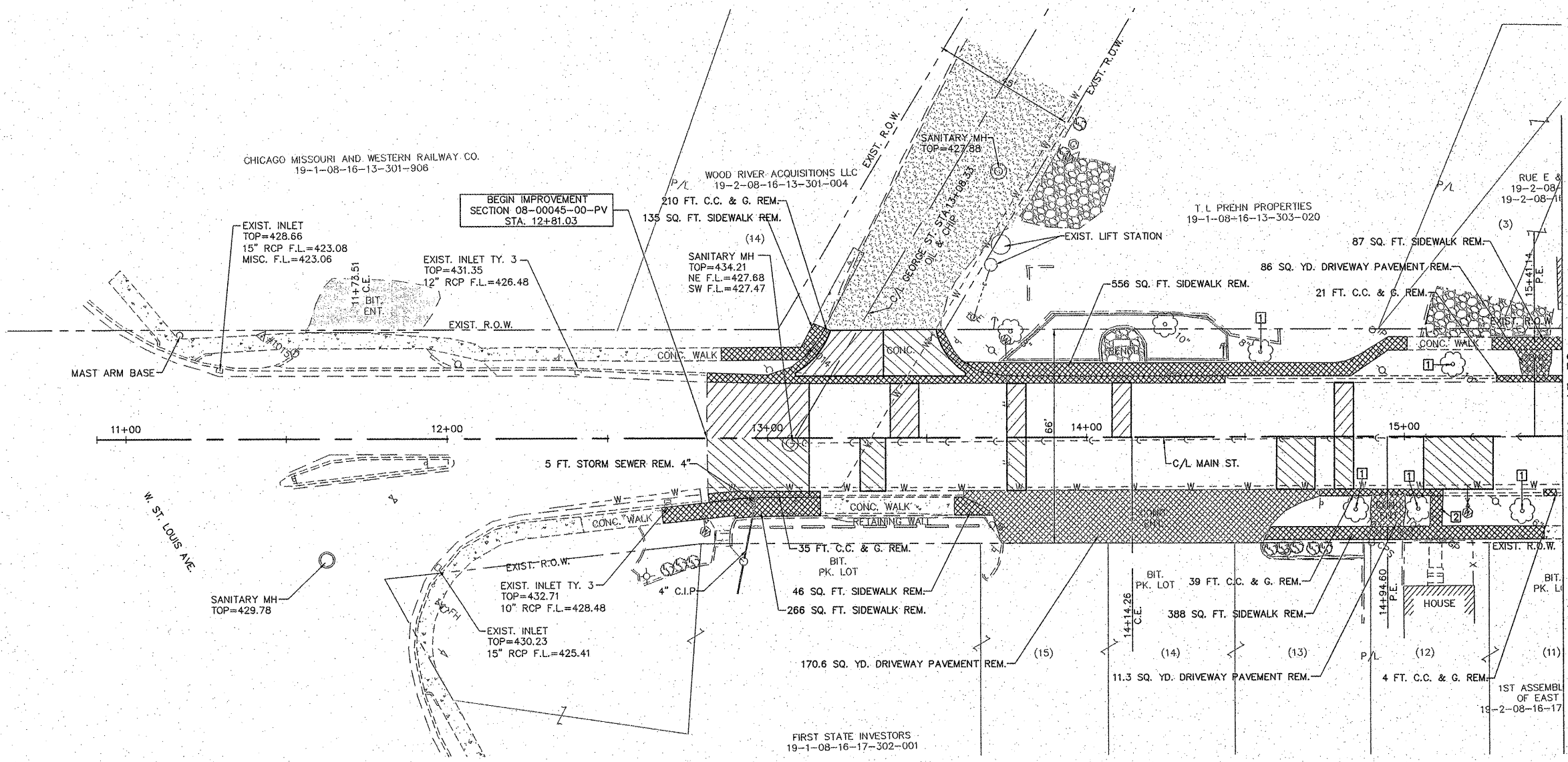
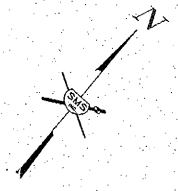

---DENOTES PAVEMENT PATCHES  
 SEE SHEET 3 FOR PATCHING SCHEDULE

- NOTES:  
 [1] TREE TO BE REMOVED BY OTHERS  
 [2] EXISTING CONCRETE STEP TO BE REMOVED AND INCLUDED IN THE COST OF SIDEWALK REMOVAL

REVISIONS

**SMS ENGINEERS**  
 Sheppard, Morgan & Schwaab, Inc.  
 CONSULTING ENGINEERS AND LAND SURVEYORS  
 216 Marquette Street, P.O. Box E, Alton, IL 62002 618/462-9755 E-mail: mail@smsengineers.com  
 10 Central Industrial Drive, Suite 3, Granite City, IL 62040 618/877-8700 E-mail: mail@smsengineers.com  
 DESIGN FIRM # 184-000892

VILLAGE OF EAST ALTON, ILLINOIS  
 SECTION 08-00045-00-PV  
 MAIN STREET - PHASE 2  
 REMOVAL ITEMS

DWG. NO.	EA MAIN ST PHIS 2 REMOVAL 1.DWG
REF. BK.	PG.
JOB NO.	227832.1
DSN. BY:	DEC
DWN. BY:	CDP
CHK. BY:	DEC
DATE:	DEC., 2011
SCALE:	1" = 20' H. 1" = 5' V.
SHEET	11 OF 17

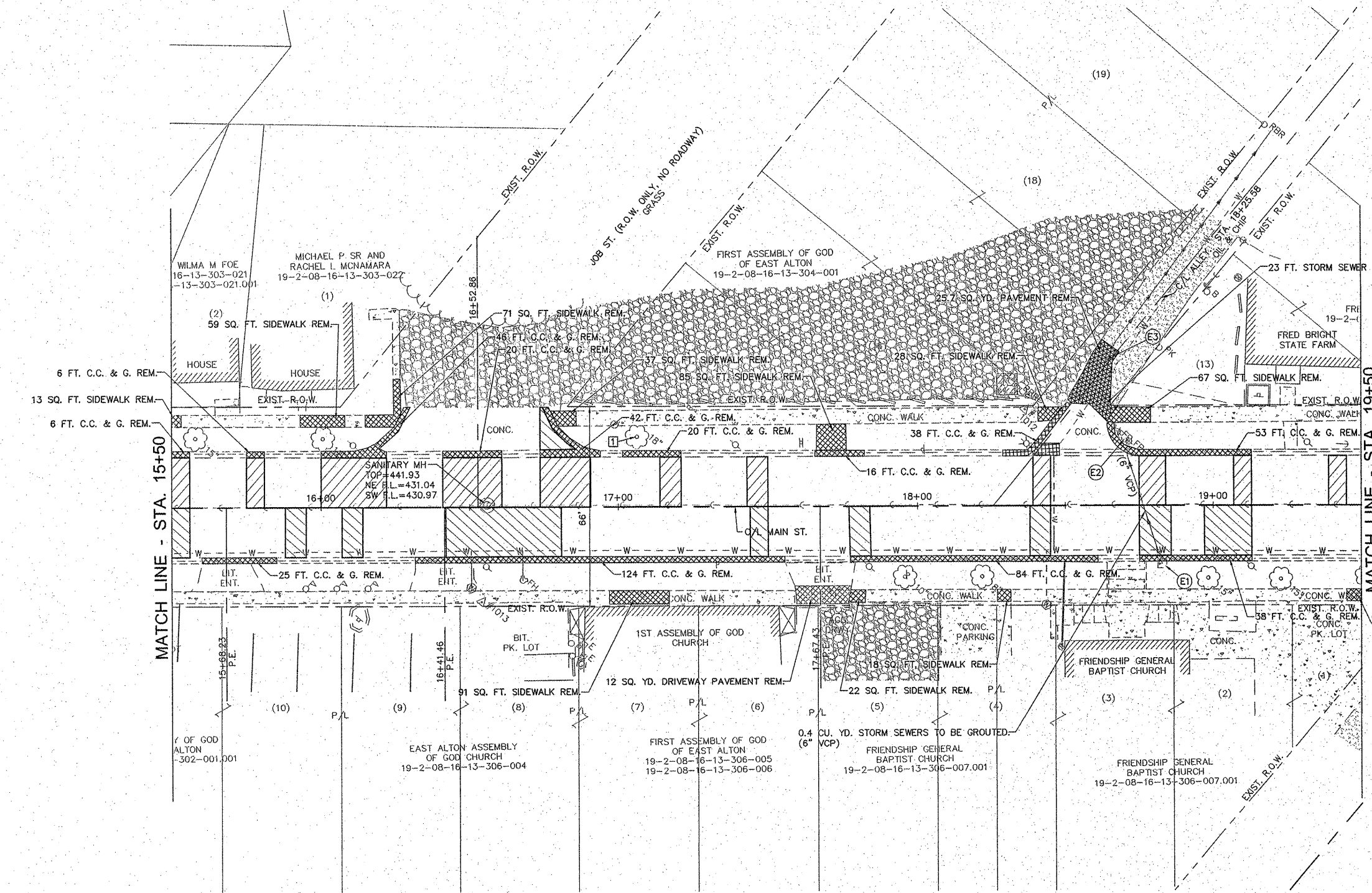
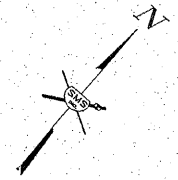

**DRAINAGE STRUCTURES**

- (E1) 1 EA. REMOVING INLETS  
3' X 3' O.D. INLET  
TOP=440.94  
F.L.=437.59
- (E2) 1 EA. REMOVING INLETS  
DAMAGED INLET  
TOP=440.39  
S.E. F.L.=437.18  
N.W. F.L.=437.43
- (E3) EXISTING INLET  
TOP = 440.14  
N. F.L. = 436.79

MATCH LINE - STA. 19+50

MATCH LINE - STA. 15+50

---DENOTES PAVEMENT PATCHES  
SEE SHEET 3 FOR PATCHING SCHEDULE

NOTES:  
[1] TREE TO BE REMOVED BY OTHERS

NO.	REVISIONS

**SMS ENGINEERS**  
**Sheppard, Morgan & Schwaab, Inc.**  
 CONSULTING ENGINEERS AND LAND SURVEYORS  
 215 Market Street, P.O. Box E, Alton, IL 62002 618462-9755 E-mail: mail@smsengineers.com  
 10 Central Industrial Drive, Suite 3, Granite City, IL 62040 618877-9700 E-mail: mail@smsengineers.com  
 DESIGN FIRM # 184-000992

VILLAGE OF EAST ALTON, ILLINOIS  
 SECTION 08-00045-00-PV  
 MAIN STREET - PHASE 2  
 REMOVAL ITEMS

DWG. NO.	EA MAIN ST PH2 2 REMOVAL 2.DWG
REF. BK.	PG.
JOB NO.	227832.1
DSN. BY:	DEG
DWN. BY:	CDP
CHK. BY:	DEG
DATE:	DEC, 2011
SCALE:	1" = 20' H. 1" = 5' V.
SHEET	12 OF 17

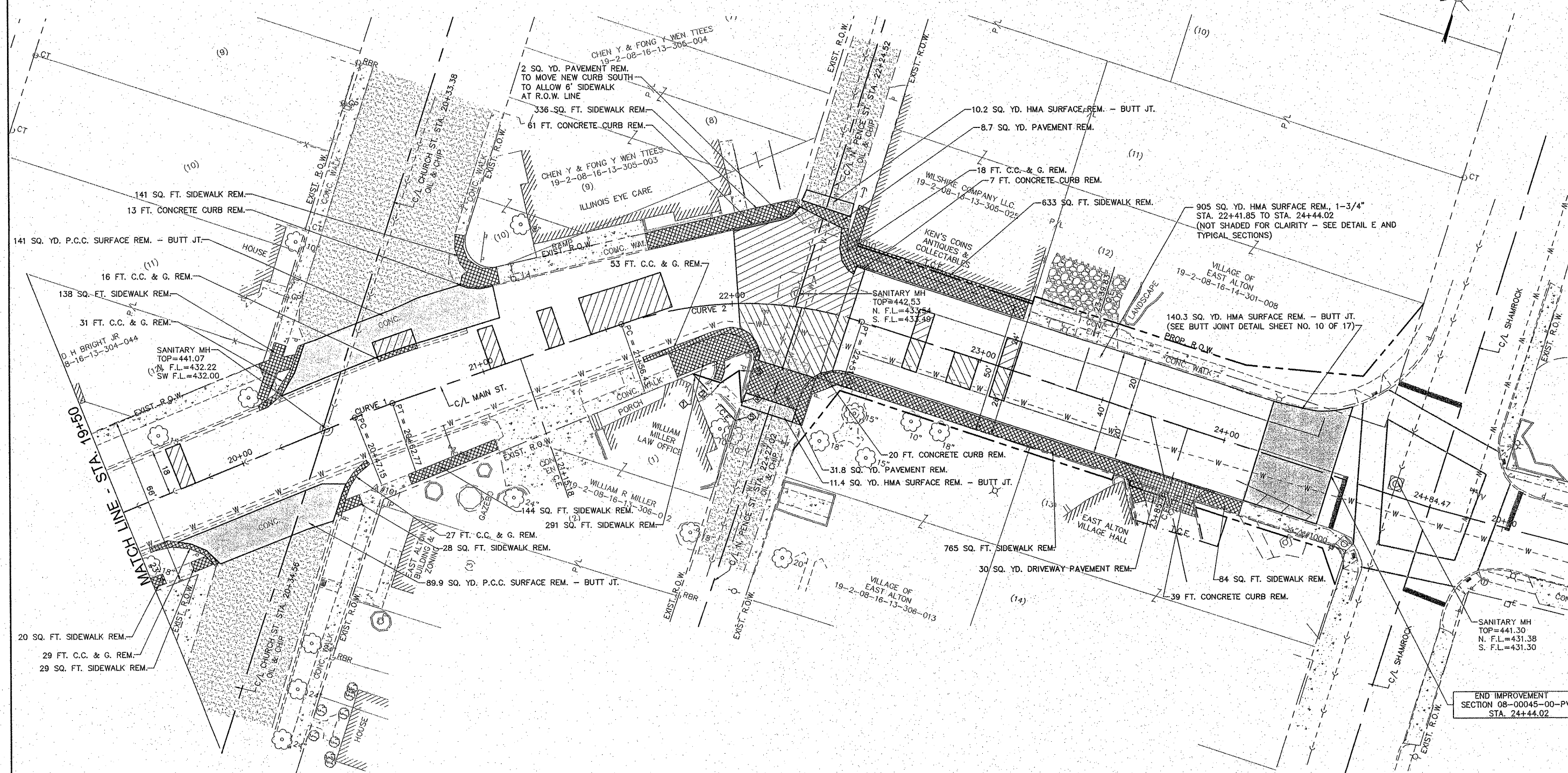

CENTERLINE CURVE DATA		CENTERLINE CURVE DATA	
<b>CURVE NO. 1</b>	<b>CURVE NO. 2</b>	<b>CURVE NO. 1</b>	<b>CURVE NO. 2</b>
P.T. STA.=20+54.96	P.T. STA.=22+05.47	P.T. STA.=20+54.96	P.T. STA.=22+05.47
Δ=02°58'56"	Δ=36°53'55"	Δ=02°58'56"	Δ=36°53'55"
D=19°05'55"	D=38°58'36"	D=19°05'55"	D=38°58'36"
T=7.81'	T=49.04'	T=7.81'	T=49.04'
R=300.00'	R=147.00'	R=300.00'	R=147.00'
L=15.61'	L=94.67'	L=15.61'	L=94.67'
E=0.10'	E=7.96'	E=0.10'	E=7.96'
P.C. STA.=20+47.15	P.C. STA.=21+56.43	P.C. STA.=20+47.15	P.C. STA.=21+56.43
P.T. STA.=20+62.77	P.T. STA.=22+51.10	P.T. STA.=20+62.77	P.T. STA.=22+51.10
SUPER ELEV.=NONE	SUPER ELEV.=NONE	SUPER ELEV.=NONE	SUPER ELEV.=NONE

▨ - DENOTES PAVEMENT PATCHES  
 SEE SHEET 3 FOR PATCHING SCHEDULE

PROPOSED RIGHT-OF-WAY STATION / OFFSET	
⊕ STA. 21+80.41, 25.58' RT.	
⊕ STA. 21+93.05, 30.44' RT.	
⊕ STA. 22+02.12, 26.03' RT.	
⊕ STA. 22+02.86, 38.22' RT.	
⊕ STA. 21+99.43, 45.16' RT.	

REVISIONS	
<b>SMS</b> Sheppard, Morgan & Schwaab, Inc. CONSULTING ENGINEERS AND LAND SURVEYORS 215 Market Street, P.O. Box E, Alton, IL 62002 618462-9755 E-mail: mail@smsengineers.com 10 Central Industrial Drive, Suite 3, Granite City, IL 62040 618677-8700 E-mail: mail@smsengineers.com DESIGN FIRM # 184-000992	
<b>ENGINEERS</b>	
VILLAGE OF EAST ALTON, ILLINOIS SECTION 08-00045-00-PV MAIN STREET - PHASE 2 REMOVAL ITEMS	
DWG. NO.	EA MAIN ST PHS 2 REMOVAL 3.DWG
REF. BK.	PG.
JOB NO.	227832.1
DES. BY:	DEG
DWN. BY:	CDP
CHK. BY:	DEG
DATE:	DEC., 2011
SCALE:	1" = 20' H. 1" = 5' V.
SHEET	13 OF 17

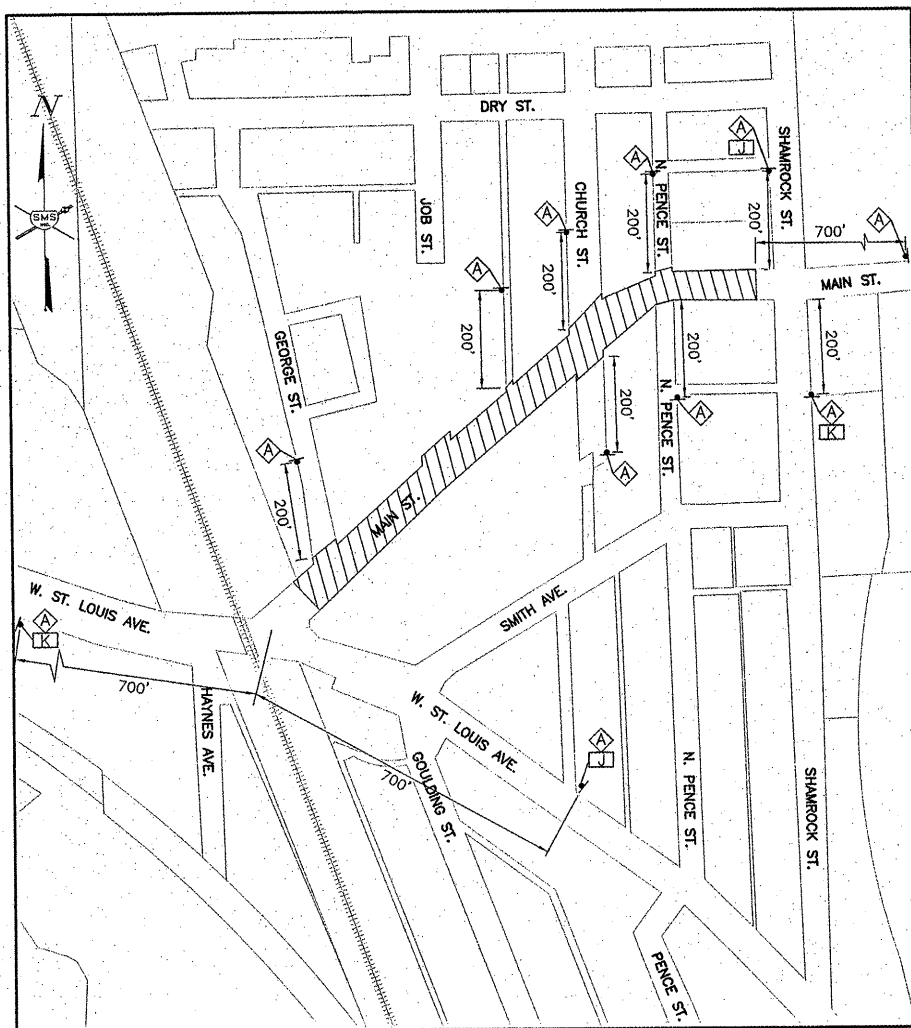

GENERAL TRAFFIC CONTROL PLAN

SCALE: 1"=200'

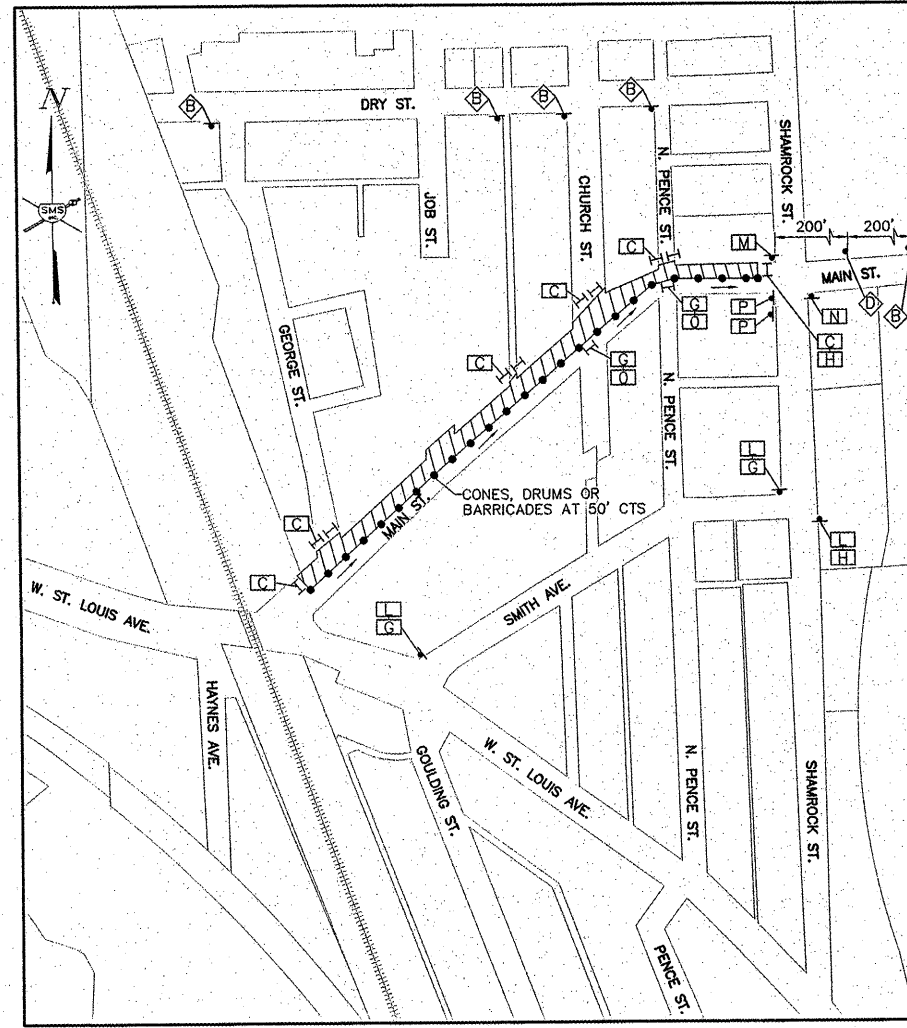
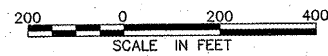

DETOUR PLAN - WEST BOUND TRAFFIC LANE

SCALE: 1"=200'

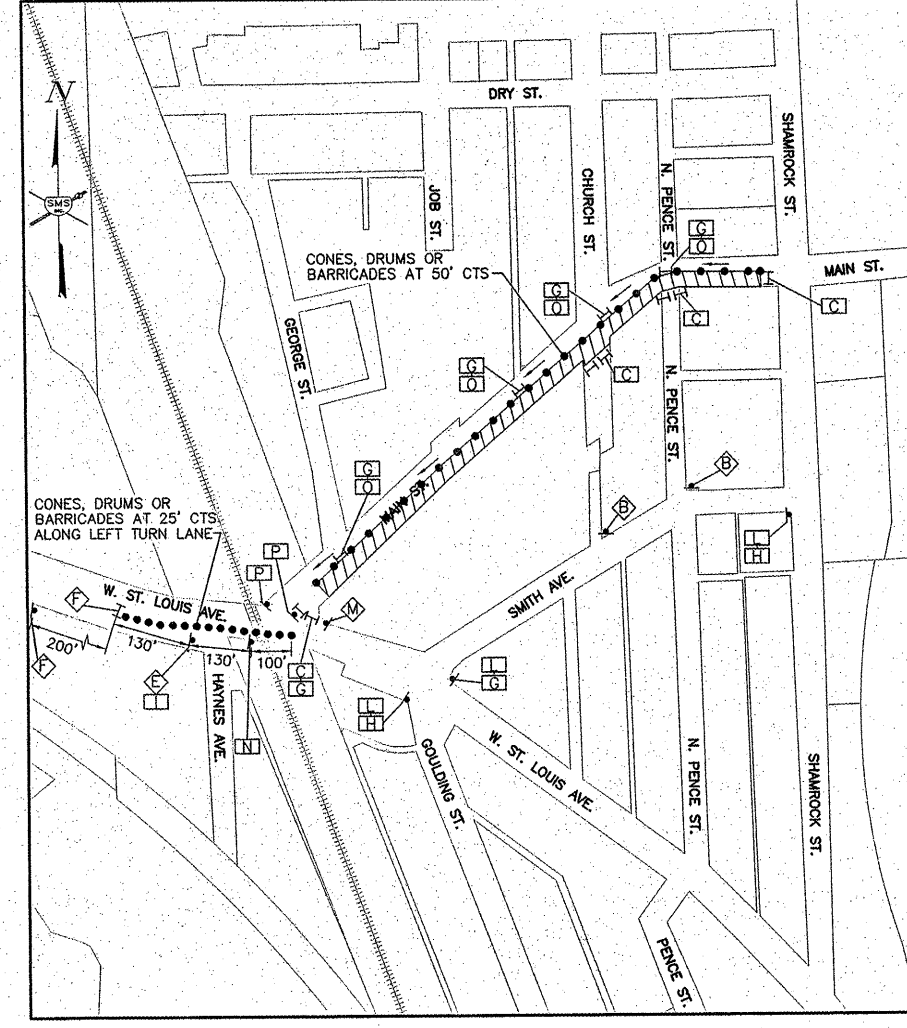

DETOUR PLAN - EAST BOUND TRAFFIC LANE

SCALE: 1"=200'

TRAFFIC CONTROL LEGEND

- WORK AREA
- TYPE III BARRICADE WITH REFLECTORIZED STRIPING ON BOTH SIDES WITH FLASHING LIGHTS
- CONE, DRUM OR BARRICADE
- SIGN "ROAD CONSTRUCTION AHEAD" W20-1(0) - 48" x 48" WITH MONODIRECTIONAL FLASHING LIGHT
- SIGN "ROAD CLOSED AHEAD" W20-3 48" x 48"
- SIGN "ROAD CLOSED" R11-2 48" x 30"
- SIGN "DETOUR AHEAD"
- SIGN "MAIN ST. CLOSED" BLACK LETTERS ON ORANGE BACKGROUND 48" x 48"
- SIGN "LEFT TURN LANE CLOSED AHEAD" BLACK LETTERS ON ORANGE BACKGROUND 48" x 48"
- SIGN M4-9R 30" x 24"
- SIGN M4-9L 30" x 24"
- SIGN BLACK LETTERS ON ORANGE BACKGROUND 30" x 24"
- SIGN BLACK ARROW ON ORANGE BACKGROUND 24" x 18"
- SIGN BLACK ARROW ON ORANGE BACKGROUND 24" x 18"
- SIGN "MAIN STREET" BLACK LETTERS ON ORANGE BACKGROUND 24" x 24"
- SIGN (NO RIGHT TURN) R3-1 24" x 24"
- SIGN (NO LEFT TURN) R3-2 24" x 24"
- SIGN "ONE WAY" R6-1 36" x 12"
- SIGN "DO NOT ENTER" R5-1 30" x 30"

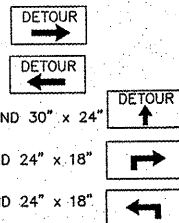

TRAFFIC CONTROL NOTES

1. THE CONTRACTOR SHALL PROVIDE THE TRAFFIC CONTROL SHOWN ON THE GENERAL TRAFFIC CONTROL PLAN AT ALL TIMES DURING THE CONSTRUCTION OF THIS PROJECT. ADDITIONAL TRAFFIC CONTROL SHALL BE PROVIDED AS SPECIFIED BELOW AND IN ACCORDANCE WITH THE SPECIFIED HIGHWAY STANDARDS.
2. AT TIMES WHEN ALL TRAFFIC LANES ARE OPEN, PROVIDE TRAFFIC CONTROL AS NEEDED PER HIGHWAY STANDARD 701006 OR 701011.
3. ONE TRAFFIC LANE ON MAIN STREET WILL BE ALLOWED TO BE CLOSED AS NEEDED DURING DAY TIME HOURS AS DESCRIBED BELOW:
  - A. FOR SPOT LOCATIONS THAT ARE LESS THAN 1 BLOCK LONG AND FOR 1 HOUR OR LESS, PROVIDE TRAFFIC CONTROL PER HIGHWAY STANDARD 701301.
  - B. FOR SPOT LOCATIONS THAT ARE LESS THAN 1 BLOCK LONG AND MORE THAN 1 HOUR, PROVIDE TRAFFIC CONTROL PER HIGHWAY STANDARD 701501 OR USE ONE OF THE TRAFFIC DETOUR PLANS.
  - C. FOR PATCHING, PAVING AND OTHER OPERATIONS THAT REQUIRE ONE LANE TO BE CLOSED FOR A LENGTH OF MORE THAN ONE BLOCK, PROVIDE TRAFFIC CONTROL PER ONE OF THE TRAFFIC DETOUR PLANS.
  - D. THE EAST ALTON STREET DEPT. WILL POST TEMPORARY "NO PARKING" SIGNS AS NEEDED TO PREVENT PARKING IN WORK AREAS. THE CONTRACTOR SHALL NOTIFY THE STREET DEPT. 2 DAYS IN ADVANCE OF THE NEED FOR "NO PARKING SIGNS".
  - E. DURING PAVEMENT PATCHING OPERATIONS, THE CONTRACTOR SHALL PROVIDE ADDITIONAL CONES, DRUMS OR BARRICADES TO PROTECT EACH PATCH.
4. SIDE STREETS AND ALLEYS MAY BE CLOSED TO ALL TRAFFIC AS NEEDED, WITH THE FOLLOWING TRAFFIC CONTROL:
  - A. PROVIDE A "ROAD CLOSED AHEAD" SIGN W20-3 48" x 48" AT THE INTERSECTION OF DRY ST. FOR SIDE STREETS AND ALLEYS TO THE NORTH AND AT SMITH STREET FOR SIDE STREETS AND ALLEYS TO THE SOUTH.
  - B. PROVIDE A MINIMUM OF TWO TYPE III BARRICADES WITH REFLECTORIZED STRIPING ON BOTH SIDES AND FLASHING LIGHTS IMMEDIATELY IN ADVANCE OF THE CLOSURE AND ALONG MAIN STREET.
  - C. PROVIDE A "ROAD CLOSED" SIGN R11-2 48" x 30" ON ONE OF THE TYPE III BARRICADES ON EACH SIDE OF THE CLOSURE.
5. FOR SIDEWALK REMOVAL AND REPLACEMENT, TRAFFIC CONTROL FOR SIDEWALK CLOSURES SHALL BE PROVIDED PER HIGHWAY STANDARD 701801. SIDEWALK REMOVAL AND REPLACEMENT SHALL BE SEQUENCED AS NEEDED TO ALWAYS ALLOW AN ACCESSIBLE ROUTE TO PRIVATE PROPERTY AND BUSINESSES.
6. WHERE A HIGHWAY STANDARD REQUIRES A "ROAD CONSTRUCTION AHEAD" SIGN, THIS REQUIREMENT WILL BE CONSIDERED FULFILLED BY THE SIGNS REQUIRED ON THE GENERAL TRAFFIC CONTROL PLAN.
7. ALL HAZARDS WITHIN WORK ZONES OPEN TO TRAFFIC SHALL BE PROTECTED WITH TYPE I BARRICADES OR DRUMS WITH FLASHING LIGHTS IF LESS 100' IN LENGTH IF GREATER THAN 100' IN LENGTH, LIGHTS SHALL BE STEADY BURN.
8. ALL CONSTRUCTION SIGNS SHALL MEET THE REQUIREMENTS OF THE LATEST EDITION OF THE "MANUAL ON UNIFORM TRAFFIC CONTROL DEVICES FOR STREETS AND HIGHWAYS"
9. IF THE CONTRACTOR WISHES TO DEVIATE FROM THIS TRAFFIC CONTROL PLAN, HE SHALL PROVIDE A REVISED TRAFFIC CONTROL PLAN IN WRITING FOR THE REVIEW AND APPROVAL OF THE ENGINEER.

REVISIONS

**SMS ENGINEERS**  
 Sheppard, Morgan & Schwaab, Inc.  
 CONSULTING ENGINEERS AND LAND SURVEYORS  
 215 Market Street, P.O. Box E, Alton, IL 62002 618/462-6755 E-mail: mail@smsengineers.com  
 10 Central Industrial Drive, Granite City, IL 62040 618/877-8700 E-mail: mail@smsengineers.com  
 DESIGN FIRM # 184-000992

VILLAGE OF EAST ALTON, ILLINOIS  
 SECTION 08-00045-00-PV  
 MAIN ST. - PHASE 2  
 TRAFFIC CONTROL PLAN

DWG. NO.	EAST ALTON MAIN ST PH2 TRAFFIC.dwg
REF. BK.	PG.
JOB NO.	227832.1
DSN. BY:	DEC
DWN. BY:	CDP
CHK. BY:	DEC
DATE:	DEC., 2011
SCALE:	1" = 200'
SHEET:	14 OF 17

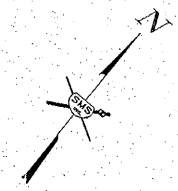

REVISIONS

**SMS ENGINEERS**  
Sheppard, Morgan & Schwaab, Inc.  
CONSULTING ENGINEERS AND LAND SURVEYORS  
215 Market Street, P.O. Box E, Alton, IL 62002 618462-9755 E-mail: mail@smsengineers.com  
10 Central Industrial Drive, Suite 3, Granite City, IL 62040 618877-8100 E-mail: mail@smsengineers.com  
DESIGN FIRM # 184-000992

VILLAGE OF EAST ALTON, ILLINOIS  
SECTION  
MAIN STREET - PHASE 2  
PAVEMENT MARKING AND SIGNING PLAN

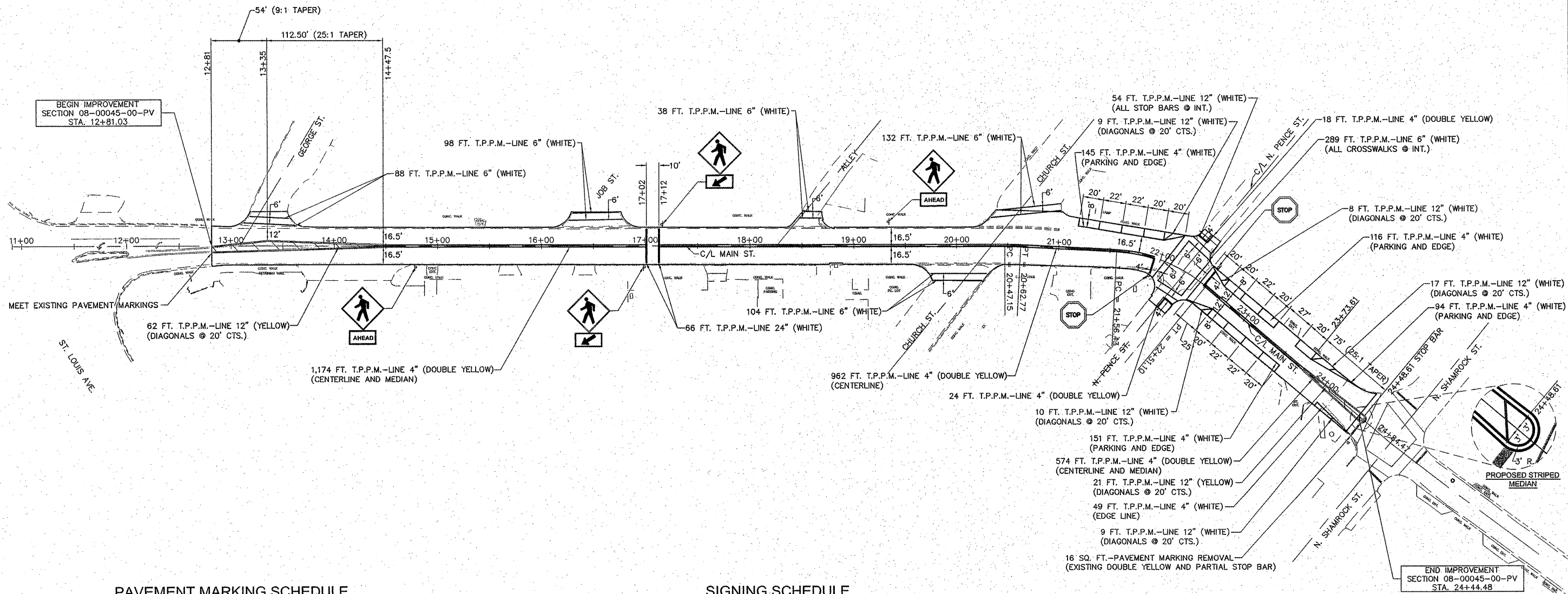

PAVEMENT MARKING SCHEDULE

SIGNING SCHEDULE

ITEM	QUANTITY	UNIT
THERMOPLASTIC PAVEMENT MARKING - LINE 4" (WHITE PARKING AND EDGE LINE)	555	FOOT
THERMOPLASTIC PAVEMENT MARKING - LINE 4" (CENTERLINES AND MEDIANS)	2,710	FOOT
TOTAL 4"	3,265	FOOT
THERMOPLASTIC PAVEMENT MARKING - LINE 6" (WHITE CROSSWALKS)	749	FOOT
TOTAL 6"	749	FOOT
THERMOPLASTIC PAVEMENT MARKING - LINE 12" (YELLOW DIAGONALS)	83	FOOT
THERMOPLASTIC PAVEMENT MARKING - LINE 12" (WHITE DIAGONALS)	53	FOOT
THERMOPLASTIC PAVEMENT MARKING - LINE 12" (WHITE STOP BARS)	54	FOOT
TOTAL 12"	190	FOOT
THERMOPLASTIC PAVEMENT MARKING - LINE 24" (WHITE CROSSWALKS)	66	FOOT
TOTAL 24"	66	FOOT
PAVEMENT MARKING REMOVAL	16	SQ. FT.

LOCATION STATION	LEGEND OR TYPE	MUTCD SIGN DESIGNATION	SIZE	SIGN PANEL - TYPE 1 (SQ. FT.)	TELESCOPING STEEL SIGN SUPPORT (FT.)
14+80 RT.	PEDESTRIAN "AHEAD"	W11-2 W16-9P	30" X 30" 24" X 12"	6.25 2.00	15.5
17+00 RT.	PEDESTRIAN DOWNWARD DIAGONAL ARROW	W11-2 W16-7P	30" X 30" 24" X 12"	6.25 2.00	15.5
17+14 RT.	PEDESTRIAN DOWNWARD DIAGONAL ARROW	W11-2 W16-7P	30" X 30" 24" X 12"	6.25 2.00	15.5
19+34 LT.	PEDESTRIAN "AHEAD"	W11-2 W16-9P	30" X 30" 24" X 12"	6.25 2.00	15.5
21+93.87 RT.	"STOP"	R1-1	30" X 30"	5.20	13.0
22+48.51 LT.	"STOP"	R1-1	30" X 30"	5.20	13.0
TOTALS				43.40	88.0

**NOTES**  
1. THERMOPLASTIC PAVEMENT MARKING IS ABBREVIATED AS T.P.P.M.

REVISIONS

**SMS ENGINEERS**  
 Sheppard, Morgan & Schwab, Inc.  
 CONSULTING ENGINEERS AND LAND SURVEYORS  
 215 Market Street, P.O. Box E, Alton, IL 62002 618462-9755 E-mail: mail@smsengineers.com  
 10 Central Industrial Drive, Granite City, IL 62040 618877-8700 E-mail: mail@smsengineers.com  
 DESIGN FIRM # 184-CC0392

VILLAGE OF EAST ALTON, ILLINOIS  
 SECTION 08-00045-00-PV  
 MAIN ST. - PHASE 2  
 CONSTRUCTION DETAILS

DWG. NO.	EA MAIN ST. PHASE 2 CONST. DETAILS.DWG
REF. BY	PC
JOB NO.	227832.1
DSN. BY	DEG
DWN. BY	CAD
CHK. BY	DEG
DATE	DEC, 2011
SCALE	NO SCALE
SHEET	16 OF 17

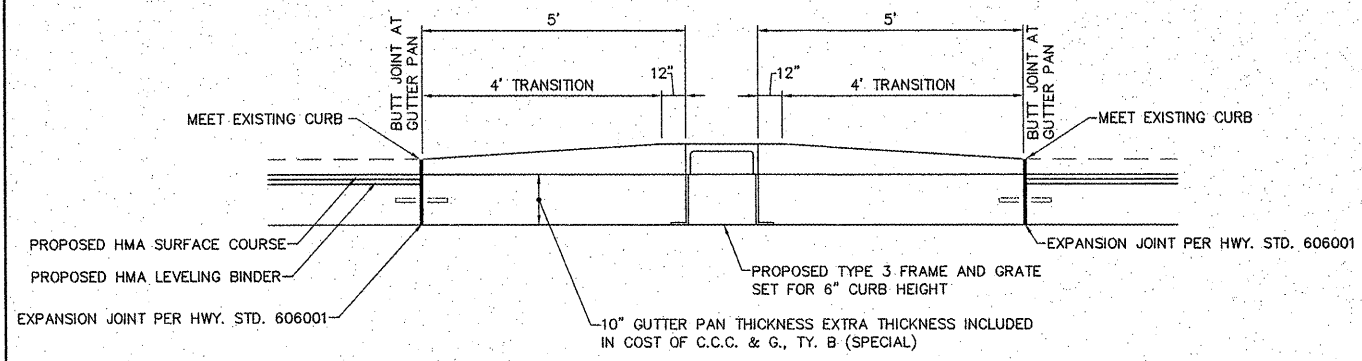

**DETAIL B**  
 COMBINATION CONCRETE CURB AND GUTTER, TYPE B (SPECIAL)  
 AT INLET STA. 18+82.77

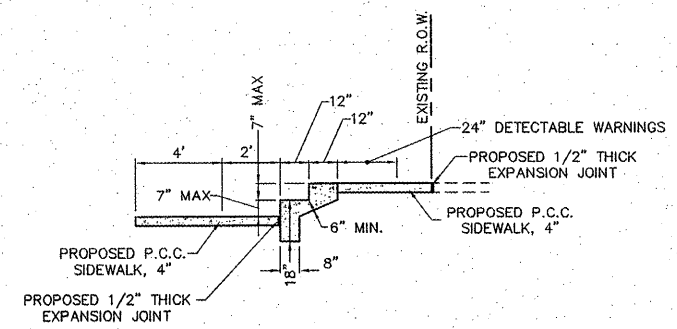
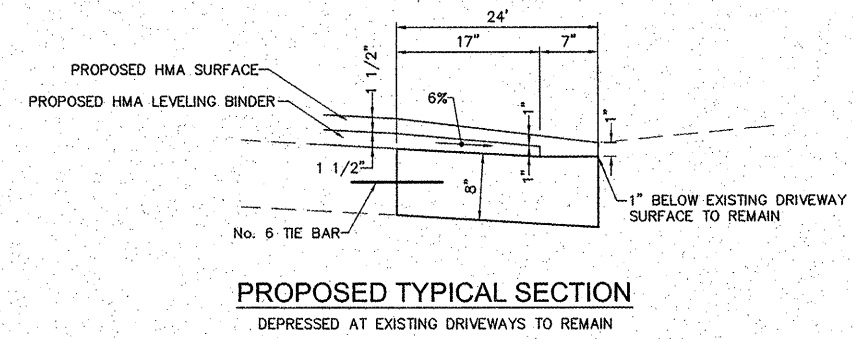
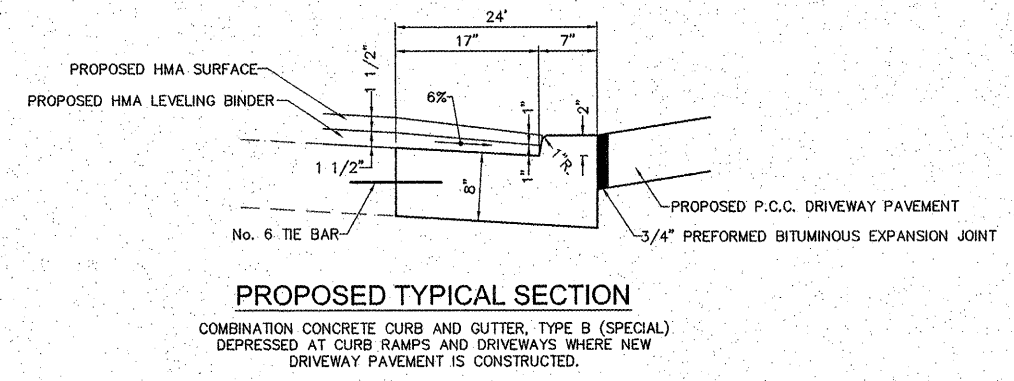
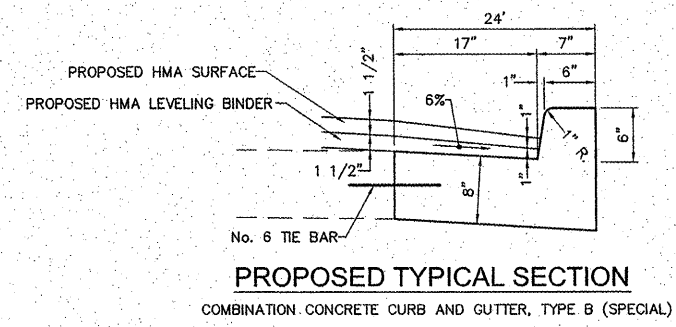
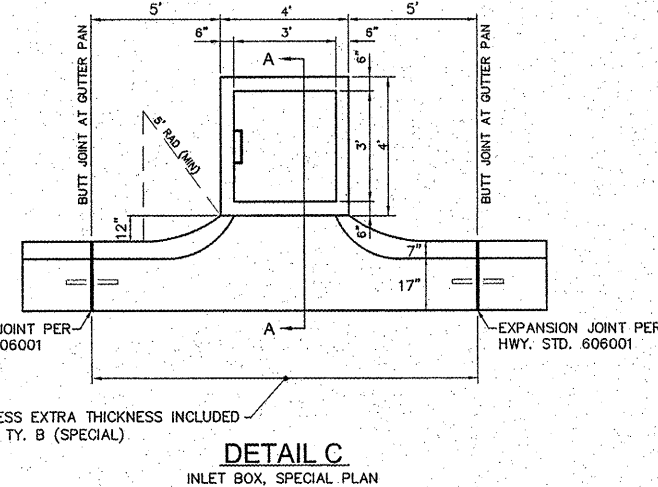
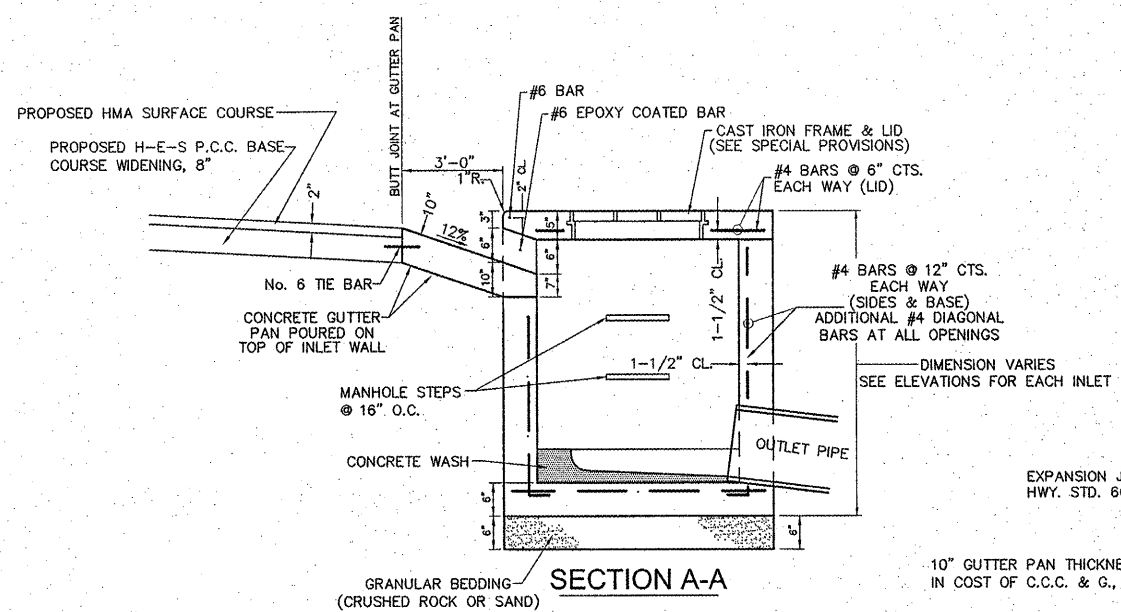
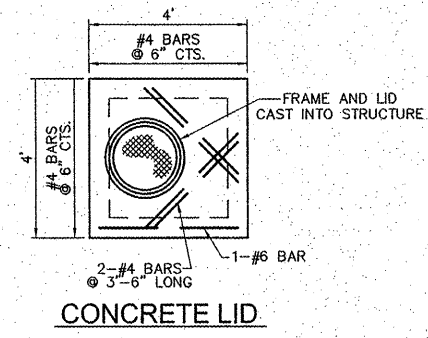

- NOTES:**
- USE AS MANY STAIR TREADS AS NEEDED TO MATCH EXISTING CONDITIONS.
  - ALL RISERS MUST BE THE SAME HEIGHT.
  - SIDEWALKS SHALL BE CONSTRUCTED ON A GRADE OF 5% OR LESS TO AVOID THE USE OF STEPS WHERE POSSIBLE.

**DETAIL D**  
 CONCRETE STEPS

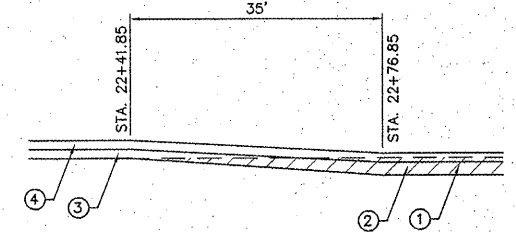

- DETAIL E**  
 MAIN ST. STA. 22+41.85 TO STA. 22+76.85
- EXISTING HMA SURFACE, 1-3/4"
  - PROPOSED HMA SURFACE REMOVAL, 1-3/4"
  - PROPOSED HMA LEVELING BINDER, 1-1/2"
  - PROPOSED HMA SURFACE COURSE, 1-1/2"

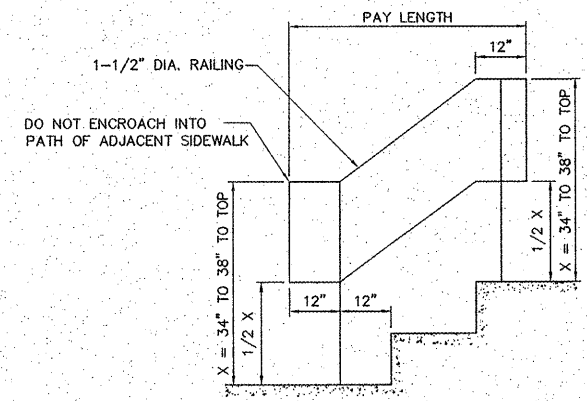

**PIPE HANDRAIL, SPECIAL**  
**DETAIL F**

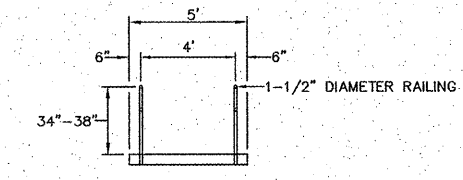

**PIPE HANDRAIL, SPECIAL**  
**DETAIL G**



