

GENERAL NOTES:

THIS SECTION SHALL BE CONSTRUCTED IN ACCORDANCE WITH THE PLANS, SPECIAL PROVISIONS AND "STANDARD SPECIFICATIONS FOR ROAD AND BRIDGE CONSTRUCTION", ADOPTED JANUARY 1, 2012.

THE WORK INVOLVED ON THIS SECTION CONSISTS OF THE REMOVAL OF THE EXISTING STRUCTURE, THE CONSTRUCTION OF A 60 FOOT LONG SINGLE SPAN PRECAST, PRESTRESSED CONCRETE DECK BEAM BRIDGE, EARTH APPROACHES, AGGREGATE SURFACE COURSE AND OTHER MISCELLANEOUS ITEMS NECESSARY TO COMPLETE THIS SECTION.

ALL ELEVATIONS ARE BASED ON U.S.G.S. MEAN SEA LEVEL DATUM.

IT SHALL BE THE CONTRACTOR'S RESPONSIBILITY TO CONTACT ALL THE UTILITIES, AFFECTING THE PROJECT, PRIOR TO CONSTRUCTION.

NOTE: CONSTRUCTION TRANSITION
STA. 2+15 TO STA 2+65
STA 7+20 TO STA 7+70

ALL QUANTITIES ARE INCLUDED IN THE PROPOSAL

TYPICAL CROSS SECTION PROPOSED

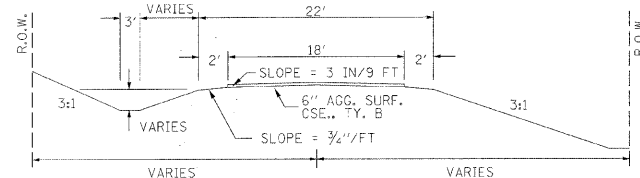

TYPICAL CROSS SECTION EXISTING

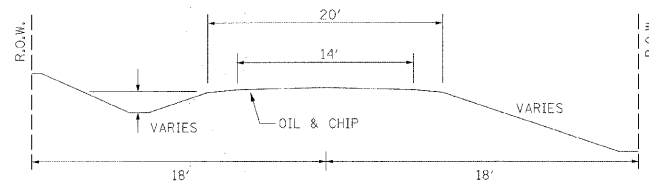

NOTE: CONSTRUCT SPECIAL DITCH

STA 2+50 TO STA 4+75 LT
STA 3+00 TO STA 4+75 RT
STA 5+10 TO STA 7+00 LT
STA 5+25 TO STA 7+50 RT

NOTE: CONSTRUCT STONE LINED DITCH

STA 4+25 TO STA 4+75 LT (0.62 TON/LIN FT)
STA 4+50 TO STA 4+75 RT (0.62 TON/LIN FT)
STA 5+10 TO STA 5+75 LT (0.62 TON/LIN FT)
STA 5+25 TO STA 5+50 RT (0.62 TON/LIN FT)
103 TON STONE LINED DITCH ALLOWED IN PROPOSAL.

SEE STONE LINED DITCH DETAIL.

UTILITIES:
J.U.L.T.E. 1-800-892-0123

WAYNE-WHITE ELECTRIC
1-618-842-2196

STONE LINED DITCH DESIGN

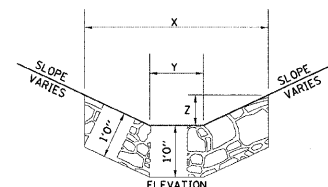
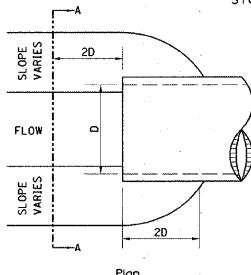

NOTE:

BOTTOM OF DITCH	SLOPE		
2 FT	X = 5 FT	6 FT	8 FT
Y = 2 FT	2 FT	2 FT	2 FT
Z = 1 FT	1 FT	1 FT	1 FT
	0.40	0.48	0.62 TON/LIN FT

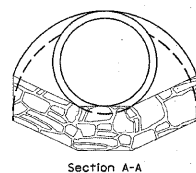

NOTE: FOR PLACEMENT, QUALITY GRADATION AND OTHER MISCELLANEOUS REQUIREMENTS FOR STONE LINED DITCH-SEE SPECIAL PROVISIONS.

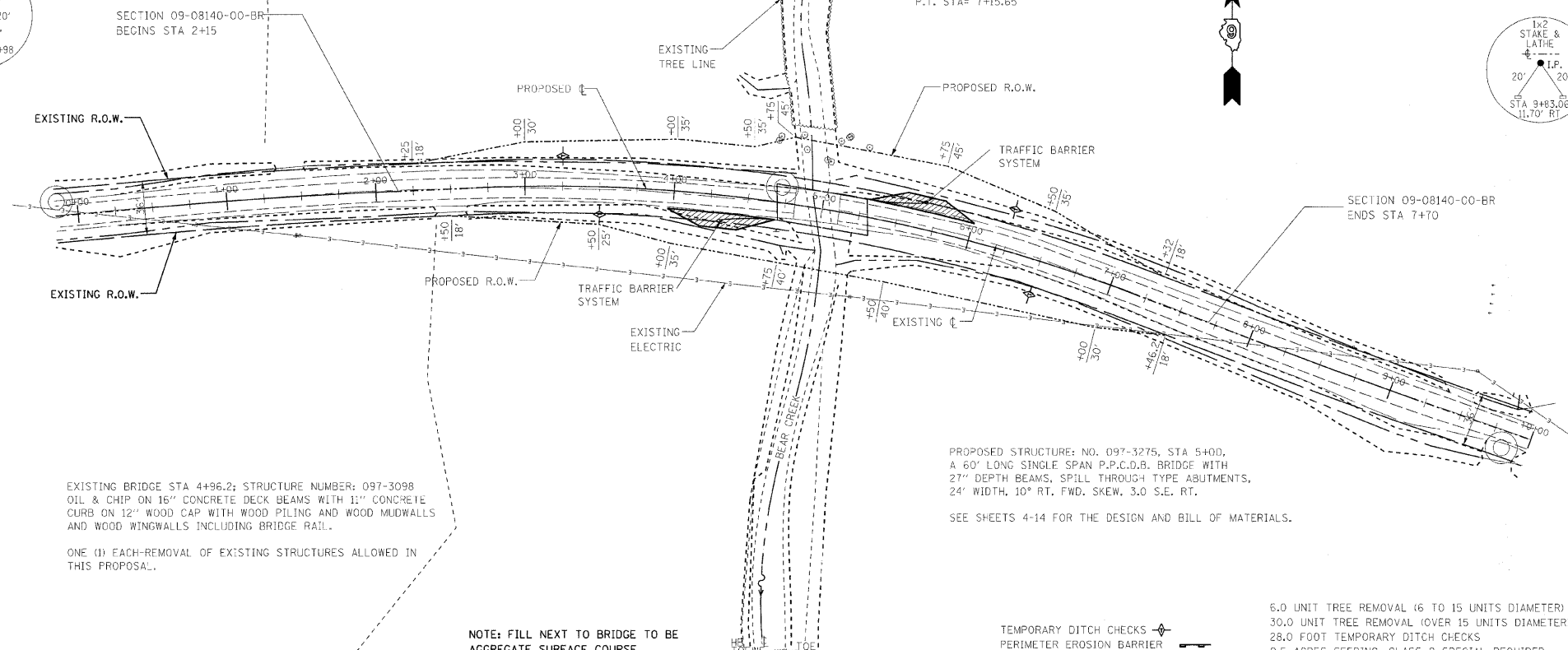
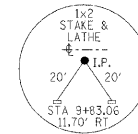
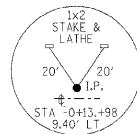

EXISTING BRIDGE STA 4+96.2; STRUCTURE NUMBER: 097-3098
OIL & CHIP ON 16" CONCRETE DECK BEAMS WITH 1" CONCRETE CURB ON 12" WOOD CAP WITH WOOD PILING AND WOOD MUDWALLS AND WOOD WINGWALLS INCLUDING BRIDGE RAIL.

ONE (1) EACH-REMOVAL OF EXISTING STRUCTURES ALLOWED IN THIS PROPOSAL.

PROPOSED STRUCTURE: NO. 097-3275, STA 5+00, A 60' LONG SINGLE SPAN P.P.C.D.B. BRIDGE WITH 27" DEPTH BEAMS, SPILL THROUGH TYPE ABUTMENTS, 24' WIDTH, 10° RT. SKEW, 3.0 S.E. RT.

SEE SHEETS 4-14 FOR THE DESIGN AND BILL OF MATERIALS.

NOTE: FILL NEXT TO BRIDGE TO BE AGGREGATE SURFACE COURSE

TEMPORARY DITCH CHECKS PERIMETER EROSION BARRIER

6.0 UNIT TREE REMOVAL (6 TO 15 UNITS DIAMETER)
30.0 UNIT TREE REMOVAL (OVER 15 UNITS DIAMETER)
28.0 FOOT TEMPORARY DITCH CHECKS
0.5 ACRES SEEDING, CLASS 2 SPECIAL REQUIRED

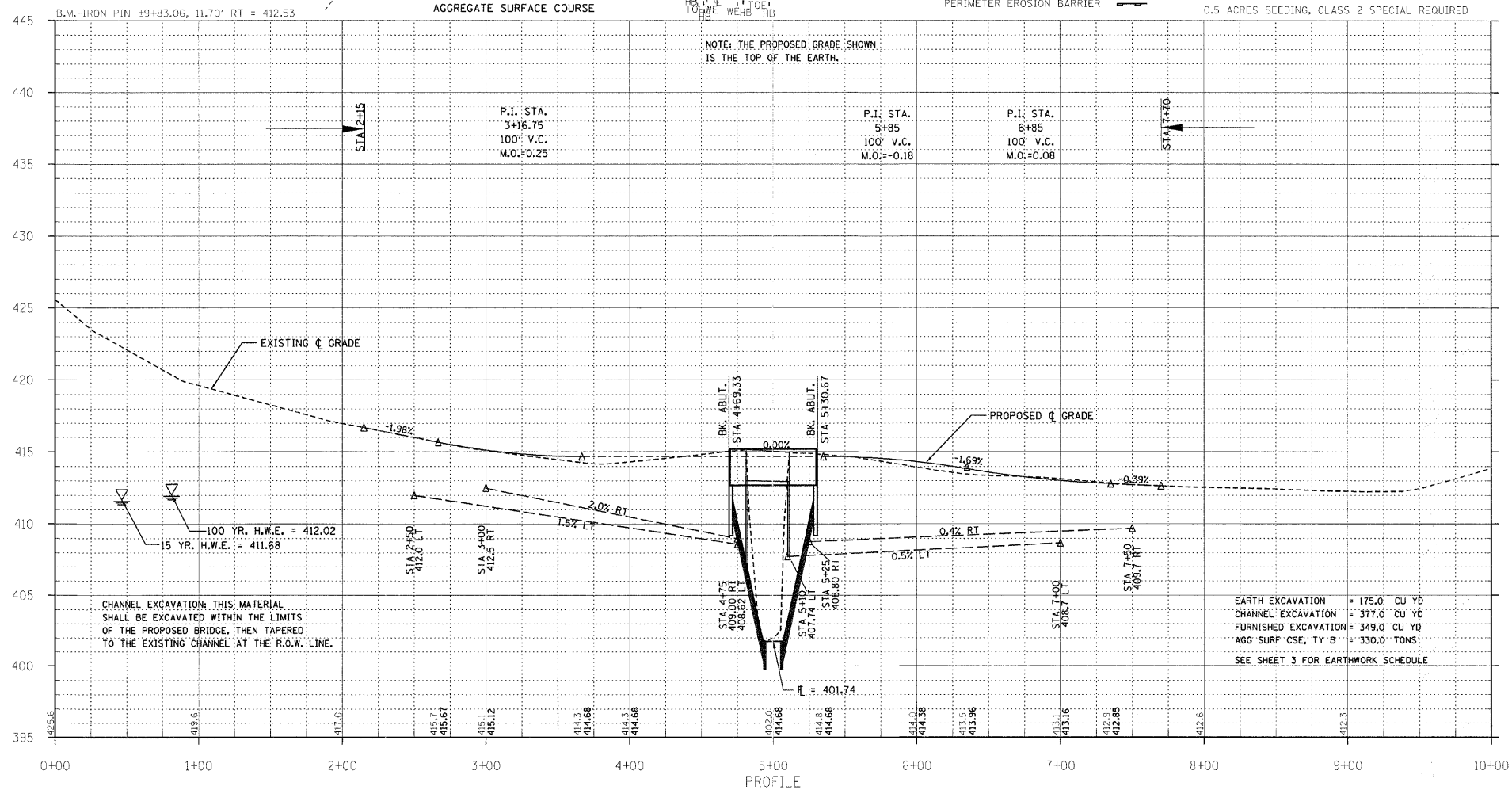

CHANNEL EXCAVATION: THIS MATERIAL SHALL BE EXCAVATED WITHIN THE LIMITS OF THE PROPOSED BRIDGE, THEN TAPERED TO THE EXISTING CHANNEL AT THE R.O.W. LINE.

EARTH EXCAVATION = 175.0 CU YD
CHANNEL EXCAVATION = 377.0 CU YD
FURNISHED EXCAVATION = 349.0 CU YD
AGG SURF CSE, TY B = 330.0 TONS
SEE SHEET 3 FOR EARTHWORK SCHEDULE

TR	SECTION	COUNTY	TOTAL SHEETS	SHEET NO.
251	09-08140-00-BR	WHITE	14	2

323 W. 3RD ST.
P.O. BOX 160
MT. CARMEL, IL 62863
PHONE: (618) 262-8651
FAX: (618)-263-3327

405 W. STATE ST
SUITE 1
PRINCETON, IN 47670
PHONE: (812)-386-7611
FAX: (812)-385-2812

PROFESSIONAL DESIGN FIRM
LAND SURVEY & PROFESSIONAL ENGINEERING CORPORATION
184-000887
(62-032435)(35-002789)



AARON M. MEFFORD
NAME
SIGNATURE
DATE: 2-15-12
11-30-13 EXPIRES

TOWNSHIP ROUTE 251
OVER BEAR CREEK
WHITE COUNTY, ILLINOIS

SHEET TITLE:	
PLAN & PROFILE	
SCALE:	VARIES
BY:	AMM
DATE:	2/9/12
REV:	
2	OF 14
SHEETS	
SHEET NO. 2	