

STATE OF ILLINOIS
DEPARTMENT OF TRANSPORTATION

F.A.S. RTE.	SECTION	COUNTY	TOTAL SHEETS	SHEET NO.
VAR. DIST. 8 RESURFACING 2018-1	ILLINOIS	MADISON	9	1
CONTRACT NO. 76K98				

INDEX OF SHEETS

- 1 COVER
- 2 HIGHWAY STANDARDS, GENERAL NOTES, & COMMITMENTS
- 3 SUMMARY OF QUANTITIES
- 4-5 TYPICAL SECTIONS
- 6-7 SCHEDULE OF QUANTITIES
- 8 PLAN SHEETS
- 9 DETAIL SHEETS

TRAFFIC DATA:

POSSUM HILL RD
2016 ADT=1150 (ACT)
2018 ADT=1200 (EST)
SU=4.3%, MU=1.2%

IL-140 TO GREEN HEDGE RD.
2016 ADT=1850 (ACT)
2018 ADT=1900 (EST)
SU=4.9%, MU=2.2%

GREEN HEDGE RD. TO POSSUM HILL RD.
2016 ADT=1100 (ACT)
2018 ADT=1150 (EST)
SU=5.5%, MU=0.2%

SOUTH FRONTAGE RD.
2016 ADT=2750 (ACT)
2018 ADT=2800 (EST)
SU=0.1%, MU=1.8%

TROY RD.
2016 ADT=2100 (ACT)
2018 ADT=2150 (EST)
SU=3.5%, MU=1.2%

MARYVILLE RD.
2016 ADT=100 (ACT)
2018 ADT=100 (EST)
SU=5%, MU=0.7%

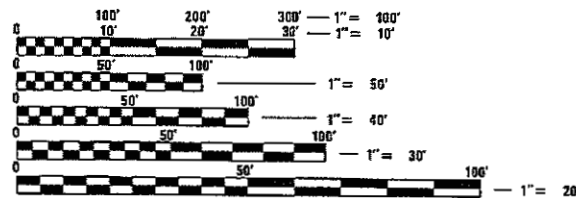

FULL SIZE PLANS HAVE BEEN PREPARED USING STANDARD ENGINEERING SCALES. REDUCED SIZED PLANS WILL NOT CONFORM TO STANDARD SCALES. IN MAKING MEASUREMENTS ON REDUCED PLANS, THE ABOVE SCALES MAY BE USED.

J.U.L.I.E.
JOINT UTILITY LOCATION INFORMATION FOR EXCAVATION
1-800-892-0123
OR 811

PROJECT ENGINEER: TIM PADGETT 618-346-3325
PROJECT MANAGER: JEFF SCHWEIZER 618-346-3208

CONTRACT NO. 76K98

PROPOSED
HIGHWAY PLANS

VARIOUS ROUTES
SECTION DIST 8 RESURFACING 2018-1
RESURFACING - A2
MADISON COUNTY
C-98-139-18

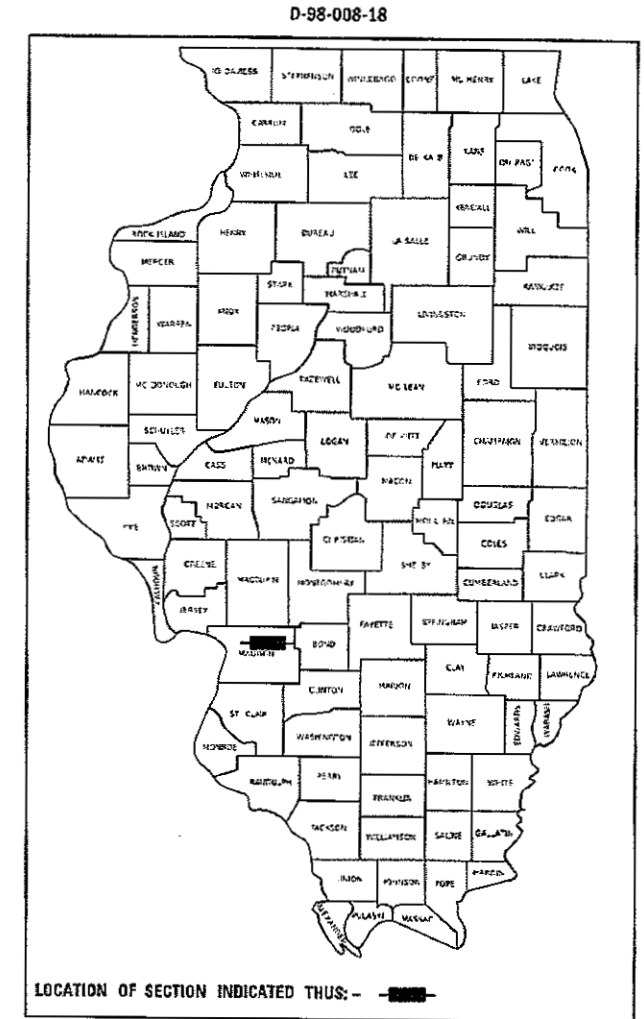
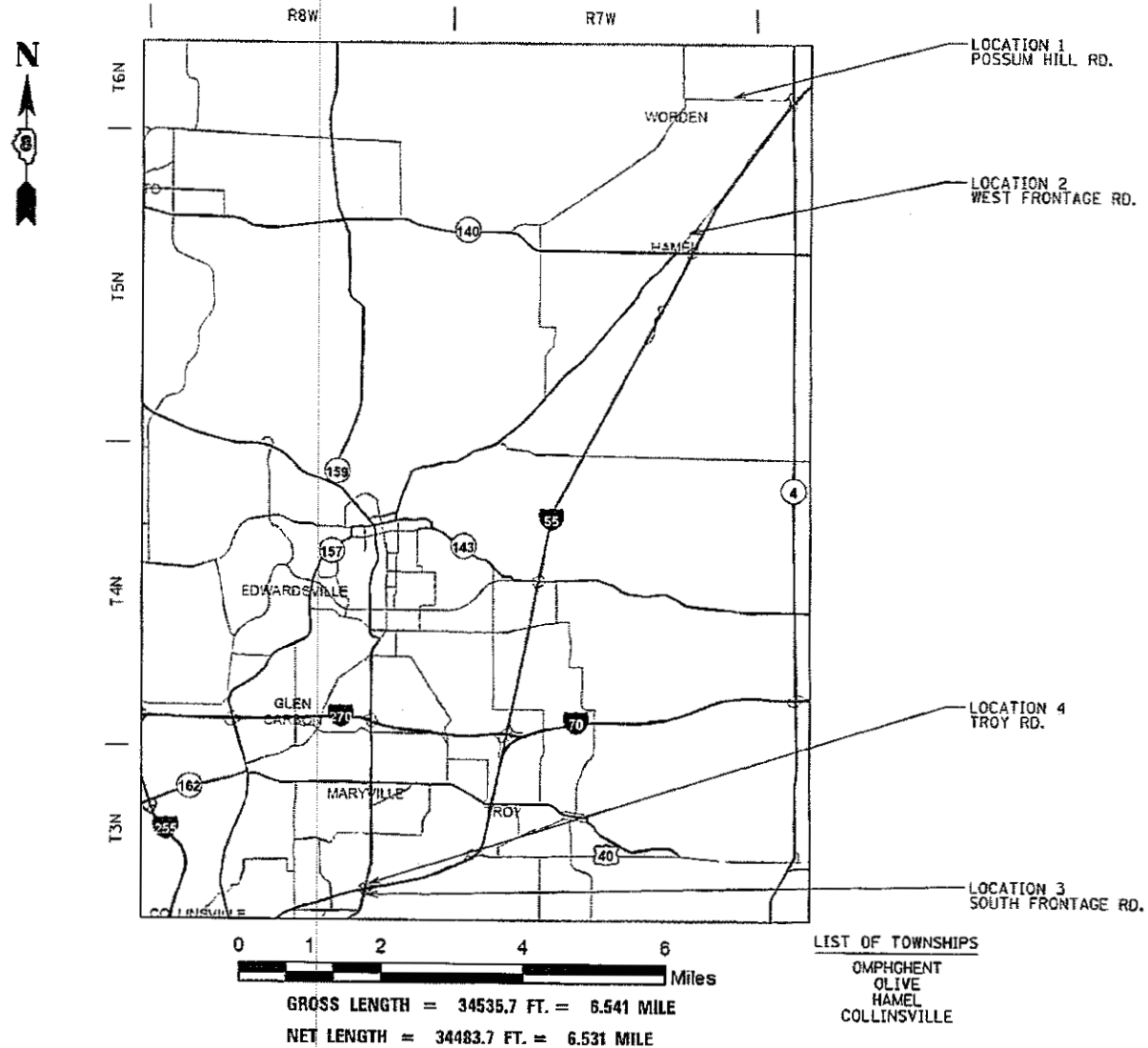

STATE OF ILLINOIS
DEPARTMENT OF TRANSPORTATION

SUBMITTED Jan 25, 2018
Jeffrey Z. Kanga REGIONAL ENGINEER

Mar 23, 2018
[Signature] ENGINEER OF DESIGN AND ENVIRONMENT

Mar 23, 2018
[Signature] DIRECTOR OF HIGHWAYS PROJECT IMPLEMENTATION

PRINTED BY THE AUTHORITY
OF THE STATE OF ILLINOIS

GENERAL NOTES

1. ILLINOIS STATE LAW REQUIRES A 48-HOUR NOTICE TO BE GIVEN TO UTILITIES BEFORE DIGGING. FIELD MARKING OF FACILITIES MAY BE OBTAINED BY CONTACTING J.U.L.I.E. (1-800-892-0123 OR 811) OR FOR NON-MEMBERS THE UTILITY COMPANY DIRECTLY.
2. THE CONTRACTOR AND THE ENGINEER SHALL BE AWARE THAT NO SURVEY WAS PERFORMED FOR THIS PROJECT. THE STATIONING, TOPOGRAPHY, AND QUANTITIES SHOWN IN THE PLANS WERE CREATED USING MICROFILM AND FIELD MEASUREMENTS. ALL SHALL BE ASSUMED TO BE APPROXIMATE. THE CONTRACTOR SHALL VERIFY DIMENSIONS AND CONDITIONS IN THE FIELD PRIOR TO CONSTRUCTION AND ORDERING OF MATERIALS.
3. NO OVERNIGHT LANE CLOSURES WILL BE PERMITTED.
4. THE PROPOSED PAVEMENT MARKING SHALL MATCH THE LOCATIONS OF THE EXISTING PAVEMENT MARKING, AS DIRECTED BY THE ENGINEER.
5. THE DEPARTMENT STRONGLY ENCOURAGES THE PRIME CONTRACTOR AND THEIR APPROVED SUB-CONTRACTORS TO HIRE MINORITY, WOMEN AND DISADVANTAGED INDIVIDUALS FROM ITS FEDERALLY FUNDED HIGHWAY CONSTRUCTION CAREERS TRAINING PROGRAM (HCCTP) TO HELP MEET WORK FORCE AND TRAINEE GOALS. THIS PROGRAM IS TRAINING MINORITIES, WOMEN AND DISADVANTAGED INDIVIDUALS IN HIGHWAY CONSTRUCTION-RELATED SKILLS, E.G., MATH FOR THE TRADES, JOB READINESS, TECHNICAL SKILLS COURSE WORK (CARPENTRY, CONCRETE FLATWORK, BLUEPRINT READING, SITE PLANS, SITE WORK, TOOLS USE, ETC.) AND OSHA 10 HOUR CERTIFICATION, TO PREPARE THEM FOR A CAREER IN THE HIGHWAY CONSTRUCTION TRADES. GRADUATES ARE WELL-TRAINED AND READY TO BECOME PRODUCTIVE ENTRY-LEVEL CONSTRUCTION WORKERS. CONTACT THE DISTRICT 8 EEO OFFICE AT 618-346-3360 AND/OR THE HCCTP COORDINATOR AT 618-874-6528 TO LEARN MORE ABOUT THE PROGRAM AND FOR ASSISTANCE IN MEETING WORK FORCE AND TRAINEE GOALS.
6. "ROAD CONSTRUCTION AHEAD" SIGNS SHALL BE PLACED AT EACH END OF THE PROJECT PLUS THE INTERSECTING SIDE ROADS, AND WILL BE CONSIDERED INCLUDED IN THE TRAFFIC CONTROL PAY ITEMS. ALL CONSTRUCTION SIGNS SHALL BE 48" X 48" FLUORESCENT ORANGE.
7. AT LOCATION 1 POSSUM HILL RD. FROM MILE STATION 0.270 TO MILE STATION 1.750 AGGREGATE WEDGE SHOULDER, TYPE B SHALL BE PLACED BEFORE A-2 SURFACE TREATMENT. A-2 SURFACE TREATMENT FROM MILE STATION 0.270 TO MILE STATION 1.750 SHALL BE 24 FT WIDE.
8. AT LOCATION 2 WEST FRONTAGE RD. FROM MILE STATION 0.0 TO MILE STATION 3.836 AGGREGATE WEDGE SHOULDER, TYPE B SHALL BE PLACED BEFORE A-2 SURFACE TREATMENT. A-2 SURFACE TREATMENT FROM MILE STATION 0.045 TO MILE STATION 3.825 SHALL BE 30 FT WIDE.
9. AT LOCATIONS WHERE PERMANENT PAVEMENT MARKINGS ARE PROPOSED, THE CONTRACTOR SHALL SWEEP THE ENTIRE ROADWAY A MINIMUM OF TWO WEEKS, BUT NOT TO EXCEED THREE WEEKS, AFTER APPLICATION OF SEAL COAT AGGREGATE TO ALLOW PLACEMENT OF THE PAINT PAVEMENT MARKINGS. THE PAVEMENT MUST BE DRY TO THE SATISFACTION OF THE ENGINEER BEFORE THE FINAL PAVEMENT MARKINGS CAN BE APPLIED. THE COST FOR THIS WORK SHALL BE INCLUDED IN THE PRICE OF THE SURFACE TREATMENT AND NO ADDITIONAL COMPENSATION WILL BE ALLOWED.
10. THE FOLLOWING APPLICATION RATES WERE USED IN DETERMINING QUANTITIES:
 BITUMINOUS MATERIALS (COVER & SEAL COAT) - 0.00146 TONS/SO YD
 AGGREGATE FOR COVER & SEAL COATS - 0.01 TONS/SO YD
 BITUMINOUS MATERIALS (PRIME COAT) - 0.0015646 TONS/SO YD

COMMITMENTS

NONE

STANDARDS

- 000001-06
- 001006
- 701306-04
- 701311-03
- 701701-10
- 701901-07
- 780001-05

MODEL: \\MODELS\MNMF5
 FILE: \\MAILS\MAILS\JULI@EEDINDITEC\Illinois\proj\RWIDOT\Documental\DOT_Offices\District 8\Projects\0876K98\CADDData\CAD\hearts\0876K98\htr-reports.dgn

USER NAME = schweizerja	DESIGNED - JS	REVISED - _____
	DRAWN - JS	REVISED - _____
PLOT SCALE = 100,0000' / in.	CHECKED - RM	REVISED - _____
PLOT DATE = 1/25/2018	DATE - _____	REVISED - _____

STATE OF ILLINOIS
DEPARTMENT OF TRANSPORTATION

HIGHWAY STANDARDS, GENERAL NOTES, & COMMITMENTS

SCALE: N/A SHEET 1 OF 1 SHEETS STA. N/A TO STA. N/A

F.A.S. RTE.	SECTION	COUNTY	TOTAL SHEETS	SHEET NO.
VAR.	DIST. 8 RESURFACING 2018-1	MADISON	9	2
			CONTRACT NO. 76K98	
		ILLINOIS	FED. AID PROJECT	

CODE NO.	ITEM	UNIT	TOTAL QUANTITY	CONSTR. CODE	
				MADISON ROADWAY 0005 RURAL	MADISON ROADWAY 0005 URBAN
40300400	BITUMINOUS MATERIALS (COVER AND SEAL COATS)	TON	323.5	269.9	53.6
40300500	COVER COAT AGGREGATE	TON	1108	924.1	183.9
40300600	SEAL COAT AGGREGATE	TON	1108	924.1	183.9
48102100	AGGREGATE WEDGE SHOULDER, TYPE B	TON	2002	2002	0
67100100	MOBILIZATION	L SUM	1	0.5	0.5
70100460	TRAFFIC CONTROL AND PROTECTION, STANDARD 701306	L SUM	1	0.5	0.5
70102635	TRAFFIC CONTROL AND PROTECTION, STANDARD 701701	L SUM	1	0	1
* 78001100	PAINT PAVEMENT MARKING - LETTERS AND SYMBOLS	50 FT	138	122	16
* 78001110	PAINT PAVEMENT MARKING - LINE 4"	FOOT	92349	76875	15474
* 78001150	PAINT PAVEMENT MARKING - LINE 12"	FOOT	131	19	112
* 78001180	PAINT PAVEMENT MARKING - LINE 24"	FOOT	168	137	31
78300200	RAISED REFLECTIVE PAVEMENT MARKER REMOVAL	EACH	368	368	0
Ø 20070604	TRAINEES TRAINING PROGRAM GRADUATE	HOOR	500	500	
X7810400	TEMPORARY RAISED PAVEMENT MARKER	EACH	4409	3080	1329

* SPECIALTY ITEM

Ø 0042

MODEL: #MODELNAME
FILE NAME: D:\VLOS4E\BID\INTES\Illinois.gov\DOT\Documents\DOT_Offices\District_8\Projects\2018\76K98\CA\Drawings\0976K98-000-509.dgn

USER NAME = schweitzerja	DESIGNED - JS	REVISED -
PLOT SCALE = 100.0000 / in.	DRAWN - JS	REVISED -
PLOT DATE = 1/25/2018	CHECKED - RM	REVISED -
	DATE -	REVISED -

**STATE OF ILLINOIS
DEPARTMENT OF TRANSPORTATION**

SUMMARY OF QUANTITIES

SCALE: N/A SHEET 1 OF 1 SHEETS STA. N/A TO STA. N/A

F.A.S. RTE.	SECTION	COUNTY	TOTAL SHEETS	SHEET NO.
VAR.	DIST. 8 RESURFACING 2018-1	MADISON	9	3
			CONTRACT NO. 76K98	
ILLINOIS FED. AID PROJECT				

LOCATION 1 - POSSUM HILL RD.

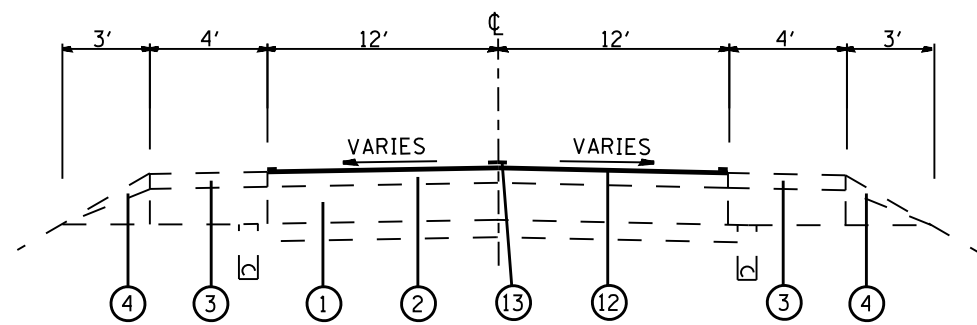

MILE POINT 0.00 TO MILE POINT 0.270

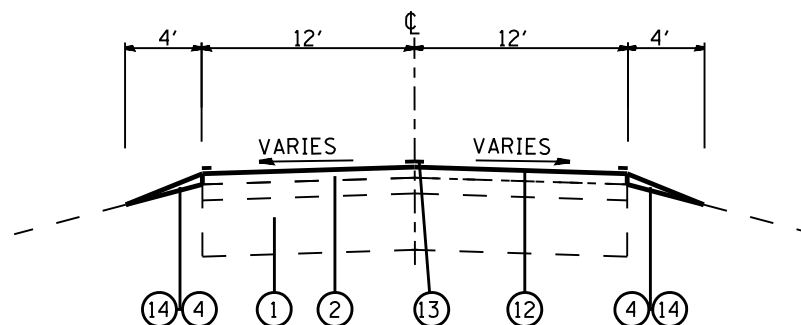

MILE POINT 0.270 TO MILE POINT 1.750

LEGEND

- ① EXISTING PCC PAVEMENT
- ② EXISTING RESURFACING, VARIES
- ③ EXISTING HMA SHOULDERS
- ④ EXISTING AGGREGATE WEDGE SHOULDER
- ⑤ EXISTING PAVEMENT PATCHING
- ⑥ EXISTING CONCRETE GUTTER
- ⑦ EXISTING CONCRETE CURB AND GUTTER
- ⑧ EXISTING AGGREGATE BASE COURSE
- ⑨ EXISTING HMA BASE COURSE WIDENING
- ⑩ EXISTING BRICK PAVEMENT
- ⑪ EXISTING PCC BASE COURSE WIDENING
- ⑫ PROPOSED A-2 SURFACE TREATMENT
- ⑬ PROPOSED PAVEMENT MARKING - LINE 4"
- ⑭ PROPOSED AGGREGATE WEDGE SHOULDER, TYPE B

LOCATION 2 - WEST FRONTAGE RD.

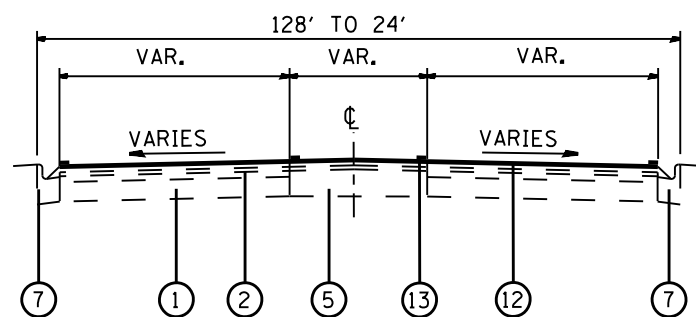

MILE POINT 0.00 TO MILE POINT 0.045

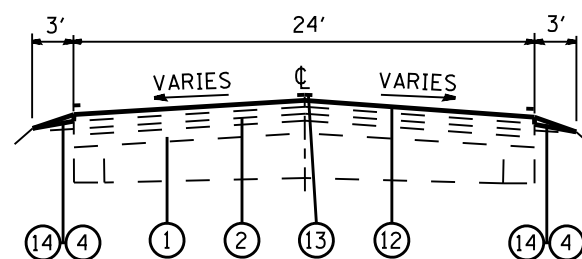

MILE POINT 0.045 TO MILE POINT 0.600

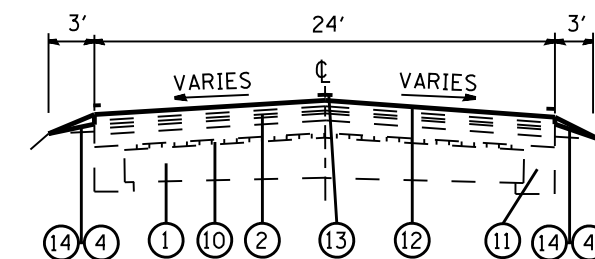

MILE POINT 0.600 TO MILE POINT 3.835

LOCATION 3 - SOUTH FRONTAGE RD.

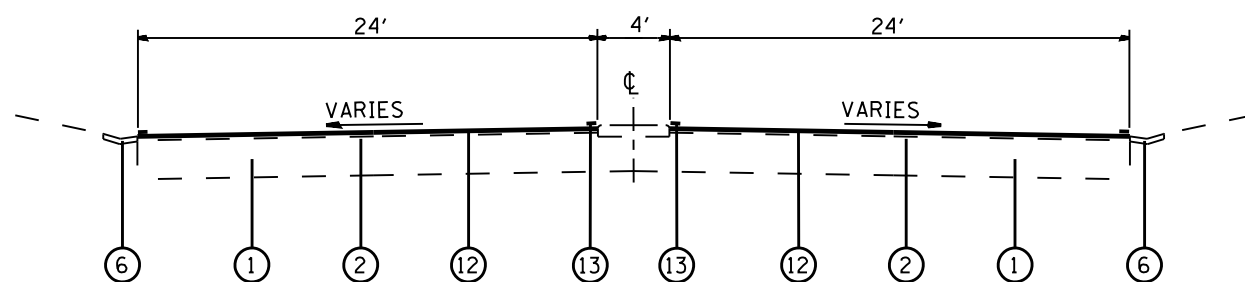

MILE POINT 0.00 TO MILE POINT 0.219

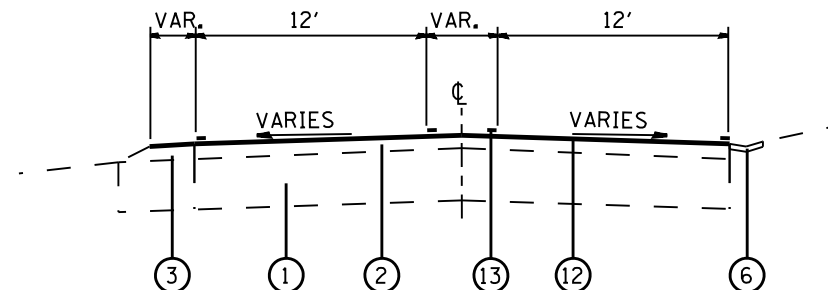

MILE POINT 0.219 TO MILE POINT 0.357

NOTES

LOCATION 1: FROM MILE STATION 0.270 TO MILE STATION 1.750 AGGREGATE WEDGE SHOULDER, TYPE B SHALL BE PLACED BEFORE A-2 SURFACE TREATMENT. A-2 SURFACE TREATMENT FROM MILE STATION 0.270 TO MILE STATION 1.750 SHALL BE 24 FT WIDE.

LOCATION 2: WEST FRONTAGE RD. FROM MILE STATION 0.0 TO MILE STATION 3.836 AGGREGATE WEDGE SHOULDER, TYPE B SHALL BE PLACED BEFORE A-2 SURFACE TREATMENT. A-2 SURFACE TREATMENT FROM MILE STATION 0.045 TO MILE STATION 3.825 SHALL BE 30 FT WIDE.

MODEL: I:\MODEL\NAME: FILE: NAME: PROJECT: I:\PROJECTS\087698\CADD\DATA\CAD\PROJECTS\087698\087698.dwg

USER NAME = schweizerja	DESIGNED - JS	REVISED -
	DRAWN - JS	REVISED -
PLOT SCALE = 100.0000' / in.	CHECKED - RM	REVISED -
PLOT DATE = 1/25/2018	DATE -	REVISED -

STATE OF ILLINOIS
DEPARTMENT OF TRANSPORTATION

TYPICAL SECTION	
SCALE: N.T.S.	SHEET 1 OF 2 SHEETS
STA. N/A	TO STA. N/A

F.A.S. RTE.	SECTION	COUNTY	TOTAL SHEETS	SHEET NO.
VAR. DIST. 8 RESURFACING 2018-1		MADISON	9	4
CONTRACT NO. 76K98			ILLINOIS FED. AID PROJECT	

PAVING SCHEDULE						
LOCATION			BITUMINOUS MATERIALS (COVER AND SEAL COAT)	COVER COAT AGGREGATE	SEAL COAT AGGREGATE	AGGREGATE WEDGE SHOULDER, TYPE B
MILE STA.	TO	MILE STA.	TON	TON	TON	TON
POSSUM HILL RD.						
0.000	TO	0.030	2.1	7.3	7.3	
0.030	TO	0.270	9.9	33.8	33.8	
0.270	TO	1.220	42.3	144.9	144.9	345.8
1.220	TO	1.230				
1.230	TO	1.746	17.7	60.5	60.5	201.8
SUB TOTAL LOCATION 1			72.0	246.5	246.5	547.6
WEST FRONTAGE RD.						
0.000	TO	0.045	2.9	10.0	10.0	5.4
0.045	TO	3.825	194.3	665.3	665.3	1444.8
3.825	TO	3.836	0.7	2.4	2.4	4.3
SUB TOTAL LOCATION 2			197.9	677.6	677.6	1454.5
SOUTH FRONTAGE RD.						
0.000	TO	0.219	18.2	62.4	62.4	
0.219	TO	0.261	2.9	10.1	10.1	
0.261	TO	0.358	4.0	13.7	13.7	
ST. CHARLES RD.						
0.000	TO	0.031	2.7	9.3	9.3	
SUB TOTAL LOCATION 3			27.9	95.5	95.5	
TROY RD.						
0.000	TO	0.326	12.3	42.1	42.1	
0.326	TO	0.390	7.0	24.1	24.1	
MARYVILLE RD.						
0.000	TO	0.180	6.5	22.2	22.2	
SUB TOTAL LOCATION 4			25.8	88.4	88.4	
TOTAL			323.5	1108.0	1108.0	2002

TRAFFIC CONTROL SCHEDULE		
LOCATION NUMBER	TRAFFIC CONTROL AND PROTECTION STANDARD 701306	TRAFFIC CONTROL AND PROTECTION STANDARD 701701
	L. SUM	L. SUM
1	0.25	0
2	0.25	0
3	0.25	0.5
4	0.25	0.5
TOTAL	1.00	1.00

MODEL: \\MODELNAME
 FILE: \\NAME.PLOT\DOT\Documental\DOT - Office\Director\B\Projects\087698\CADD\DATA\CAD\Sheet\087698-ptschedule.dgn

USER NAME = schweizerja	DESIGNED - JS	REVISED - _____
	DRAWN - JS	REVISED - _____
PLOT SCALE = 100,0000' / in.	CHECKED - RM	REVISED - _____
PLOT DATE = 1/25/2018	DATE - _____	REVISED - _____

STATE OF ILLINOIS
DEPARTMENT OF TRANSPORTATION

SCALE: N/A		SHEET 1 OF 2 SHEETS		STA. N/A TO STA. N/A		SCHEDULE	
						ILLINOIS	FED. AID PROJECT

F.A.S. RTE.	SECTION	COUNTY	TOTAL SHEETS	SHEET NO.
VAR.	DIST. 8 RESURFACING 2018-1	MADISON	9	6
CONTRACT NO. 76K98				

PAVEMENT MARKING SCHEDULE												
LOCATION			COMMENTS	PAINT PAVEMENT MARKING 4"				PAINT PAVEMENT MARKING 12"	PAINT PAVEMENT MARKING 24"	PAINT PAVEMENT MARKING, LETTERS AND SYMBOLS	TEMPORARY RAISED PAVEMENT MARKER	RAISED REFLECTIVE PAVEMENT MARKER REMOVAL
				WHITE		YELLOW						
MILE STA.	TO	MILE STA.		SOLID	6' SKIP 2' DASH	30' SKIP 10' DASH	SOLID	YELLOW	WHITE			
POSSUM HILL RD.				FOOT		FOOT		FOOT	FOOT	SO. FT.	EACH	EACH
0.000	TO	0.040	EB 2 STOP BARS	462		50.0			48.0		10.0	3.0
0.040	TO	0.246	WB NO PASS	2075		280.0	1087.7				218.0	14.0
0.246	TO	0.501	DOUBLE NO PASS	2693			2693				270	17
0.501	TO	0.683	EB NO PASS	1922		240	961				193	12
0.683	TO	1.017	SKIP-DASH	3527		440					81	22
1.017	TO	1.220	WB NO PASS	2144		280	1072		27	61	215	13
1.230	TO	1.236	DOUBLE NO PASS	63			63				7	0
1.236	TO	1.432	EB NO PASS	2070		260	1035		27	61	207	13
1.432	TO	1.746	SKIP-DASH	3316		410					76	21
SUB - TOTAL LOCATION 1				18272		1960	6912		102	122	1277	115
WEST FRONTAGE RD.												
0.000	TO	0.045	MEDIAN & DBL NO PASS	120			697	19	20		93	3
0.045	TO	1.829	SKIP-DASH	18287		2355					429	118
1.829	TO	1.941	NB NO PASS	1080		148	591				119	7
1.941	TO	2.043	SKIP-DASH	1077		135					25	7
2.043	TO	2.089	SB NO PASS	486		61	243				49	3
2.089	TO	2.152	DOUBLE NO PASS	665			665				67	4
2.152	TO	2.215	NB NO PASS	665		83	333				67	4
2.215	TO	2.296	SKIP-DASH	855		107					20	5
2.296	TO	2.420	SB NO PASS	1309		164	655				131	8
2.420	TO	2.902	SKIP-DASH	5090		636					116	32
2.902	TO	3.007	NB NO PASS	1109		139	554				111	7
3.007	TO	3.110	SKIP-DASH	1088		136					25	7
3.110	TO	3.212	SB NO PASS	1077		135	539				108	7
3.212	TO	3.479	SKIP-DASH	2820		352					65	18
3.479	TO	3.724	NB NO PASS	2587		323					259	16
3.724	TO	3.836	DOUBLE NO PASS	1223			1144		15		119	7
SUB - TOTAL LOCATION 2				39538		4773	5421	19	35		1803	253
SOUTH FRONTAGE RD.												
0.000	TO	0.219	MEDIAN	1773			820				463	
0.219	TO	0.261	GORE	444			887				89	
0.261	TO	0.358	DOUBLE NO PASS	1024			1024				103	
ST. CHARLES RD.												
0.000	TO	0.031	DOUBLE NO PASS	340			327				43	
SUB - TOTAL LOCATION 3				3581			3059				698	
TROY RD.												
0.000	TO	0.326	DOUBLE NO PASS	3443			3443				345	
0.326	TO	0.390	MEDIAN / TURN LANES	885	92		752	112	31	16	242	
MARYVILLE RD.												
0.000	TO	0.180	SKIP-DASH			220					44	
SUB - TOTAL LOCATION 4				4328	92	220	4194	112	31	16	631	
SUB - TOTAL				65718	92	6953	19586	131	168	138	4409	368
TOTAL						92349		131	168	138	4409	368

MODEL: I:\MODEL\NAME: FILE: NAME: PROJECT: I:\PROJECTS\0876698\CADD\DATA\CAD\PROJECTS\0876698\PS-SCHEDULE.dgn

USER NAME = schweizerja	DESIGNED - JS	REVISED - _____
	DRAWN - JS	REVISED - _____
PLOT SCALE = 100.0000 ' / in.	CHECKED - RM	REVISED - _____
PLOT DATE = 1/25/2018	DATE - _____	REVISED - _____

STATE OF ILLINOIS
DEPARTMENT OF TRANSPORTATION

SCHEDULE

SCALE: N/A SHEET 2 OF 2 SHEETS STA. N/A TO STA. N/A

F.A.S. RTE.	SECTION	COUNTY	TOTAL SHEETS	SHEET NO.
VAR.	DIST. 8 RESURFACING 2018-1	MADISON	9	7
			CONTRACT NO. 76K98	
		ILLINOIS	FED. AID PROJECT	

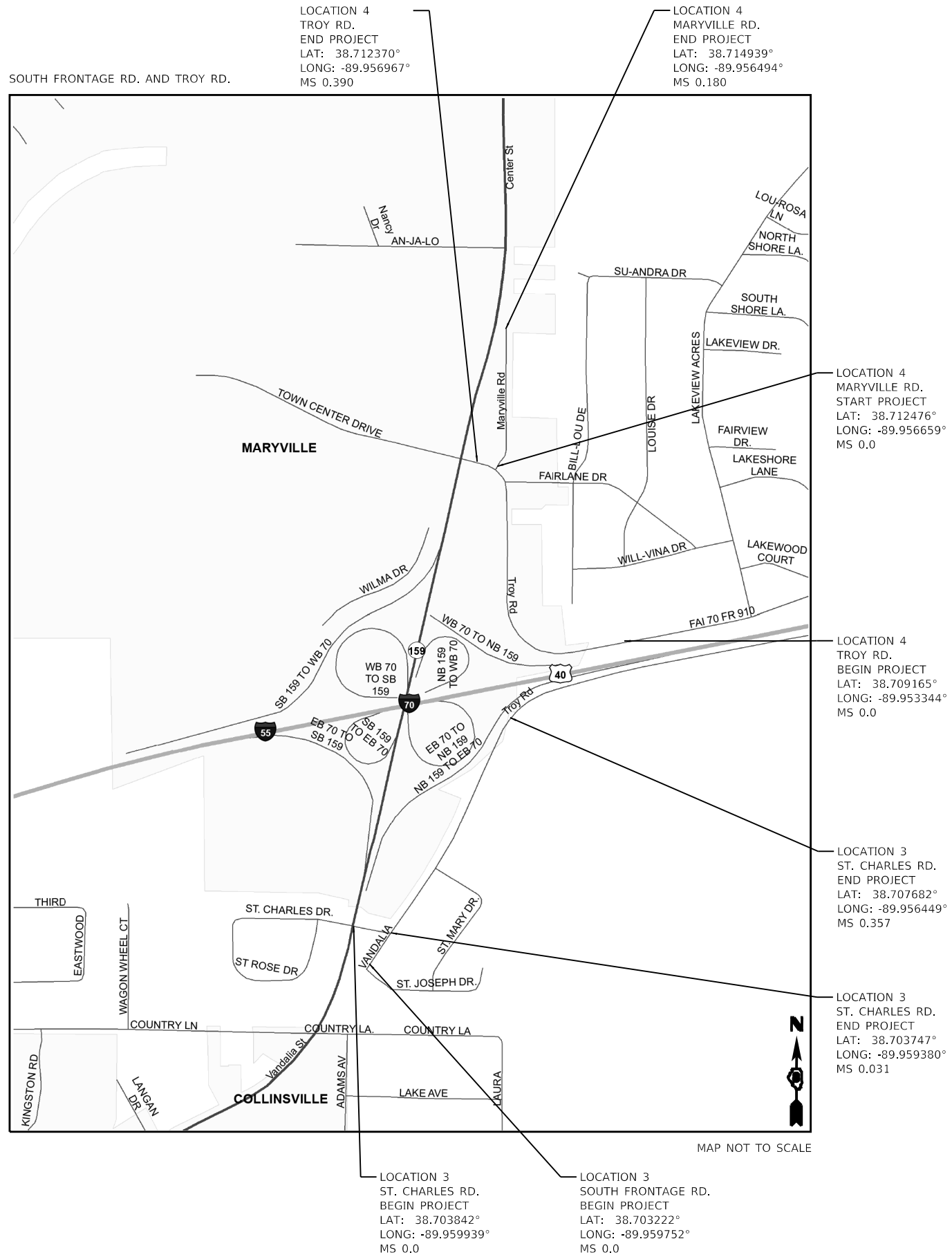
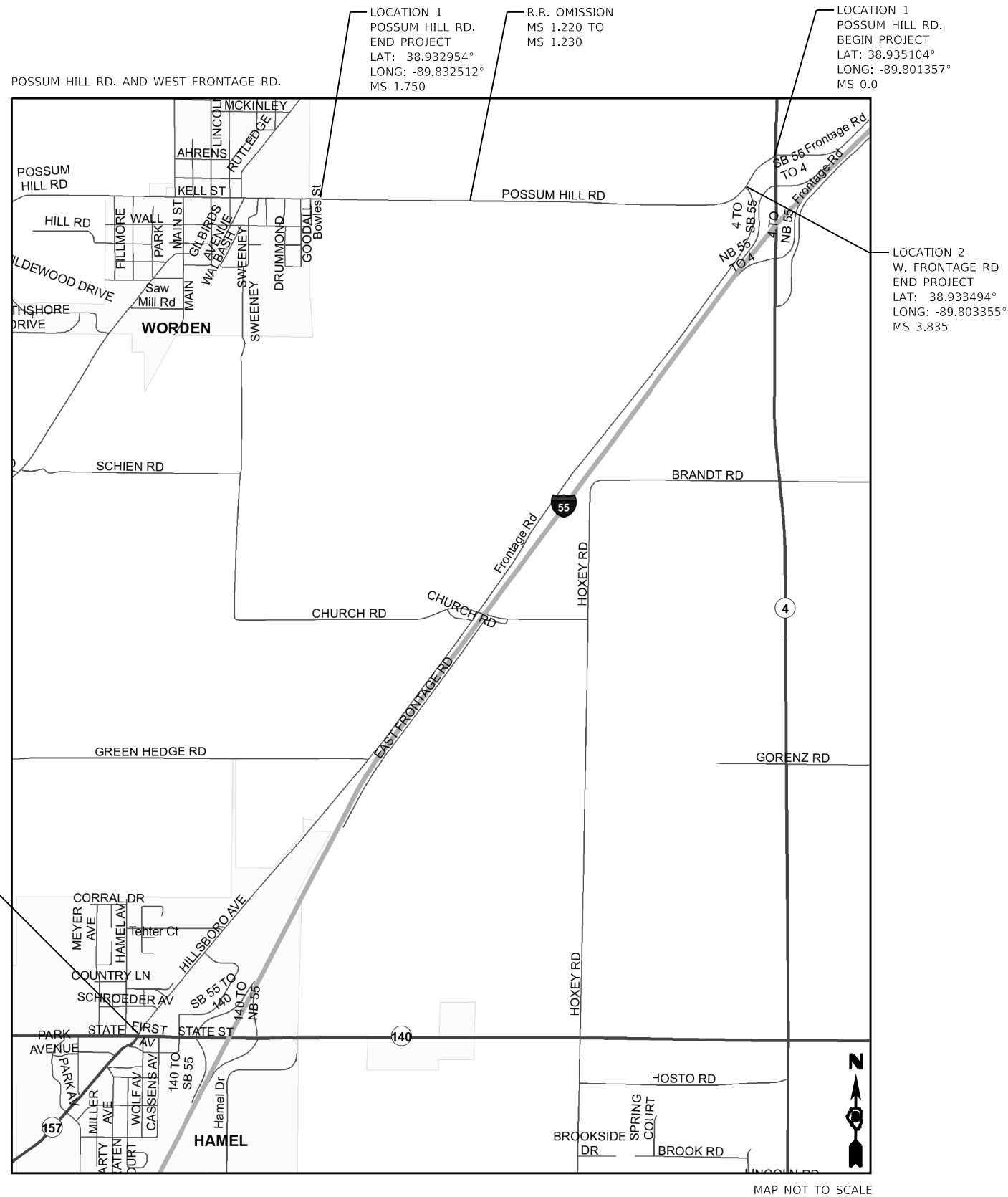

MODEL: 410001.MXD
 FILE: 410001.DWG
 PROJECT: 087609810001.DWG
 OFFICE: 087609810001.DWG
 USER: jschweizerja
 DATE: 1/25/2018

USER NAME = jschweizerja	DESIGNED - JS	REVISED -
DRAWN - JS	REVISED -	
PLOT SCALE = 100,0000' / in.	CHECKED - RM	REVISED -
PLOT DATE = 1/25/2018	DATE -	REVISED -

**STATE OF ILLINOIS
DEPARTMENT OF TRANSPORTATION**

SCALE: N.T.S.		SHEET 1 OF 1 SHEETS	STA. N/A TO STA. N/A
---------------	--	---------------------	----------------------

F.A.S. RTE.	SECTION	COUNTY	TOTAL SHEETS	SHEET NO.
VAR.	DIST. 8 RESURFACING 2018-1	MADISON	9	8
CONTRACT NO. 76K98				
ILLINOIS FED. AID PROJECT				

LOCATION 1 POSSUM HILL RAILROAD
CROSSING OMISSION DETAIL (N.T.S.)

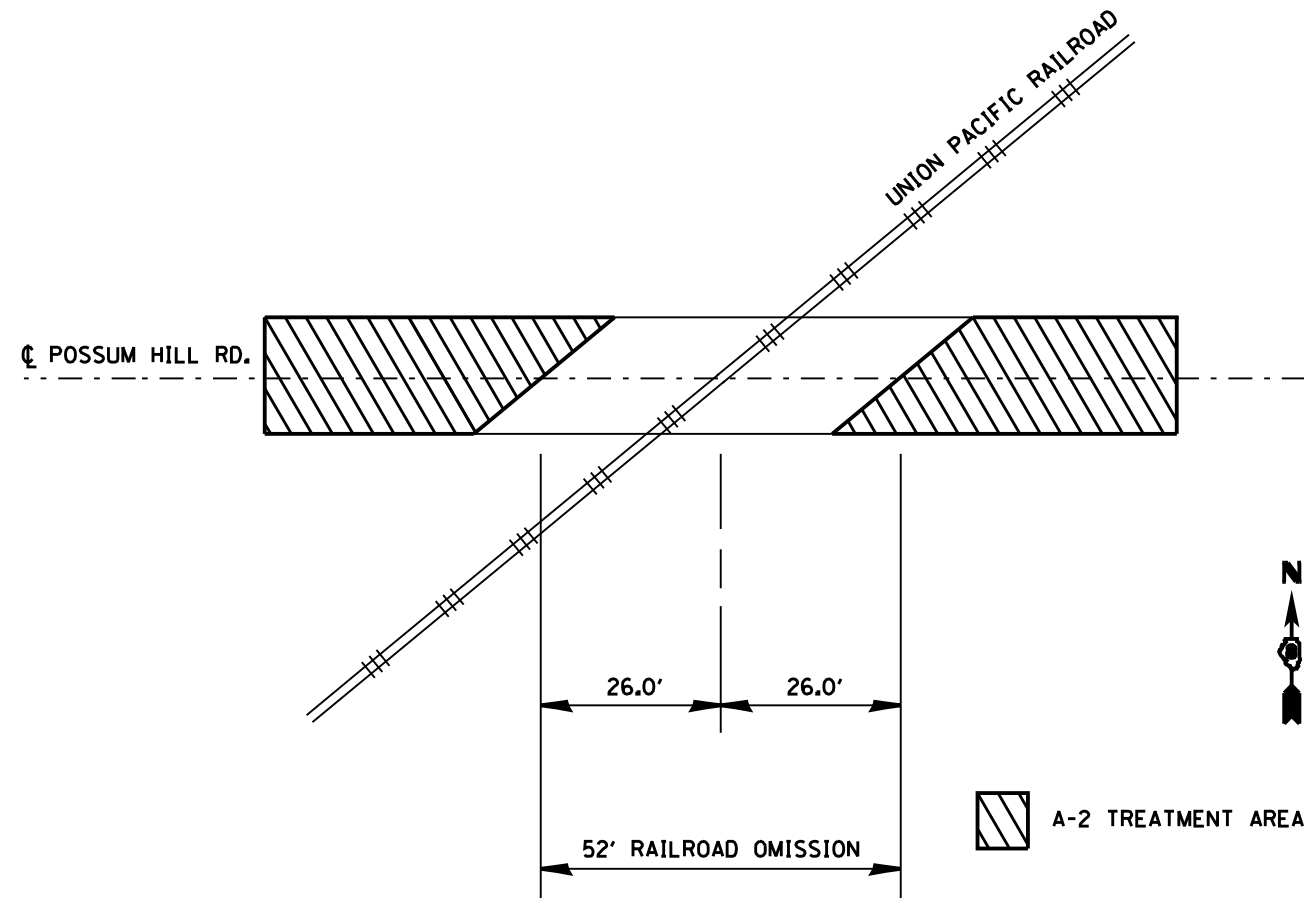

MODEL: s:\MODEL\MAME
 FILE NAME: s:\ULU@EID\NITEG\Illinois\proj\RWIDOT\Documental\DOT Office\Detailct 8\Project\0876K98\CADD\data\CAD\sheet\0876K98-ct-detail.dgn

USER NAME = schweizerja	DESIGNED - JS	REVISED - _____
	DRAWN - JS	REVISED - _____
PLOT SCALE = 100,0000' / in.	CHECKED - RM	REVISED - _____
PLOT DATE = 1/25/2018	DATE - _____	REVISED - _____

**STATE OF ILLINOIS
DEPARTMENT OF TRANSPORTATION**

DETAILS

SCALE: N.T.S. SHEET 1 OF 1 SHEETS STA. N/A TO STA. N/A

F.A.S. RTE.	SECTION	COUNTY	TOTAL SHEETS	SHEET NO.
VAR.	DIST. 8 RESURFACING 2018-1	MADISON	9	9
			CONTRACT NO. 76K98	
		ILLINOIS	FED. AID PROJECT	