

STATE OF ILLINOIS
DEPARTMENT OF TRANSPORTATION

F.A.J. RTE.	SECTION	COUNTY	TOTAL SHEETS	SHEET NO.
255	60-8RS-2	MADISON	10	1
		ILLINOIS	CONTRACT NO. 76L00	

D-98-010-18



FOR INDEX OF SHEETS, SEE SHEET NO. 2

PROPOSED HIGHWAY PLANS

FAI ROUTE 255 (I-255)
SECTION 60-8RS-2
MILL AND FILL
MADISON COUNTY

C-98-141-18

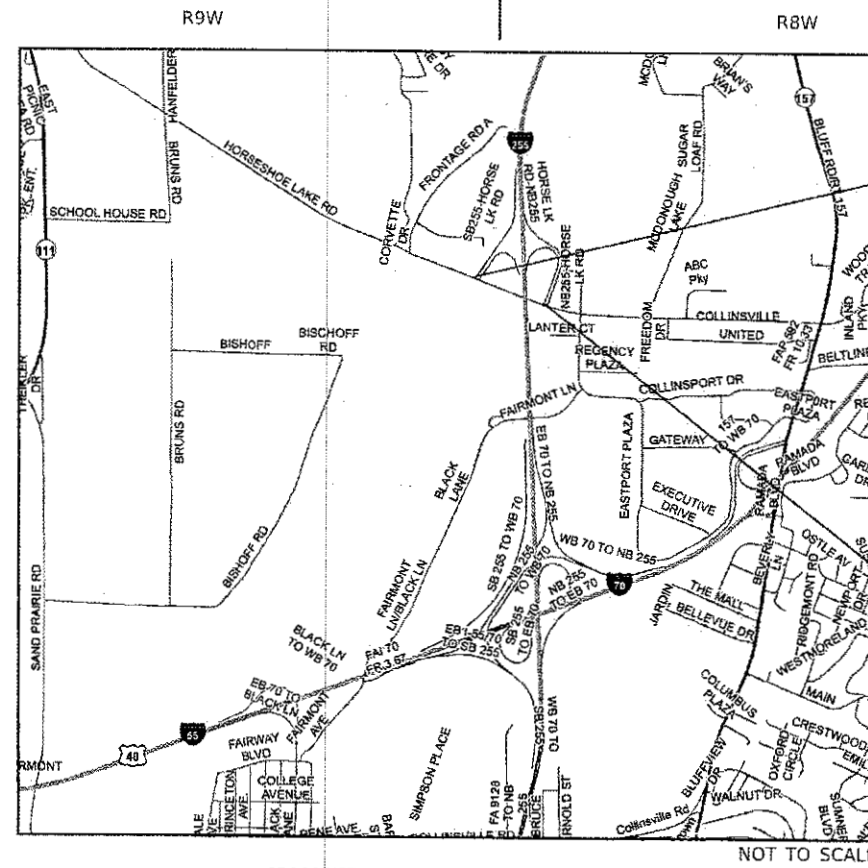

SB EXIT RAMP I-255 AT
HORSESHOE LAKE ROAD
LAT: 38.69185
LONG: -90.03383

NB EXIT RAMP I-255 AT
HORSESHOE LAKE ROAD
LAT: 38.69039
LONG: -90.02890

GROSS/NET LENGTH = 368 FT. = 0.07 MILE

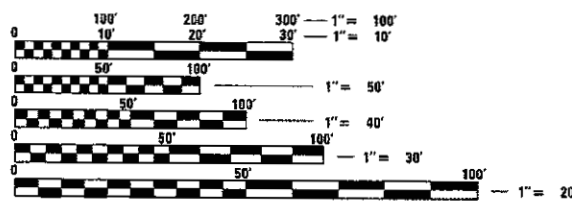

FULL SIZE PLANS HAVE BEEN PREPARED USING STANDARD ENGINEERING SCALES. REDUCED SIZED PLANS WILL NOT CONFORM TO STANDARD SCALES. IN MAKING MEASUREMENTS ON REDUCED PLANS, THE ABOVE SCALES MAY BE USED.

J.U.L.I.E.
JOINT UTILITY LOCATION INFORMATION FOR EXCAVATION
1-800-892-0123
OR 811

PROJECT ENGINEER: HERVE GELIN (618)346-3179
PROJECT MANAGER: BILLIE OWEN (618)346-3209

CONTRACT NO. 76L00

STATE OF ILLINOIS
DEPARTMENT OF TRANSPORTATION

SUBMITTED Feb 1 20 18
Jeffrey Z. Kan REGIONAL ENGINEER
Mar 23 20 18
acno ENGINEER OF DESIGN AND ENVIRONMENT
Mar 29 20 18
David P. [Signature]
DIRECTOR OF HIGHWAYS PROJECT IMPLEMENTATION

PRINTED BY THE AUTHORITY
OF THE STATE OF ILLINOIS

INDEX OF SHEETS

- 1 COVER SHEET
- 2 INDEX OF SHEETS, HIGHWAY STANDARDS, GENERAL NOTES AND COMMITMENTS
- 3-4 SUMMARY OF QUANTITIES
- 5 TYPICAL SECTIONS
- 6-7 RAMP DETAIL SHEETS
- 8-10 ELECTRICAL SHEETS

HIGHWAY STANDARDS

- 000001-06
- 001001-02
- 001006
- 442101-08
- 701011-04
- 701451-05
- 701456-05
- 701901-07
- 780001-05
- 781001-04
- 886001-01
- 886006-01

GENERAL NOTES

1. ILLINOIS STATE LAW REQUIRES A 48-HOUR NOTICE BE GIVEN TO ALL UTILITIES WITHIN THE PROJECT AREA BEFORE DIGGING. FIELD MARKING OF FACILITIES MAY BE OBTAINED BY CONTACTING J.U.L.I.E. OR FOR NON-MEMBERS, THE UTILITY COMPANY DIRECTLY. AGENCIES KNOWN TO HAVE FACILITIES WITHIN THE PROJECT AREA ARE AS FOLLOWS:

- * AT&T ILLINOIS
- * AT&T CORPORATION
- * CHARTER COMMUNICATIONS, INC.
- * CITY OF COLLINSVILLE
- * SOUTHWESTERN ELECTRIC COOPERATIVE, INC.

MEMBERS OF J.U.L.I.E. CALL TOLL FREE (800) 892-0123 OR 811 AND ARE INDICATED BY *. NON- J.U.L.I.E. MEMBERS MUST BE NOTIFIED INDIVIDUALLY.

2. THE DEPARTMENT STRONGLY ENCOURAGES THE PRIME CONTRACTOR AND THEIR APPROVED SUB-CONTRACTORS TO HIRE MINORITY, WOMEN AND DISADVANTAGED INDIVIDUALS FROM ITS FEDERALLY FUNDED HIGHWAY CONSTRUCTION CAREERS TRAINING PROGRAM (HCCTP) TO HELP MEET WORKFORCE AND TRAINEE GOALS. THIS PROGRAM IS TRAINING MINORITIES, WOMEN AND DISADVANTAGED INDIVIDUALS IN HIGHWAY CONSTRUCTION-RELATED SKILLS, E.G., MATH FOR THE TRADES, JOB READINESS, TECHNICAL SKILLS COURSEWORK (CARPENTRY, CONCRETE FLATWORK, BLUEPRINT READING, SITE PLANS, SITE WORK, TOOLS USE, ETC.) AND OSHA 10 HOUR CERTIFICATION, TO PREPARE THEM FOR A CAREER IN THE HIGHWAY CONSTRUCTION TRADES. GRADUATES ARE WELL-TRAINED AND READY TO BECOME PRODUCTIVE ENTRY-LEVEL CONSTRUCTION WORKERS. CONTACT THE DISTRICT 8 EEO OFFICE AT 618-346-3360 AND/OR THE HCCTP COORDINATOR AT 618-874-6528 TO LEARN MORE ABOUT THE PROGRAM AND FOR ASSISTANCE IN MEETING WORKFORCE AND TRAINEE GOALS.
3. THE INTENT OF THE MILLING IS TO REMOVE THE HOT-MIX ASPHALT RESURFACING AND TO SCUFF THE UNDERLYING CONCRETE. IF THE EXISTING CONCRETE IS DETERIORATED, OR THE REBAR IS REACHED, MILLING OF THE CONCRETE SHALL STOP.
4. THE SHORT TERM PAVEMENT MARKING IS FOR STOP BARS AND OTHER MARKING AT THE ENGINEER'S DIRECTION.

COMMITMENTS
NONE

MIX CHART

MIXTURE USE	POLY SURFACE
AC/PG	SBS PG 76-22
RAP % (MAX)	SEE SPECIAL PROVISION
DESIGN AIR VOIDS	4.0%@Ndes=90
MIX COMPOSITION (GRADATION)	IL 9.5
FRICTION AGG	MIXTURE "E"
QUALITY MGMT PROGRAM	QC/QA

MODEL: Default
 FILE NAME: P:\1108\B&E\BIDD\ITEC\Illinois.gov\FWD\DOT\Documents\1108\DOT\Office\District 8\Projects\0876\00\CAD\data\CAD\sheet\0876\00-01-01-01.dgn

USER NAME = challandeske	DESIGNED -	REVISED -
	DRAWN -	REVISED -
PLOT SCALE = 100.0000' / in.	CHECKED -	REVISED -
PLOT DATE = 2/9/2018	DATE -	REVISED -

STATE OF ILLINOIS
DEPARTMENT OF TRANSPORTATION

INDEX OF SHEETS, HIGHWAY STANDARDS
GENERAL NOTES AND COMMITMENTS

SCALE: SHEET OF SHEETS STA. TO STA.

F.A.I. RTE.	SECTION	COUNTY	TOTAL SHEETS	SHEET NO.
255	60-8R5-2	MADISON	10	2
CONTRACT NO. 76L00				
ILLINOIS			FED. AID PROJECT	

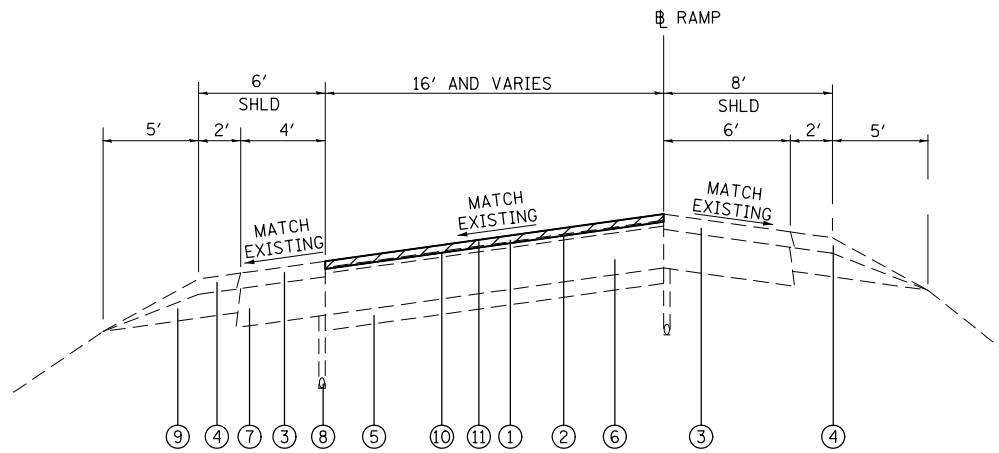

I-255 EXIT RAMPS AT HORSESHOE LAKE RD.

LEGEND

- ① EXISTING POLYMERIZED HOT-MIX ASPHALT SURFACE COURSE, STONE MATRIX ASPHALT, N80, 2" AND VARIES
- ② EXISTING POLYMERIZED HOT-MIX ASPHALT SURFACE COURSE, STONE MATRIX ASPHALT, N80, 2" (LOWER LIFT)
- ③ EXISTING HOT-MIX ASPHALT SHOULDERS, 4" AND VARIES
- ④ EXISTING AGGREGATE SHOULDERS, TYPE B, VARIES 4" TO 0"
- ⑤ EXISTING STABILIZED SUB-BASE 4"
- ⑥ EXISTING PCC PAVEMENT 8" (REINFORCED)
- ⑦ EXISTING HOT-MIX ASPHALT SHOULDER 8"
- ⑧ EXISTING PIPE UNDERDRAINS 4"
- ⑨ EXISTING AGGREGATE SHOULDERS TYPE B
- ⑩ PROPOSED BITUMINOUS MATERIALS (TACK COAT)
- ⑪ POLYMERIZED HOT-MIX ASPHALT SURFACE COURSE, IL-9.5FG, N70 1 1/2"

PROPOSED HOT-MIX ASPHALT SURFACE REMOVAL, 1 1/2"
 THIS HMA SURFACE REMOVAL MAY BE COMPRISED OF A MIX OF HMA AND CONCRETE SURFACE REMOVAL DUE TO THE VARYING DEPTH OF THE EXISTING HMA SURFACE OVER THE PCC PAVEMENT.

MODEL: Default
 FILE: \\nas01.cba.uillinois.gov\pww\DOT\Documents\DOT - Offices\Director\Projects\0876\00\CAD\data\CAD\sheet\0876\00-rt-tyr\cal.dgn

USER NAME = challandeske	DESIGNED -	REVISED -
	DRAWN -	REVISED -
PLOT SCALE = 100.0000' / in.	CHECKED -	REVISED -
PLOT DATE = 2/9/2018	DATE -	REVISED -

STATE OF ILLINOIS
DEPARTMENT OF TRANSPORTATION

TYPICAL SECTIONS

SCALE: NONE SHEET OF SHEETS STA. TO STA.

F.A.I. RTE.	SECTION	COUNTY	TOTAL SHEETS	SHEET NO.
255	60-8R5-2	MADISON	10	5
CONTRACT NO. 76L00				
ILLINOIS FED. AID PROJECT				



HOT-ASPHALT SURFACE REMOVAL, 1½ - 612.0 SQ YDS
 HOT ASPHALT SURFACE COURSE - 1½" - 51.4 TONS
 BITUMINOUS MATERIALS (TACK COAT) - 110.2 POUNDS

THERMOPLASTIC PAVEMENT MARKING LETTERS AND SYMBOLS -
 LEFT ARROW 15.6 SQ FT
 RIGHT ARROW 15.6 SQ FT

WHITE THERMOPLASTIC
 PAVEMENT MARKING LINE 4" - 225'

WHITE THERMOPLASTIC
 PAVEMENT MARKING LINE 8" - 93'

CLASS B, PATCHES

YELLOW THERMOPLASTIC
 PAVEMENT MARKING LINE 4" - 159'

RAISED REFLECTIVE PAVEMENT MARKER - 6 EACH
 3 EACH GORE LINE
 RAISED REFLECTIVE PAVEMENT MARKER REMOVAL - 6 EACH
 3 EACH GORE LINE

WHITE THERMOPLASTIC
 PAVEMENT MARKING LINE 12" - 32'

86'
 155'

PATCHING SCHEDULE

			CLASS B PATCHES	DOWEL	SAW
			TYPE 2, 8"	BARS 1 1/2"	CUTS
	WIDTH	LENGTH	SQ YD	EACH	FOOT
NB EXIT RAMP	4	23	10	28	81

MODEL: Default
 FILE: \\nas0101\B&E\BID\NTEC\Illinois\gov\PI\DOT\Documents\DOT - Offices\Director\B\Projects\0876\00\CAD\data\CAD\sheet\0876\00-rt-eban.dgn

USER NAME = challandeske	DESIGNED -	REVISED -
PLOT SCALE = 40.0000 ' / in.	DRAWN -	REVISED -
PLOT DATE = 1/29/2018	CHECKED -	REVISED -
	DATE -	REVISED -

**STATE OF ILLINOIS
 DEPARTMENT OF TRANSPORTATION**

**I-255 AT HORSESHOE LAKE ROAD
 NORTH BOUND EXIT RAMP DETAIL**

SCALE: 1"=40' SHEET 1 OF 2 SHEETS STA. TO STA.

F.A.I. RTE.	SECTION	COUNTY	TOTAL SHEETS	SHEET NO.
255	60-8R5-2	MAIDSON	10	6
CONTRACT NO. 76L00				
ILLINOIS FED. AID PROJECT				

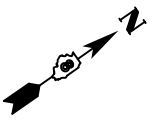

HOT-ASPHALT SURFACE REMOVAL, 1 1/2" - 683.50 SQ YDS
 HOT ASPHALT SURFACE COURSE 1 1/2" - 57.4 TONS
 BITUMINOUS MATERIALS (TACK COAT) - 123.0 POUNDS

THERMOPLASTIC PAVEMENT MARKING LETTERS AND SYMBOLS -
 LEFT ARROW 15.6 SQ FT
 RIGHT ARROW 15.6 SQ FT

WHITE THERMOPLASTIC
 PAVEMENT MARKING LINE 4" - 281'

WHITE THERMOPLASTIC
 PAVEMENT MARKING LINE 8" - 71'

CLASS B, PATCHES

YELLOW THERMOPLASTIC
 PAVEMENT MARKING LINE 4" - 212'

RAISED REFLECTIVE PAVEMENT MARKER - 6 EACH
 3 EACH GORE LINE
 RAISED REFLECTIVE PAVEMENT MARKER REMOVAL - 6 EACH
 3 EACH GORE LINE

WHITE THERMOPLASTIC
 PAVEMENT MARKING LINE 12" - 32'

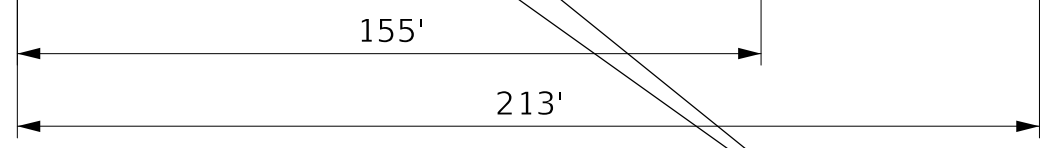

PATCHING SCHEDULE					
			CLASS B PATCHES	DOWEL	SAW
			TYPE 2, 8"	BARS 1 1/2"	CUTS
	WIDTH	LENGTH	SQ YD	EACH	FOOT
SB EXIT RAMP	4	18	8	28	66

MODEL: Default
 FILE: \\nas0101\B&E\BID\NTEC\Illinois\gov\PI\DOT\Documents\DOT - Offices\Director\B\Projects\0876\00\CAD\data\CAD\sheet\0876\00-rt-eban.dgn

USER NAME = challandeske	DESIGNED -	REVISED -
PLOT SCALE = 40.0000' / in.	DRAWN -	REVISIED -
PLOT DATE = 1/29/2018	CHECKED -	REVISIED -
	DATE -	REVISIED -

STATE OF ILLINOIS
DEPARTMENT OF TRANSPORTATION

I-255 SOUTHBOUND EXIT RAMP DETAIL
 SCALE: 1"=40' SHEET 2 OF 2 SHEETS STA. TO STA.

F.A.I. RTE.	SECTION	COUNTY	TOTAL SHEETS	SHEET NO.
255	60-8R5-2	MAIDSON	10	7
CONTRACT NO. 76L00				
ILLINOIS FED. AID PROJECT				

LOOP#	PHASE # (Φ)	LOOP SIZE (FT. X FT.)	REQUIRED # OF TURNS	CALCULATED INDUCTANCE MICROHENRIES (μH)	CALCULATED RESISTANCE OHMS (Ω)
1. EB CCG	6	6' x 6'	6	256.4	0.4
2. EBLT CD	1	6' x 50' (Q)	3-6-3	789.8	1.7
3. EB THRU CD	6	6' x 50' (Q)	3-6-3	786.4	1.6
4. WB CCO	2	6' x 6'	6	256.9	0.4
5. WB THRU CD	2	6' x 50' (Q)	3-6-3	788.9	1.7
6. WBRT CD	2	6' x 50' (Q)	3-6-3	787.8	1.6
7. SBLT CD	8	6' x 50' (Q)	3-6-3	791.9	1.7
8. SBRT CD	8	6' x 50' (Q)	3-6-3	786.7	1.6

THE ABOVE VALUES ARE CALCULATED OF COMBINED LOOP AND LEAD-IN INDUCTANCE AND RESISTANCE. ACTUAL MEASURED VALUES SHOULD BE WITHIN +/- 20% OF THESE VALUES.

Q=QUADRAPOLE

* =SEE DETAIL "A"

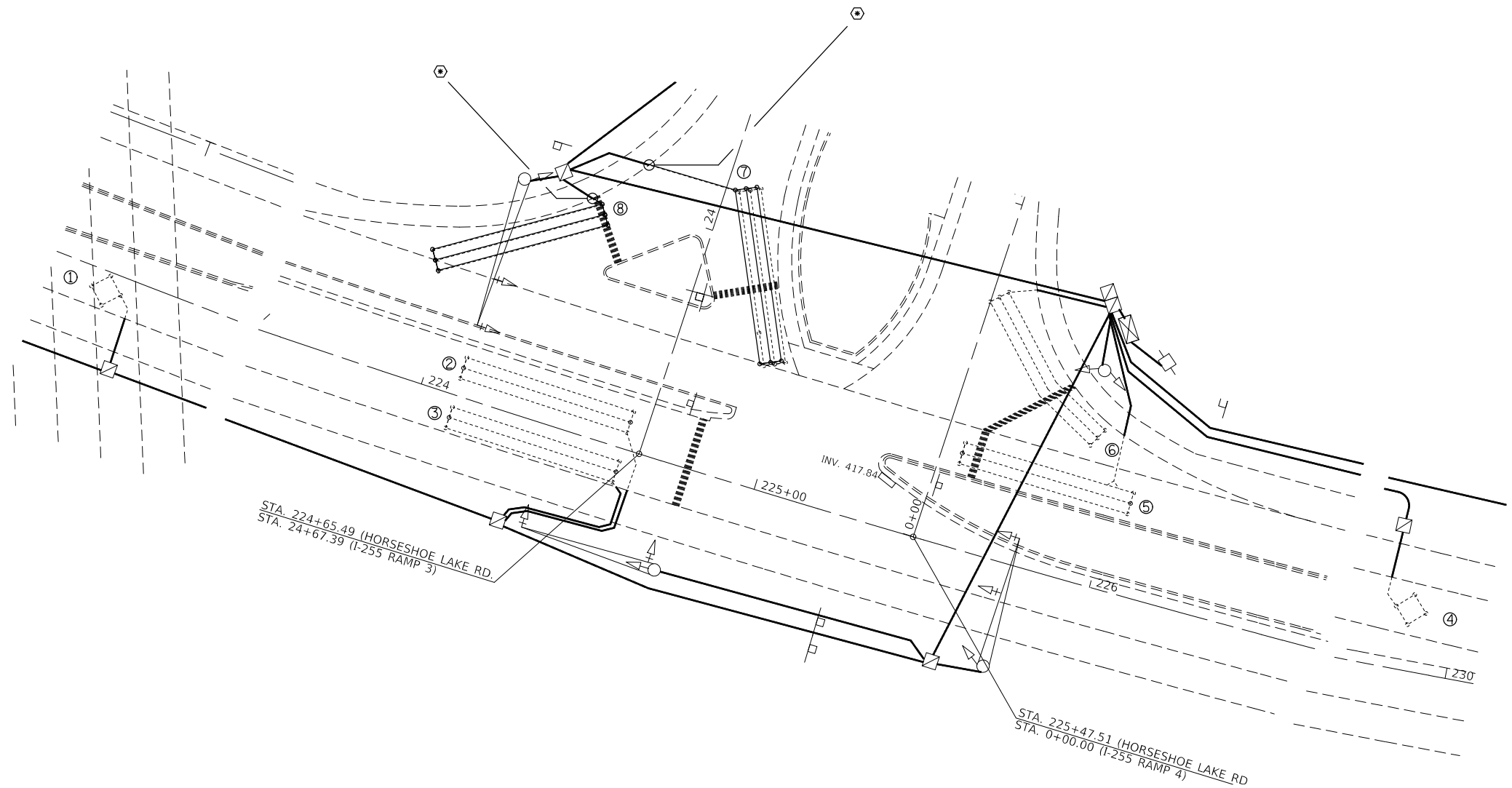

MODEL: Default
 FILE: \\nas101.psu.edu\B&E\BID\NTEC\Illinois.gov\PI\DOT\Documents\1\DOT - Offices\Director\B Projects\08761000\CAD\data\CAD\sheet\08761000-rt-plan.dgn

USER NAME = challandeske	DESIGNED -	REVISED -
	DRAWN -	REVISED -
PLOT SCALE = 40.0000 ' / in.	CHECKED -	REVISED -
PLOT DATE = 1/29/2018	DATE -	REVISED -

**STATE OF ILLINOIS
DEPARTMENT OF TRANSPORTATION**

**NORTHBOUND EXIT RAMP
DETECTOR LOOP REPLACEMENT**

SCALE: 1"=40' SHEET 2 OF 3 SHEETS STA. TO STA.

F.A.I. RTE.	SECTION	COUNTY	TOTAL SHEETS	SHEET NO.
255	60-8R5-2	MAIDSON	10	9
CONTRACT NO. 76L00				
ILLINOIS FED. AID PROJECT				

LOOP#	PHASE # (Φ)	LOOP SIZE (FT. X FT.)	REQUIRED # OF TURNS	CALCULATED INDUCTANCE MICROHENRIES (μH)	CALCULATED RESISTANCE OHMS (Ω)
1. EB LT CD	1	6' x 50' (Q)	3-6-3	786.8	1.6
2. EB LT CD	1	6' x 50' (Q)	3-6-3	786.8	1.6
3. SB LT CD	8	6' x 50' (Q)	3-6-3	786.6	1.6
4. SB RT CD	8	6' x 50' (Q)	3-6-3	787.9	1.6

THE ABOVE VALUES ARE CALCULATED OF COMBINED LOOP AND LEAD-IN INDUCTANCE AND RESISTANCE. ACTUAL MEASURED VALUES SHOULD BE WITHIN +/- 20% OF THESE VALUES.

Q=QUADRAPOLE

* =SEE DETAIL "A"

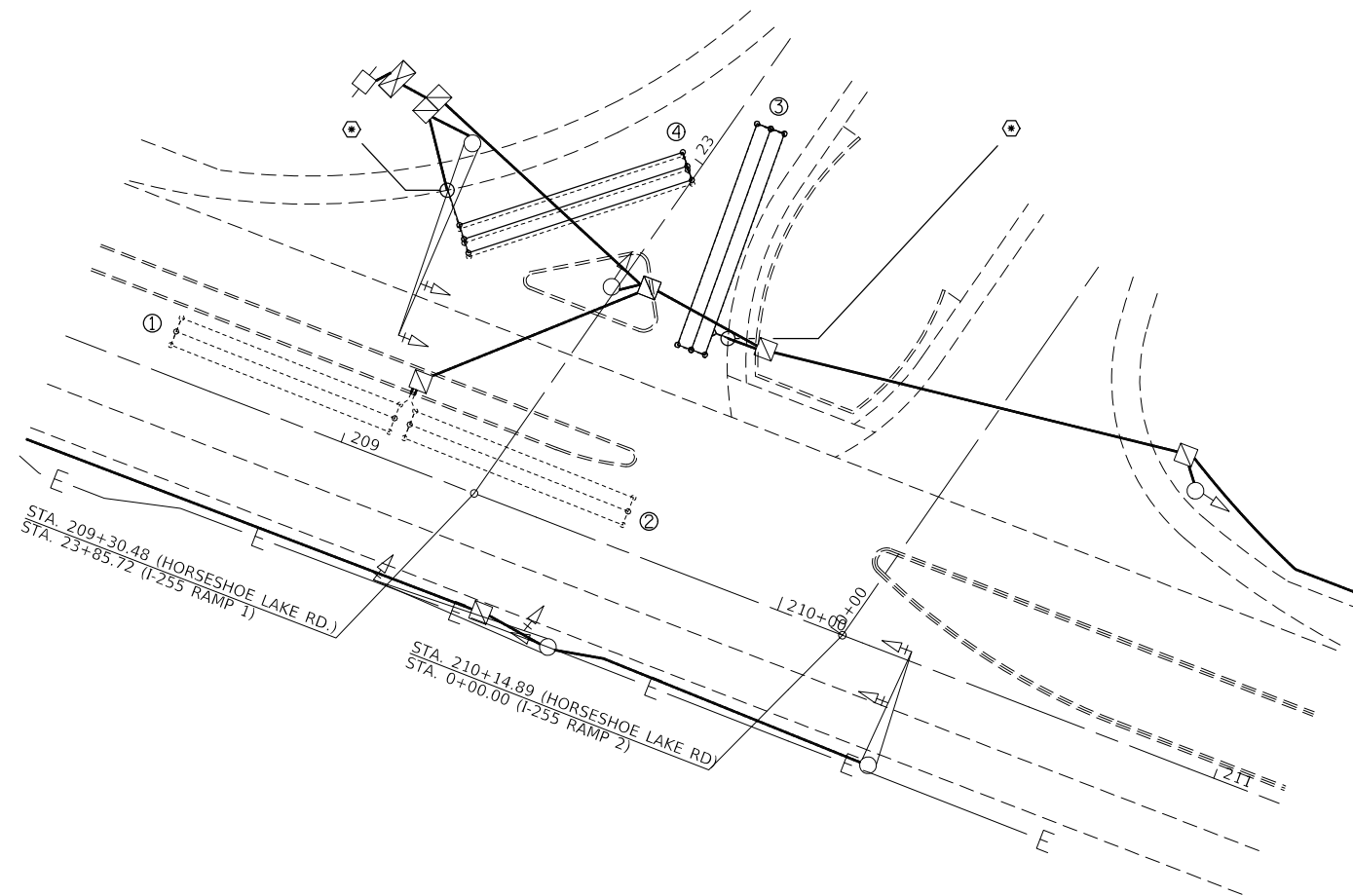

MODEL: Default
FILE: \\nas101.pva\illinois\BID\NTEC\Illinois\gov\PIV\DOT\Documents\DOT - Offices\Director\B\Projects\0876L00\CADD\data\CAD\sheet\0876L00-4-fs-plan.dgn

USER NAME = challandeske	DESIGNED -	REVISED -
	DRAWN -	REVISED -
PLOT SCALE = 40.0000 ' / in.	CHECKED -	REVISED -
PLOT DATE = 1/29/2018	DATE -	REVISED -

**STATE OF ILLINOIS
DEPARTMENT OF TRANSPORTATION**

**SOUTHBOUND EXIT RAMP
DETECTOR LOOP REPLACEMENT**

SCALE: 1"=40' SHEET 3 OF 3 SHEETS STA. TO STA.

F.A.I. RTE.	SECTION	COUNTY	TOTAL SHEETS	SHEET NO.
255	60-8R5-2	MAIDSON	10	10
CONTRACT NO. 76L00				
ILLINOIS FED. AID PROJECT				