

04-27-2018 LETTING ITEM 076

STATE OF ILLINOIS  
DEPARTMENT OF TRANSPORTATION

F.A. RTE.	SECTION	COUNTY	TOTAL SHEETS	SHEET NO.
VAR.	D2 BDS 2018-4	VARIOUS	18	1
		ILLINOIS	CONTRACT NO. 64M88	

FOR INDEX OF SHEETS, SEE SHEET NO. 2  
FOR STATE STANDARDS, SEE SHEET NO. 2

# PROPOSED HIGHWAY PLANS

VARIOUS ROUTES  
SECTION D2 BDS 2018-4  
TYPE of IMPROVEMENT: BRIDGE DECK SEALING  
VARIOUS COUNTIES

C-92-042-18

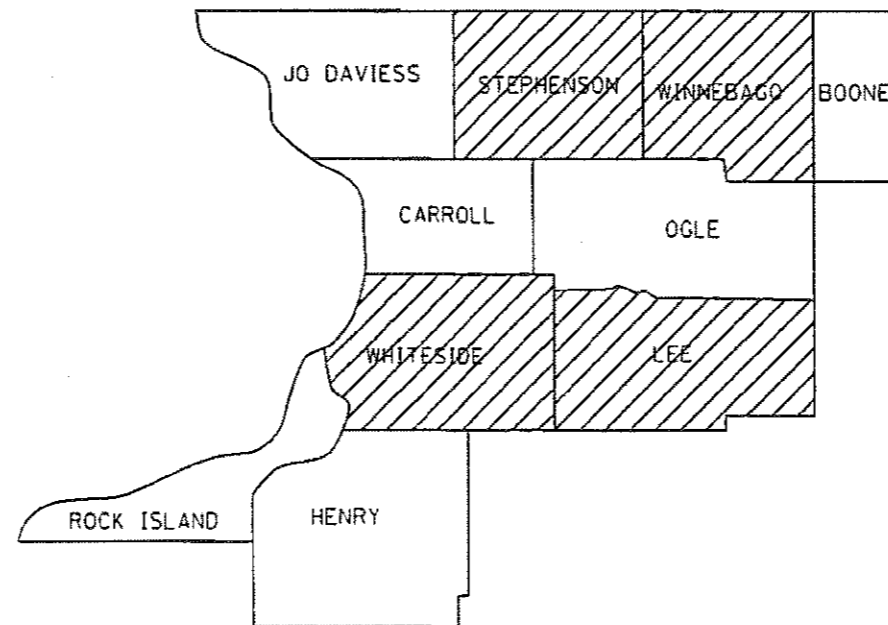
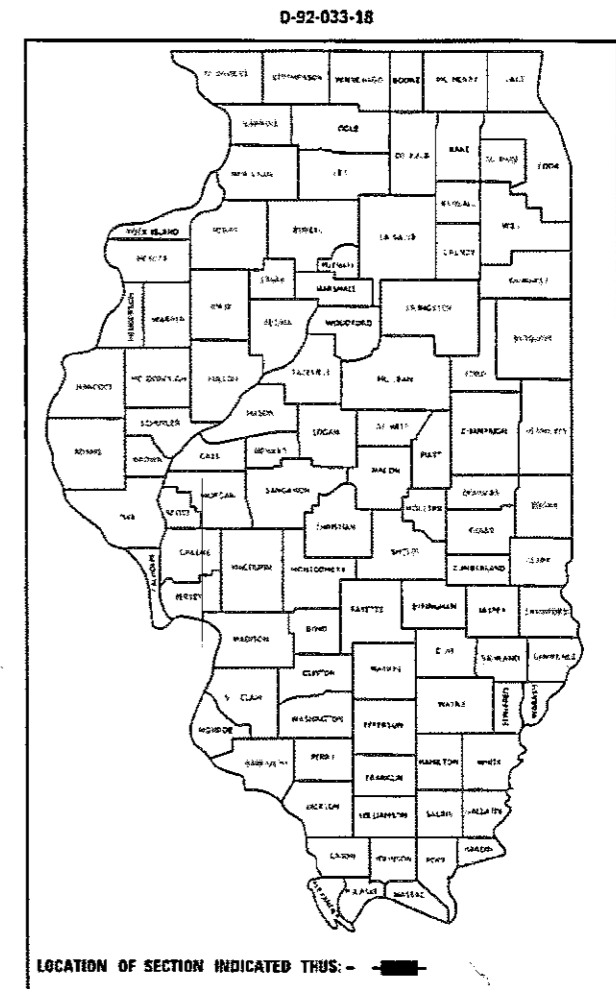

DISTRICT 2

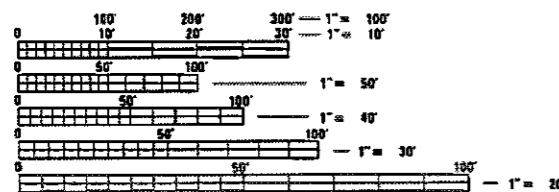

FULL SIZE PLANS HAVE BEEN PREPARED USING STANDARD ENGINEERING SCALES. REDUCED SIZED PLANS WILL NOT CONFORM TO STANDARD SCALES. IN MAKING MEASUREMENTS ON REDUCED PLANS, THE ABOVE SCALES MAY BE USED.

J.U.L.I.E.  
JOINT UTILITY LOCATION INFORMATION FOR EXCAVATION  
1-800-892-0123  
OR 811

PROJECT ENGINEER: DAVID BOSS (815) 284-5416  
PROJECT MANAGER: MAHMOUD ETEMADI (815) 284-5393

CONTRACT NO. 64M88

STATE OF ILLINOIS  
DEPARTMENT OF TRANSPORTATION

SUBMITTED Feb 7 2018  
K. S. Marshall  
REGIONAL ENGINEER

Mar 23 2018  
Scott A. Elk  
Acting ENGINEER OF DESIGN AND ENVIRONMENT

Mar 23 2018  
Paul P. Chisholm  
DIRECTOR OF HIGHWAYS PROJECT IMPLEMENTATION

PRINTED BY THE AUTHORITY  
OF THE STATE OF ILLINOIS

# INDEX OF SHEETS

- 1 COVER SHEET
- 2 INDEX OF SHEETS, STATE STANDARDS & GENERAL NOTES
- 3 SUMMARY OF QUANTITIES
- 4 SCHEDULE OF QUANTITIES
- 5 SEALING DETAIL
- 6 LOCATION MAP LEE COUNTY
- 7 LOCATION MAP STEPHENSON COUNTY
- 8 LOCATION MAP WHITESIDE COUNTY
- 9 LOCATION MAP WINNEBAGO COUNTY
- 10-13 WORK ZONE SIGN DETAILS (DISTRICT STANDARD 34.1)
- 14-17 TRAFFIC CONTROL FOR TRANSITION AREAS (DISTRICT STANDARD 38.1)
- 18 TRAFFIC CONTROL AND PROTECTION AT TURN BAYS (TO REMAIN OPEN TO TRAFFIC) (DISTRICT STANDARD 94.2)

# GENERAL NOTES

THE CONCRETE SEALER SHALL BE APPLIED TO THE ENTIRE TOP SURFACE OF THE DECK, INCLUDING THE INSIDE FACES AND TOPS OF PARAPETS.

WATER BASED CONCRETE SEALERS WILL NOT BE ALLOWED.

WORK ON THIS PROJECT MAY POTENTIALLY CONFLICT WITH WORK ON OTHER CONTRACTS IN THE AREA. THE CONTRACTOR SHOULD BE PREPARED TO PLAN FOR POTENTIAL DELAYS AND COOPERATE WITH CONTRACTORS ON THE OTHER PROJECTS.

NO WORK SHALL BE PERFORMED ON THIS CONTRACT AFTER NOVEMBER 15 OR PRIOR TO APRIL 15.

NO STREAM PERMITS HAVE BEEN PROCURED FOR THIS PROJECT. NONE ARE REQUIRED FROM THE REGULATORY AGENCIES AS LONG AS THERE IS NO DEBRIS FALLING OR BEING PLACED INTO THE STREAM. ANY TEMPORARY FILL IN THE STREAM OR THE COMPROMISING OF THE DIKE (IF APPLICABLE) WILL NOT BE ALLOWED. IF THE CONTRACTOR CHOOSES TO USE ALTERNATE/MODIFIED CONSTRUCTION METHOD(S) FROM THE AFOREMENTIONED, THEY WILL BE RESPONSIBLE FOR OBTAINING THE PROPER PERMITS. NO RELIEF OR COMPENSATION WILL BE GIVEN FOR ANY DELAYS, WORKING DAYS CHARGED, OR CALENDAR DAYS EXPIRED AS A RESULT OF THE LOSS TIME OR DELAY DURING THE RE-SUBMITTAL PROCESS TO PROCURE THE NECESSARY PERMIT(S) DUE TO THE CONTRACTOR CHOOSING ALTERNATE/MODIFIED CONSTRUCTION METHOD(S). ABSOLUTELY NO CONSTRUCTION ACTIVITIES WILL TAKE PLACE WITHOUT THE PROPER PERMITS BEING SECURED.

# STATE STANDARDS

- 701006-05 OFF-RD OPERATIONS, 2L, 2W, 15'(4.5m) TO 24"(600mm) FROM PAVEMENT EDGE
- 701101-05 OFF-RD OPERATIONS, MULTILANE, 15'(4.5m) TO 24"(600mm) FROM PAVEMENT EDGE
- 701201-04 LANE CLOSURE, 2L, 2W, DAY ONLY, FOR SPEEDS  $\geq$  45 MPH
- 701306-04 LANE CLOSURE, 2L, 2W, SLOW MOVING OPERATIONS DAY ONLY, FOR SPEEDS  $\geq$  45 MPH
- 701400-09 APPROACH TO LANE CLOSURE, FREEWAY/EXPRESSWAY
- 701406-11 LANE CLOSURE, FREEWAY/EXPRESSWAY, DAY OPERATIONS ONLY
- 701426-09 LANE CLOSURE, MULTILANE, INTERMITTENT OR MOVING OPER., FOR SPEEDS  $\geq$  45 MPH
- 701901-07 TRAFFIC CONTROL DEVICES

MODEL: Default FILE NAME: \\ILLINOIS\DOT\Documents\DOT Office\District 2\Projects\Operations\Bridges\Section\Bridges\Deck Sealing\Contracts\1018161MBVCAD\1018161-18-ent-cover.dgn

USER NAME = dssidd PLOT SCALE = 100.0000' / in. PLOT DATE = Feb-05-2018 02:33:51 PM	DESIGNED - _____ DRAWN - _____ CHECKED - _____ DATE - _____	REVISED - _____ REVISED - _____ REVISED - _____ REVISED - _____	<b>STATE OF ILLINOIS DEPARTMENT OF TRANSPORTATION</b>	<b>INDEX OF SHEETS STATE STANDARDS &amp; GENERAL NOTES</b>	<table border="1" style="width: 100%; border-collapse: collapse;"> <tr> <td style="font-size: small;">F.A. RTE.</td> <td style="font-size: small;">SECTION</td> <td style="font-size: small;">COUNTY</td> <td style="font-size: small;">TOTAL SHEETS</td> <td style="font-size: small;">SHEET NO.</td> </tr> <tr> <td style="font-size: x-small;">VAR.</td> <td style="font-size: x-small;">D2 BDS 2018-4</td> <td style="font-size: x-small;">VARIOUS</td> <td style="font-size: x-small;">18</td> <td style="font-size: x-small;">2</td> </tr> <tr> <td colspan="5" style="font-size: x-small; text-align: right;">CONTRACT NO. 64M88</td> </tr> <tr> <td colspan="5" style="font-size: x-small; text-align: right;">ILLINOIS FED. AID PROJECT</td> </tr> </table>	F.A. RTE.	SECTION	COUNTY	TOTAL SHEETS	SHEET NO.	VAR.	D2 BDS 2018-4	VARIOUS	18	2	CONTRACT NO. 64M88					ILLINOIS FED. AID PROJECT				
F.A. RTE.	SECTION	COUNTY	TOTAL SHEETS	SHEET NO.																					
VAR.	D2 BDS 2018-4	VARIOUS	18	2																					
CONTRACT NO. 64M88																									
ILLINOIS FED. AID PROJECT																									
			SCALE: _____ SHEET ____ OF ____ SHEETS STA. _____ TO STA. _____																						

# SUMMARY OF QUANTITIES

CODE NUMBER	ITEM	UNIT	100% STATE	100% STATE			
			TOTAL QUANTITY	VARIOUS COUNTIES 0047			
X5870015	BRIDGE DECK CONCRETE SEALER	SQ FT	196,449	196,449			
67100100	MOBILIZATION	L SUM	1	1			
70100450	TRAFFIC CONTROL AND PROTECTION, STANDARD 701201	L SUM	1	1			
70100700	TRAFFIC CONTROL AND PROTECTION, STANDARD 701406	L SUM	1	1			

MODEL: Default  
 FILE NAME: P:\V\LOE\BID\INTEC\Illinois.gov\FWID\DOT\Documents\DOT\_Offices\District\_2\Projects\Operations\op\_Section\bridge\_Deck\_Sealing\_Contract\2018\64M88\CADD\02-042-18-FN-cover.dwg

USER NAME = dosidd	DESIGNED - _____	REVISED - _____
DRAWN - _____	CHECKED - _____	REVISED - _____
PLOT SCALE = 100.0000' / in.	DATE - _____	REVISED - _____
PLOT DATE = Feb-05-2018 02:34:02 PM		

**STATE OF ILLINOIS  
DEPARTMENT OF TRANSPORTATION**

**SUMMARY OF QUANTITIES**

SCALE: \_\_\_\_\_ SHEET \_\_\_\_\_ OF \_\_\_\_\_ SHEETS STA. \_\_\_\_\_ TO STA. \_\_\_\_\_

F.A. RTE.	SECTION	COUNTY	TOTAL SHEETS	SHEET NO.
VAR.	D2 BDS 2018-4	VARIOUS	18	3
CONTRACT NO. 64M88			ILLINOIS FED. AID PROJECT	

# SCHEDULE OF QUANTITIES

SN	FacilityCarried	FeatureCrossed	Location	Length Total	Bridge Rdwy Width	Area to be Sealed	Traffic Control Standard
0520020	ILL 38	FRANKLIN CREEK	.6 MI W FRANKLIN GR	156.4	36	6,491	701201
0520060	US 52	GREEN RIVER	SOUTH EDGE OF AMBOY	193.5	32	7,256	701201
0520061	ILL 26	COON CREEK	3.2 MI S OF AMBOY RD	105	32	3,938	701201
0520062	IL 26	C & NW RR	S EDGE OF DIXON	172.6	56	10,615	701400 & 701406 OR 701746
0520064	FAP 561-IL 2 EB	LITTLE CREEK	W SAUK VAL. COLLEGE	61.5	40	2,798	701400 & 701406 OR 701746
0520065	FAP 561-IL 2 EB	DRAINAGE DITCH	E SAUK VAL. COLLEGE	72.7	40	3,308	701400 & 701406 OR 701746
0520066	US 30	5 MILE BRANCH CREEK	2.5 MI. W. OF IL 26	116.8	36	4,847	701201
0520067	US 30	HOWLAND CREEK	E. WHITESIDE CO. LN.	167.8	36	6,964	701201
0520068	IL 251	BUREAU CREEK	.9 MI N LASALLE CO	120	40	5,460	701201
* 0520069	IL 251	WILLOW CREEK	0.8 MI. N. OF US 30	103.4	31.5	3,826	701201
* 0520070	ILL 251	STEWARD CREEK	2.5 MI. NW. STEWARD	90.2	31.5	3,337	701201
* 0890008	US 20 BR	YELLOW CREEK	1 MI E FREEPORT	178	63.5	12,282	701201
* 0986000	US 30	LINCOLN ST/DAKIN RD	.5 MI. W OF IL 84	205.7	40	9,668	701201
* 0986001	US 30	UNION PACIFIC RR	.6 MI. W OF IL 84	166.3	40	7,816	701201
* 1010195	US 20 EB	W CHANNEL ROCK RIVER	.5 MI. E OF IL 2	407.9	42	20,273	701400 & 701406 OR 701746
* 1010196	US 20 WB	W CHANNEL ROCK RIVER	.5 MI. E OF IL 2	407.9	42	20,273	701400 & 701406 OR 701746
* 1010197	US 20 EB	E CHANNEL ROCK RIVER	.7 MI. E OF IL 2	437	42	21,719	701400 & 701406 OR 701746
* 1010198	US 20 WB	E CHANNEL ROCK RIVER	.7 MI. E OF IL 2	437	42	21,719	701400 & 701406 OR 701746
* 1010193	I-90 SB	DRY CREEK	1 MI. S OF IL 75	153.3	65.7	11,252	701400 & 701406 OR 701746
* 1010194	I-90 NB	DRY CREEK	1 MI. S OF IL 75	153.3	59.5	10,302	701400 & 701406 OR 701746

\* NIGHT WORK (HOUR RESTRICTIONS) (SEE SPECIAL PROVISIONS)

MODEL: Default  
FILE: \\mhc-pw\ulib\B&E\BID\ITEC\Illinois\gov\p\W\DOT\Documents\BID\Office\BID\BID\Contract\2018\64M88\CADD\092-042-18-shc-cover.dgn

USER NAME = drossdd	DESIGNED - _____	REVISED - _____	<b>STATE OF ILLINOIS DEPARTMENT OF TRANSPORTATION</b>	<b>SCHEDULE OF QUANTITIES</b>			F.A. RTÉ.	SECTION	COUNTY	TOTAL SHEETS	SHEET NO.	
PLOT SCALE = 100,0000' / in.	CHECKED - _____	REVISED - _____		SCALE: _____	SHEET _____	OF _____	SHEETS	VAR.	D2 BDS 2018-4	VARIOUS	18	4
PLOT DATE = Feb-09-2018 07:48:20 AM	DATE - _____	REVISED - _____		STA. _____	TO STA. _____	CONTRACT NO. 64M88						
ILLINOIS FED. AID PROJECT												

# SEALING DETAIL

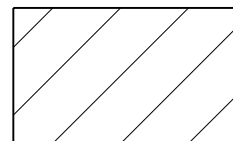
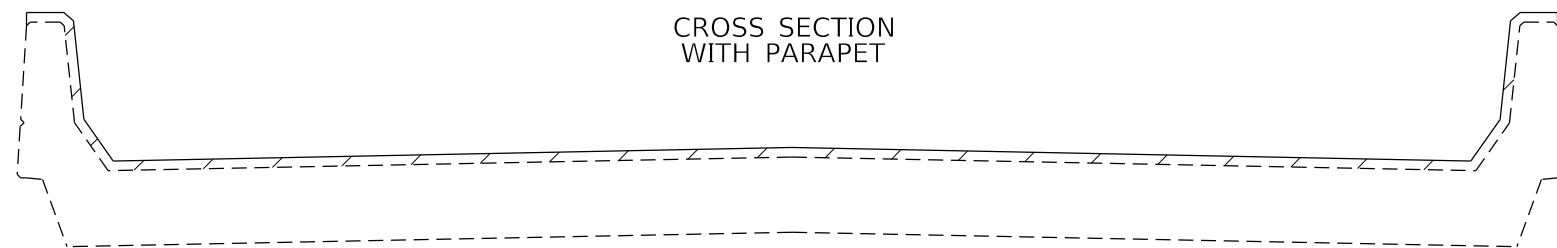
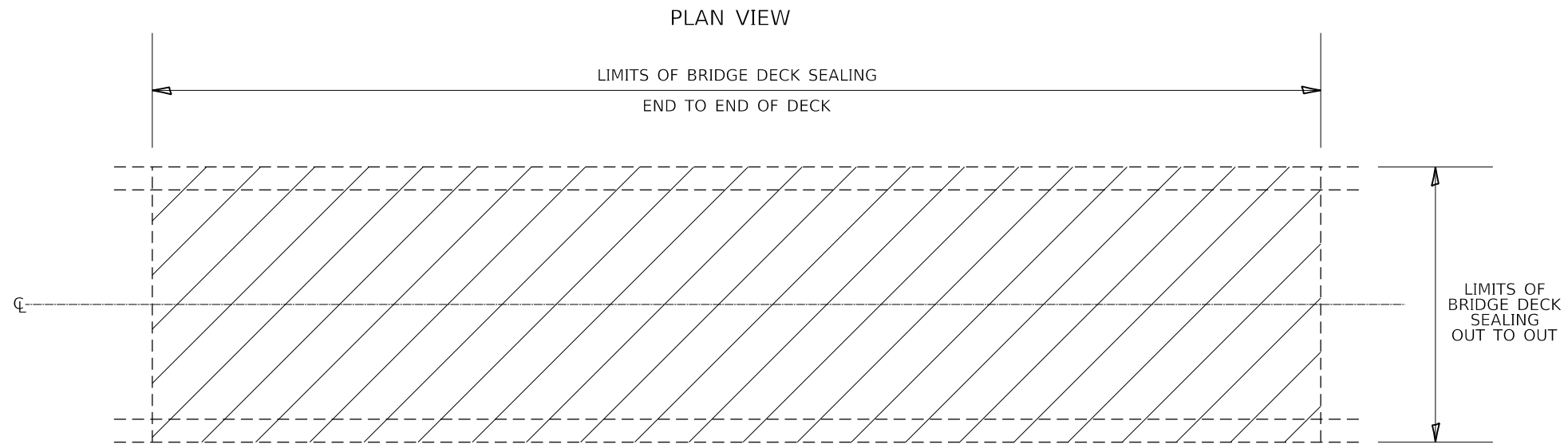

AREA TO BE SEALED

MODEL: Default  
 FILE NAME: P:\ILLINOIS\BID\NTEC\Illinois.gov\PIW\DOT\Documents\DOT\_Offices\District 2\Projects\Operations\Bridges\_Section\Bridges\_Deck\_Sealing\_Contracts\2018\64M88\CADD\092-042-18-sht-cover.dgn

USER NAME = dossed	DESIGNED - _____	REVISED - _____
	DRAWN - _____	REVISED - _____
PLOT SCALE = 100.0000' / in.	CHECKED - _____	REVISED - _____
PLOT DATE = Feb-05-2018 02:34:16 PM	DATE - _____	REVISED - _____

**STATE OF ILLINOIS  
DEPARTMENT OF TRANSPORTATION**

**SEALING DETAIL**

SCALE: \_\_\_\_\_ SHEET \_\_\_\_ OF \_\_\_\_ SHEETS STA. \_\_\_\_\_ TO STA. \_\_\_\_\_

F.A. RTE.	SECTION	COUNTY	TOTAL SHEETS	SHEET NO.
VAR.	D2 BDS 2018-4	VARIOUS	18	5
			CONTRACT NO. 64M88	
		ILLINOIS	FED. AID PROJECT	



# LOCATION MAP STEPHENSON COUNTY

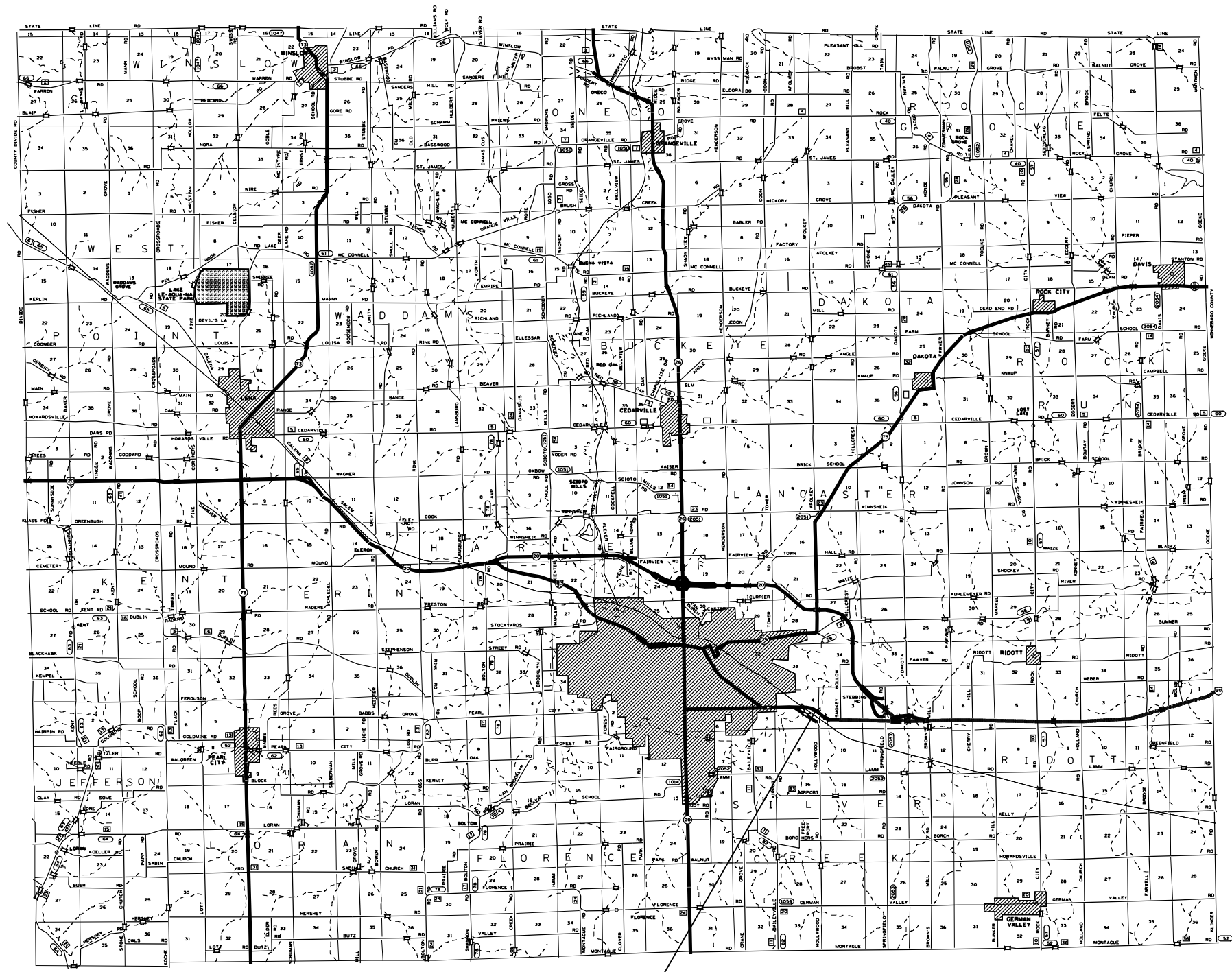

SN 089-0008

MODEL: Default  
 FILE: \\p1108\B&E\ID\NITEC\Illinois\poc\RW\DOT\Documents\DOT\_Offices\District 2\Projects\Operations\Bldg\_Section\Bldg\_Deck\_Scaling\_Contract\2018\64M88\CADD\092-042-18-shr-cover.dgn

USER NAME = dossed	DESIGNED - _____	REVISED - _____
	DRAWN - _____	REVISED - _____
PLOT SCALE = 100,0000' / in.	CHECKED - _____	REVISED - _____
PLOT DATE = Feb-05-2018 02:34:37 PM	DATE - _____	REVISED - _____

STATE OF ILLINOIS  
DEPARTMENT OF TRANSPORTATION

LOCATION MAP STEPHENSON COUNTY

SCALE: \_\_\_\_\_ SHEET \_\_\_\_\_ OF \_\_\_\_\_ SHEETS STA. \_\_\_\_\_ TO STA. \_\_\_\_\_

F.A. RTE.	SECTION	COUNTY	TOTAL SHEETS	SHEET NO.
VAR.	D2 BDS 2018-4	VARIOUS	18	7
CONTRACT NO. 64M88				
ILLINOIS FED. AID PROJECT				

# LOCATION MAP WHITESIDE COUNTY

SN 098-6000 &  
SN 098-6001

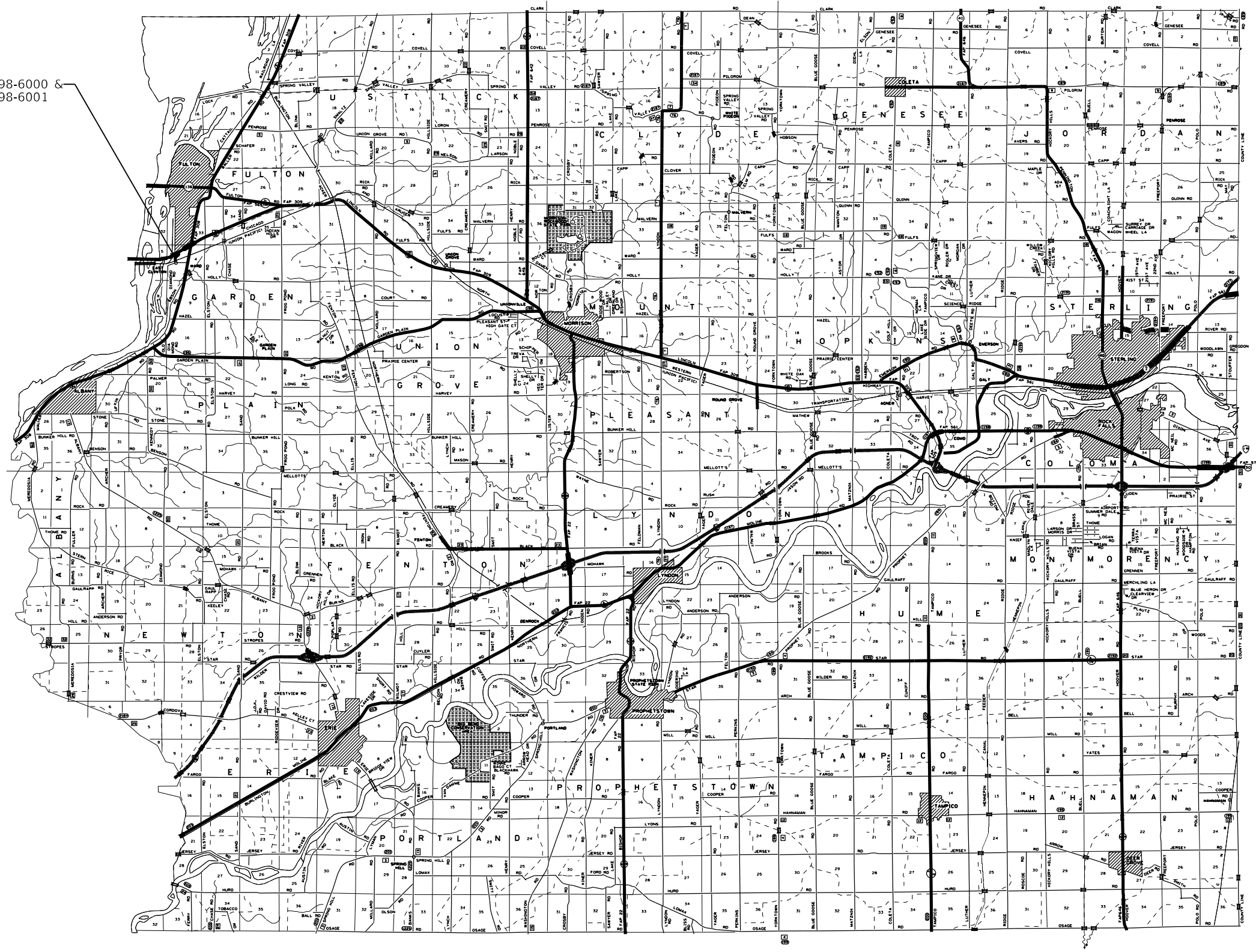

MODEL: Default  
 FILE: \\mtrc-pw\pub\B&E\ID\ITC\Illinois\gov\PWDOT\Documents\DOT\_Offices\District\_2\Projects\Operations\Bridges\_Section\Bridges\_Deck\_Sealing\_Contracts\2018\64M88\CADD\092-042-1B-shc-cover.dgn

USER NAME = drossd	DESIGNED - _____	REVISED - _____
	DRAWN - _____	REVISED - _____
PLOT SCALE = 100,000' / in.	CHECKED - _____	REVISED - _____
PLOT DATE = Feb-05-2018 02:34:45 PM	DATE - _____	REVISED - _____

STATE OF ILLINOIS  
DEPARTMENT OF TRANSPORTATION

LOCATION MAP WHITESIDE COUNTY

SCALE: \_\_\_\_\_ SHEET \_\_\_\_\_ OF \_\_\_\_\_ SHEETS STA. \_\_\_\_\_ TO STA. \_\_\_\_\_

F.A. RTE.	SECTION	COUNTY	TOTAL SHEETS	SHEET NO.
VAR.	D2 BDS 2018-4	VARIOUS	18	8
CONTRACT NO. 64M88				
ILLINOIS FED. AID PROJECT				



# LOCATION MAP WINNEBAGO COUNTY

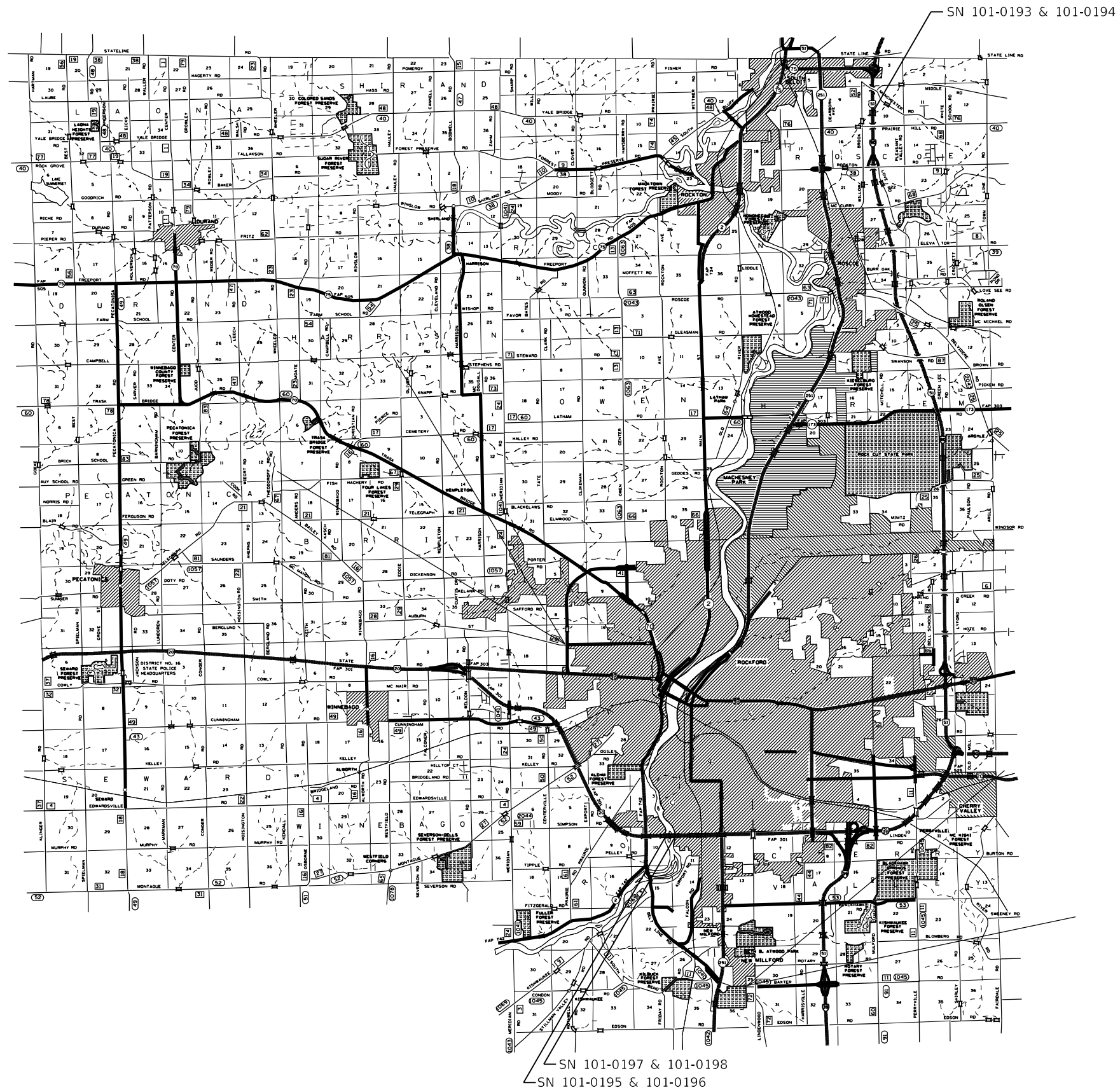

SN 101-0193 & 101-0194

SN 101-0197 & 101-0198  
SN 101-0195 & 101-0196

Model: Default  
FILE NAME: p:\u0008&E\ID\NTEC\Illinois\poc\PW\DOT\Documents\DOT\Office\District 2\Projects\Operations\Barge\_Section\Barge\_Deck\_Scaling\_Contract\2018\64M88\CADD\092-042-18-INT-cover.dgn

USER NAME = dossed	DESIGNED - _____	REVISED - _____
PLOT SCALE = 100,000' / in.	DRAWN - _____	REVISED - _____
PLOT DATE = Feb-05-2018 02:34:53 PM	CHECKED - _____	REVISED - _____
	DATE - _____	REVISED - _____

STATE OF ILLINOIS  
DEPARTMENT OF TRANSPORTATION

LOCATION MAP WINNEBAGO COUNTY	
SCALE: _____	SHEET _____ OF _____ SHEETS
STA. _____ TO STA. _____	

F.A. RTE.	SECTION	COUNTY	TOTAL SHEETS	SHEET NO.
VAR.	D2 BDS 2018-4	VARIOUS	18	9
CONTRACT NO. 64M88				
ILLINOIS FED. AID PROJECT				

# WORK ZONE SIGN DETAILS

**ILLINOIS STANDARD G20-I100**

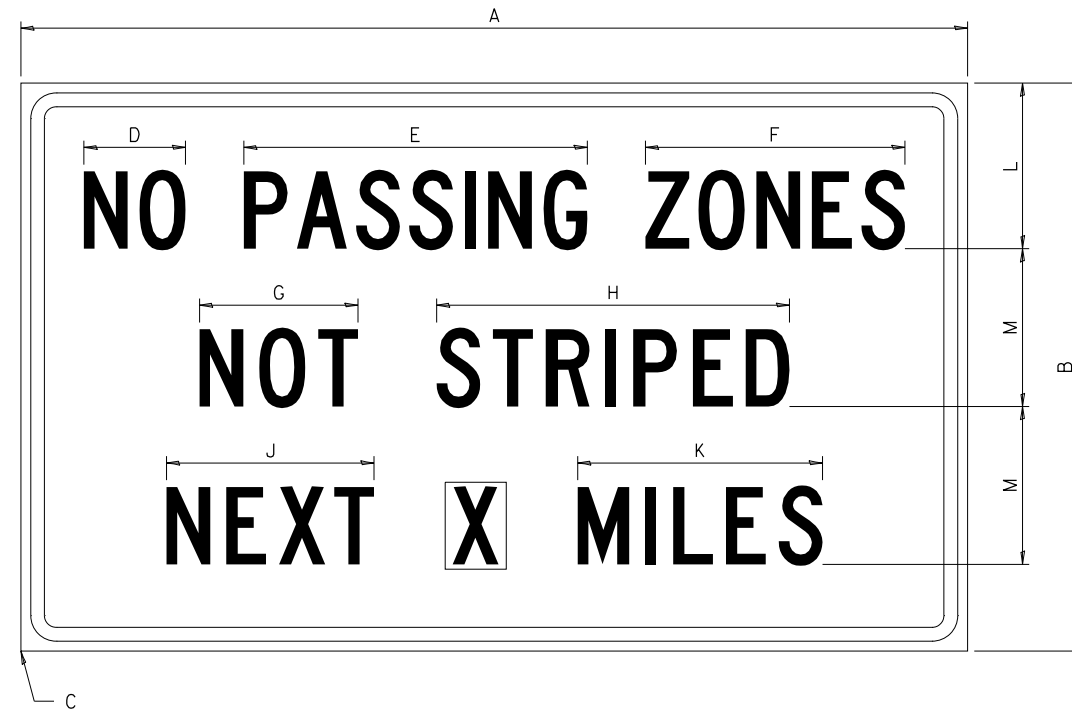

COLOR LEGEND AND BORDER BACKGROUND BLACK ORANGE NON-REFLECTORIZED REFLECTORIZED

SIGN SIZE	DIMENSIONS											
	A	B	C	D	E	F	G	H	J	K	L	M
60 x 36	60.00	36.00	2.25	6.4	21.80	16.40	10.00	22.40	13.20	15.50	10.50	10.00

SIGN SIZE	SERIES BY LINE			MARGIN	BORDER
	1	2	3		
60 x 36	5C	5C	5C	0.625	0.875

Sign not to scale

**ILLINOIS STANDARD W8-I107**

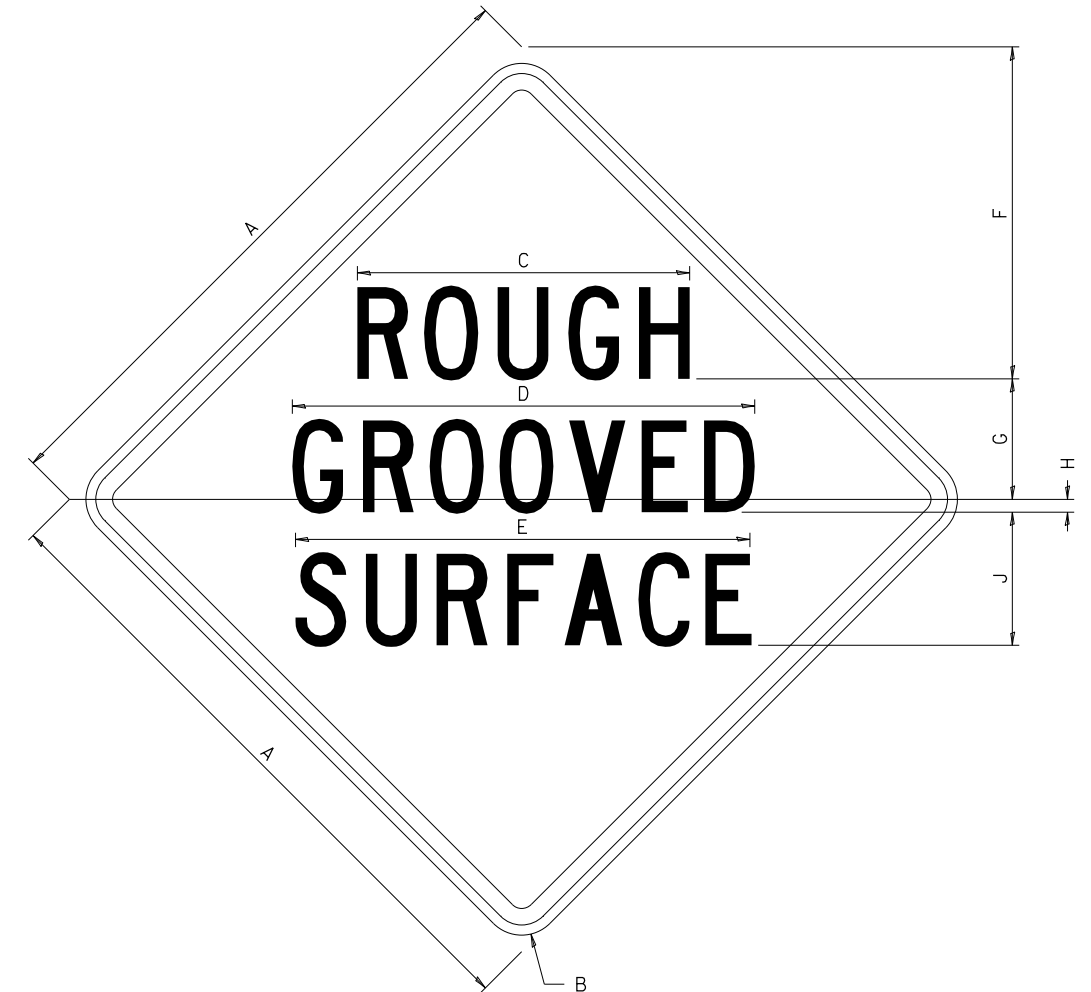

COLOR LEGEND AND BORDER BACKGROUND BLACK ORANGE NON-REFLECTORIZED REFLECTORIZED

SIGN SIZE	DIMENSIONS								
	A	B	C	D	E	F	G	H	J
48 x 48	48.00	3.00	25.00	34.80	34.20	24.94	9.00	1.00	10.00

SIGN SIZE	SERIES BY LINE			MARGIN	BORDER
	1	2	3		
48 x 48	7C	7C	7C	1.250	0.750

Sign not to scale

**GENERAL NOTES**

All work to furnish and install these signs shall be included in the cost of the specified traffic control standards and shall not be paid separately.

All Illinois Standard signs shall conform to the latest edition of the "Illinois Standard Highway Signs Book" in effect on the date of invitation for bids.

Signs shall meet the applicable portions of Sections 701 and 720 of the Standard Specifications.

All dimensions are in inches unless otherwise noted.

FILE NAME =	USER NAME = dosddd	DESIGNED -	REVISED - 3-02-16
p:\11\084EBIDINTEG\illinois.gov\PI\DOT\Documents\DOT Offices\District 2\Projects\Open Bridge-Section\Bridge Deck Sealings\REVISED\2018\64M88\CADD\092-042-18-sheet-cover.dgn		DRAWN -	REVISED -
	PLOT SCALE = 100.0000' / in.	CHECKED -	REVISED -
	PLOT DATE = Feb-05-2018 02:35:02 PM	DATE -	REVISED -

**STATE OF ILLINOIS  
DEPARTMENT OF TRANSPORTATION**

**REGION 2 / DISTRICT 2 STANDARD**

SCALE: \_\_\_\_\_ SHEET NO. \_\_\_\_ OF \_\_\_\_ SHEETS STA. \_\_\_\_\_ TO STA. \_\_\_\_\_

F.A. RTE.	SECTION	COUNTY	TOTAL SHEETS	SHEET NO.
VAR.	D2 BDS 2018-4	VARIOUS	18	10
FED. ROAD DIST. NO. _____ ILLINOIS FED. AID PROJECT			CONTRACT NO. 64M88	

# WORK ZONE SIGN DETAILS

## ILLINOIS STANDARD W12-I102

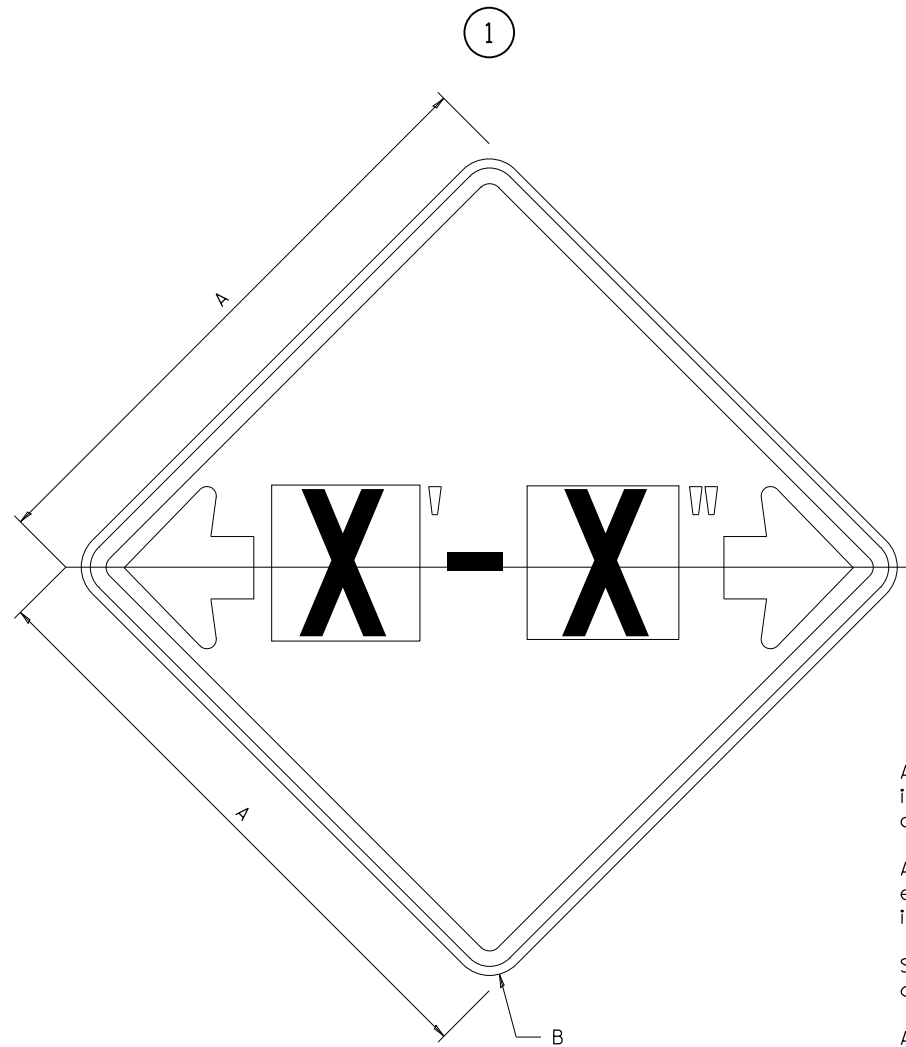

### GENERAL NOTES

All work to furnish and install these signs shall be included in the cost of the specified traffic control standards and shall not be paid separately.

All Illinois Standard signs shall conform to the latest edition of the "Illinois Standard Highway Signs Book" in effect on the date of invitation for bids.

Signs shall meet the applicable portions of Sections 701 and 720 of the Standard Specifications.

All dimensions are in inches unless otherwise noted.

COLOR LEGEND AND BORDER BACKGROUND BLACK FL ORANGE NON-REFLECTORIZED REFLECTORIZED

SIGN SIZE	DIMENSIONS	
	A	B
48 x 48	48.00	3.00

① Illinois Standard signs W12-I102 and W12-I103 shall be used as described in the special provisions.

SIGN SIZE	SERIES BY LINE	MARGIN	BORDER
	1		
48 x 48	12C	0.750	1.250

Sign not to scale

## ILLINOIS STANDARD W12-I103

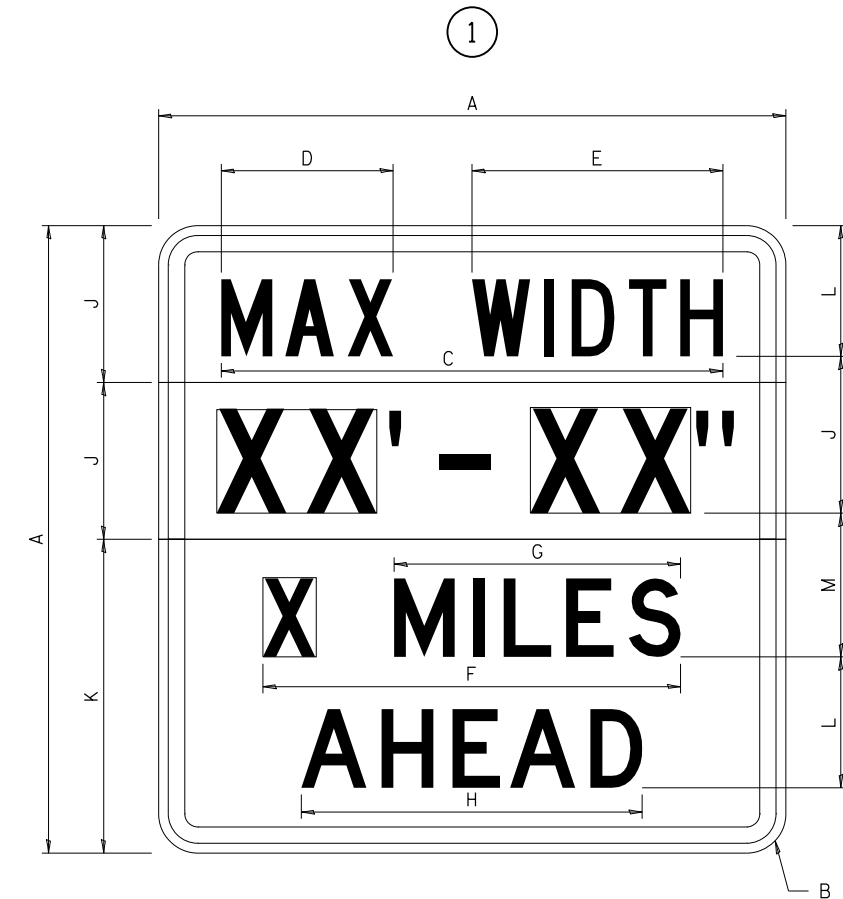

COLOR LEGEND AND BORDER BACKGROUND (WIDTH) BLACK WHITE FL ORANGE NON-REFLECTORIZED REFLECTORIZED REFLECTORIZED

SIGN SIZE	DIMENSIONS											
	A	B	C	D	E	F	G	H	J	K	L	M
48 x 48	48.00	3.00	38.40	13.20	19.20	32.00	22.00	26.20	12.00	24.00	10.00	11.00

SIGN SIZE	SERIES BY LINE				MARGIN	BORDER
	1	2	3	4		
48 x 48	6C	8D	6D	6D	0.750	1.250

Sign not to scale

XX'-XX" WIDTH AND X MILES ARE VARIABLE TOP AND BOTTOM OF BACKGROUND WHITE

FILE NAME =	USER NAME = dosddd	DESIGNED -	REVISED - 3-02-16
p:\11\084EBIDINTEG.illinois.gov\PIDOT\Documents\IDOT Offices\District 2\Projects\Operations\Bridges\Section\Bridges\Deck Sealing\REVISED\2018\64M88\CADD\092-042-18-st-cover.dgn		CHECKED -	REVISED -
		DATE -	REVISED -

STATE OF ILLINOIS  
DEPARTMENT OF TRANSPORTATION

REGION 2 / DISTRICT 2 STANDARD

SCALE: SHEET NO. OF SHEETS STA. TO STA.

F.A. RTE.	SECTION	COUNTY	TOTAL SHEETS	SHEET NO.
VAR.	D2 BDS 2018-4	VARIOUS	18	11
CONTRACT NO. 64M88			FED. ROAD DIST. NO. ILLINOIS FED. AID PROJECT	

# WORK ZONE SIGN DETAILS

## ROAD CLOSED TO OVERSIZED LOADS

## STOP LINE SIGN FOR TEMPORARY SIGNALS

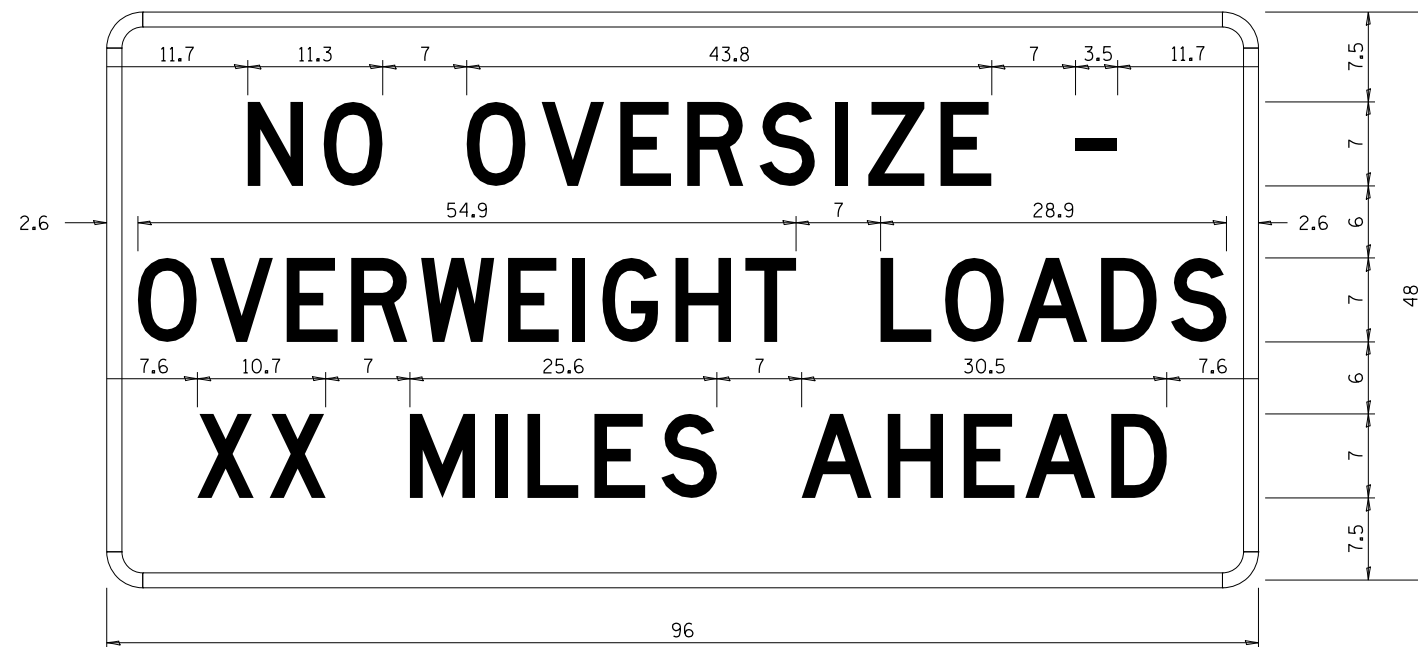

COLOR	LEGEND AND BORDER BACKGROUND	BLACK ORANGE	NON-REFLECTORIZED REFLECTORIZED
-------	------------------------------	--------------	---------------------------------

COLOR	LEGEND AND BORDER BACKGROUND	BLACK WHITE	NON-REFLECTORIZED REFLECTORIZED
-------	------------------------------	-------------	---------------------------------

Permit Loads - Loads Over 13 Feet; 3.0" Radius, 1.3" Border;  
 [NO OVERSIZE -] D; [OVERWEIGHT LOADS] D 85% spacing; [XX MILES AHEAD] D;  
 Table of letter and object lefts.

SIGN SIZE	SERIES BY LINE		
	1	2	3
24 x 24	4C	4C	4C

N	O	O	V	E	R	S	I	Z	E	-
11.7	18.1	30.0	36.2	42.8	48.4	54.4	60.7	63.5	69.5	80.8

O	V	E	R	W	E	I	G	H	T	L	O	A	D	S
2.6	8.6	15.0	20.4	26.2	33.4	38.8	41.3	47.4	53.2	64.5	69.9	75.9	82.9	88.7

X	X	M	I	L	E	S	A	H	E	A	D
7.6	13.6	25.3	32.3	35.1	40.6	46.2	57.9	65.1	71.4	76.6	83.7

Sign not to scale

Sign not to scale

### GENERAL NOTES

All work to furnish and install these signs shall be included in the cost of the specified traffic control standards and shall not be paid separately.

All Illinois Standard signs shall conform to the latest edition of the "Illinois Standard Highway Signs Book" in effect on the date of invitation for bids.

Signs shall meet the applicable portions of Sections 701 and 720 of the Standard Specifications.

All dimensions are in inches unless otherwise noted.

FILE NAME =	USER NAME = dosddd	DESIGNED -	REVISED - 3-02-16	STATE OF ILLINOIS DEPARTMENT OF TRANSPORTATION	REGION 2 / DISTRICT 2 STANDARD	F.A. RTE.	SECTION	COUNTY	TOTAL SHEETS	SHEET NO.
p:\11\084EBIDINTEG.illinois.gov\PI\DOT\Documents\DOT Offices\District 2\Projects\Open Bridge-Section\Bridge Deck Sealing\REVISED\2018\64M88\CADD\092-042-18-st-cover.dgn	PLOT SCALE = 100.0000' / in.	CHECKED -	REVISED -			VAR.	D2 BDS 2018-4	VARIOUS	18	12
PLOT DATE = Feb-05-2018 02:35:16 PM	DATE -	REVISED -	SCALE: _____ SHEET NO. ____ OF ____ SHEETS STA. _____ TO STA. _____			CONTRACT NO. 64M88				

**ENTRANCE SIGN FOR USE  
WITH TEMPORARY SIGNALS**

**WORK ZONE SIGN DETAILS**

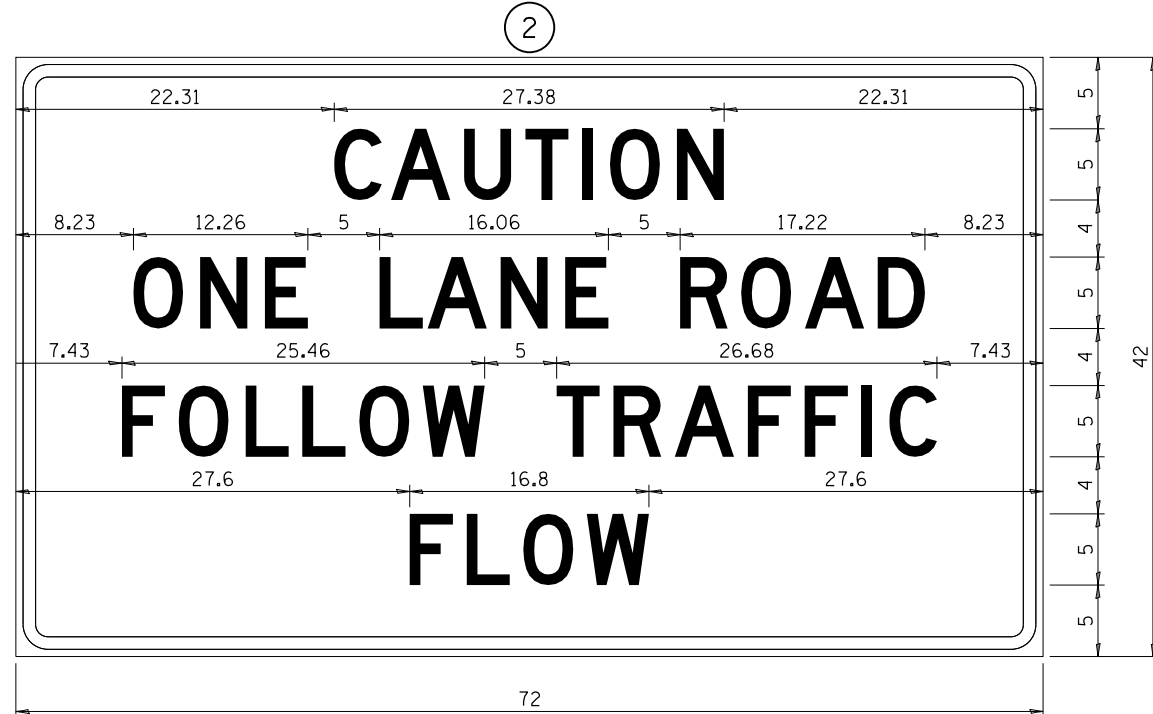

COLOR LEGEND AND BORDER BACKGROUND BLACK ORANGE NON-REFLECTORIZED REFLECTORIZED

2.25" Radius, 0.88" Border, 0.50" Indent;  
[CAUTION] D; [ONE LANE ROAD] D;  
[FOLLOW TRAFFIC] D; [FLOW] D

② This sign shall be installed at entrances located between the temporary signals as shown in the staging plans.

**Table Of Widths And Spaces**

22.31	C	0.62	A	0.94	U	0.94	T	0.94	I	1.17	O	1.17	N	3.36	22.31
	3.36		4.18		3.36		3.04		0.78		3.52		3.36		

8.23	O	1.17	N	1.18	E	3.04
	3.51		3.36		3.04	

5.00	L	0.31	A	0.94	N	1.17	E	3.05
	3.05		4.18		3.36		3.05	

5.00	R	0.93	O	0.94	A	0.93	D	8.23
	3.36		3.52		4.18		3.36	

7.43	F	0.94	O	1.17	L	0.94	L	0.94	O	0.94	W	4.37
	3.04		3.52		3.04		3.05		3.51		4.37	

5.00	T	0.94	R	0.94	A	0.93	F	0.94	F	0.94	I	1.18	C	7.43
	3.05		3.36		4.18		3.05		3.04		0.78		3.35	

27.60	F	0.94	L	0.94	O	0.93	W	27.60
	3.05		3.04		3.52		4.38	

Sign not to scale

**STAY IN YOUR LANE**

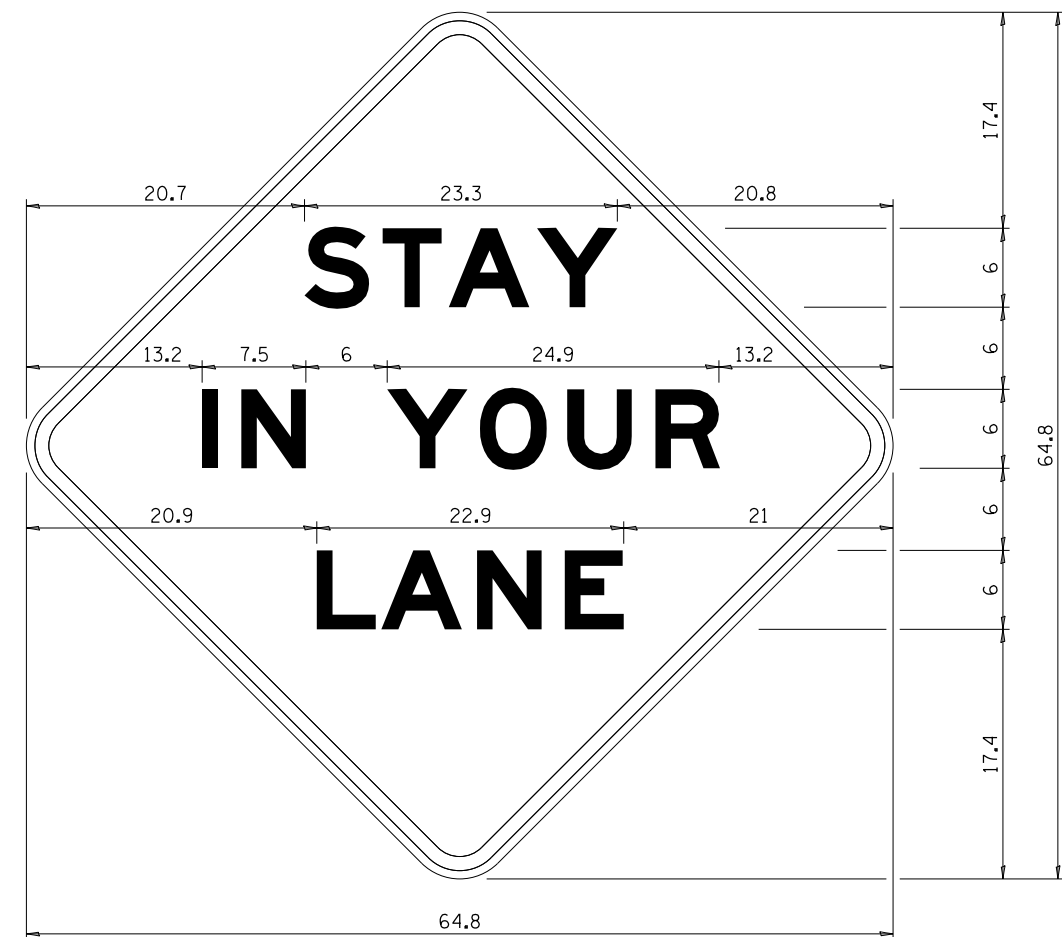

COLOR LEGEND AND BORDER BACKGROUND BLACK ORANGE NON-REFLECTORIZED REFLECTORIZED

48.0" across sides 3.8" Radius, 1.0" Border, 0.6" Indent;  
"STAY" E Mod; "IN YOUR" E Mod; "LANE" E Mod;

**Table of Letter and Object Lefts**

S	T	A	Y
20.7	26.8	31.6	38.0

I	N	Y	O	U	R
13.2	15.9	26.7	33.9	40.5	46.8

L	A	N	E
20.9	25.8	33.1	39.4

Sign not to scale

**GENERAL NOTES**

All work to furnish and install these signs shall be included in the cost of the specified traffic control standards and shall not be paid separately.

All Illinois Standard signs shall conform to the latest edition of the "Illinois Standard Highway Signs Book" in effect on the date of invitation for bids.

Signs shall meet the applicable portions of Sections 701 and 720 of the Standard Specifications.

All dimensions are in inches unless otherwise noted.

FILE NAME =	USER NAME = dossed	DESIGNED -	REVISED - 3-02-16
p:\11\084EBID\INTEG\illinois.gov\PIDOT\Documents\DOT Offices\District 2\Projects\Operations\Bridges\Section\Bridge Deck Sealing\REVISED\2018\64M88\CADD\092-042-18-st-cover.dgn		DRAWN -	REVISED -
		CHECKED -	REVISED -
		DATE -	REVISED -

**STATE OF ILLINOIS  
DEPARTMENT OF TRANSPORTATION**

**REGION 2 / DISTRICT 2 STANDARD**

SCALE: SHEET NO. OF SHEETS STA. TO STA.

F.A. RTE.	SECTION	COUNTY	TOTAL SHEETS	SHEET NO.
VAR.	D2 BDS 2018-4	VARIOUS	18	13
CONTRACT NO. 64M88				
FED. ROAD DIST. NO. ILLINOIS FED. AID PROJECT				

# TRAFFIC CONTROL FOR TRANSITION AREAS

## CASE 1

SIGNS, DEVICES & FLAGGERS ACCORDING TO APPLICABLE TRAFFIC CONTROL STANDARDS

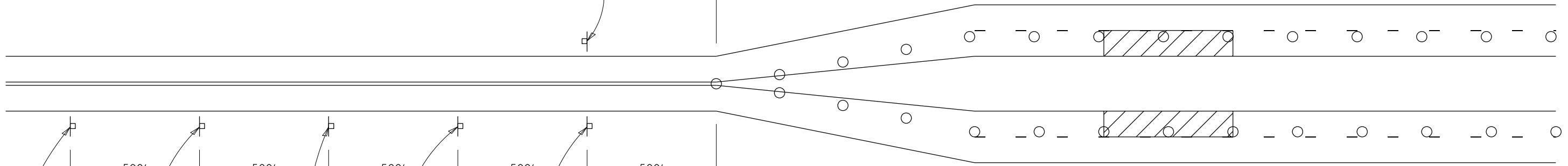
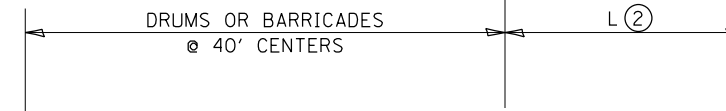

SIGNS, DEVICES & FLAGGERS ACCORDING TO APPLICABLE TRAFFIC CONTROL STANDARDS

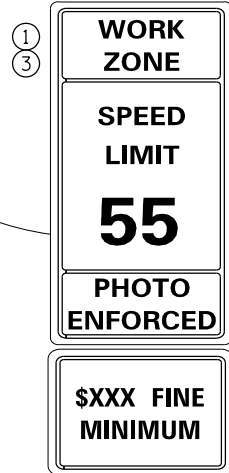
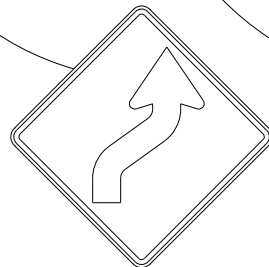
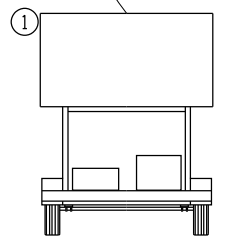
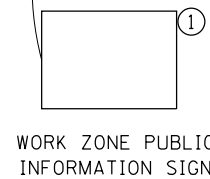

W2-1115(0)-3618  
R2-1-3648  
R10-1108p-3618 (only along roadways under the jurisdiction of the State.)  
R2-1106-3618

GENERAL NOTES  
THIS DETAIL IS TO BE USED IN CONJUNCTION WITH THE APPLICABLE MULTILANE TRAFFIC CONTROL AND PROTECTION STANDARD.

1. If applicable, use if shown on applicable multilane Traffic Control and Protection Standard being used.
2. If the work is within 2500 feet of the transition when the speed is > 40 mph, or 1500 feet for all other speeds, the detail shall be used.
3. WORK ZONE SPEED LIMIT 55 SIGN ASSEMBLY shall be replaced with WORK ZONE SPEED LIMIT 45 SIGN ASSEMBLY where the workers are within 500 feet of the transition.

THIS TRAFFIC CONTROL DETAIL SHALL BE INCLUDED IN THE COST OF SPECIFIED TRAFFIC CONTROL STANDARDS OR ITEMS.

○ DRUMS OR BARRICADES WITH LIGHTS

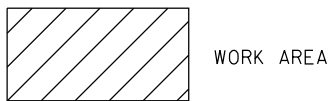

NOTE: STANDARDS 701301 AND 701306 SHALL NOT BE USED WITHIN 500 FEET OF THE TRANSITION.

\* DEPENDS ON GEOMETRICS OF THE TRANSITION. MAY SWITCH THE "STAY IN YOUR LANE" AND "WEAVE SIGNS"

FILE NAME =	USER NAME = dosddd	DESIGNED -	REVISED - 4-20-17
pw:\IL\084EBIDINTEG\illinois.gov\PIWIDOT\Documents\DOT Offices\District 2\Projects\Open Bridge-Section\Bridge Deck Sealing\REVISED 2018\64M88-042-18-stt-cover.dgn		DRAWN -	REVISED - 8-27-13
		CHECKED -	REVISED - 1-16-13
		DATE -	
	PLOT DATE = Feb-05-2018 02:35:31 PM		

STATE OF ILLINOIS  
DEPARTMENT OF TRANSPORTATION

REGION 2 / DISTRICT 2 STANDARD

SCALE: \_\_\_\_\_ SHEET NO. \_\_\_\_ OF \_\_\_\_ SHEETS STA. \_\_\_\_\_ TO STA. \_\_\_\_\_

F.A. RTÉ.	SECTION	COUNTY	TOTAL SHEETS	SHEET NO.
VAR.	D2 BDS 2018-4	VARIOUS	18	14
CONTRACT NO. 64M88				
FED. ROAD DIST. NO. _ ILLINOIS FED. AID PROJECT				

# TRAFFIC CONTROL FOR TRANSITION AREAS

## CASE 2

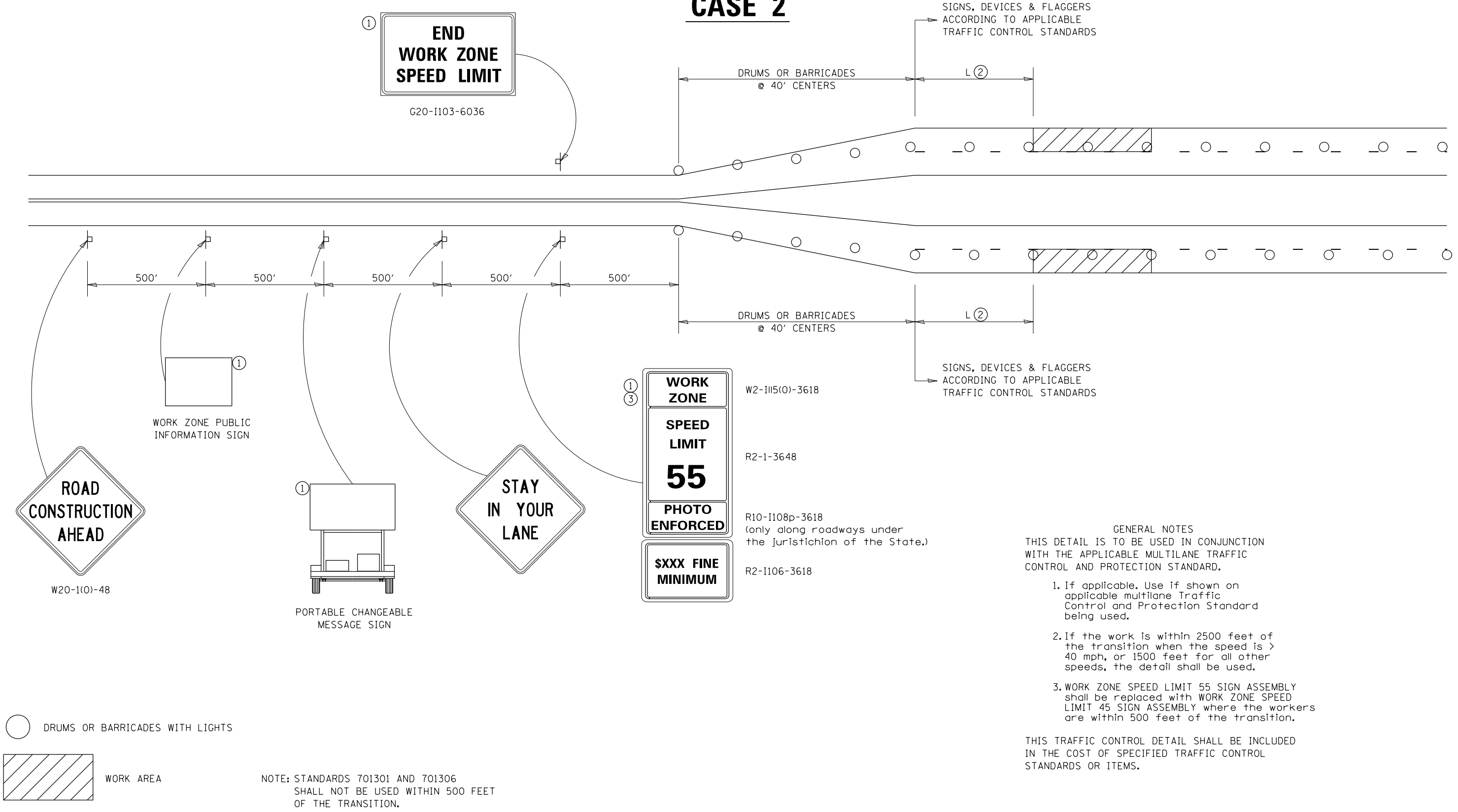

- GENERAL NOTES
- THIS DETAIL IS TO BE USED IN CONJUNCTION WITH THE APPLICABLE MULTILANE TRAFFIC CONTROL AND PROTECTION STANDARD.
1. If applicable, Use if shown on applicable multilane Traffic Control and Protection Standard being used.
  2. If the work is within 2500 feet of the transition when the speed is > 40 mph, or 1500 feet for all other speeds, the detail shall be used.
  3. WORK ZONE SPEED LIMIT 55 SIGN ASSEMBLY shall be replaced with WORK ZONE SPEED LIMIT 45 SIGN ASSEMBLY where the workers are within 500 feet of the transition.

THIS TRAFFIC CONTROL DETAIL SHALL BE INCLUDED IN THE COST OF SPECIFIED TRAFFIC CONTROL STANDARDS OR ITEMS.

FILE NAME =	USER NAME = dosddd	DESIGNED -	REVISED - 4-20-17	<b>STATE OF ILLINOIS DEPARTMENT OF TRANSPORTATION</b>	<b>REGION 2 / DISTRICT 2 STANDARD</b>	F.A. RTÉ.	SECTION	COUNTY	TOTAL SHEETS	SHEET NO.			
DRAWN -						SCALE: _____	SHEET NO. ____ OF ____ SHEETS	STA. _____ TO STA. _____	VAR.	D2 BDS 2018-4	VARIOUS	18	15
PLOT SCALE = 100.0000' / in.						REVISED - 8-27-13	CONTRACT NO. 64M88						
PLOT DATE = Feb-05-2018 02:35:41 PM				DATE -	REVISED - 1-16-13	FED. ROAD DIST. NO. _ ILLINOIS FED. AID PROJECT							

# TRAFFIC CONTROL FOR TRANSITION AREAS

## CASE 3

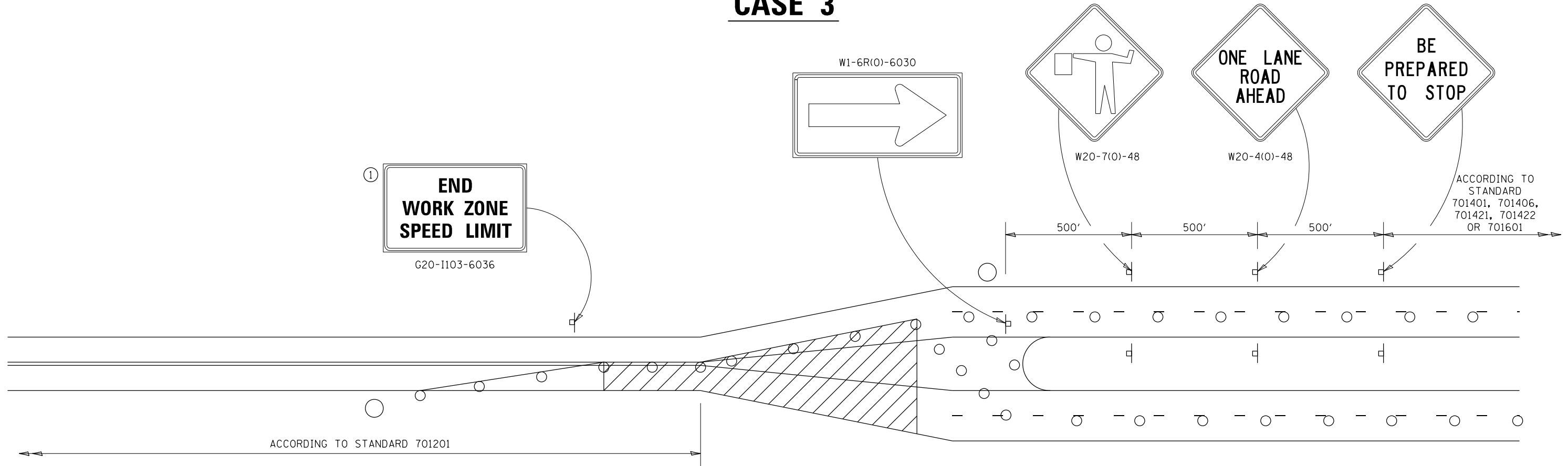

**GENERAL NOTES**  
 THIS DETAIL IS TO BE USED IN CONJUNCTION WITH THE APPLICABLE MULTILANE TRAFFIC CONTROL AND PROTECTION STANDARD.

1. If applicable, Use if shown on applicable multilane Traffic Control and Protection Standard being used.
2. If the work is within 2500 feet of the transition when the speed is > 40 mph, or 1500 feet for all other speeds, the detail shall be used.
3. WORK ZONE SPEED LIMIT 55 SIGN ASSEMBLY shall be replaced with WORK ZONE SPEED LIMIT 45 SIGN ASSEMBLY where the workers are within 500 feet of the transition.

THIS TRAFFIC CONTROL DETAIL SHALL BE INCLUDED IN THE COST OF SPECIFIED TRAFFIC CONTROL STANDARDS OR ITEMS.

- FLAGGER WITH TRAFFIC CONTROL SIGN
- DRUMS OR BARRICADES WITH LIGHTS
- WORK AREA

NOTE: STANDARDS 701301 AND 701306 SHALL NOT BE USED WITHIN 500 FEET OF THE TRANSITION.

FILE NAME =	USER NAME = dosddd	DESIGNED -	REVISED - 4-20-17	<b>STATE OF ILLINOIS DEPARTMENT OF TRANSPORTATION</b>	<b>REGION 2 / DISTRICT 2 STANDARD</b>	F.A. RTE.	SECTION	COUNTY	TOTAL SHEETS	SHEET NO.	
DRAWN BY: [unclear]						VAR.	D2 BDS 2018-4	VARIOUS	18	16	
PLOT SCALE = 100.0000' / in.						CHECKED -	CONTRACT NO. 64M88			FED. ROAD DIST. NO. - ILLINOIS FED. AID PROJECT	
PLOT DATE = Feb-05-2018 02:35:48 PM				DATE -	SCALE: _____	SHEET NO. _____ OF _____ SHEETS	STA. _____ TO STA. _____				



# TRAFFIC CONTROL FOR TRANSITION AREAS

## CASE 4

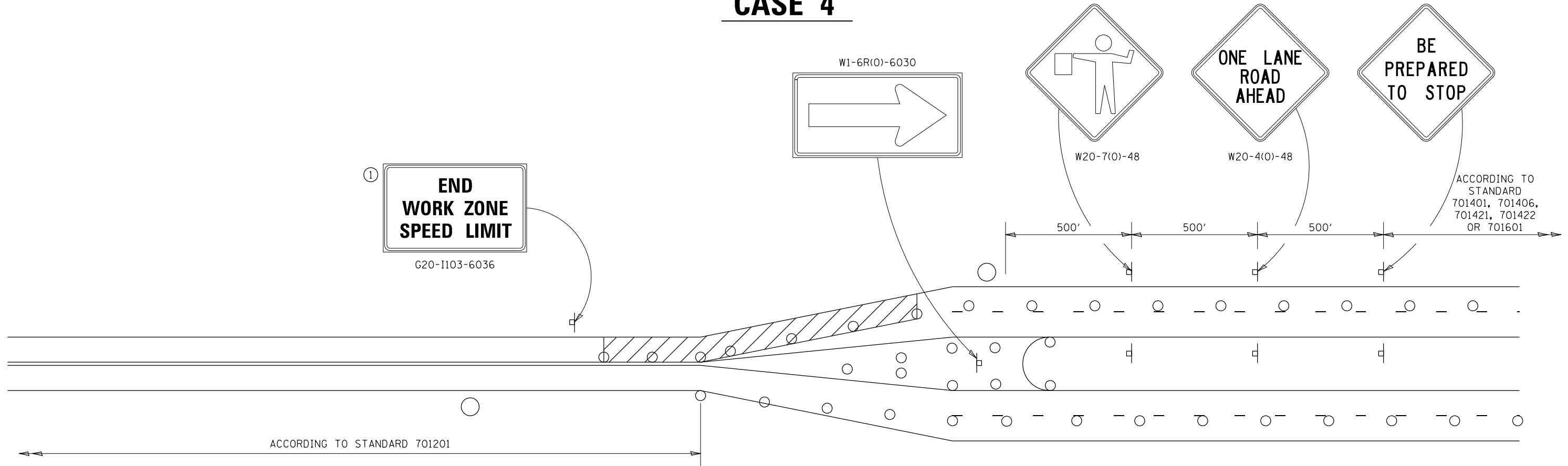

GENERAL NOTES  
THIS DETAIL IS TO BE USED IN CONJUNCTION WITH THE APPLICABLE MULTILANE TRAFFIC CONTROL AND PROTECTION STANDARD.

1. If applicable, Use if shown on applicable multilane Traffic Control and Protection Standard being used.
2. If the work is within 2500 feet of the transition when the speed is > 40 mph, or 1500 feet for all other speeds, the detail shall be used.
3. WORK ZONE SPEED LIMIT 55 SIGN ASSEMBLY shall be replaced with WORK ZONE SPEED LIMIT 45 SIGN ASSEMBLY where the workers are within 500 feet of the transition.

THIS TRAFFIC CONTROL DETAIL SHALL BE INCLUDED IN THE COST OF SPECIFIED TRAFFIC CONTROL STANDARDS OR ITEMS.

- FLAGGER WITH TRAFFIC CONTROL SIGN
- DRUMS OR BARRICADES WITH LIGHTS
- WORK AREA



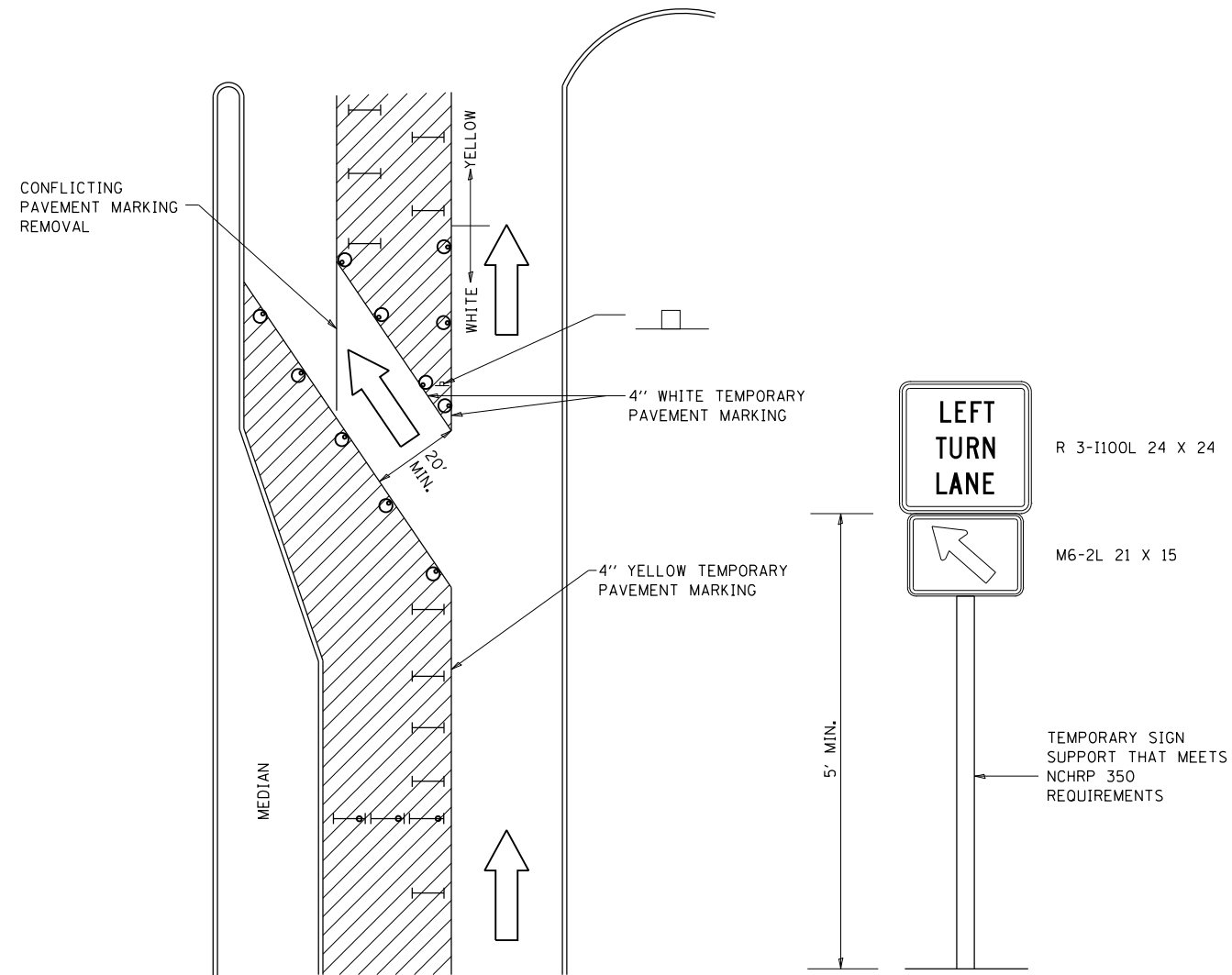

NOTE: STANDARDS 701301 AND 701306 SHALL NOT BE USED WITHIN 500 FEET OF THE TRANSITION.

FILE NAME =	USER NAME = dosddd	DESIGNED -	REVISED - 4-20-17	<b>STATE OF ILLINOIS DEPARTMENT OF TRANSPORTATION</b>	<b>REGION 2 / DISTRICT 2 STANDARD</b>	F.A. RTE.	SECTION	COUNTY	TOTAL SHEETS	SHEET NO.			
DRAWN BY: [unclear]						SCALE: _____	SHEET NO. ____ OF ____ SHEETS	STA. _____ TO STA. _____	VAR.	D2 BDS 2018-4	VARIOUS	18	17
PLOT SCALE = 100.0000' / in.						CHECKED -	REVISED - 8-27-13	CONTRACT NO. 64M88					
PLOT DATE = Feb-05-2018 02:35:56 PM				DATE -	REVISED - 3-05-12	FED. ROAD DIST. NO. _ ILLINOIS FED. AID PROJECT							

# TRAFFIC CONTROL AND PROTECTION AT TURN BAYS (TO REMAIN OPEN TO TRAFFIC)

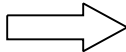

### LEGEND

-  WORK AREA
-  LANE OPEN TO TRAFFIC
-  TYPE I OR II BARRICADE OR DRUM WITH FLASHING BURNING LIGHT
-  DRUM OR BARRICADE WITH STEADY BURN LIGHT
-  SIGN (SEE DETAIL)
-  TYPE I OR II CHECK BARRICADE WITH STEADY LIGHT BURN

REVISED - 10-14-11

### GENERAL NOTES

CONES MAY BE SUBSTITUTED FOR BARRICADES OR DRUMS AT HALF THE SPACING DURING DAY OPERATIONS. CONES SHALL BE A MINIMUM OF 28 IN HEIGHT.

STEADY BURNING LIGHTS WILL NOT BE REQUIRED ON BARRICADES OR DRUMS FOR DAY OPERATIONS. ALL LIGHTS WILL BE MONODIRECTIONAL.

TEMPORARY PAVEMENT MARKING SHALL BE PLACED THROUGHOUT THE BARRICADED AREA OF EACH BAY WHERE THE CLOSURE TIME IS GREATER THAN FOURTEEN DAYS.

THIS APPLICATION ALSO APPLIES WHEN WORK IS BEING PERFORMED IN THE RIGHT LANE(S) AND THE RIGHT TURN BAY IS TO REMAIN OPEN. UNDER THIS CONDITION, "RIGHT TURN LANE" R3-100 24 X 24 AND M6-2R 21 X 15 SHALL BE USED.

THESE CONTROLS SHALL SUPPLEMENT MAINLINE TRAFFIC CONTROL FOR LANE CLOSURES. LONGITUDINAL DIMENSIONS MAY BE ADJUSTED TO FIT FIELD CONDITIONS.

TRAFFIC CONTROL AND PROTECTION AT TURN BAYS (TO REMAIN OPEN TO TRAFFIC) SHALL BE INCLUDED IN THE COST SPECIFIED TRAFFIC CONTROL STANDARDS OR ITEMS.

ALL DIMENSIONS ARE IN INCHES UNLESS OTHERWISE NOTED.

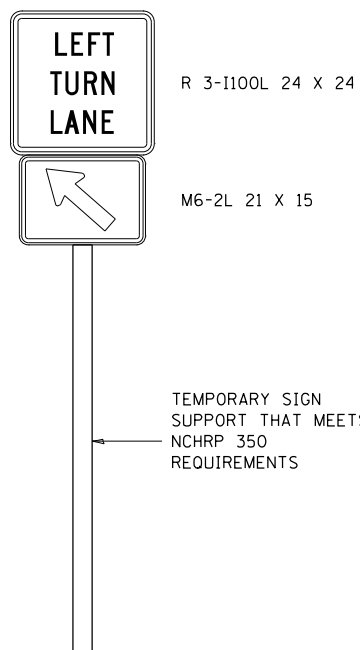

REVISED - ____	<b>REGION 2 / DISTRICT 2 STANDARD</b>	F.A. RTE.	SECTION	COUNTY	TOTAL SHEETS	SHEET NO.
REVISED - ____		VAR.	D2 BDS 2018-4	VARIOUS	18	18
REVISED - ____		CONTRACT NO. 64M88				
REVISED - ____		FED. ROAD DIST. NO. ILLINOIS FED. AID PROJECT				

PLOT DATE = Feb-05-2018 02:35:06 PM