

04-27-2018 LETTING ITEM 083

STATE OF ILLINOIS
DEPARTMENT OF TRANSPORTATION

F.A.P. RTE.	SECTION	COUNTY	TOTAL SHEETS	SHEET NO.
68	(31) SFY	DEKALB	5	1
		ILLINOIS	CONTRACT NO. 66H93	

INDEX OF SHEETS

- 1 COVER SHEET
- 2 GENERAL NOTES
- 3 SUMMARY OF QUANTITIES
- 4 FLASHING BEACON LAYOUT PLAN
- 5 DETAILS

LIST OF ILLINOIS DOT HIGHWAY STANDARDS

000001-06	STANDARD SYMBOLS, ABBREVIATIONS AND PATTERNS
001006	DECIMAL OF AN INCH AND OF A FOOT
701001-02	OFF-ROAD OPERATIONS 2L, 2W, MORE THAN 15' (4.5 m) AWAY
701006-05	OFF-ROAD OPERATIONS 2L, 2W, 15' (4.5 m) TO 24" (600 mm) FROM PAVEMENT EDGE
701201-04	LANE CLOSURE, 2L, 2W, DAY ONLY, FOR SPEEDS ≥ 45 MPH
701901-07	TRAFFIC CONTROL DEVICES
805001-01	ELECTRICAL SERVICE INSTALLATION DETAILS
814001-03	HANDHOLES
862001-01	UNINTERRUPTABLE POWER SUPPLY (UPS)
873001-02	TRAFFIC SIGNAL GROUNDING & BONDING
880001-01	SPAN WIRE MOUNTED SIGNALS AND FLASHING BEACON INSTALLATION

PROPOSED
HIGHWAY PLANS

FAP ROUTE 68 (IL 23)
SECTION (31) SFY
PROJECT: HSIP-4RLM (896)
FLASHING BEACON INSTALLATION
DEKALB COUNTY

C-93-031-18

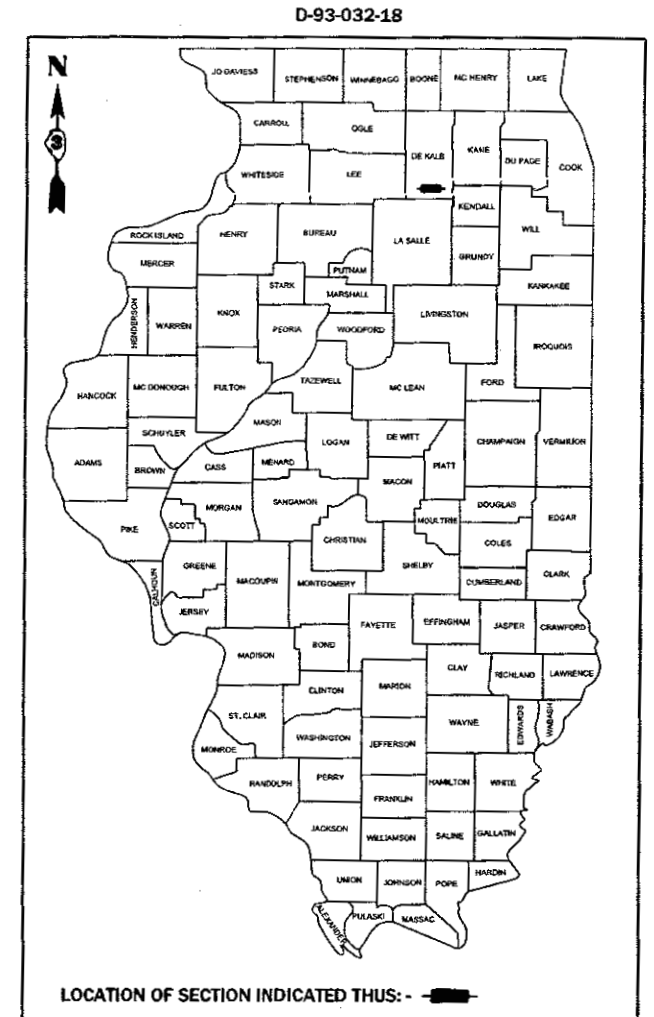

IL 23 - MINOR ARTERIAL
2015 ADT=2550
P.V.=83.3% S.U.=3.9% M.U.=12.8%

CHICAGO RD - MAJOR COLLECTOR
2015 ADT=1425
P.V.=96.2% S.U.=1.9% M.U.=1.9%

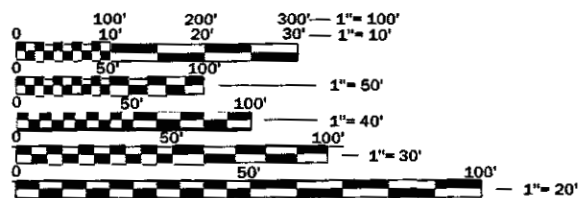

FULL SIZE PLANS HAVE BEEN PREPARED USING STANDARD ENGINEERING SCALES. REDUCED SIZED PLANS WILL NOT CONFORM TO STANDARD SCALES. IN MAKING MEASUREMENTS ON REDUCED PLANS, THE ABOVE SCALES MAY BE USED.

J.U.L.I.E.
JOINT UTILITY LOCATION INFORMATION FOR EXCAVATION
1-800-892-0123
OR 811

PROJECT ENGINEER: JOE KANNEL, P.E.
UNIT CHIEF: MARC BUDZYNSKI, P.E.
DISTRICT 3 NO. (815) 434-6131
CONTRACT NO. 66H93

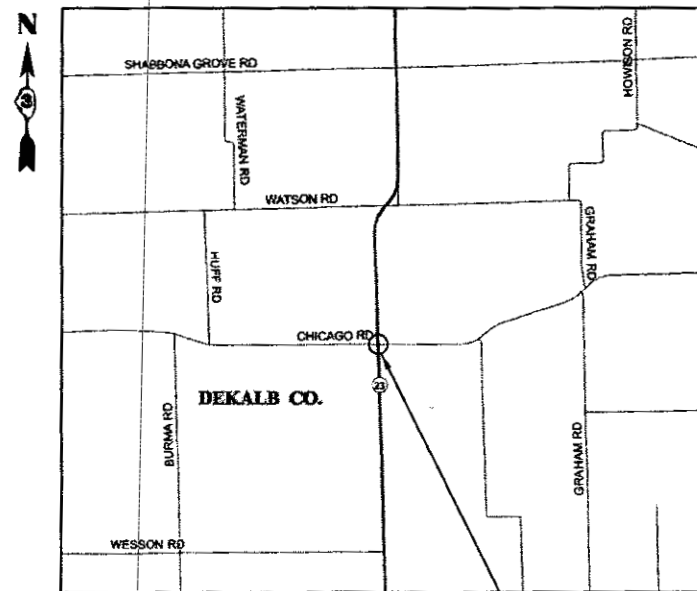

PROJECT LOCATION
IL 23 AND CHICAGO RD

GROSS & NET LENGTH = POINT LOCATION

STATE OF ILLINOIS
DEPARTMENT OF TRANSPORTATION

SUBMITTED 2-1 2018
[Signature]
REGIONAL ENGINEER

Mar 23 2018
[Signature]
ENGINEER OF DESIGN AND ENVIRONMENT

Mar 23 2018
[Signature]
DIRECTOR OF HIGHWAYS PROJECT IMPLEMENTATION

PRINTED BY THE AUTHORITY
OF THE STATE OF ILLINOIS

TRAFFIC SIGNAL GENERAL NOTES

THE TRAFFIC SIGNAL SECTION AT THE ILLINOIS DEPARTMENT OF TRANSPORTATION, DISTRICT 3, SHALL BE NOTIFIED AT 815-434-8506 AT LEAST 72 HOURS PRIOR TO TURNING ON ANY FLASHER OR CONTROLLER UNITS.

THE CONTRACTOR SHALL BE RESPONSIBLE FOR PROTECTING UTILITY PROPERTY DURING CONSTRUCTION OPERATIONS AS OUTLINED IN ARTICLE 107.31 OF THE STANDARD SPECIFICATIONS. A MINIMUM OF 48 HOURS ADVANCE NOTICE IS REQUIRED FOR NON-EMERGENCY WORK. THE JULIE NUMBER IS 800-892-0123. THE MEMBERS OF JULIE KNOWN TO BE WITHIN THE LIMITS OF THE IMPROVEMENT ARE:

- COMED
- FRONTIER
- NICOR

ALL TRAFFIC CONTROL AND OTHER ADVISORY SIGNS NEEDED FOR CONSTRUCTION ARE TO BE FURNISHED BY THE CONTRACTOR IN ACCORDANCE WITH SECTION 701 OF THE STANDARD SPECIFICATIONS.

ALL TRAFFIC SIGNAL HEADS SHALL BE 12-INCH POLYCARBONATE.

TRAFFIC SIGNAL HEADS SHALL BE PROPERLY COVERED PRIOR TO INTERSECTION TURN-ON OR AS DIRECTED BY THE ENGINEER. THIS COST SHALL BE INCLUDED WITH THE COST OF THE ASSOCIATED TRAFFIC SIGNAL PAY ITEMS.

A 1/4" DIAMETER CONTINUOUS RODENT RESISTANT NYLON ROPE SHALL BE FURNISHED AND LEFT IN PLACE IN ALL CONDUITS BETWEEN HANDHOLES AND FOUNDATIONS OR CONTROLLER. THIS COST SHALL BE INCLUDED WITH THE COST OF CONDUIT PAY ITEM.

NO ADDITIONAL COMPENSATION WILL BE ALLOWED FOR PLACING CONDUIT AT A GREATER THAN 2' MINIMUM DEPTH TO AVOID OBSTACLES SUCH AS UNDERGROUND UTILITIES.

THE ELECTRICAL CONDUCTORS FOR ALL TRAFFIC SIGNAL HEADS SHALL BE SOLID, SOFT COPPER.

ALL THREADS OF BOLTS USED IN THE ASSEMBLY OF TRAFFIC SIGNAL COMPONENTS SHALL BE COATED WITH A NON-LEAD BASED ANTI-SEIZE COMPOUND, SIMILAR TO LEAD PLATE, PRIOR TO ASSEMBLY.

ALL HARDWARE SHALL BE TIGHTENED AND WELL SECURED. CABLES SHALL BE NEATLY WOUND IN HANDHOLES. CABLES SHALL BE NEATLY TRAINED IN THE CONTROLLER CABINET.

ALL TRAFFIC SIGNAL WIRING SHALL EXTEND FROM CONTROLLER TO SIGNAL. SPLICES IN HANDHOLES WILL NOT BE ALLOWED.

THE CONTRACTOR SHALL BE RESPONSIBLE FOR OBTAINING ELECTRICAL SERVICE FOR THE TRAFFIC SIGNALS. THE CONTRACTOR SHALL CONTACT THE UTILITY COMPANY PRIOR TO BEGINNING WORK TO OBTAIN THE UTILITY COMPANY REQUIREMENTS FOR THE SERVICE INSTALLATION.

ALL VEHICLE AND PEDESTRIAN SIGNAL HEADS SHALL HAVE POLYCARBONATE BLACK HOUSING AND BLACK BRACKETS.

ALL UNINTERRUPTIBLE POWER SUPPLIES SHALL BE EQUIPPED WITH ALPHA GUARD MONITORS.

ALL GROUNDING MATERIALS FOR CONCRETE FOUNDATIONS SHALL REFER TO SECTION 807 OF THE STANDARD SPECIFICATIONS.

ALL AREAS DISTURBED BY THE CONTRACTOR SHALL BE RESTORED WITH SEED OR SOD TO THE SATISFACTION OF THE ENGINEER. SEEDING OR SODDING SHALL NOT BE PERMITTED AT ANY TIME WHEN THE GROUND IS FROZEN, WET, OR IN AN UNTILLABLE CONDITION.

ALL EXCAVATED MATERIAL, WHICH INCLUDES DIGGING OR GRADING OF ANY SOIL OR FILL MATERIAL, WITH THE EXCEPTION OF AGGREGATE FILLS, MUST BE INCORPORATED WITHIN THE IDOT RIGHT OF WAY DUE TO ENVIRONMENTAL DOCUMENTATION REQUIREMENTS

COMMITMENTS:

STATE OF ILLINOIS
DEPARTMENT OF TRANSPORTATION
DISTRICT THREE
AS BUILT INFORMATION

SUPERVISING CONSTRUCTION FIELD ENGINEER

RESIDENT ENGINEER / TECHNICIAN

START & END DATES
OF CONSTRUCTION:

INSPECTORS:

STATE OF ILLINOIS
DEPARTMENT OF TRANSPORTATION
DISTRICT THREE

PREPARED BY: David Brunick (eip)
DISTRICT STUDIES & PLANS ENGINEER

DATE: 02/02/18

EXAMINED BY: W.H. Williams
DISTRICT CONSTRUCTION ENGINEER

2/2/18 M.L.H. Holt
DISTRICT MATERIALS ENGINEER

J. Williams
DISTRICT OPERATIONS ENGINEER

STATE OF ILLINOIS
DEPARTMENT OF TRANSPORTATION

GENERAL NOTES

SCALE: SHEET OF SHEETS STA. TO STA.

F.A.P. RTE.	SECTION	COUNTY	TOTAL SHEETS	SHEET NO.
68	(31) SPY	DEKALB	5	2
CONTRACT NO. 68H93				
ILLINOIS FED. AID PROJECT				

FILE NAME =	USER NAME = budzynskfm	DESIGNED -	REVISED -
pc:\1084EBID\INTEG\Illinois.gov\FWIDOT\Documents\DOT Offices\District 3\Projects\0366H93\CADData\0366H93-sh-	DRMN	CHECKED -	REVISED -
Default		DATE -	REVISED -
	PLOT SCALE = 100.0000 "/ft.		
	PLOT DATE = 1/31/2018		

CODE NO.	ITEM	UNIT	TOTAL QUANTITY	CONSTR. CODE	
				90% FED	10% STATE
				ROADWAY	
67100100	MOBILIZATION	L SUM	1.0	0021	1.0
70100450	TRAFFIC CONTROL AND PROTECTION, STANDARD 701201	L SUM	1.0	0021	1.0
80500300	SERVICE INSTALLATION, TYPE C	EACH	1	0021	1
81028200	UNDERGROUND CONDUIT, GALVANIZED STEEL, 2" DIA.	FOOT	172	0021	172
81028350	UNDERGROUND CONDUIT, PVC, 2" DIA.	FOOT	1676	0021	1676
81100500	CONDUIT ATTACHED TO STRUCTURE, 1 1/2" DIA., GALVANIZED STEEL	FOOT	63	0021	63
81400700	HANDHOLE, PORTLAND CEMENT CONCRETE	EACH	6	0021	6
85800100	FLASHER CONTROLLER	EACH	1	0021	1
87301215	ELECTRIC CABLE IN CONDUIT, SIGNAL NO. 14 2C	FOOT	2110	0021	2110
87301805	ELECTRIC CABLE IN CONDUIT, SERVICE, NO. 6 2 C	FOOT	5	0021	5
87301900	ELECTRIC CABLE IN CONDUIT, EQUIPMENT GROUNDING CONDUCTOR, NO. 6 1C	FOOT	2110	0021	2110
88040030	SIGNAL HEAD, POLYCARBONATE, LED, 1-FACE, 1-SECTION, POST MOUNTED	EACH	4	0021	4
X0326887	WOOD POLE, 25 FT, CLASS 4	EACH	1	0021	1
X8620200	UNINTERRUPTABLE POWER SUPPLY, SPECIAL	EACH	1	0021	1
Z0030850	TEMPORARY INFORMATION SIGNING	SQ FT	84	0021	84

FILE NAME =	USER NAME = lsdjynskim	DESIGNED -	REVISED -
pw:\R084EBIDINTEG\Illinois.gov\PWIDOT\Documents\DOT Offices\District 3\Projects\0368H93\CADData\0368H93-ent	DRAWN -	CHECKED -	REVISED -
Default	PLOT SCALE = 100.0000 1/in.	DATE -	REVISED -
	PLOT DATE = 1/31/2018		





**STATE OF ILLINOIS
DEPARTMENT OF TRANSPORTATION**

SUMMARY OF QUANTITIES

SCALE: SHEET OF SHEETS STA. TO STA.

F.A.P. RTE.	SECTION	COUNTY	TOTAL SHEETS	SHEET NO.
68	(31) SFY	DEKALB	5	3
CONTRACT NO. 66H93			ILLINOIS FED. AID PROJECT	

TRAFFIC SIGNALS LEGEND

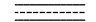
-  PROPOSED SERVICE INSTALLATION
-  PROPOSED FLASHER CONTROLLER
-  PROPOSED WOOD POLE
-  PROPOSED FLASHING BEACON
-  PROPOSED HANDHOLE
-  PROPOSED CONDUIT

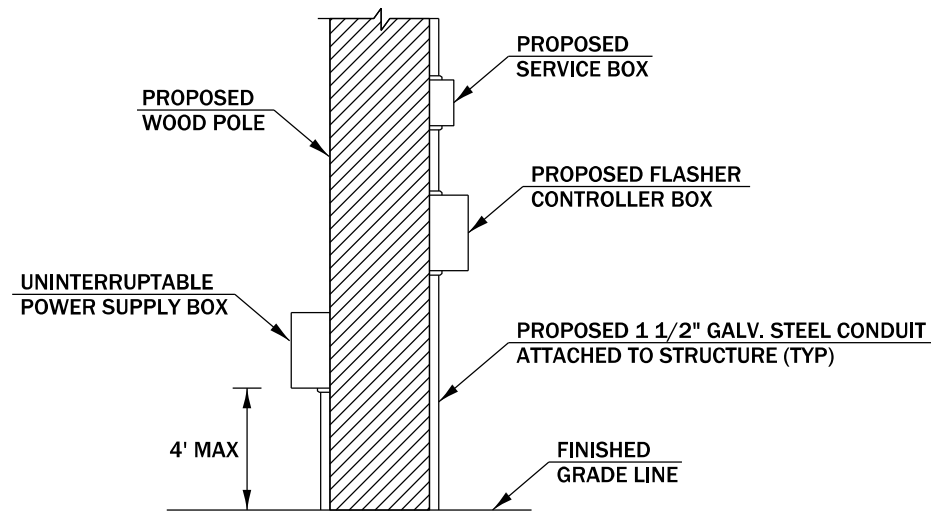
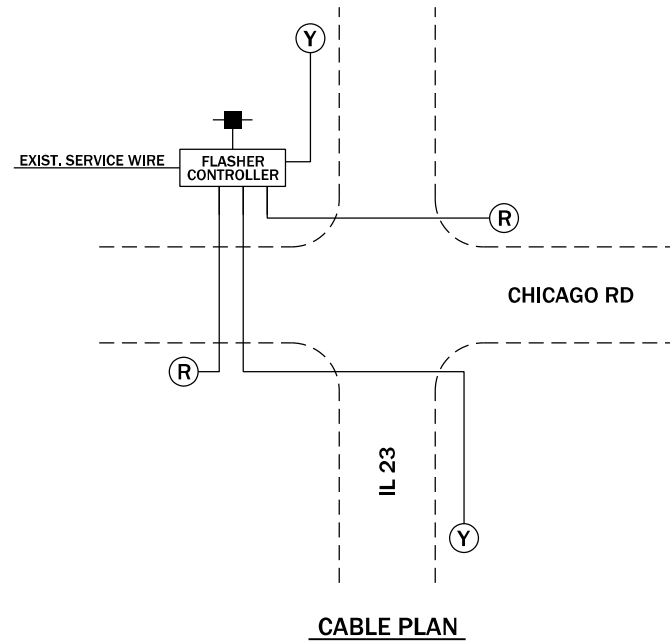

NOTE: THE IDOT TRAFFIC SIGNAL SECTION SHALL BE CONTACTED AT 815-434-8506 BEFORE THE EQUIPMENT IS MOUNTED TO VERIFY AN ACCEPTABLE PLACEMENT AND ORIENTATION ON THE POLE

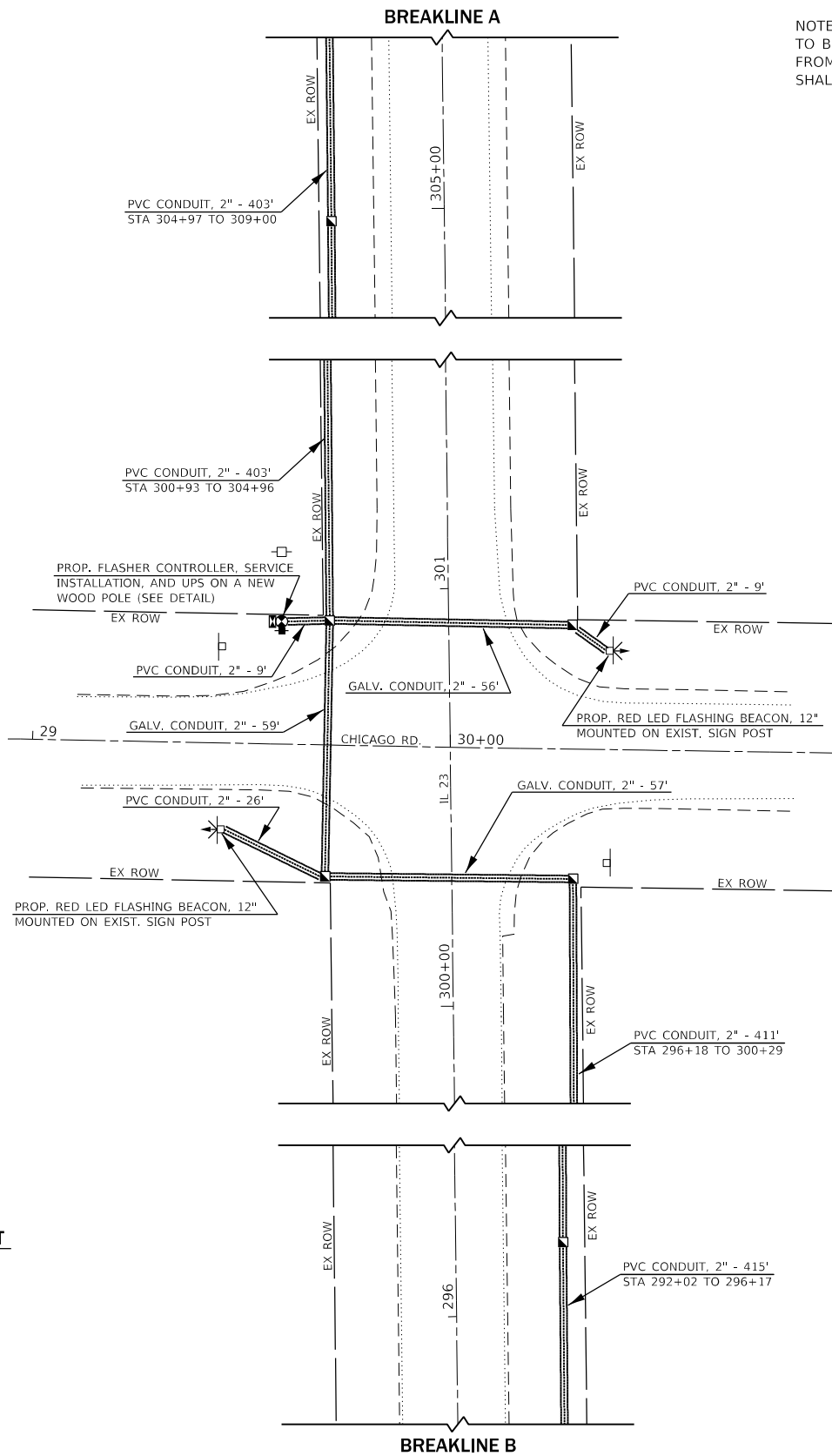

NOTE: PROVIDE 12' OF 1 1/2" GALV. STEEL CONDUIT TO BE ATTACHED TO EACH SIGN POST. ADAPTERS FROM THE PVC TO THE GALV. STEEL CONDUIT SHALL BE INCIDENTAL

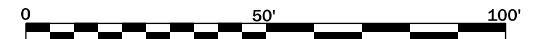
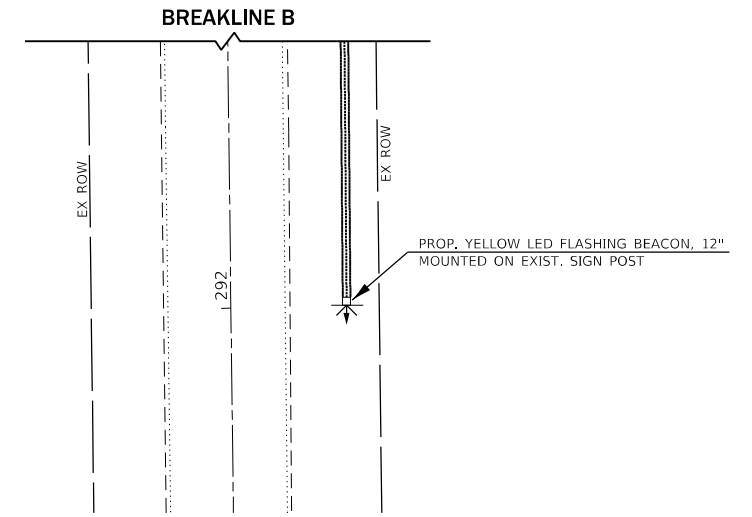
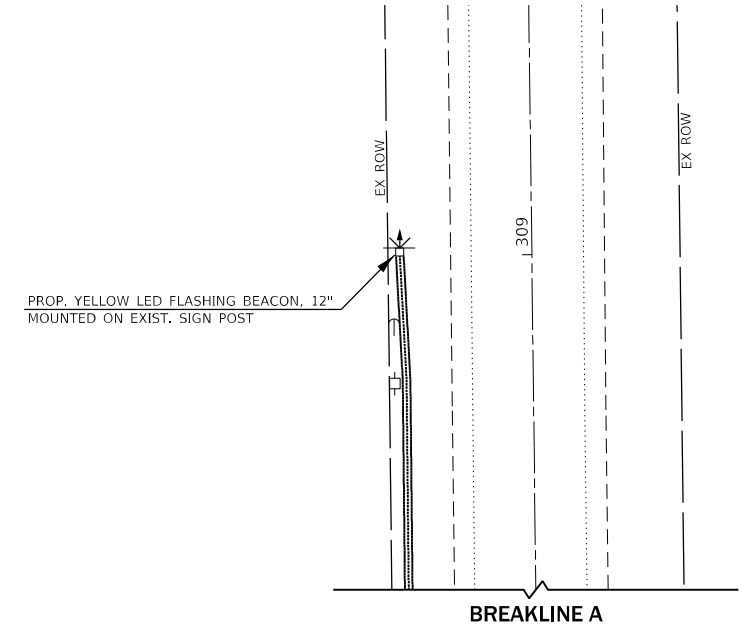

FILE NAME =	USER NAME = budzynsklm	DESIGNED -	REVISED -
p:\i\084EBID\INTEG\Illnotes\gov\PWIDOT\Documents\IDOT\Office\District 3\Projects\D366H93\CADDData\D366H93-sht-cov		DRAWN -	REVISED -
Default	PLOT SCALE = 40,0000' / in.	CHECKED -	REVISED -
	PLOT DATE = 1/31/2018	DATE -	REVISED -

**STATE OF ILLINOIS
DEPARTMENT OF TRANSPORTATION**

FLASHING BEACON LAYOUT PLAN

SCALE: SHEET OF SHEETS STA. TO STA.

F.A.P. RTE.	SECTION	COUNTY	TOTAL SHEETS	SHEET NO.
68	(31) SFY	DEKALB	5	4
CONTRACT NO. 66H93				
ILLINOIS FED. AID PROJECT				

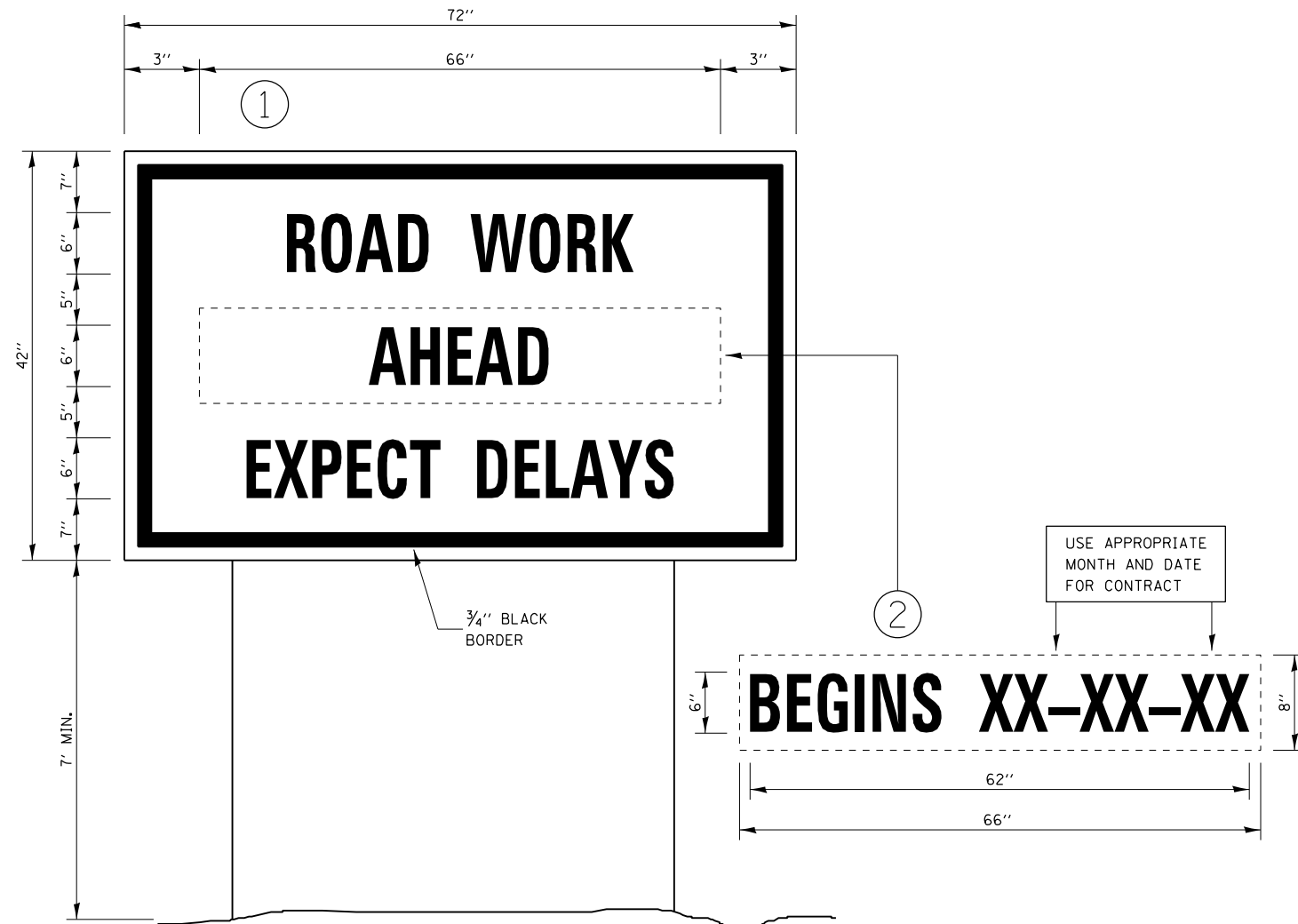

TEMPORARY INFORMATION SIGNING

NOTES:

1. USE 6" D BLACK LETTERING ON FLUORESCENT ORANGE BACKGROUND.
2. ERECT SIGNS AT LOCATIONS IN ADVANCE OF THE "ROAD CONSTRUCTION AHEAD" SIGNS AS DIRECTED BY THE ENGINEER.
3. ERECT SIGN ① WITH INSTALLED PANEL ② A MINIMUM OF ONE WEEK PRIOR TO THE START OF THE LANE CLOSURE.
4. REMOVE PANEL ② ON THAT DATE.
5. SEE SPECIAL PROVISION "TEMPORARY INFORMATION SIGNING" FOR ADDITIONAL INFORMATION.
6. WILL BE PAID FOR PER SQ FT AS "TEMPORARY INFORMATION SIGNING". EACH SIGN = 21 SQ FT AND THE DATE PANEL ② WILL NOT BE MEASURED SEPARATELY FOR PAYMENT.

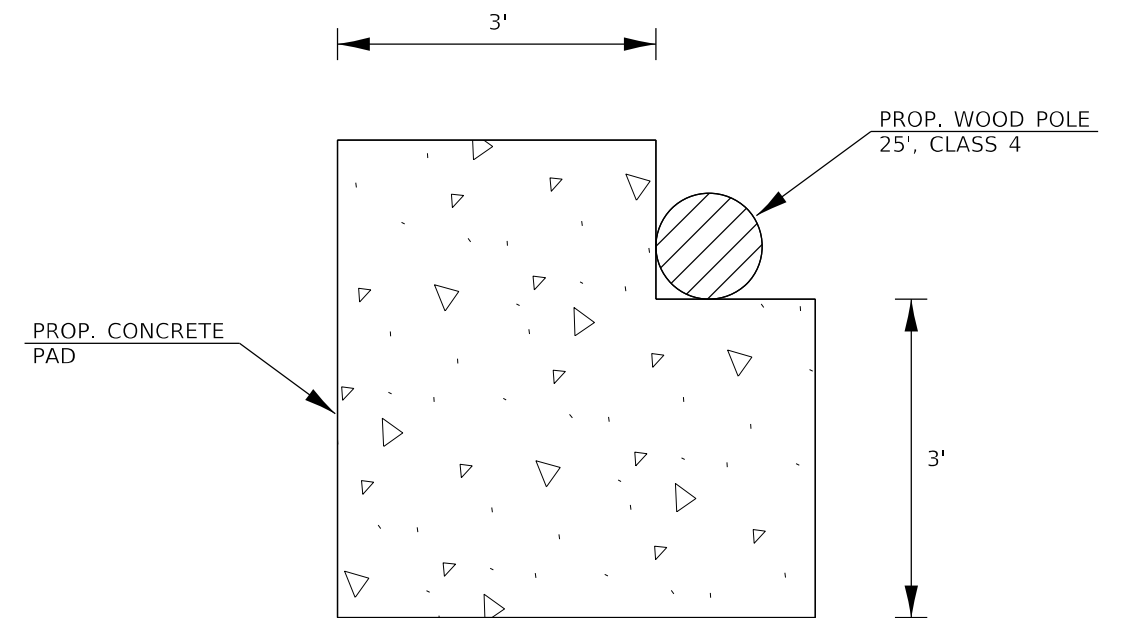

TOP VIEW

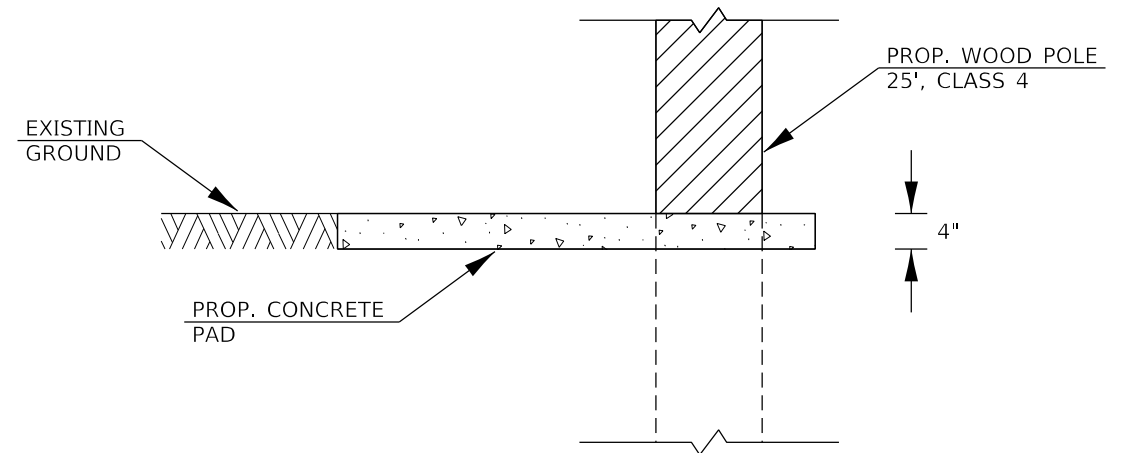

FRONT VIEW

WOOD POLE AND CONCRETE PAD LAYOUT

FILE NAME =	USER NAME = budzynsklm	DESIGNED -	REVISED -	STATE OF ILLINOIS DEPARTMENT OF TRANSPORTATION	DETAILS	F.A.P. RTE.	SECTION	COUNTY	TOTAL SHEETS	SHEET NO.	
pw:\il084EBID\INTEG\ilnotes.gov\PWIDOT\Documents\DOT\Office\District 3\Projects\D366H93\CADDData\D366H93-sht-cv	DRAWN -	REVISED -	68			(31) SFY	DEKALB	5	5		
Default	PLOT SCALE = 100.0000' / in.	CHECKED -	REVISED -			CONTRACT NO. 66H93					
	PLOT DATE = 1/31/2018	DATE -	REVISED -			SCALE:	SHEET	OF	SHEETS	STA.	TO
						ILLINOIS FED. AID PROJECT					