

**SURFACE TRANSPORTATION / RURAL PROGRAM
HANCOCK COUNTY
FAS ROUTE 428 & 1600
COUNTY HIGHWAY 11 & 12
SECTION 15-00129-01-PP
PROJECT NUMBER 2D16(723)
JOB NUMBER C-96-056-18**

CONTRACT 93712
sheet 1 of 2

- INDEX OF SHEETS**
- SHEET 1 LOCATION MAP
 - SHEET 1 INDEX OF SHEETS
 - SHEET 1 HIGHWAY STANDARDS
 - SHEET 1 SIGNATURES
 - SHEET 2 TYPICAL SECTION
 - SHEET 2 SUMMARY OF QUANTITIES

04-27-2018 LETTING ITEM 140

HIGHWAY STANDARDS

- 701006-05
- 701011-04
- 701201-04
- 701306-04
- 701901-07

LOCATION MAP

COUNTY HIGHWAYS

- GRAVEL
- BITUMINOUS
- PROPOSED IMPROVEMENT

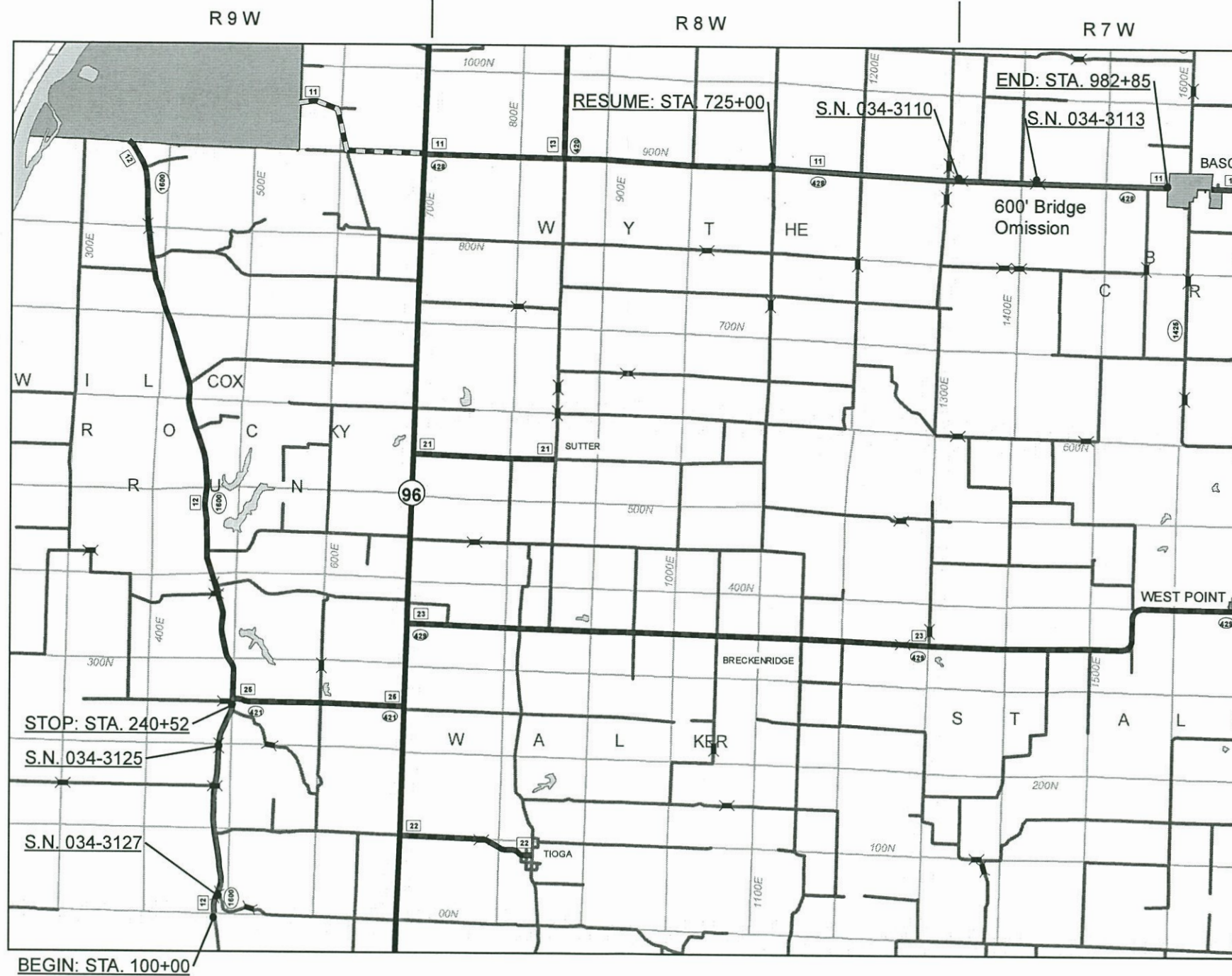
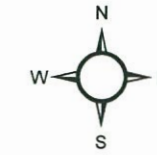
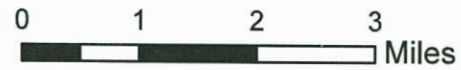

BASCO WEST ROAD
STATION 725+00 - 982+85
MAINTENANCE SECTION: 428-M-1
FAS ROUTE: 428 (C.H. 11)
TOTAL LENGTH: 4.88 MILES
IMPROVED LENGTH: 4.770 MILES
25,185.00 FEET
FROM 1100E TO 1580E
BEGINNING SECTION: 24
END SECTION: 24

BLUFF ROAD
STATION 100+00 - 240+52
MAINTENANCE SECTION: 1600M1
FAS ROUTE: 1600 (C.H. 12)
TOTAL LENGTH: 2.66 MILES
IMPROVED LENGTH: 2.661 MILES
14,052.00 FEET
FROM 00N TO 250N
BEGINNING SECTION: I
END SECTION: I

SIGNATURES

APPROVED 1/23 20 18
Elgin Berry
COUNTY ENGINEER

PASSED 1-29 20 18
Chris J. Schell
DISTRICT SIX ENGINEER OF
LOCAL ROADS & STREETS

Releasing For
Bid Based on
Limited Review 1-29 20 18
Jeffrey M. Southwick
REGION FOUR ENGINEER
DEPARTMENT OF TRANSPORTATION
STATE OF ILLINOIS

ROADWAY CLASSIFICATION: RURAL COLLECTORS
DESIGN SPEED: 55 M.P.H.
2014 ADT
ADT (BASCO WEST): 600
ADT (BLUFF): 375
DESIGN GUIDELINES: PAVEMENT PRESERVATION
NET LENGTH OF PROJECT: 39,237.00 FEET/7.431 MILES

CONTRACT 93712



I HEREBY CERTIFY THAT THESE PLANS WERE PREPARED BY ME OR UNDER MY DIRECT PERSONAL SUPERVISION AND THAT I AM A DULY LICENSED PROFESSIONAL ENGINEER IN ACCORDANCE WITH THE LAWS OF THE STATE OF ILLINOIS.

Elgin Berry 1/23/18
ELGIN L. BERRY LICENSE # 062-057924 EXPIRES 11/30/2019

CONTRACT 93712

TYPICAL CROSS SECTION
 C.H. 12 BLUFF ROAD & C.H. 11 BASCO ROAD
 ORIGINAL CONSTRUCTION SECTION: I, 24
 STA. 100+00 - STA. 240+52 & STA. 725+00 TO STA. 982+85

PAVEMENT MARKING
 BY OTHERS

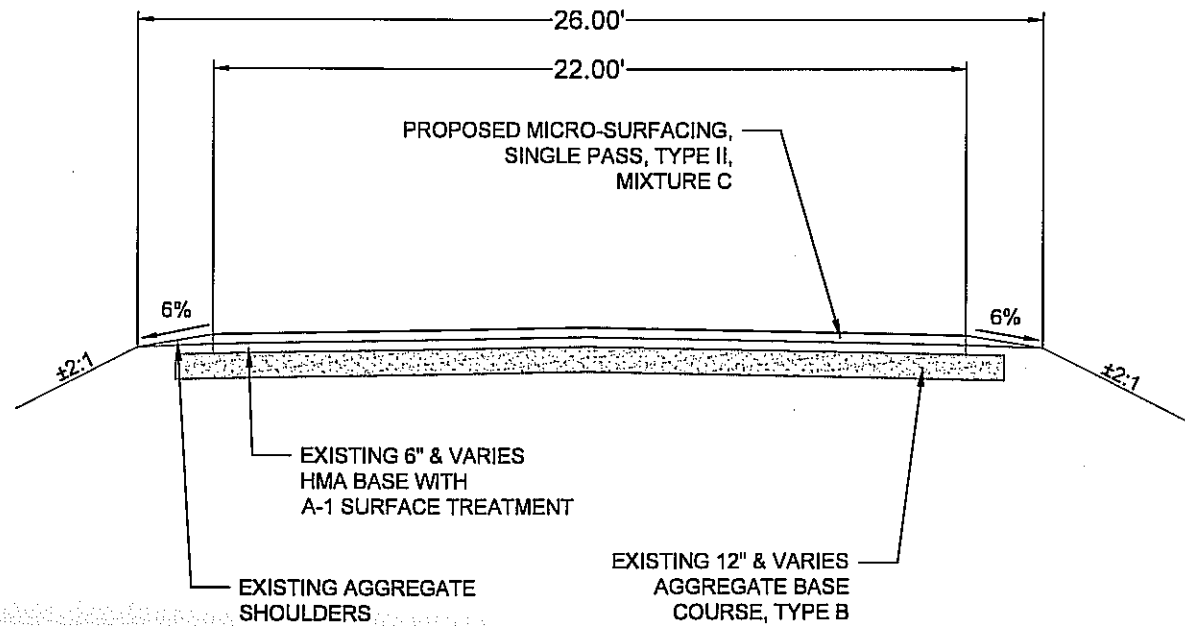

DETAILED SURFACE INFORMATION

STA. - STA.	THICKNESS	SURFACE TYPE
100+00 - 240+52	3.5	HMA
725+00 - 982+85	5.5	HMA

SUMMARY OF QUANTITIES

PAY ITEM CODE	PAY ITEM DESCRIPTION	UNIT	QUANTITY
40400113	MICRO-SURFACING, SINGLE PASS, TYPE II, MIXTURE C	SQ. YD.	95,913
67100100	MOBILIZATION	L. SUM	1
X7010216	TRAFFIC CONTROL AND PROTECTION, (SPECIAL)	L. SUM	1

* SEE SPECIAL PROVISIONS

CONSTRUCTION TYPE CODE: 0005

APPLICATION RATE

MICRO-SURFACE: 20 LBS. PER SQ. YD.

GENERAL NOTES

- WHERE SECTION OR SUBSECTION MONUMENTS ARE ENCOUNTERED, THE ENGINEER SHALL BE NOTIFIED BEFORE SUCH MONUMENTS ARE REMOVED. THE CONTRACTOR SHALL PROTECT AND CAREFULLY PRESERVE ALL PROPERTY MARKS AND MONUMENTS UNTIL THE OWNER, AN AUTHORIZED SURVEYOR, OR AGENT HAS WITNESSED OR OTHERWISE REFERENCED THEIR LOCATION.
- NO EXCAVATION IS ANTICIPATED FOR THIS PROJECT. SHOULD ANY EXCAVATION BE REQUIRED, BEFORE STARTING ANY EXCAVATION, THE CONTRACTOR MUST CALL J.U.L.I.E. AT 1-800-892-0123 OR 811 FOR FIELD LOCATIONS OF BURIED ELECTRICAL, TELEPHONE, GAS FACILITIES, AND ALL PUBLIC UTILITIES. A 48 HOUR NOTIFICATION IS REQUIRED.