

*REF-topol2

CONTRACT NO. 60A42

F.A.I. RTE.	SECTION	COUNTY	TOTAL SHEETS	SHEET NO.
80	99-1-I-3	WILL	34	18
STA. 1915+00		TO STA. 1930+00		
FED. ROAD DIST. NO.		ILLINOIS FED. AID PROJECT		

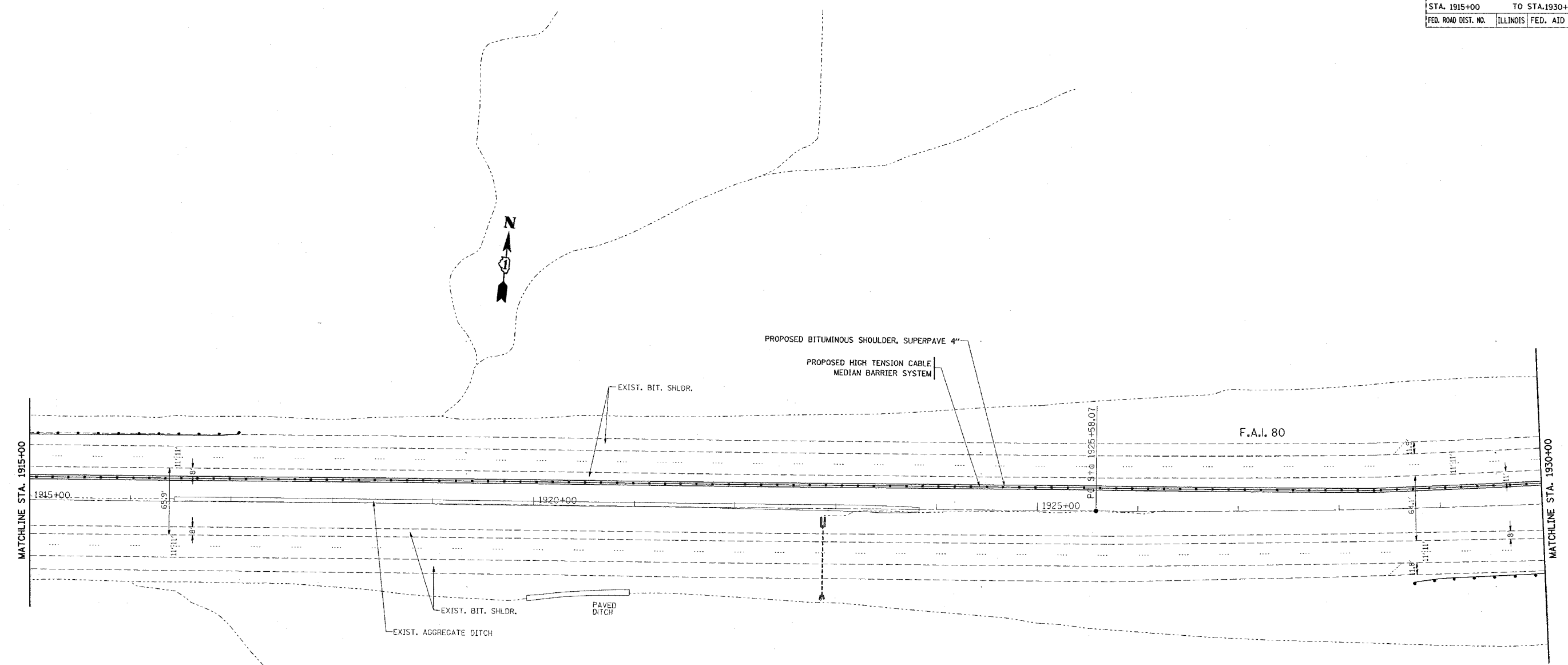

EXIST. CURVE E_180-3
 PI STA. = 1928+62.77
 $\Delta = 3^\circ 55' 03''$ (LT)
 $D = 0^\circ 38' 35''$
 $R = 8,909.49'$
 $T = 304.70'$
 $L = 609.16'$
 $E = 5.21'$
 $e =$
 $T.R. =$
 $S.E. OR UN = 0$
 $P.C. STA. = 1925+58.07$
 $P.T. STA. = 1931+67.23$

REVISIONS	
NAME	DATE

ILLINOIS DEPARTMENT OF TRANSPORTATION
 ROADWAY PLAN
 I-80
 GRUNDY COUNTY LINE TO I-55
 SCALE: VERT. 1"=50'
 HORIZ. DATE 3/9/2006
 DRAWN BY
 CHECKED BY

PLOT DATE = 3/9/2006
 FILE NAME = c:\projects\100206\100206_vh1_rdw.dgn
 USER = jbr
 USER NAME = jbr