

F.A.P. RTE.	SECTION	COUNTY	TOTAL SHEETS	SHEET NO.
342	530 N-2	COOK	53	9
STA.		TO STA.		
FED. ROAD DIST. NO. 1 ILLINOIS FED. AID PROJECT				
CONTRACT NO. 60A61				

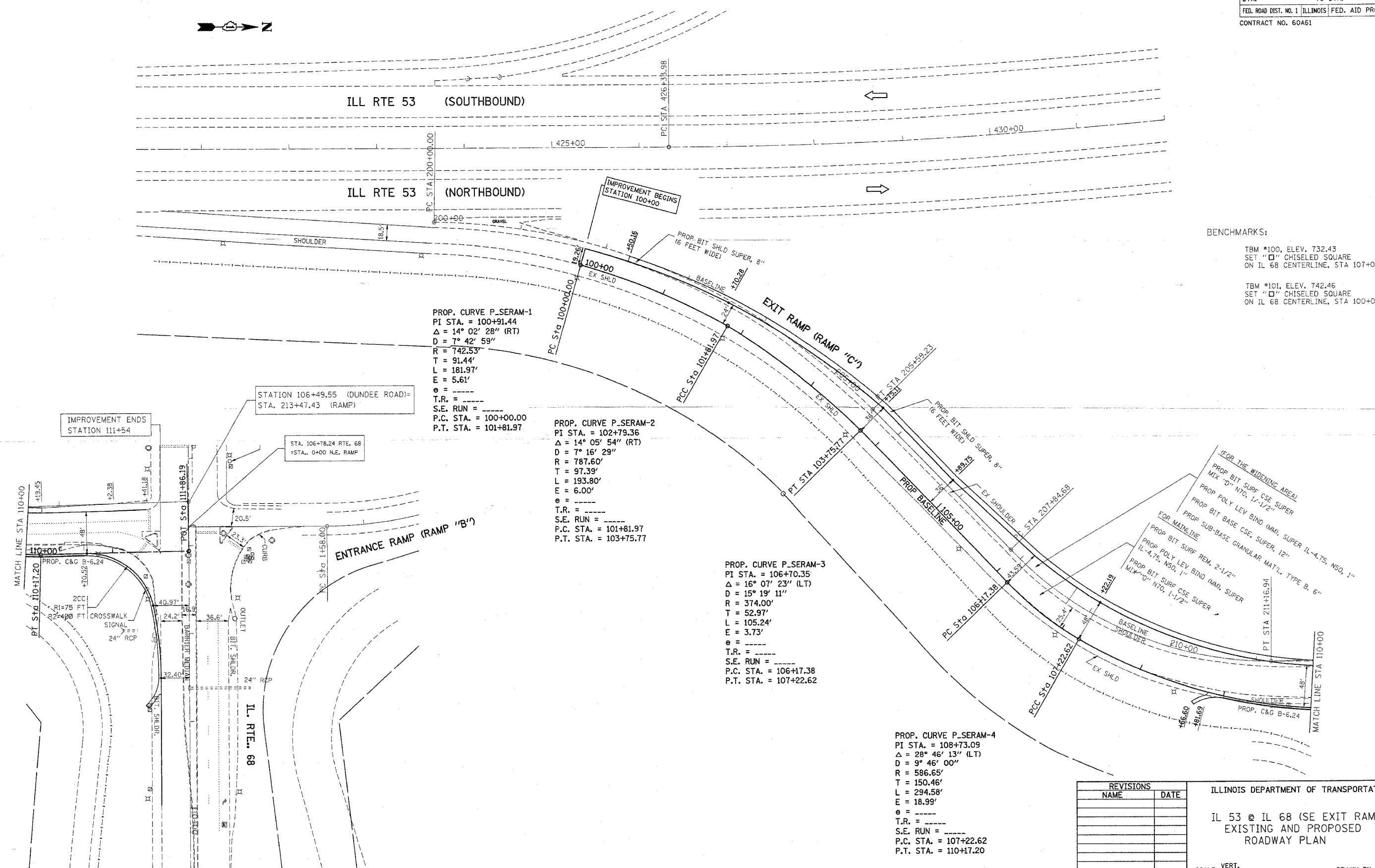
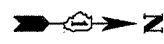

PROP. CURVE P_SERAM-1
 PI STA. = 100+91.44
 $\Delta = 14^\circ 02' 28''$ (RT)
 $D = 7^\circ 42' 59''$
 $R = 742.53'$
 $T = 91.44'$
 $L = 181.97'$
 $E = 5.61'$
 $\theta = \text{---}$
 $T.R. = \text{---}$
 $S.E. RUN = \text{---}$
 $P.C. STA. = 100+00.00$
 $P.T. STA. = 101+81.97$

PROP. CURVE P_SERAM-2
 PI STA. = 102+79.36
 $\Delta = 14^\circ 05' 54''$ (RT)
 $D = 7^\circ 16' 29''$
 $R = 787.60'$
 $T = 97.39'$
 $L = 193.80'$
 $E = 6.00'$
 $\theta = \text{---}$
 $T.R. = \text{---}$
 $S.E. RUN = \text{---}$
 $P.C. STA. = 101+81.97$
 $P.T. STA. = 103+75.77$

PROP. CURVE P_SERAM-3
 PI STA. = 106+70.35
 $\Delta = 16^\circ 07' 23''$ (LT)
 $D = 15^\circ 19' 11''$
 $R = 374.00'$
 $T = 52.97'$
 $L = 105.24'$
 $E = 3.73'$
 $\theta = \text{---}$
 $T.R. = \text{---}$
 $S.E. RUN = \text{---}$
 $P.C. STA. = 106+17.38$
 $P.T. STA. = 107+22.62$

PROP. CURVE P_SERAM-4
 PI STA. = 108+73.09
 $\Delta = 28^\circ 46' 13''$ (LT)
 $D = 9^\circ 46' 00''$
 $R = 586.65'$
 $T = 150.46'$
 $L = 294.58'$
 $E = 18.99'$
 $\theta = \text{---}$
 $T.R. = \text{---}$
 $S.E. RUN = \text{---}$
 $P.C. STA. = 107+22.62$
 $P.T. STA. = 110+17.20$

BENCHMARKS:
 TBM #100, ELEV. 732.43
 SET "□" CHISELED SQUARE
 ON IL 68 CENTERLINE, STA 107+00

 TBM #101, ELEV. 742.46
 SET "□" CHISELED SQUARE
 ON IL 68 CENTERLINE, STA 100+00

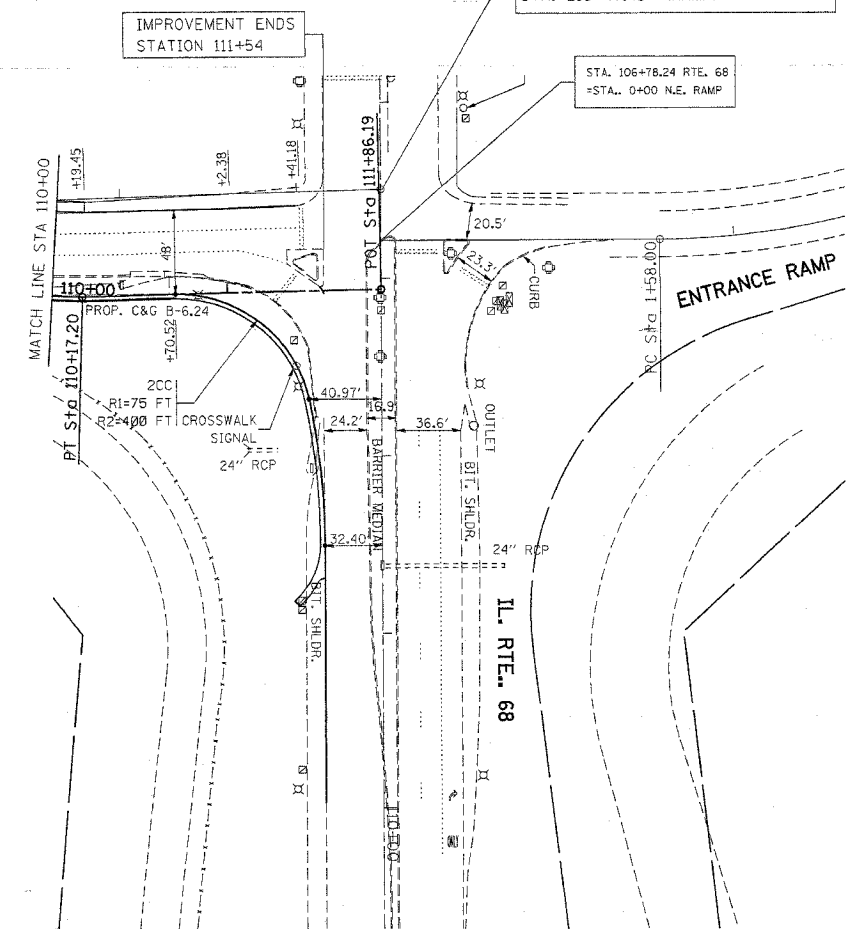

REVISIONS	
NAME	DATE

ILLINOIS DEPARTMENT OF TRANSPORTATION
 IL 53 @ IL 68 (SE EXIT RAMP)
 EXISTING AND PROPOSED
 ROADWAY PLAN

 SCALE: VERT. / HORIZ.
 DATE / DRAWN BY / CHECKED BY

PLOT DATE = 3/15/2006
 FILE NAME = c:\pvc\metsa\1088968\design-bb.dgn
 PLOT SCALE = 50.0000' / 1" / IN.
 USER NAME = gelbenn