

F.A.P. RTE.	SECTION	COUNTY	TOTAL SHEETS	SHEET NO.
342	530 N-2	COOK	53	10
STA.		TO STA.		
FED. ROAD DIST. NO. 1 ILLINOIS FED. AID PROJECT				
CONTRACT NO. 60A61				

LEGEND

- ① PROPOSED BITUMINOUS BASE COURSE, SUPERPAVE, 12" (OVERLAYED WITH POLY LEVEL BIND & BIT SURF)
- ② PROPOSED PAVED SHOULDER REMOVAL
- ③ PROPOSED COMB. CONC. CURB & GUTTER
- ④ PROPOSED BITUMINOUS SHOULDER
- ⑤ EXISTING PAVEMENT
- ⑥ PROP SUB BASE GRANULAR MATERIAL, TYPE "B", 6"
- ⑦ TYPE II BARRICADES OR DRUMS
- (A) PAVEMENT MARKING TYPE III 4" WHITE
- (B) PAVEMENT MARKING TYPE III 6" WHITE
- (C) PAVEMENT MARKING TYPE III 8" WHITE
- (D) PAVEMENT MARKING TAPE TYPE III 12" WHITE
- (E) PAVEMENT MARKING TYPE TAPE III 24" WHITE
- A-1 TEMPORARY PAVEMENT MARKING LINE 4" WHITE
- B-1 TEMPORARY PAVEMENT MARKING LINE 6" WHITE
- C-1 TEMPORARY PAVEMENT MARKING LINE 8" WHITE
- D-1 TEMPORARY PAVEMENT MARKING LINE 24" WHITE

- ⊥ SIGN
- ⊥ TYPE III BARRICADE WITH FLASHING LIGHTS
- ➔ DIRECTION OF TRAFFIC FLOW
- TYPE II BARRICADE OR DRUM WITH MONO-DIRECTIONAL STEADY BURN LIGHT
- ⊞⊞⊞⊞ TEMPORARY SAND MODULE IMPACT ATTENUATORS
- ▨ CONSTRUCTION AREA

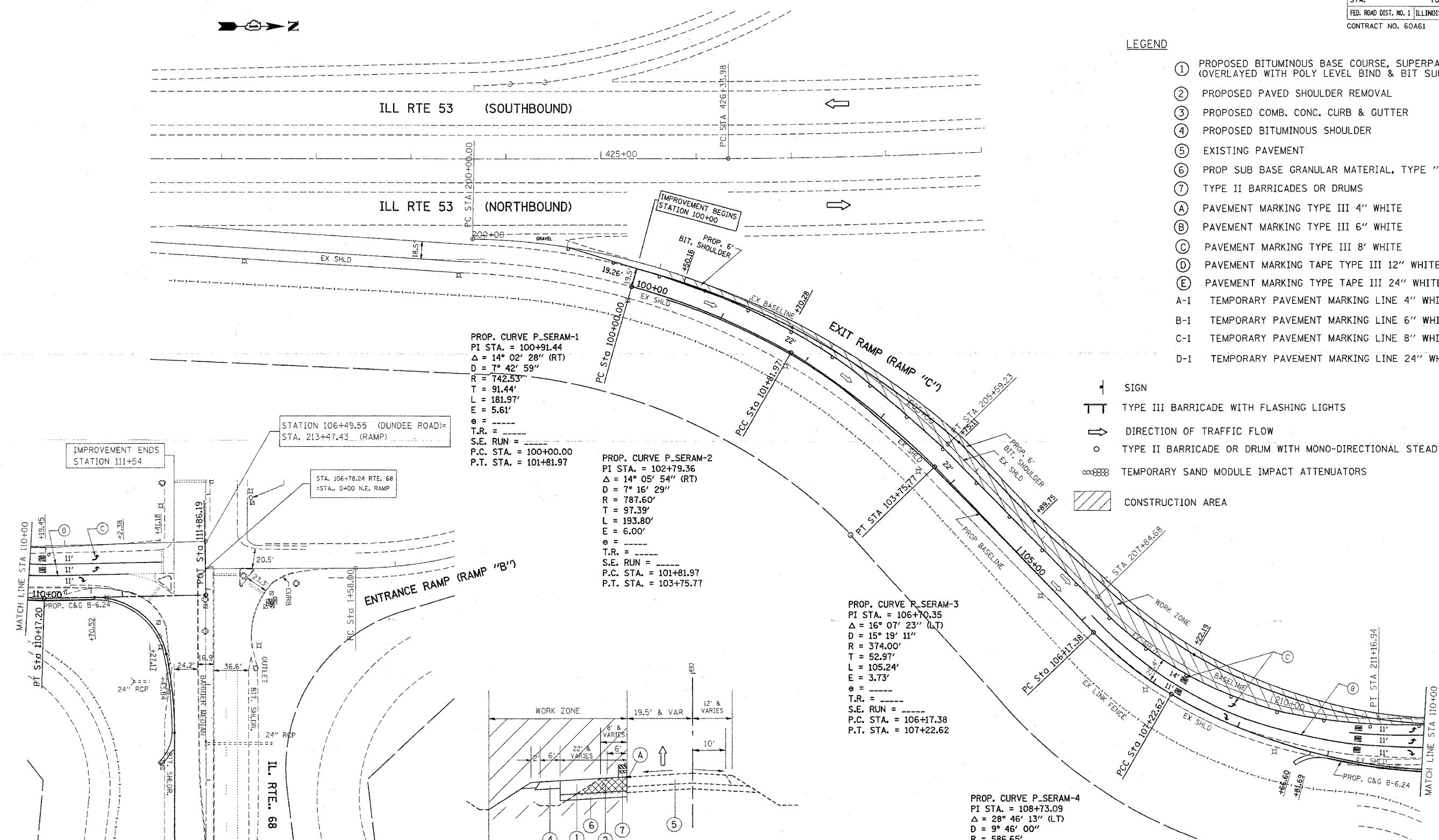

PROP. CURVE P_SERAM-1
 PI STA. = 100+91.44
 $\Delta = 14^\circ 02' 28''$ (RT)
 $D = 7^\circ 42' 59''$
 $R = 742.53'$
 $T = 91.44'$
 $L = 181.97'$
 $E = 5.61'$
 $\theta = \text{---}$
 T.R. = ---
 S.E. RUN = ---
 P.C. STA. = 100+00.00
 P.T. STA. = 101+81.97

PROP. CURVE P_SERAM-2
 PI STA. = 102+79.36
 $\Delta = 14^\circ 05' 54''$ (RT)
 $D = 7^\circ 16' 29''$
 $R = 787.60'$
 $T = 97.39'$
 $L = 193.80'$
 $E = 6.00'$
 $\theta = \text{---}$
 T.R. = ---
 S.E. RUN = ---
 P.C. STA. = 101+81.97
 P.T. STA. = 103+75.77

PROP. CURVE P_SERAM-3
 PI STA. = 106+70.35
 $\Delta = 16^\circ 07' 23''$ (LT)
 $D = 15^\circ 19' 11''$
 $R = 374.00'$
 $T = 52.97'$
 $L = 105.24'$
 $E = 3.73'$
 $\theta = \text{---}$
 T.R. = ---
 S.E. RUN = ---
 P.C. STA. = 106+17.38
 P.T. STA. = 107+22.62

PROP. CURVE P_SERAM-4
 PI STA. = 108+73.09
 $\Delta = 28^\circ 46' 13''$ (LT)
 $D = 9^\circ 46' 00''$
 $R = 586.65'$
 $T = 150.46'$
 $L = 294.58'$
 $E = 18.99'$
 $\theta = \text{---}$
 T.R. = ---
 S.E. RUN = ---
 P.C. STA. = 107+22.62
 P.T. STA. = 110+17.20

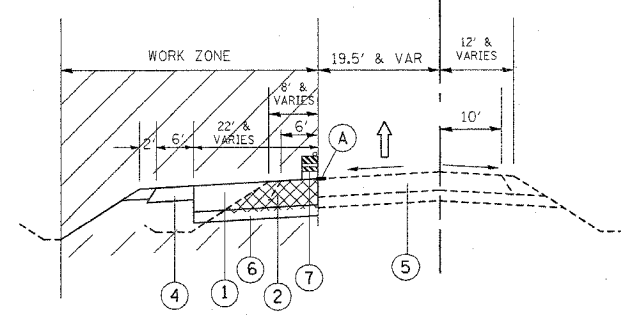

TYPICAL SECTION
 IL 53 (SE EXIT RAMP) @ IL 68
 STA 100+00 TO STA. 111+54
 STAGE I

PLOT DATE = 3/15/2005
 FILE NAME = c:\projects\11154\11154.dwg
 USER NAME = gshen

REVISIONS	
NAME	DATE

ILLINOIS DEPARTMENT OF TRANSPORTATION
 IL 53 @ IL 68 (SE EXIT RAMP)
 MAINTENANCE OF TRAFFIC
 STAGE I
 SCALE: VERT. _____
 HORIZ. _____
 DATE _____
 DRAWN BY _____
 CHECKED BY _____