

F.A.P. RTE.	SECTION	COUNTY	TOTAL SHEETS	SHEET NO.
342	530 N-2	COOK	53	11
STA.		TO STA.		
FED. ROAD DIST. NO. 1 ILLINOIS		FED. AID PROJECT		
CONTRACT NO. 60A61				



LEGEND

- ① PROPOSED BITUMINOUS BASE COURSE, SUPERPAVE, 12" (OVERLAYED WITH POLY LEVEL BIND & BIT SURF)
- ② PROPOSED PAVED SHOULDER REMOVAL
- ③ PROPOSED COMB. CONC. CURB & GUTTER
- ④ PROPOSED BITUMINOUS SHOULDER
- ⑤ EXISTING PAVEMENT
- ⑥ PROP SUB BASE, 6"
- ⑦ TYPE II BARRICADES OR DRUMS
- (A) PAVEMENT MARKING TYPE III 4" WHITE
- (B) PAVEMENT MARKING TYPE III 6" WHITE
- (C) PAVEMENT MARKING TYPE III 8" WHITE
- (D) PAVEMENT MARKING TAPE TYPE III 12" WHITE
- (E) PAVEMENT MARKING TAPE TYPE III 24" WHITE
- A-1 TEMPORARY PAVEMENT MARKING LINE 4" WHITE
- B-1 TEMPORARY PAVEMENT MARKING LINE 6" WHITE
- C-1 TEMPORARY PAVEMENT MARKING LINE 8" WHITE
- D-1 TEMPORARY PAVEMENT MARKING LINE 24" WHITE

- ⊥ SIGN
- ⊥ TYPE III BARRICADE WITH FLASHING LIGHTS
- ➔ DIRECTION OF TRAFFIC FLOW
- TYPE II BARRICADE OR DRUM WITH MONO-DIRECTIONAL STEADY BURN LIGHT
- ⊞ TEMPORARY SAND MODULE IMPACT ATTENUATORS
- ▨ CONSTRUCTION AREA

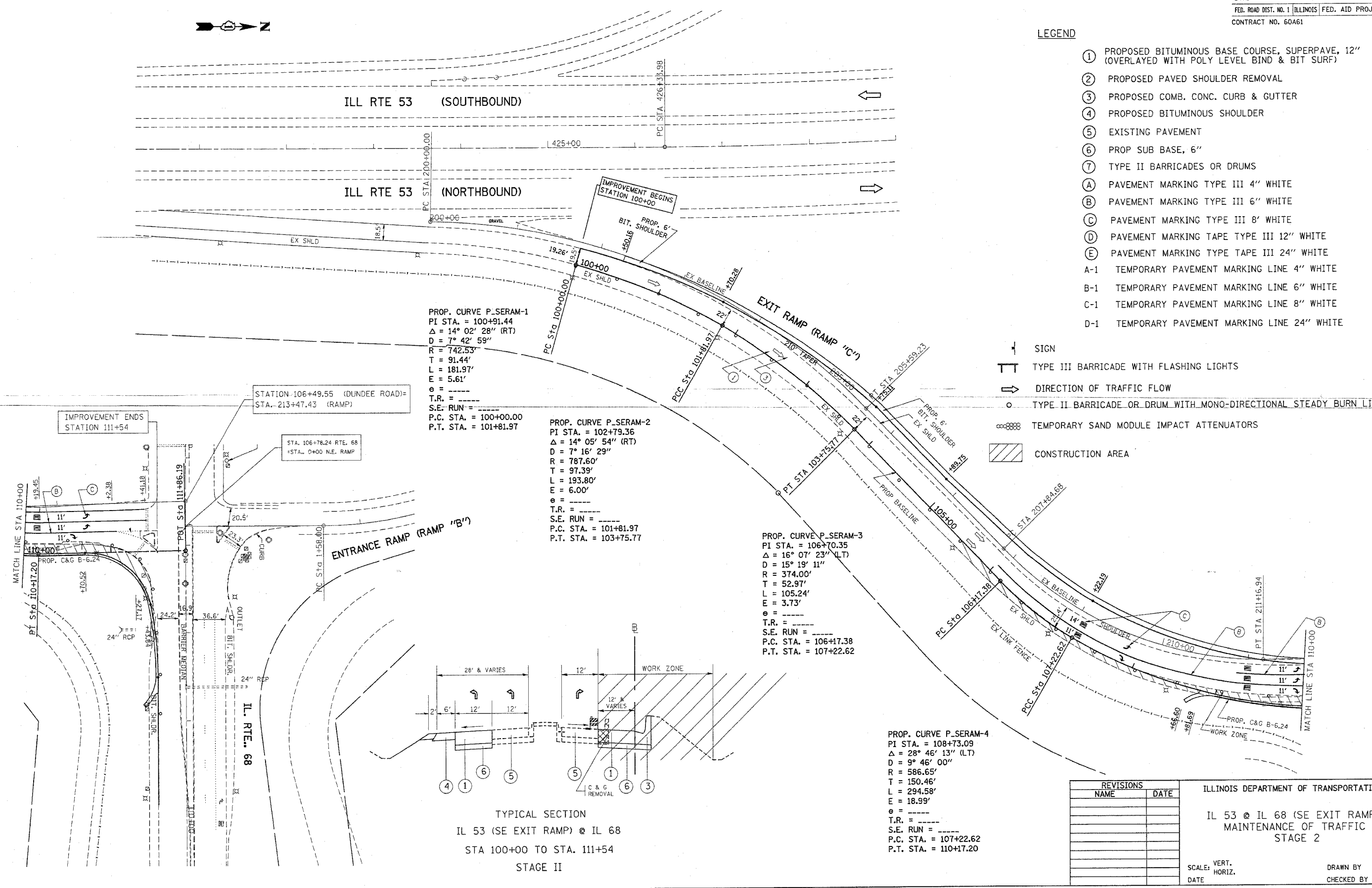

PROP. CURVE P.SERAM-1
 PI STA. = 100+91.44
 $\Delta = 14^\circ 02' 28''$ (RT)
 $D = 7^\circ 42' 59''$
 $R = 742.53'$
 $T = 91.44'$
 $L = 181.97'$
 $E = 5.61'$
 $e =$
 T.R. =
 S.E. RUN =
 P.C. STA. = 100+00.00
 P.T. STA. = 101+81.97

PROP. CURVE P.SERAM-2
 PI STA. = 102+79.36
 $\Delta = 14^\circ 05' 54''$ (RT)
 $D = 7^\circ 16' 29''$
 $R = 787.60'$
 $T = 97.39'$
 $L = 193.80'$
 $E = 6.00'$
 $e =$
 T.R. =
 S.E. RUN =
 P.C. STA. = 101+81.97
 P.T. STA. = 103+75.77

PROP. CURVE P.SERAM-3
 PI STA. = 106+70.35
 $\Delta = 16^\circ 07' 23''$ (LT)
 $D = 15^\circ 19' 11''$
 $R = 374.00'$
 $T = 52.97'$
 $L = 105.24'$
 $E = 3.73'$
 $e =$
 T.R. =
 S.E. RUN =
 P.C. STA. = 106+17.38
 P.T. STA. = 107+22.62

PROP. CURVE P.SERAM-4
 PI STA. = 108+73.09
 $\Delta = 28^\circ 46' 13''$ (LT)
 $D = 9^\circ 46' 00''$
 $R = 586.65'$
 $T = 150.46'$
 $L = 294.58'$
 $E = 18.99'$
 $e =$
 T.R. =
 S.E. RUN =
 P.C. STA. = 107+22.62
 P.T. STA. = 110+17.20

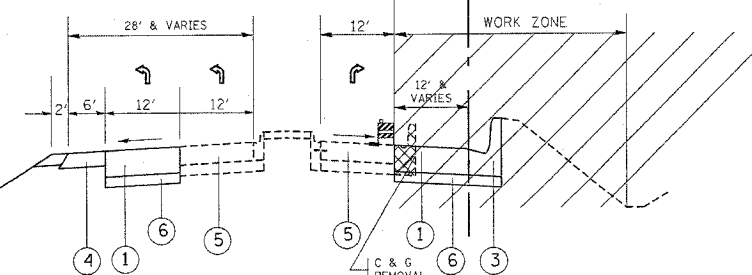

TYPICAL SECTION
 IL 53 (SE EXIT RAMP) @ IL 68
 STA 100+00 TO STA. 111+54
 STAGE II

REVISIONS	
NAME	DATE

ILLINOIS DEPARTMENT OF TRANSPORTATION
 IL 53 @ IL 68 (SE EXIT RAMP)
 MAINTENANCE OF TRAFFIC
 STAGE 2
 SCALE: VERT. / HORIZ.
 DATE / DRAWN BY / CHECKED BY

PLOT DATE = 3/15/2006
 FILE NAME = c:\p\projects\1108196\design-bb.dgn
 PLOT SCALE = 800000 / 1" = 1 MI.
 USER NAME = gubbert