

F.A.P. RTE.	SECTION	COUNTY	TOTAL SHEETS	SHEET NO.
342	530 N-2	COOK	53	14
STA.		TO STA.		
FED. ROAD DIST. NO. 1		ILLINOIS	FED. AID PROJECT	
CONTRACT NO. 60A61				

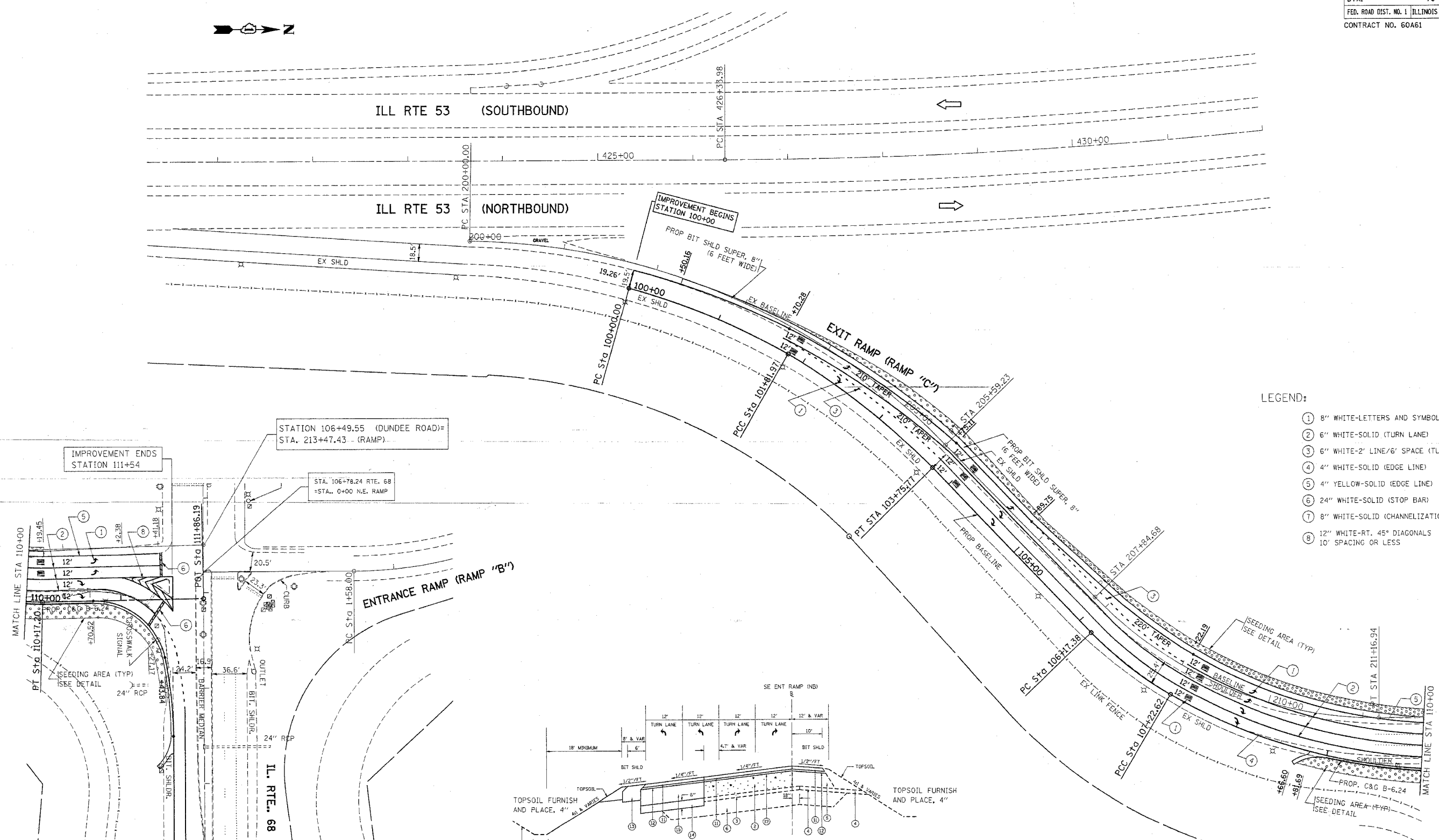

- LEGEND:
- ① 8" WHITE-LETTERS AND SYMBOLS
  - ② 6" WHITE-SOLID (TURN LANE)
  - ③ 6" WHITE-2" LINE/6" SPACE (TURN LANE)
  - ④ 4" WHITE-SOLID (EDGE LINE)
  - ⑤ 4" YELLOW-SOLID (EDGE LINE)
  - ⑥ 24" WHITE-SOLID (STOP BAR)
  - ⑦ 8" WHITE-SOLID (CHANNELIZATION)
  - ⑧ 12" WHITE-RT, 45° DIAGONALS 10' SPACING OR LESS

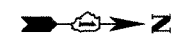
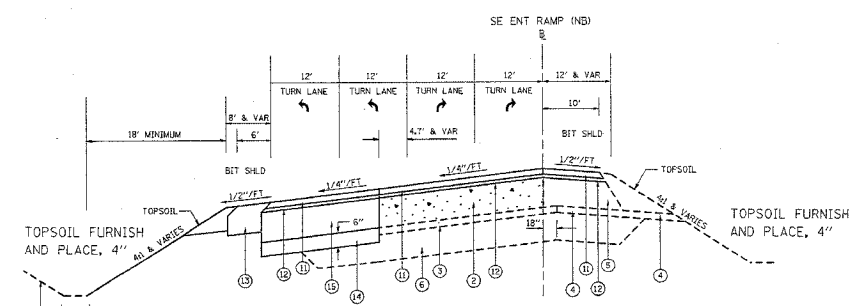

SEEDING CLASS, 2A  
 EROSION CONTROL BLANKET  
 NUTRIENTS

REVISIONS	
NAME	DATE

ILLINOIS DEPARTMENT OF TRANSPORTATION  
 IL 53 @ IL 68 (SE EXIT RAMP)  
 PAVEMENT MARKINGS AND  
 LANDSCAPING PLAN

SCALE: VERT. HORIZ.  
 DATE

DRAWN BY  
 CHECKED BY

PLOT DATE = 3/15/2006  
 FILE NAME = c:\projects\108198\design\bb.dgn  
 PLOT SCALE = 800000 / 1" = 800000'  
 USER NAME = gabbard