

F.A.P. RTE.	SECTION	COUNTY	TOTAL SHEETS	SHEET NO.
342	530 N-2	COOK	53	17
STA.		TO STA.		
FED. ROAD DIST. NO.		ILLINOIS FED. AID PROJECT		
CONTRACT NO. 60A61				

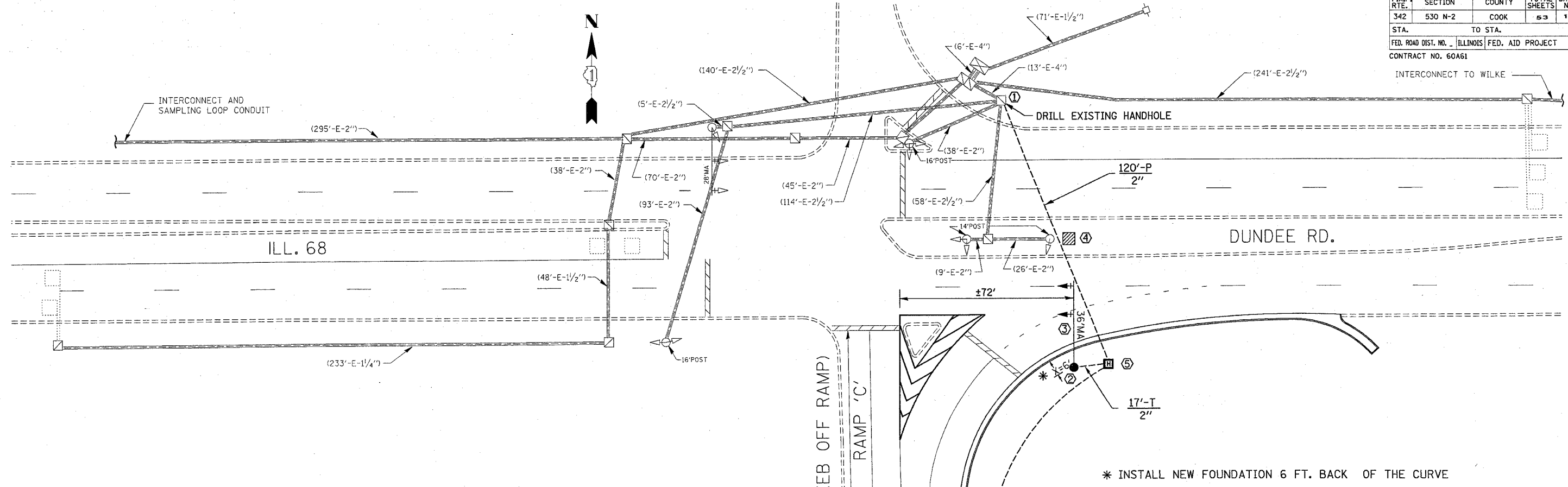

**CONSTRUCTION NOTES:**

- ① DRILL EXISTING HANDHOLE
- ② INSTALL CONCRETE FOUNDATION, TYPE "E" 30-INCH DIAMETER
- ③ INSTALL STEEL MAST ARM ASSEMBLY & POLE, 36 FT
- ④ REPLACE 25 SF. OF CONCRETE FROM THE MEDIAN AFTER REMOVE TEMP. WOOD POLE
- ⑤ INSTALL HEAVY-DUTY HANDHOLE (2)

**TRAFFIC SIGNAL LEGEND**

	PROPOSED	EXISTING		PROPOSED	EXISTING
CONTROLLER CABINET			SIGNAL HEAD WITH LOUVERS		
RAILROAD CONTROL CABINET			JUNCTION BOX		
SERVICE INSTALLATION, (P) POLE OR (G) GROUND MOUNT			HANDHOLE		
TELEPHONE CONNECTION			HEAVY DUTY HANDHOLE		
SIGNAL HEAD			DOUBLE HANDHOLE		
SIGNAL HEAD WITH BACKPLATE			G.S. CONDUIT IN TRENCH OR PUSHED		
SIGNAL HEAD OPTICALLY PROGRAMMED			COMMON TRENCH		
SIGNAL HEAD PEDESTRIAN			UNIT DUCT		
ILLUMINATED SIGN "NO LEFT TURN"			PEDESTRIAN PUSHBUTTON DETECTOR		
ILLUMINATED SIGN "NO RIGHT TURN"			DETECTOR LOOP, TYPE I		
SIGNAL POST			PERFORMED DETECTOR LOOP		
WOOD POLE			MICROWAVE VEHICLE SENSOR		
STEEL MAST ARM ASSEMBLY AND POLE			VIDEO DETECTOR		
ALUMINUM MAST ARM ASSEMBLY AND POLE			CLOSED CIRCUIT TV		
STEEL COMBINATION MAST ARM ASSEMBLY AND POLE WITH LUMINAIRE			EMERGENCY VEHICLE SYSTEM DETECTOR		
			CONFIRMATION BEACON		

REVISIONS		NAME	DATE
NO.	DESCRIPTION		

ILLINOIS DEPARTMENT OF TRANSPORTATION

**TRAFFIC SIGNAL MODIFICATION**  
IL.53 (EAST RAMP) AT IL.68 (DUNDEE RD.)

SCALE: 1"=20'  
DATE: 01-10-2006

DRAWN BY: SN  
DESIGNED BY: SN  
CHECKED BY: DAD

PLOT DATE = 1/25/2006  
 FILE NAME = c:\p\projects\1188986\1188986.dgn  
 PLOT SCALE = 28.0081 / IN.  
 USER NAME = nguyenan