

PROFILE SURVEYED  
 PLOTTED  
 NOTE BOOK  
 STRUCTURE NOTATIONS CHRD  
 NO. \_\_\_\_\_  
 DATE \_\_\_\_\_  
 BY \_\_\_\_\_

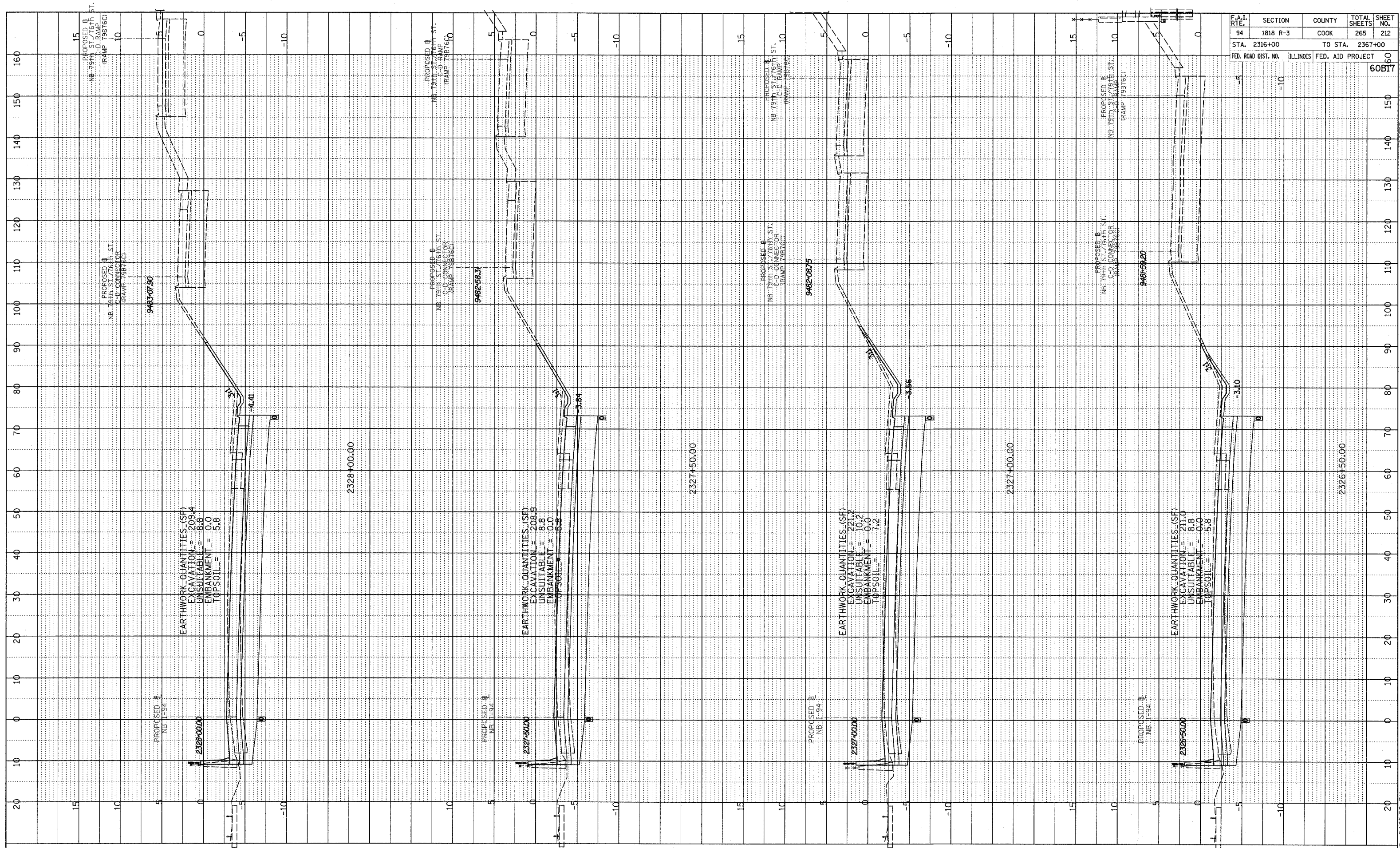

F.A.I. RTE.	SECTION	COUNTY	TOTAL SHEETS	SHEET NO.
94	1818 R-3	COOK	265	212
STA. 2316+00 TO STA. 2367+00				
FED. ROAD DIST. NO.		ILLINOIS	FED. AID PROJECT	
			60BT7	

TYLIN INTERNATIONAL

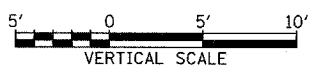
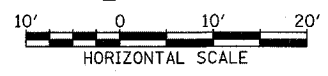

NORTHBOUND I-94 (DAN RYAN EXPWY)  
 STA. 2327+50 TO STA. 2328+50

03/03/2006 04:09:22 PM