

PROFILE DRAWING
 DATE: _____
 BY: _____
 CHECKED: _____
 DATE: _____
 NO. _____
 NOTE BOOK NO. _____
 REVISIONS: _____
 DATE: _____

F.A.L. RTE.	SECTION	COUNTY	TOTAL SHEETS	SHEET NO.
94	1818 R-3	COOK	265	227
STA. 2316+00	TO STA. 2367+00			
FED. ROAD DIST. NO.	ILLINOIS FED. AID PROJECT			

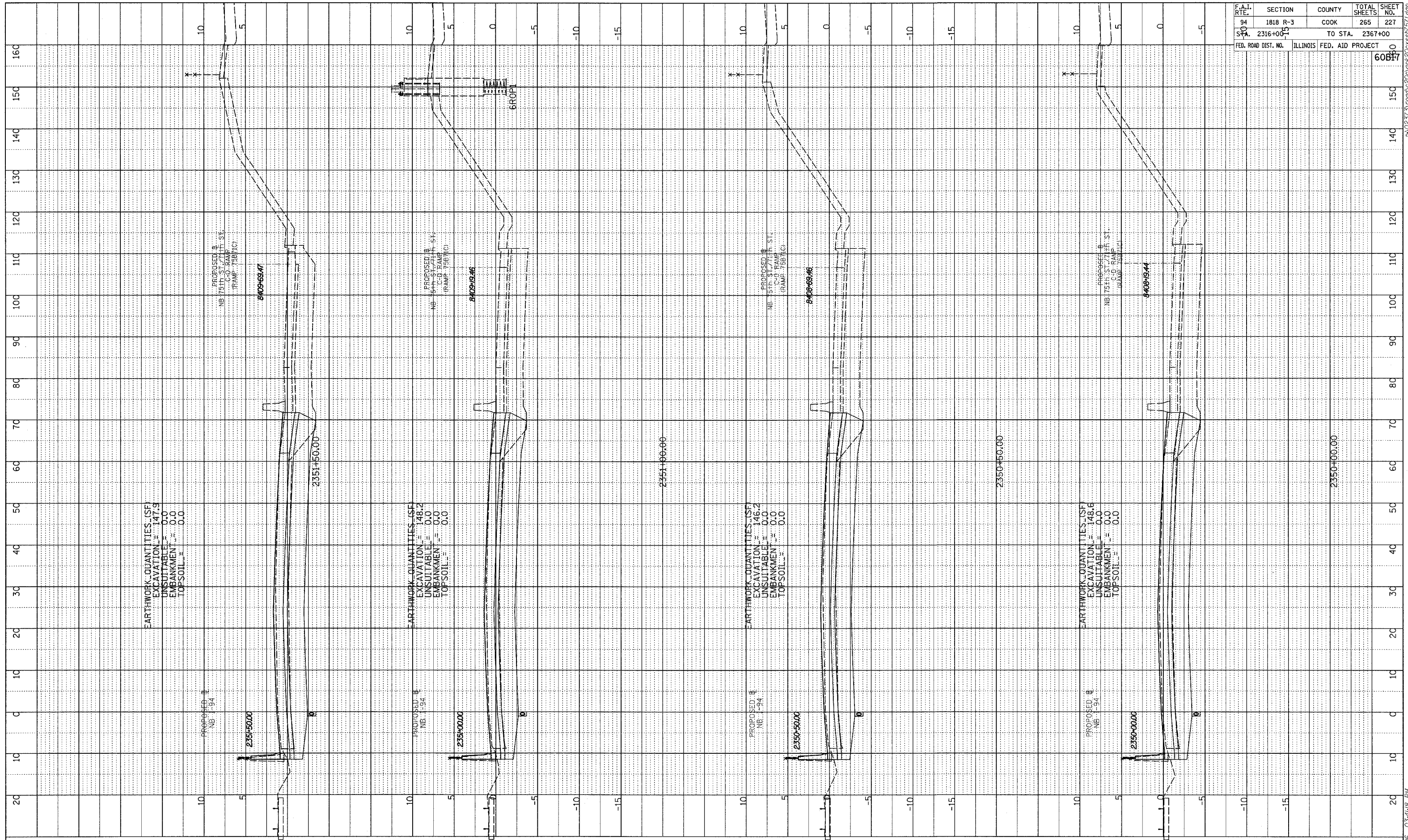

TYLIN INTERNATIONAL

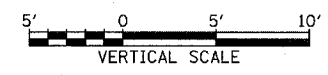
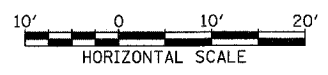

NORTHBOUND I-94 (DAN RYAN EXPWY)
 STA. 2350+50 TO STA. 2352+50

03/03/2006 03:41:48 PM