

F.A.I. RTE.	SECTION	COUNTY	TOTAL SHEETS	SHEET NO.
94		COOK	916	278
STA. 190+65 (NB I-57) TO STA. 2316+00 (NB RYAN)				
FED. ROAD DIST. NO. ILLINOIS FED. AID PROJECT				
• (1516.1, 1717, & 1818) R-4				

62304



**SIGNING LEGEND:**

- - - - - EXISTING GROUND MOUNTED SIGN
- - - - - EXISTING OVERHEAD TRUSS MOUNTED SIGN
- - - - - EXISTING OVERHEAD SIGN STRUCTURE-BRIDGE MOUNTED
- - - - - EXISTING OVERHEAD CANTILEVER MOUNTED SIGN
- - - - - PROPOSED GROUND MOUNTED SIGN
- - - - - PROPOSED OVERHEAD SIGN STRUCTURE - TRUSS
- ▨ CONSTRUCTION ZONE
- ◊ EXISTING SIGN
- ◊ EXISTING SIGN TO BE REMOVED
- ◊ PROPOSED SIGN

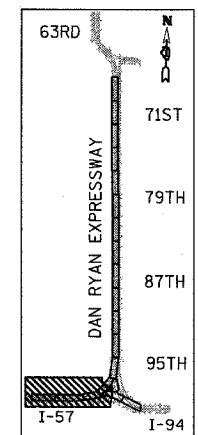

LOCATION MAP

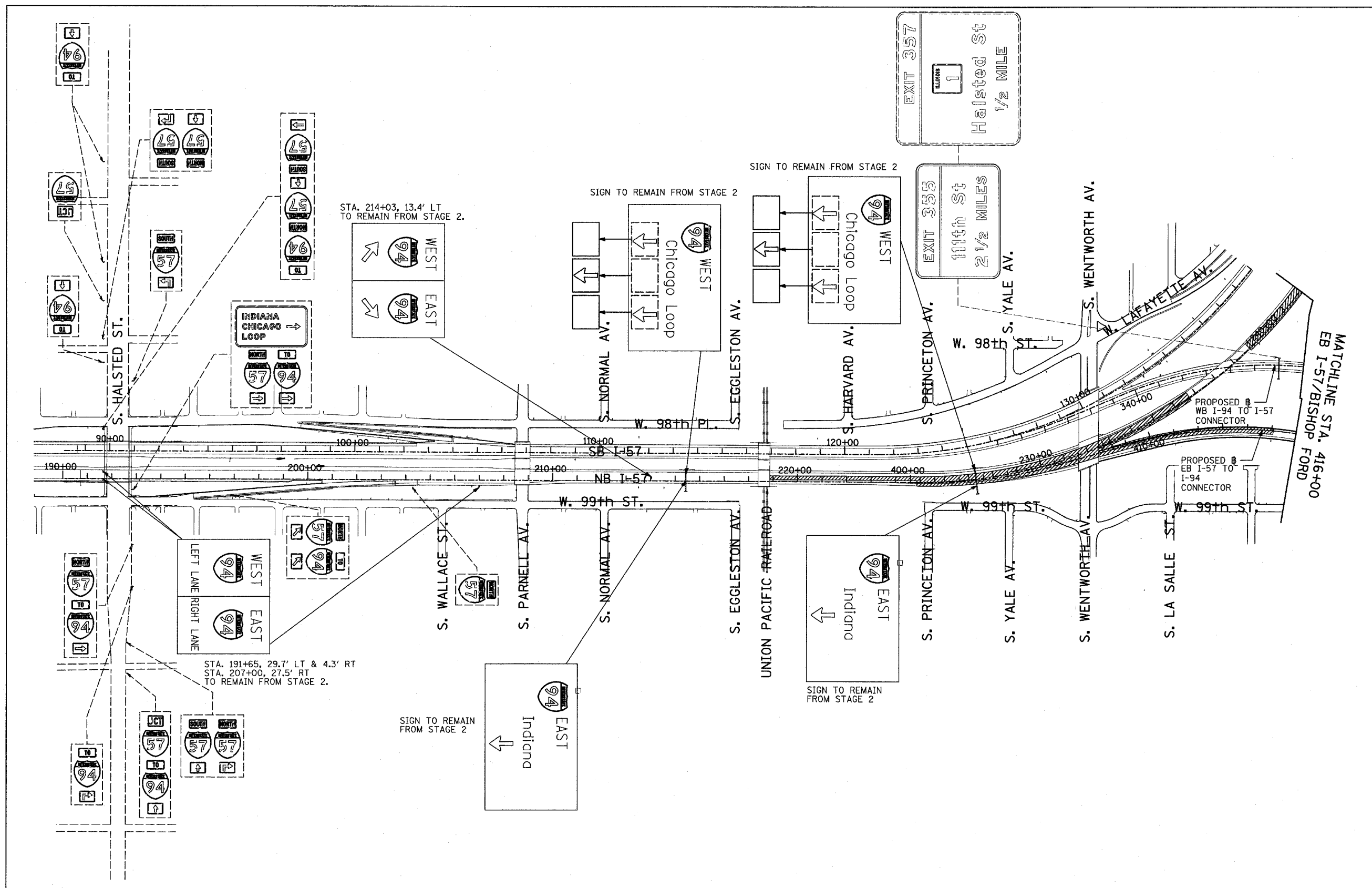

STA. 214+03, 13.4' LT TO REMAIN FROM STAGE 2.

SIGN TO REMAIN FROM STAGE 2

SIGN TO REMAIN FROM STAGE 2

SIGN TO REMAIN FROM STAGE 2

SIGN TO REMAIN FROM STAGE 2

STA. 191+65, 29.7' LT & 4.3' RT  
STA. 207+00, 27.5' RT  
TO REMAIN FROM STAGE 2.

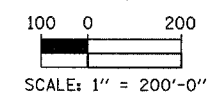

SCALE: 1" = 200'-0"

REVISIONS	
NAME	DATE

ILLINOIS DEPARTMENT OF TRANSPORTATION  
F.A.I. 94 (DAN RYAN EXPRESSWAY)  
**CONSTRUCTION SIGNING-STAGE 3**  
STA. 190+00 TO STA. 416+00  
SHEET 1 OF 3  
SCALE: 1" = 200'  
DATE: MARCH 7, 2006  
DRAWN BY: AMB  
CHECKED BY: TGB

TYLIN INTERNATIONAL