

F.A.I. RTE.	SECTION	COUNTY	TOTAL SHEETS	SHEET NO.
94		COOK	916	496
STA. 2295+18		TO STA. 2308+18		
FED. ROAD DIST. NO.	ILLINOIS	FED. AID PROJECT		
• (1516.1, 1717, & 1818) R-4		62304		

- NOTES:
- ROADWAY LIGHT POLES AND AERIAL CABLE SHALL BE REMOVED UNDER CONTRACT 62583. FOUNDATION REMOVAL SHALL BE INCLUDED AS PART OF THIS CONTRACT (62304).

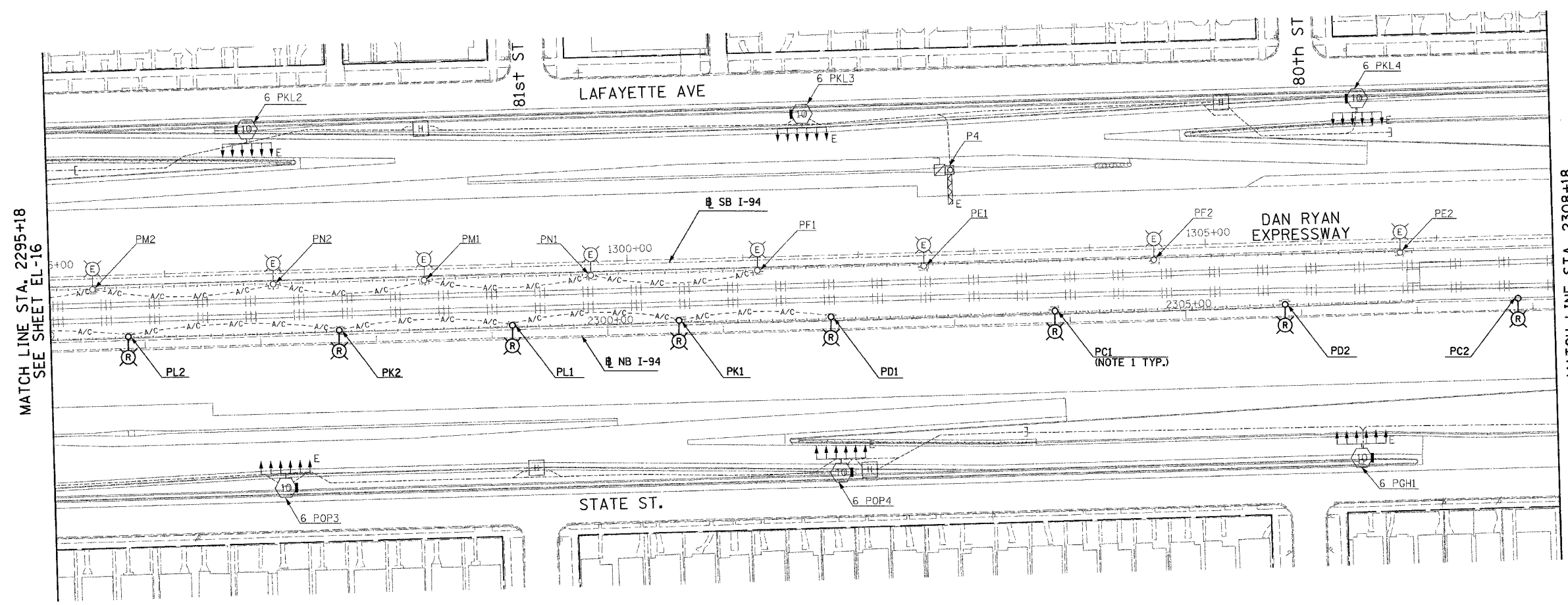
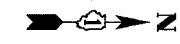

MATCH LINE STA. 2295+18
SEE SHEET EL-16

MATCH LINE STA. 2308+18
SEE SHEET EL-18

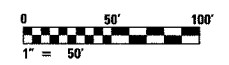

20/EL-17

REVISIONS	
NAME	DATE

ILLINOIS DEPARTMENT OF TRANSPORTATION
 F.A.I. 94 (DAN RYAN EXPRESSWAY)
 ROADWAY LIGHTING AND SURVEILLANCE PLANS
 EXISTING CONDITIONS AND DEMOLITION
 STA. 2295+18 TO STA. 2308+18

SCALE: 1"=50' DRAWN BY: YJ
 DATE: MARCH 7, 2006 CHECKED BY: TM

SINGH 300 W. ADAMS ST.
 CHICAGO, IL 60606
 SINGH & ASSOCIATES, INC. TEL: (312) 629-0240
 CONSULTING ENGINEERS FAX: (312) 629-8449

11/3/2005 AM
3/7/2006