

PROFILE SURVEYED  
 GRADES CHECKED  
 E.M. NOTED  
 STRUCTURE NOTATIONS SHOWN  
 BY  
 DATE

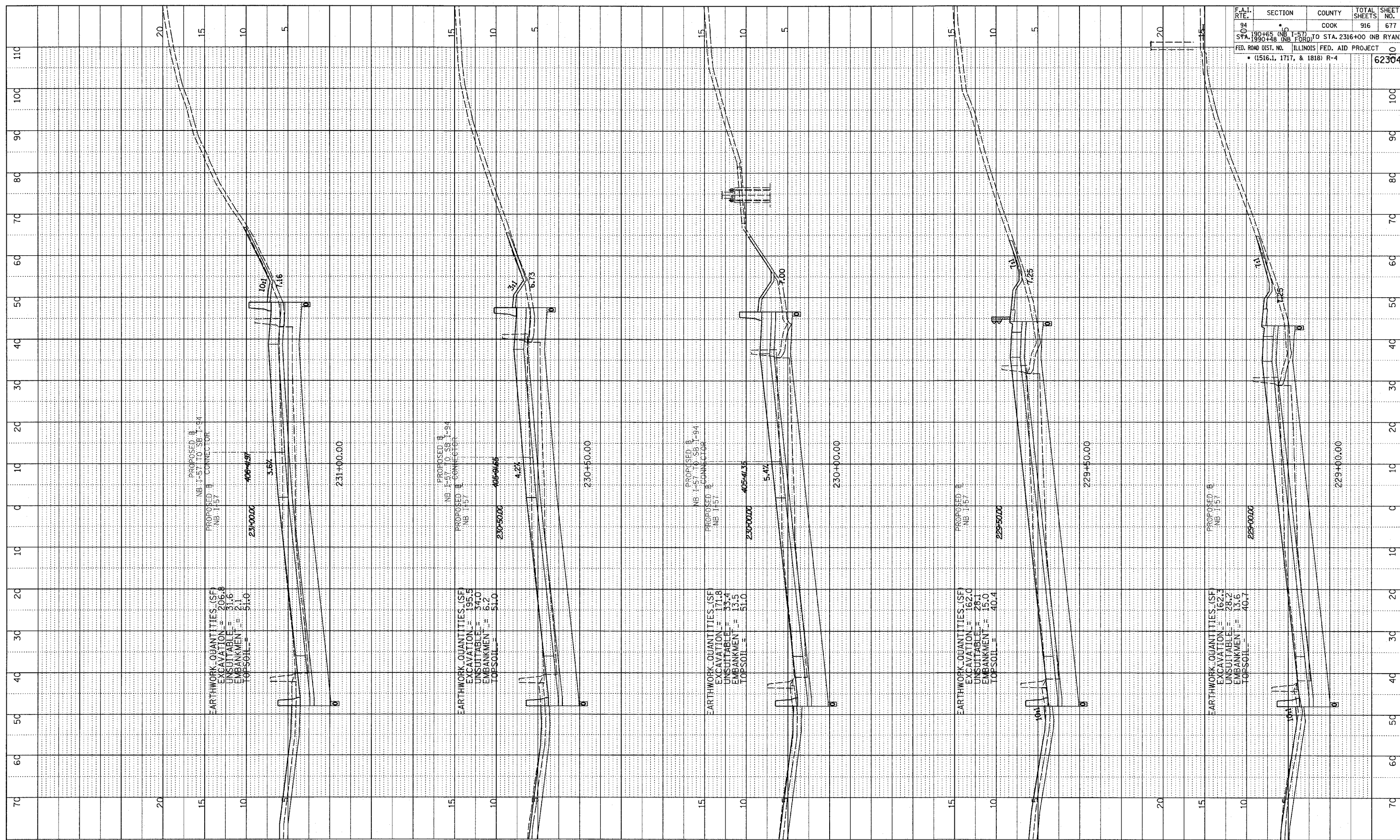

F.A.I. RTE.	SECTION	COUNTY	TOTAL SHEETS	SHEET NO.
94	10	COOK	916	677
STA. 190+65 (NB I-57) TO STA. 2316+00 (NB RYAN) STA. 190+48 (NB FORD)				
FED. ROAD DIST. NO. ILLINOIS FED. AID PROJECT • (1516.1, 1717, & 1818) R-4				
				62304

TYLIN INTERNATIONAL

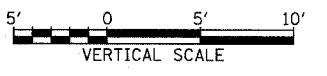
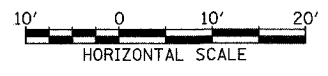

NORTHBOUND I-57  
 STA. 229+00 TO STA. 231+00

03/03/2006 04:00:31 PM