

PROFILE SURVEYED	BY	DATE
NOTE BOOK	GRADES CHECKED	
NO.	S.M. NOTED	
	PLUG DATE	NOTATIONS CIRC'D

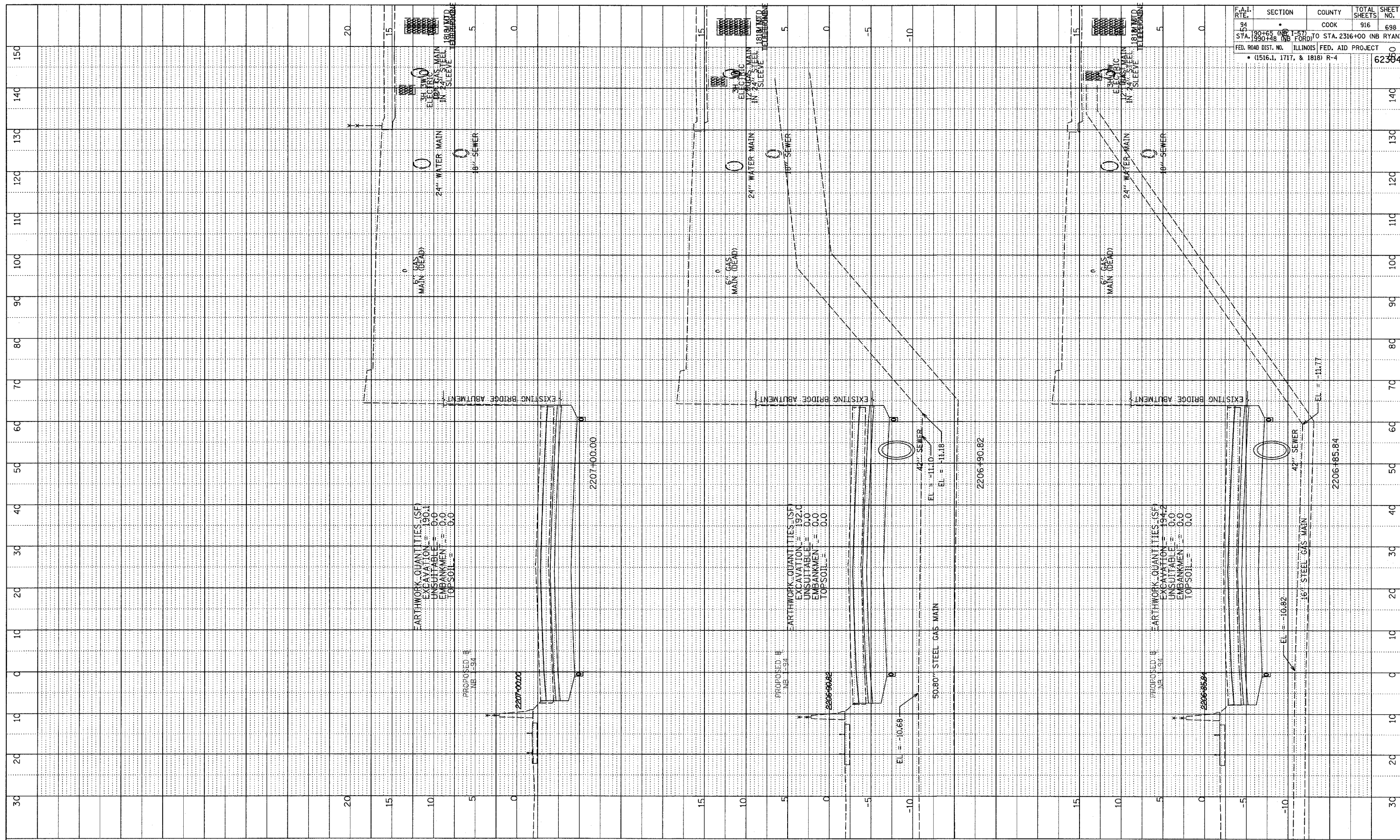

F.A.I. RTE.	SECTION	COUNTY	TOTAL SHEETS	SHEET NO.
94	157	COOK	916	698
STA. 1990+00	TO STA. 2316+00	FORD		
FED. ROAD DIST. NO. ILLINOIS FED. AID PROJECT				
• (1516.1, 1717, & 1818) R-4				

TYLIN INTERNATIONAL

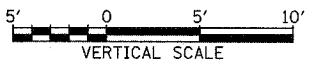
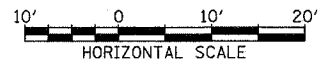

NORTHBOUND I-94 (DAN RYAN EXPWY)
STA. 2206+85.84 TO STA. 2207+00

03/03/2006 04:05:51 PM