

PROFILE SURVEYED \_\_\_\_\_ DATE \_\_\_\_\_  
 GRADES CHECKED \_\_\_\_\_  
 B.M. NOTED \_\_\_\_\_  
 NO. \_\_\_\_\_ STRUCTURE NOTATIONS CIP/D

F.A.I. RTE.	SECTION	COUNTY	TOTAL SHEETS	SHEET NO.
94	190+65 (NB I-57) TO STA. 2316+00 (NB RYAN)	COOK	916	704
FED. ROAD DIST. NO. ILLINOIS FED. AID PROJECT				
• (1516, 1, 1717, & 1818) R-4				
				<b>62384</b>

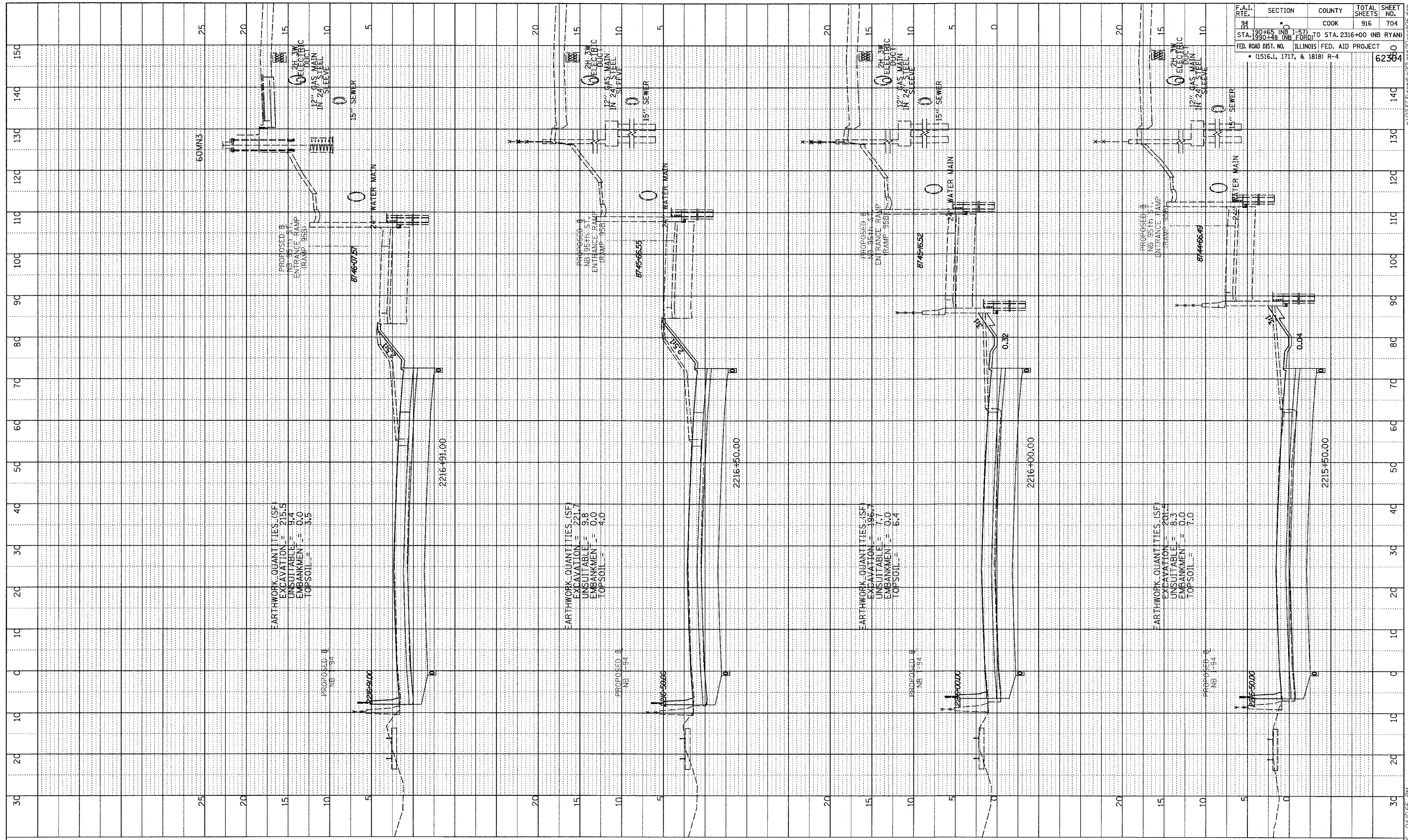

**TYLIN** INTERNATIONAL

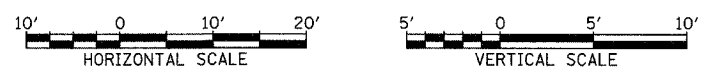

NORTHBOUND I-94 (DAN RYAN EXPWY)  
 STA. 2215+50 TO STA. 2216+51

P:\0237\3\road\20\gpk\20\rs\195.dgn 03/03/2006 04:40:55 PM