

PROFILE SURVEYED
 PLOTTED
 NOTE BOOK
 NO. _____
 STRUCTURE NOTATION CHWD
 BY _____ DATE _____

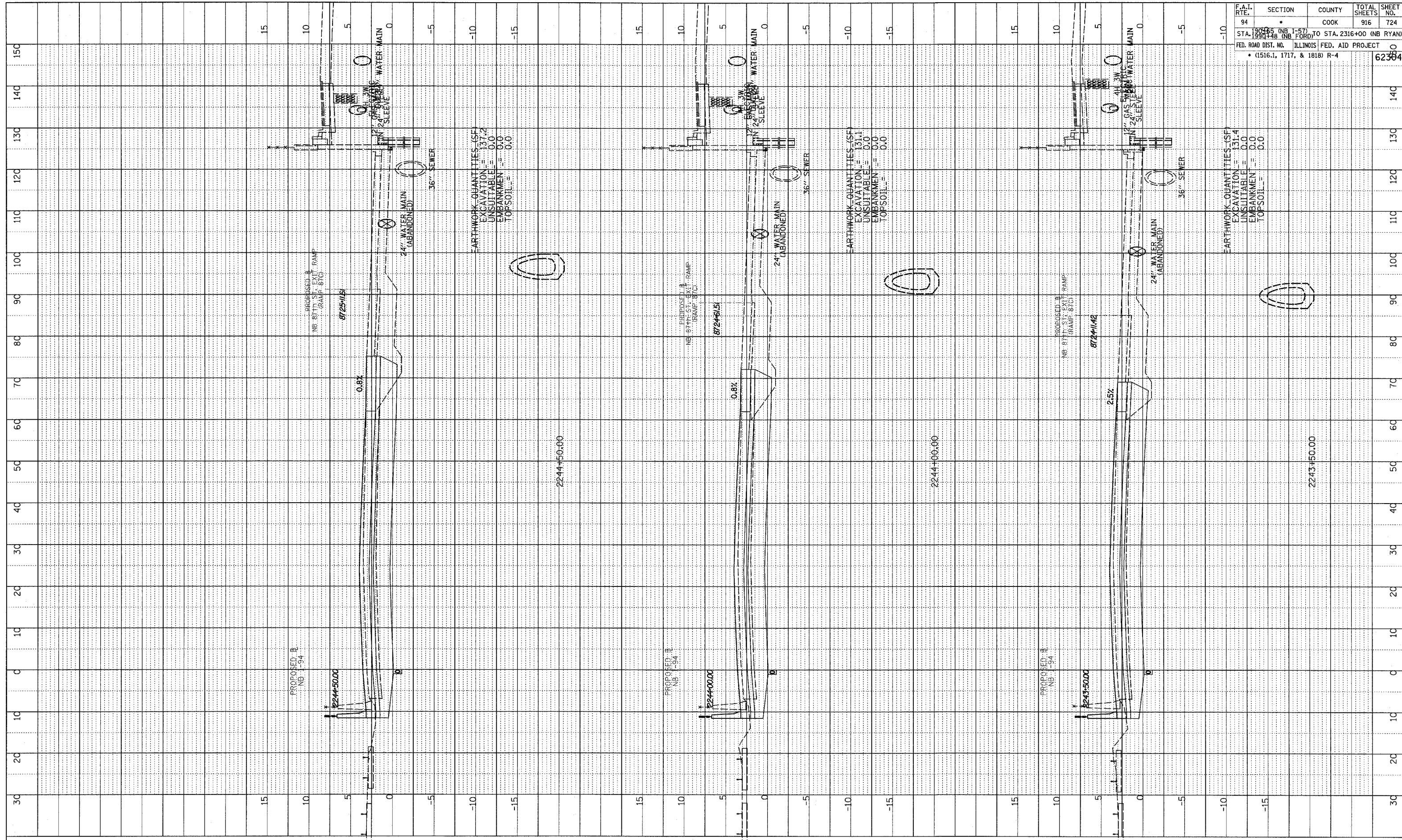

F.A.I. RTE.	SECTION	COUNTY	TOTAL SHEETS	SHEET NO.
94	*	COOK	916	724
STA. 190+00 (NB I-57) TO STA. 2316+00 (NB RYAN) STA. 190+148 (NB I-57) TO STA. 2316+00 (NB RYAN) FED. ROAD DIST. NO. ILLINOIS FED. AID PROJECT * (1516.1, 1717, & 1818) R-4				
				62384

TYLIN INTERNATIONAL

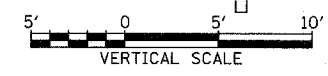
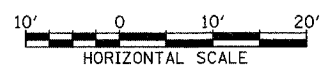

NORTHBOUND I-94 (DAN RYAN EXPY)
 STA. 2243+50 TO STA. 2244+50

03/07/2006 04:40:06 PM P:\02313\road\2006\202\202\87c.dgn