

PROFILE SURVEYED _____ DATE _____
 GRADES CHECKED _____
 BY _____
 NO. _____
 NOTE BOOK _____
 E.M. AND D. _____
 ENCLOSURE NOTATION CHVD

F.A.I. RTE.	SECTION	COUNTY	TOTAL SHEETS	SHEET NO.
94	190+65 (NB I-57) TO STA. 2316+00 (NB RYAN EXP)	COOK	916	750
ILLINOIS FED. AID PROJECT				
• (1516.1, 1717, & 1818) R-4				
				62384

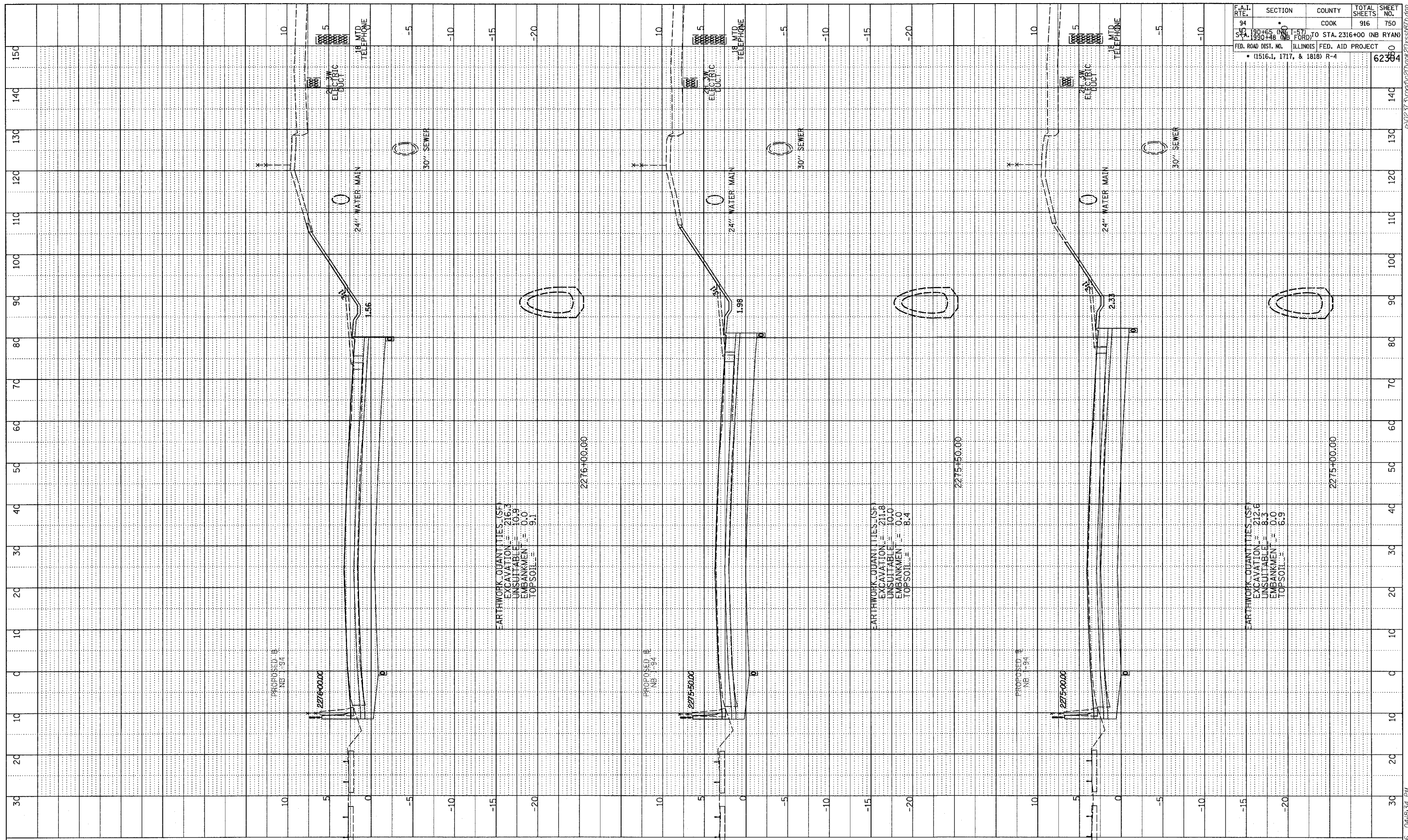

TYLIN INTERNATIONAL

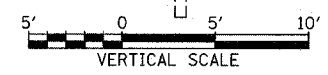
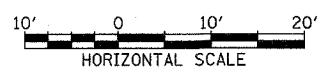

NORTHBOUND I-94 (DAN RYAN EXPWY)
STA. 2275+00 TO STA. 2276+00

03/03/2006 04:48:34 PM