

DATE	BT
PROFILE SURVEYED	
GRADES CHECKED	
B.M. NOTED	
NOTE BOOK	
PIT/UTILITY (NOT/THIS CHFD)	
NO.	

F.A.I. RTE.	SECTION	COUNTY	TOTAL SHEETS	SHEET NO.
94		COOK	916	751
TO STA. 190+65 (NB I-57) TO STA. 2316+00 (NB RYAN)				
STA. 190+48 (NB I-57) TO STA. 2316+00 (NB RYAN)				
FED. ROAD DIST. NO. ILLINOIS FED. AID PROJECT				
• (1516.1, 1717, & 1818) R-4				
				62384

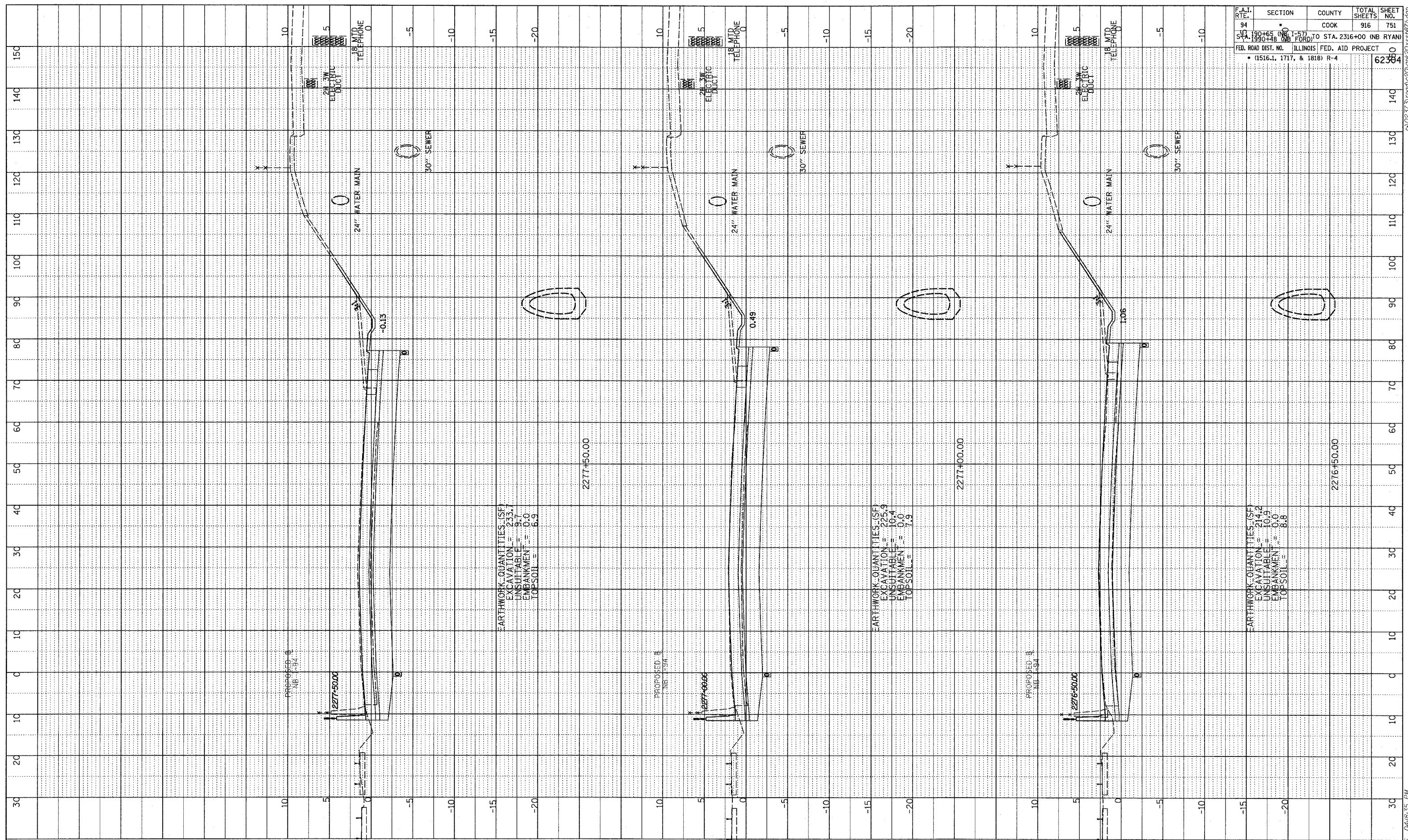

TYLIN INTERNATIONAL

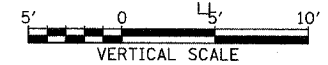
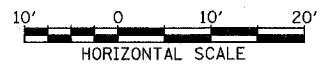

NORTHBOUND I-94 (DAN RYAN EXPWY)
 STA. 2276+50 TO STA. 2277+50

03/03/2006 04:18:35 PM