

PROFILE SURVEYED: _____ BY: _____ DATE: _____
 GRADES CHECKED: _____
 E.M. NOTED: _____
 NO. _____
 INCLUDE NOTATIONS: CHRD

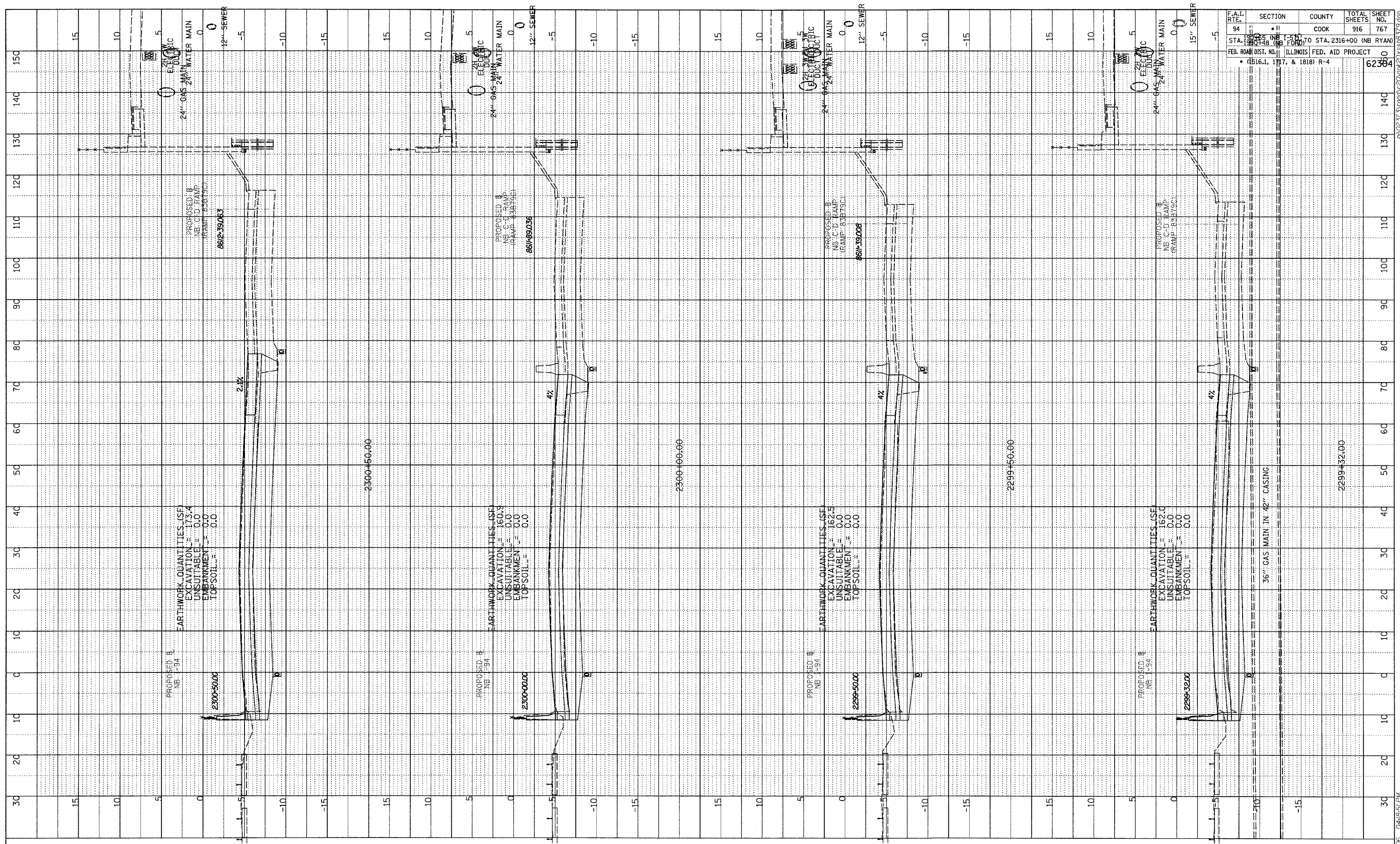

PROPOSED # NB I-94
 2300+50.00
 2.3%
 EARTHWORK QUANTITIES (SF)
 EXCAVATION = 173.4
 UNSUITABLE = 0.0
 EMBANKMENT = 0.0
 TOP SOIL = 0.0

PROPOSED # NB I-94
 2300+00.00
 4%
 EARTHWORK QUANTITIES (SF)
 EXCAVATION = 160.9
 UNSUITABLE = 0.0
 EMBANKMENT = 0.0
 TOP SOIL = 0.0

PROPOSED # NB I-94
 2299+50.00
 4%
 EARTHWORK QUANTITIES (SF)
 EXCAVATION = 162.5
 UNSUITABLE = 0.0
 EMBANKMENT = 0.0
 TOP SOIL = 0.0

PROPOSED # NB I-94
 2299+32.00
 4%
 EARTHWORK QUANTITIES (SF)
 EXCAVATION = 162.0
 UNSUITABLE = 0.0
 EMBANKMENT = 0.0
 TOP SOIL = 0.0

| F.A.T. RTE. | SECTION | COUNTY | TOTAL SHEETS | SHEET NO. |
|-------------|---------|--------|--------------|-----------|
| 94 | 11 | COOK | 916 | 767 |

STA. 198+48 (NB I-94) TO STA. 2316+00 (NB RYAN)
 FED. ROAD DIST. NO. 11 ILLINOIS FED. AID PROJECT
 • (1516.1, 177, & 1818) R-4

TYLIN INTERNATIONAL

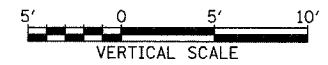

NORTHBOUND I-94 (DAN RYAN EXPWY)
 STA. 2299+32 TO STA. 2300+50

03/03/2006 04:48:51 PM