

PROFILE
 BY _____ DATE _____
 SURVEYED _____
 PLOTTED _____
 NOTE BOOK _____
 NO. _____
 STRUCTURE ARTIST'S CHRD

F.A.I. RTE.	SECTION	COUNTY	TOTAL SHEETS	SHEET NO.
94	190+00 (NB I-57) TO STA. 2316+00 (NB RYAN)	COOK	916	790
FED. ROAD DIST. NO. ILLINOIS FED. AID PROJECT				
• (1516.1, 1717, & 1818) R-4				

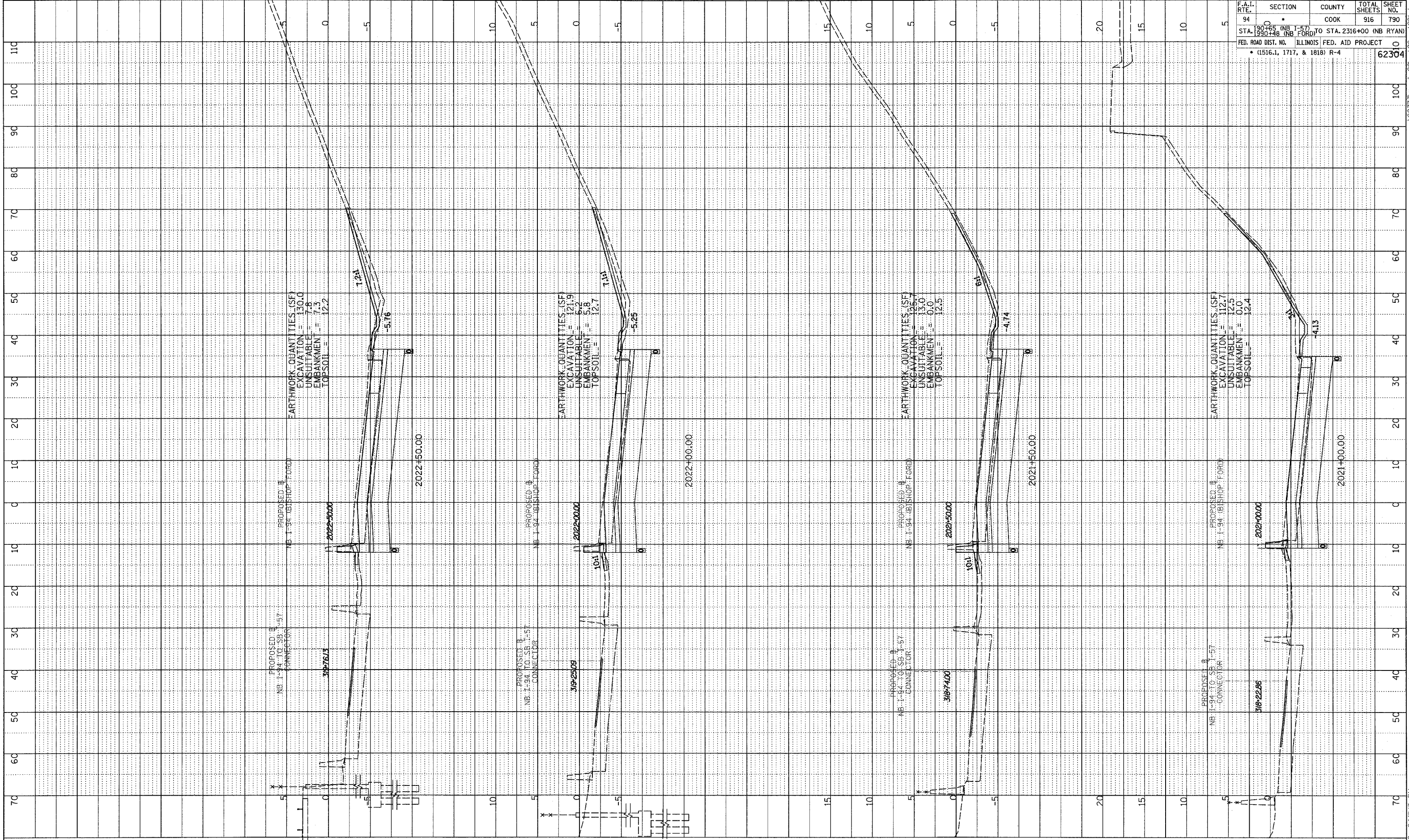

TYLIN INTERNATIONAL

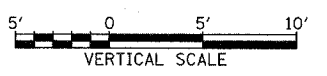
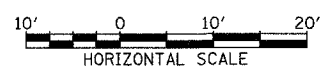

NORTHBOUND I-94 (BISHOP FORD EXPWY)
STA. 2021+00 TO STA. 2022+50

03/03/2006 04:19:13 PM R:\02373\work\2022\pk2022\ss999b.dgn