

PROFILE SURVEYED _____ DATE _____
 NOTE BOOK _____
 NO. _____
 BY _____
 GRADES CHECKED _____
 E.M. NOTED _____
 STRUCTURE NOTATIONS CHECKED _____

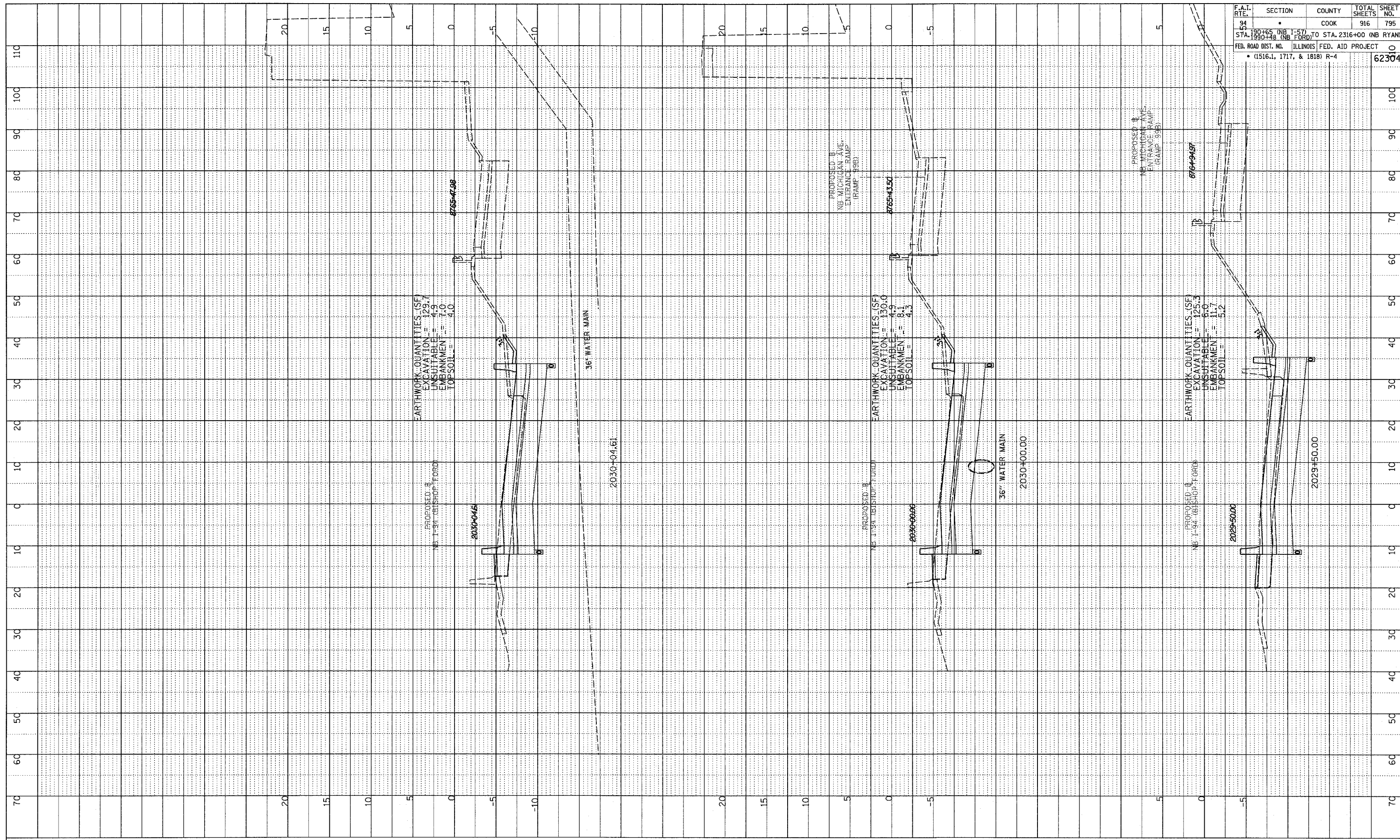

F.A.I. RTE.	SECTION	COUNTY	TOTAL SHEETS	SHEET NO.
94	190+65 (NB I-57) TO STA. 2316+00 (NB RYAN)	COOK	916	795
55	STA. 1990+48 (NB FORD) TO STA. 2316+00 (NB RYAN)			
ILLINOIS FED. AID PROJECT				62304
FED. ROAD DIST. NO. (1516.1, 1717, & 1818) R-4				

TYLIN INTERNATIONAL

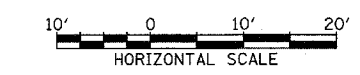

NORTHBOUND I-94 (BISHOP FORD EXPWY)
 STA. 2029+50 TO STA. 2030+04.61

03/03/2006 04:49:15 PM