

F.A.I. RTE.	SECTION	COUNTY	TOTAL SHEETS	SHEET NO.
90		COOK	81	18
STA. 3450+00 TO STA. 3480+00		ILLINOIS FED. AID PROJECT		
• (1012, 1214, 1415, & 1517) RS-3				

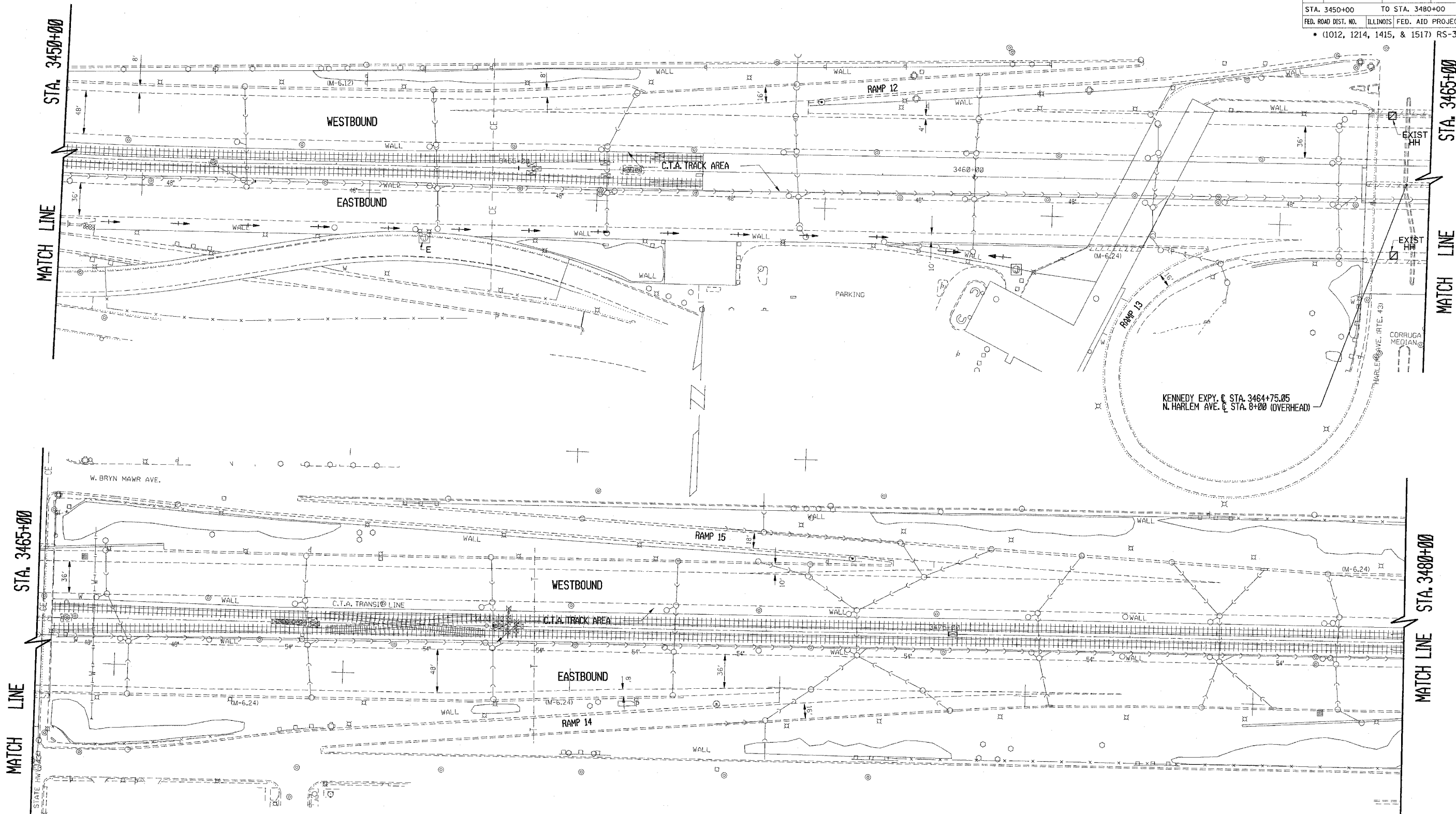

REVISIONS	
NAME	DATE

ILLINOIS DEPARTMENT OF TRANSPORTATION
F.A.I. ROUTE 90
KENNEDY EXPRESSWAY
EXISTING CONDITIONS
STA. 3450+00 TO STA. 3480+00

SCALE: HORIZ. SCALE IN FEET
 DATE 2/3/2006 DRAWN BY CADD CHECKED BY