

F.A.P. RTE.	SECTION	COUNTY	TOTAL SHEETS	SHEET NO.
553	125VBR-1	DEKALB	55	1

+1  
56

D-92-010-03

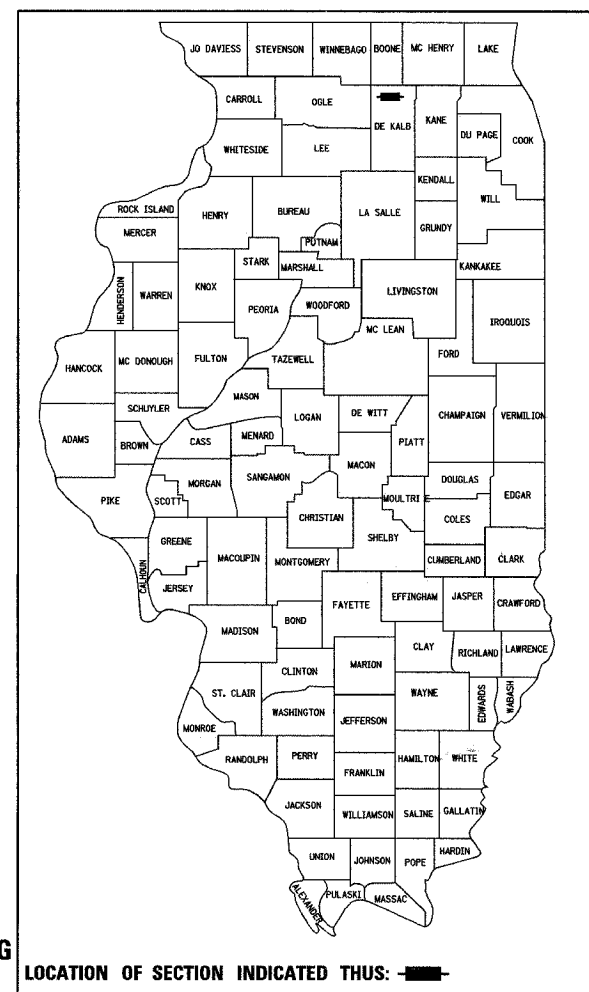

LOCATION OF SECTION INDICATED THUS: [Black Box]

**STATE OF ILLINOIS**  
**DEPARTMENT OF TRANSPORTATION**  
**DIVISION OF HIGHWAYS**  
**PLANS FOR PROPOSED**  
**FEDERAL AID HIGHWAY**  
**FAP ROUTE 553 (IL 72)**  
**SECTION 125VBR-1**  
**OVER IOWA CHICAGO AND EASTERN RAILROAD**  
**DEKALB COUNTY**  
**PROJECT NO. BRF-0553(149)**

PROJECT ENGINEER  
BOB WAGNER

**INDEX OF SHEETS**

- COVER SHEET
- GENERAL NOTES
- SUMMARY OF QUANTITIES
- TYPICAL SECTIONS
- 6. HORIZONTAL AND VERTICAL CONTROL
- 8. SCHEDULE OF QUANTITIES
- 10. PLAN AND PROFILE IL 72
- PLAN AND PROFILE IOWA CHICAGO & EASTERN RAILROAD
- PLAN AND PROFILE IRENE & QUARRY ROADS
- TRAFFIC CONTROL PLAN
- 30. STRUCTURAL PLANS - 30A SLIPFORM PARAPET DETAIL
- 35. STRUCTURE BORINGS
- 42. EXISTING BRIDGE PLANS (FOR INFORMATION ONLY)
- CONCRETE HEADWALLS FOR PIPE DRAINS (27.4)
- WITNESS MARKER FOR PERMANENT SURVEY MARKERS, TYPE II (38.4)
- EROSION CONTROL DETAILS FOR SILT FENCE (29.2)
- TYPICAL APPLICATION FOR ROAD CLOSURE (40.1)
- TOWNSHIP ROAD ENTRANCE DETAIL
- 55. CROSS SECTIONS

**HIGHWAY STANDARDS**

000001-04	STANDARD SYMBOLS, ABBREVIATIONS AND PATTERNS
001001	AREA OF REINFORCEMENT BARS
280001-02	TEMPORARY EROSION CONTROL SYSTEMS
420001-06	PAVEMENT JOINTS
420401-05	BRIDGE APPROACH PAVEMENT
421001-01	BAR REINFORCEMENT FOR CRC PAVEMENT
515001-02	NAME PLATE FOR BRIDGES
601101	CONCRETE HEADWALL FOR PIPE DRAIN
630001-06	STEEL PLATE BEAM GUARDRAIL
631031-05	TRAFFIC BARRIER TERMINAL, TYPE 6
635006-02	REFLECTOR AND TERMINAL MARKER PLACEMENT
635011-01	REFLECTOR MARKER AND MOUNTING DETAILS
667101	PERMANENT SURVEY MARKERS
701306-01	LANE CLOSURE, 2L, 2W, SLOW MOVING OPERATIONS DAY ONLY, FOR SPEEDS ≥ 45 MPH
702001-06	TRAFFIC CONTROL DEVICES
720011	METAL POSTS FOR SIGNS, MARKERS, AND DELINEATORS
780001-01	TYPICAL PAVEMENT MARKINGS
781001-02	TYPICAL APPLICATIONS RAISED REFLECTIVE PAVEMENT MARKERS

SENIOR SQUAD LEADER  
MICHAEL A. YUSEF  
815-284-5354

**TRAFFIC DATA**  
 HIGHWAY CLASSIFICATION: RURAL MINOR ARTERIAL  
 2008 ADT = 2850  
 DESIGN SPEED 55 MPH  
 POSTED SPEED 55 MPH

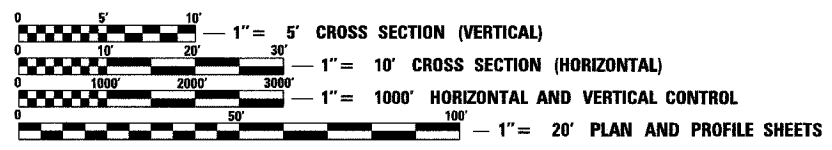

FULL SIZE PLANS HAVE BEEN PREPARED USING STANDARD ENGINEERING SCALES. REDUCED SIZED PLANS WILL NOT CONFORM TO STANDARD SCALES. IN MAKING MEASUREMENTS ON REDUCED PLANS, THE ABOVE SCALES MAY BE USED.

J.U.L.I.E.  
 JOINT UTILITY LOCATION INFORMATION FOR EXCAVATION  
 1-800-892-0123

**CONTRACT NO. 64858**

JAMES K. CLINARD  
CHAMLIN & ASSOCIATES  
815-223-3344

**C-92-114-06**  
**R. 3 E. 3 P.M.**

BEGIN PROJECT  
STA. 142 + 00

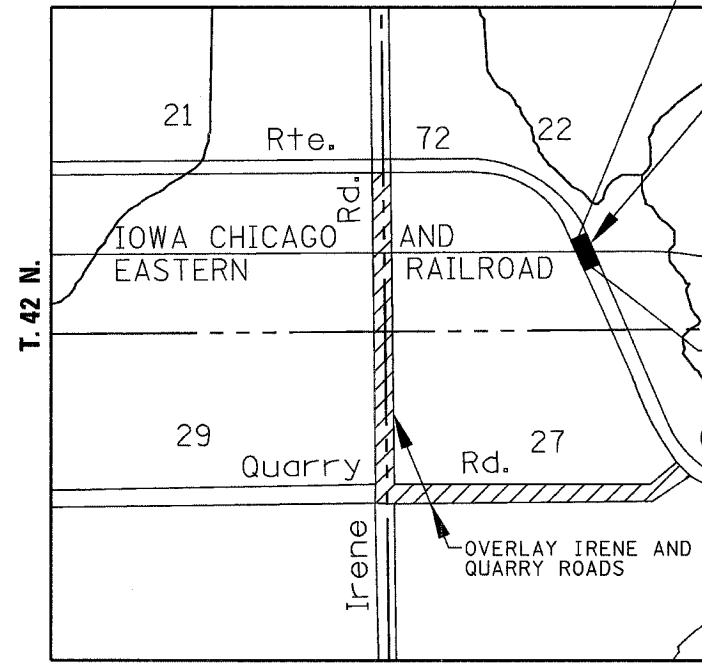

**SECTION 125VBR-1**  
**INCLUDES THE REMOVAL OF EXISTING**  
**STRUCTURE NO. 019-0029 AND**  
**CONSTRUCTION OF THE NEW**  
**STRUCTURE NO. 019-0047, A THREE SPAN COMPOSITE STEEL**  
**BEAM BRIDGE OVER THE IOWA CHICAGO AND EASTERN**  
**RAILROAD AT STA. 144 + 14.40, 163'-6 1/2" BK TO BK OF ABUTMENT.**

END PROJECT  
STA. 146 + 75

NET LENGTH OF SECTION 475 FEET (0.090 miles)  
 GROSS LENGTH OF SECTION 475 FEET (0.090 miles)

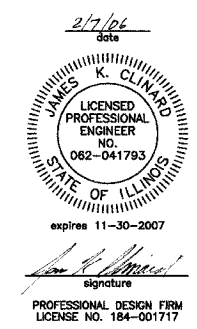
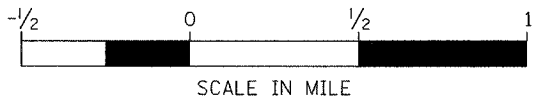

**CHAMLIN & ASSOCIATES**  
 PERU ILLINOIS MORRIS

STATE OF ILLINOIS  
 DEPARTMENT OF TRANSPORTATION  
 DIVISION OF HIGHWAYS

SUBMITTED FEB 9 20 06

*Gregory L. Monte*  
 DEPUTY DIRECTOR OF HIGHWAYS, REGION ENGINEER

March 24 20 06  
*Mike Hine*  
 ENGINEER OF DESIGN AND ENVIRONMENT

March 24 20 06  
*Milton R. See P.E.*  
 DIRECTOR OF HIGHWAYS, CHIEF ENGINEER

**DISTRICT 2 DIXON IL.**  
**PRINTED BY THE AUTHORITY**  
**OF THE STATE OF ILLINOIS**