

F.A.I. RTE.	SECTION	COUNTY	TOTAL SHEETS	SHEET NO.
55	D-3 BRIDGE PAINTING 2006-1	LIVINGSTON & GRUNDY	12	7
ILLINOIS			STATE AID PROJECT	

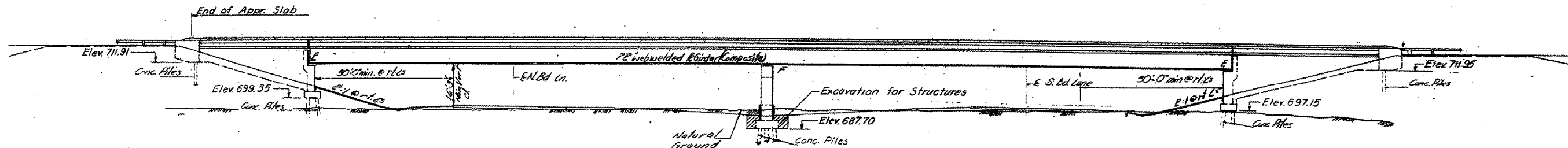

ELEVATION

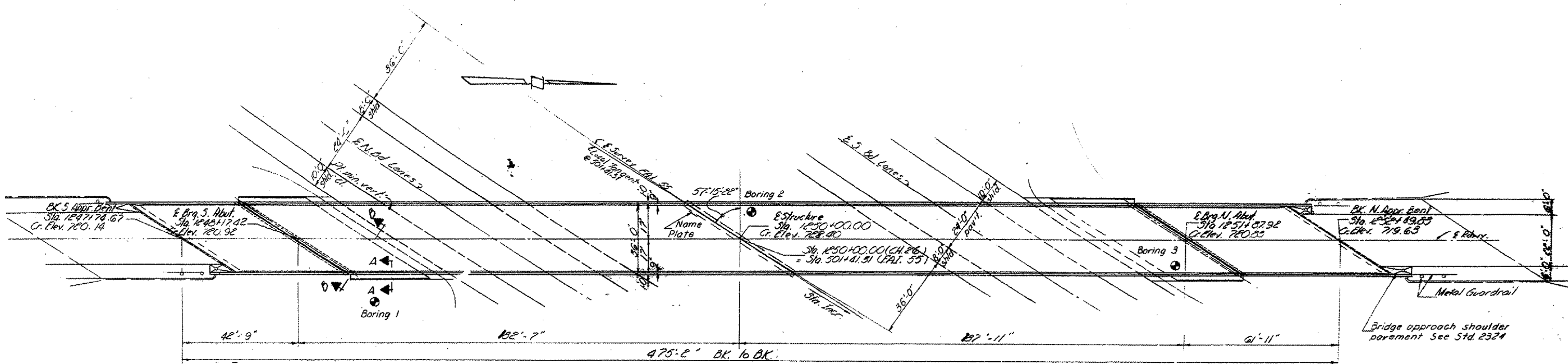

PLAN

GENERAL PLAN & ELEVATION

CH. 26 OVER FAI. RT. 55

LIVINGSTON COUNTY
STATION 3011+41.31 FAI. RT. 55

REVISIONS	
NAME	DATE

ILLINOIS DEPARTMENT OF TRANSPORTATION
**EXISTING STRUCTURE PLANS
FOR INFORMATION ONLY**
BRIDGE NO. 1
S.N. 053-0119

SCALE: VERT. DRAWN BY RW
 HORIZ. CHECKED BY
DATE 01/19/06

Date: 01/19/06
File: c:\projects\brf\gepain\06\2006-1\details.dgn