

SEC 36, T 8 N, R 6 W, 3RD PM

F.A.S. RTE.	SECTION	COUNTY	TOTAL SHEETS	SHEET NO.
1766	RS, R	*	302	67
STA. 1005+00 TO STA. 1034+00				
FED. ROAD DIST. NO.			ILLINOIS FED. AID PROJECT	

MACOUPIN & MONTGOMERY COUNTIES

CONTRACT NO. 72526

CONNECT EXISTING CULVERT TO PROPOSED MANHOLE

PLAN	SURVEYED	BY	DATE
	PLOTTED		
	CHECKED		
	BY		
	NO. OF WAY CHECKED		
	CADD FILE NAME		

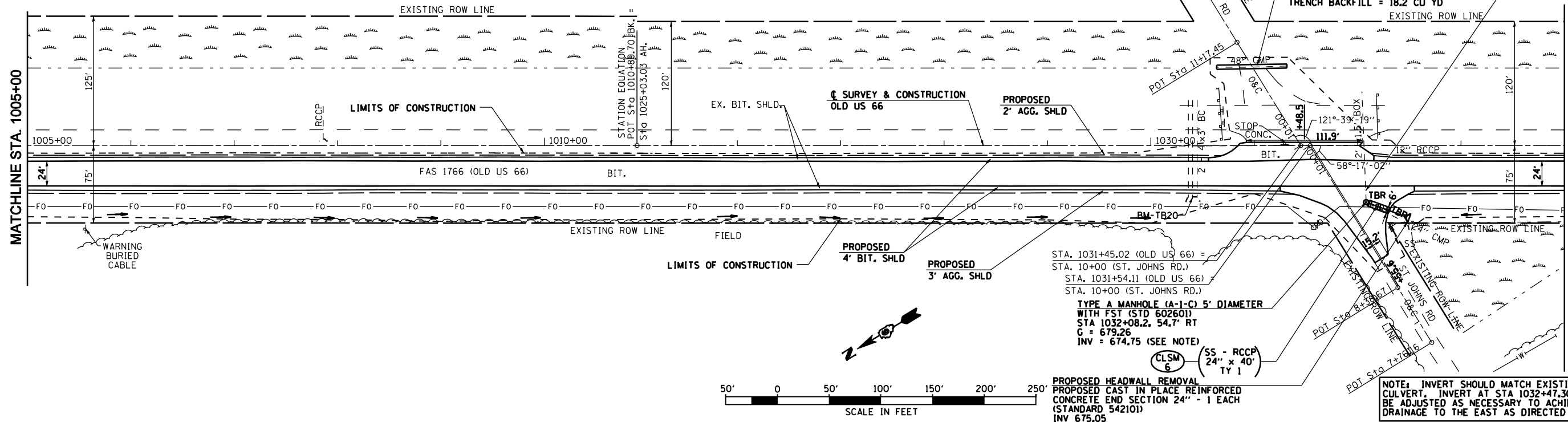

STA. 1031+45.02 (OLD US 66) =
 STA. 10+00 (ST. JOHNS RD.)
 STA. 1031+54.11 (OLD US 66)
 STA. 10+00 (ST. JOHNS RD.)

TYPE A MANHOLE (A-1-C) 5' DIAMETER
 WITH FST (STD 602601)
 STA 1032+08.2, 54.7' RT
 G = 679.26
 INV = 674.75 (SEE NOTE)

PROPOSED HEADWALL REMOVAL
 PROPOSED CAST IN PLACE REINFORCED
 CONCRETE END SECTION 24" - 1 EACH
 (STANDARD 542101)
 INV 675.05

NOTE: INVERT SHOULD MATCH EXISTING 2' x 1.5' BOX CULVERT. INVERT AT STA 1032+47.30 69.21' RT SHALL BE ADJUSTED AS NECESSARY TO ACHIEVE POSITIVE DRAINAGE TO THE EAST AS DIRECTED BY THE ENGINEER.

PROFILE	SURVEYED	BY	DATE
	PLOTTED		
	CHECKED		
	BY		
	NO. OF WAY CHECKED		
	STRUCTURE NOTATIONS CHRD		

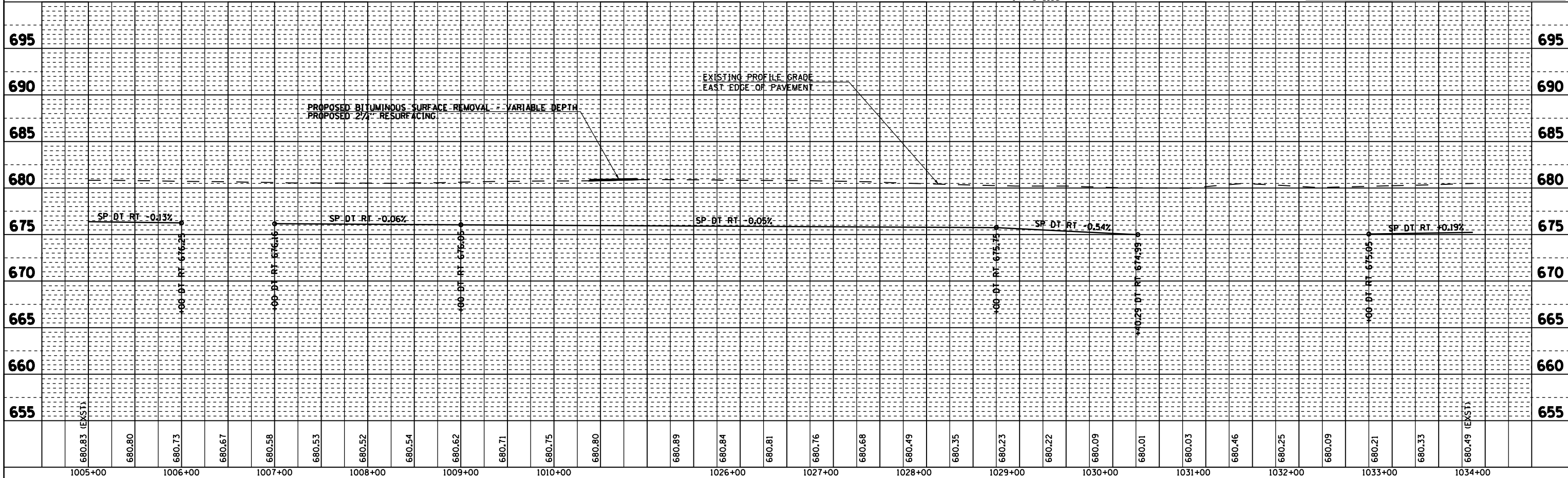

DGN-SPEC
 DATE-TIME
 *REF01