

F.A.S. RTE. 1766	SECTION RS, R	COUNTY •	TOTAL SHEETS 302	SHEET NO. 75
STA. 1139+00		TO STA. 1154+00		
FED. ROAD DIST. NO.		ILLINOIS FED. AID PROJECT		
• MACOUPIN & MONTGOMERY COUNTIES				

CONTRACT NO. 72526

SEC 3, T 7 N, R 6 W, 3RD PM

PLAN	SURVEYED	BY	DATE
	PLOTTED		
	NOTE BOOK		
	NO. OF WAY CHECKED		
	NO.		
	DATE FILE NAME		

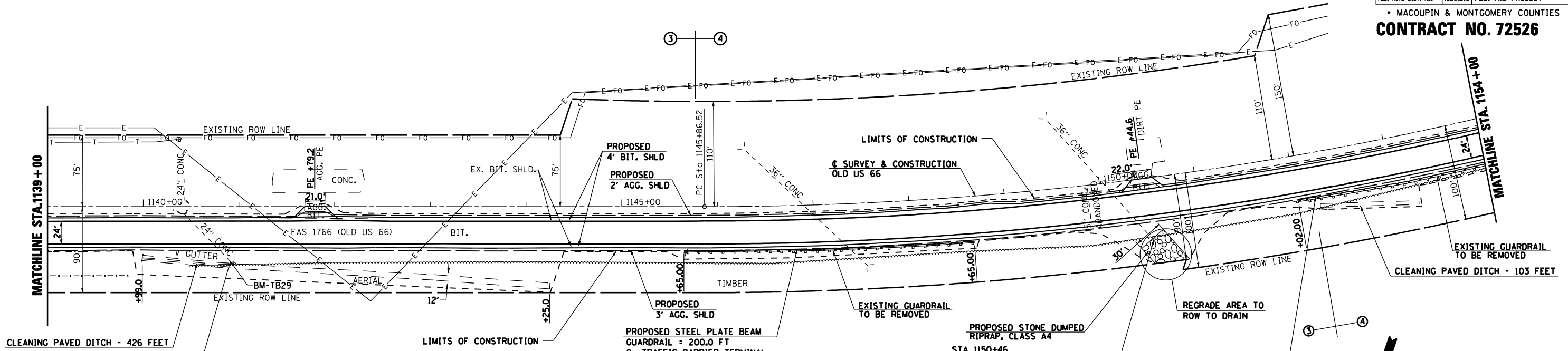

STA 1140+91.20
PROPOSED CAST IN PLACE REINFORCED
CONCRETE END SECTION 24" - 1 EACH
(STANDARD 542201)

PROPOSED STEEL PLATE BEAM
GUARDRAIL = 200.0 FT
2- TRAFFIC BARRIER TERMINAL
TYPE 1 SPECIAL (TANGENT)
STA 1145+65.00 to STA 1148+65.00

STA 1150+46
CULVERT REPAIR, 61' RT - 1 EACH
FOR COLLAR - SEE SPECIAL DETAILS
ON SHEET 158.

PROPOSED STEEL PLATE BEAM
GUARDRAIL = 325.0 FT
2- TRAFFIC BARRIER TERMINAL
TYPE 1 SPECIAL (TANGENT)
STA 1152+02.00 to STA 1156+27.00

PROFILE	SURVEYED	BY	DATE
	PLOTTED		
	NOTE BOOK		
	NO. OF WAY CHECKED		
	NO.		
	DATE FILE NAME		

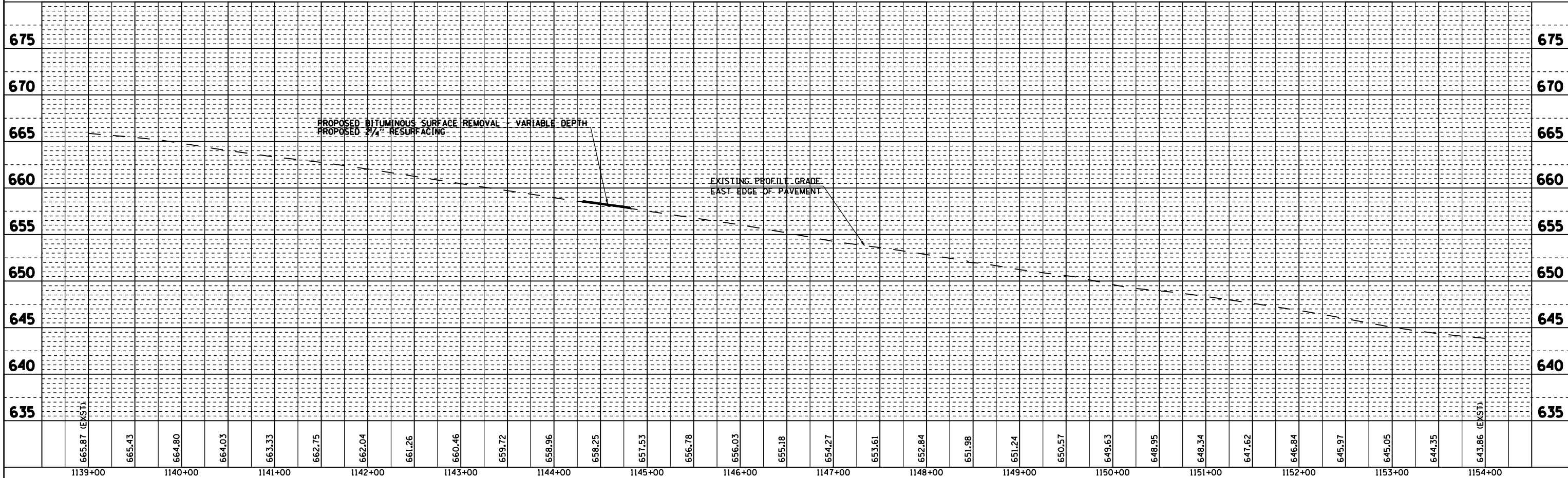

DGN-SPEC
DATE-TIME
*REF01