

FAS RTE.	SECTION	COUNTY	TOTAL SHEETS	SHEET NO.
1766	RS, R		302	94
STA. 110+00		TO STA. 125+00		
FED. ROAD DIST. NO.		ILLINOIS FED. AID PROJECT		
• MACOUPIN & MONTGOMERY COUNTIES				

SEC 3, T 7 N, R 6 W, 3RD PM

NOTES: FOR FLASHING BEACON DETAILS REFER TO FLASHING BEACON PLANS ON SHEETS 145-146.
SEE SHEET 156 FOR DETAILS OF SIDEROAD AT STA 112+90.40 LT (IL 138).

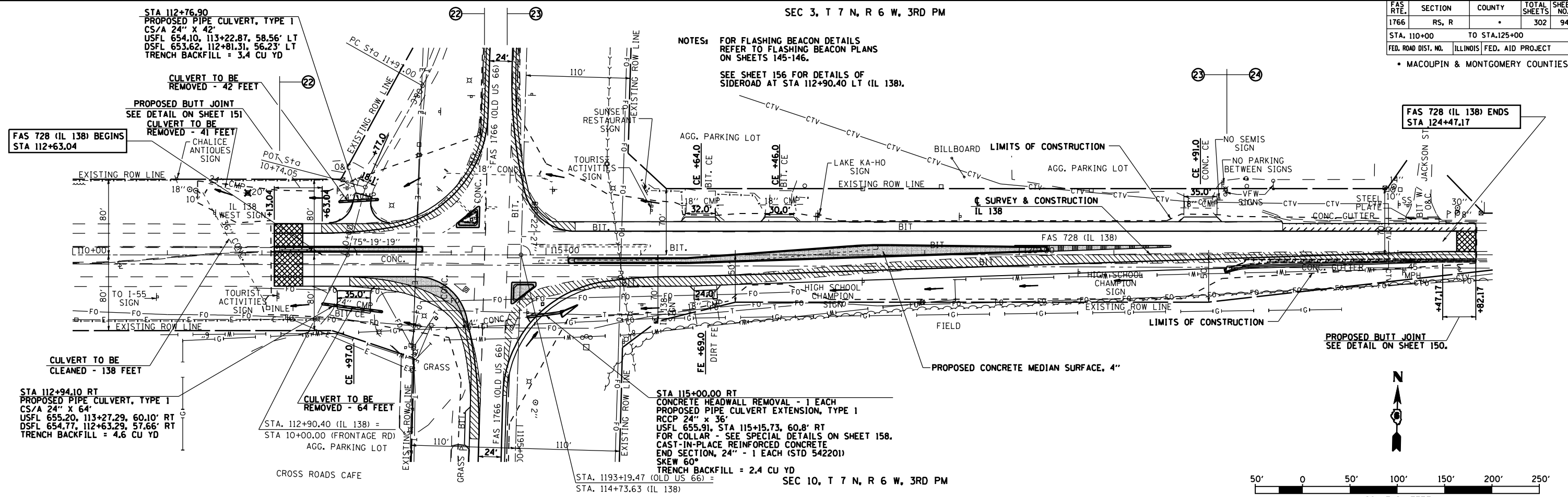

PLAN	DATE
SURVEYED	
PLOTTED	
CHECKED	
BY	
NO.	

PROFILE	DATE
SURVEYED	
PLOTTED	
CHECKED	
BY	
NO.	

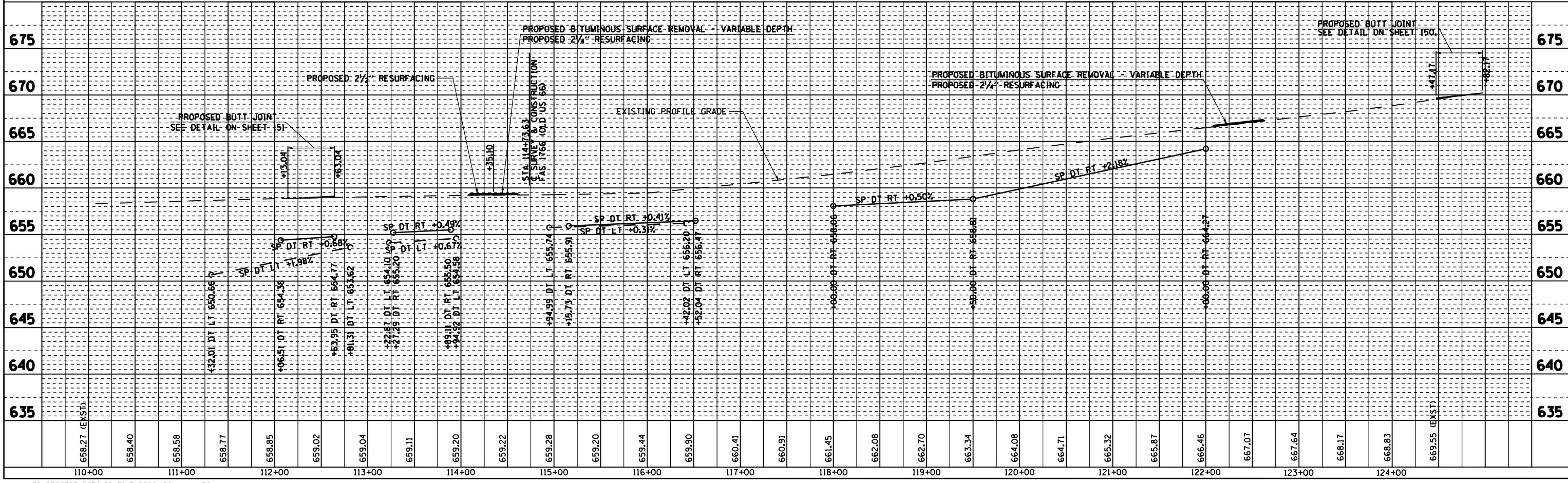
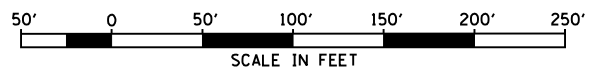

DGN-SPEC
DATE-TIME
*REF01