

SEC 21, T 7 N, R 6 W, 3RD PM

S.B.I. RTE.	SECTION	COUNTY	TOTAL SHEETS	SHEET NO.
16	RS,R		302	115
STA. 40+00		TO STA. 55+00		
FED. ROAD DIST. NO.		ILLINOIS FED. AID PROJECT		
• MACOUPIN & MONTGOMERY COUNTIES				
<b>CONTRACT NO. 72526</b>				

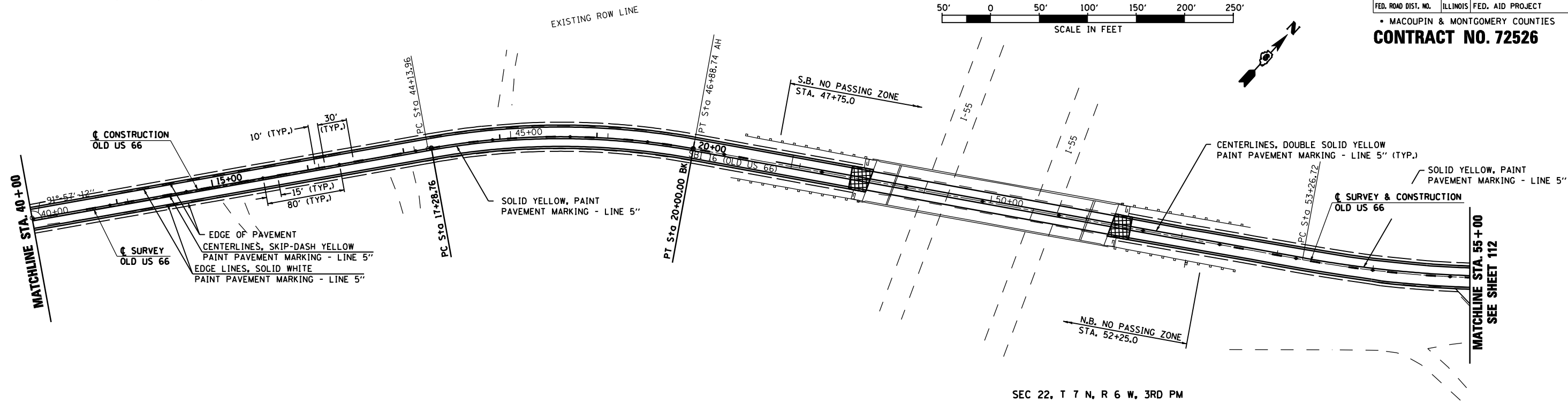
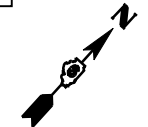
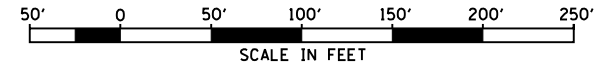

SEC 22, T 7 N, R 6 W, 3RD PM

SEC 3, T 7 N, R 6 W, 3RD PM

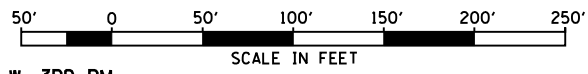
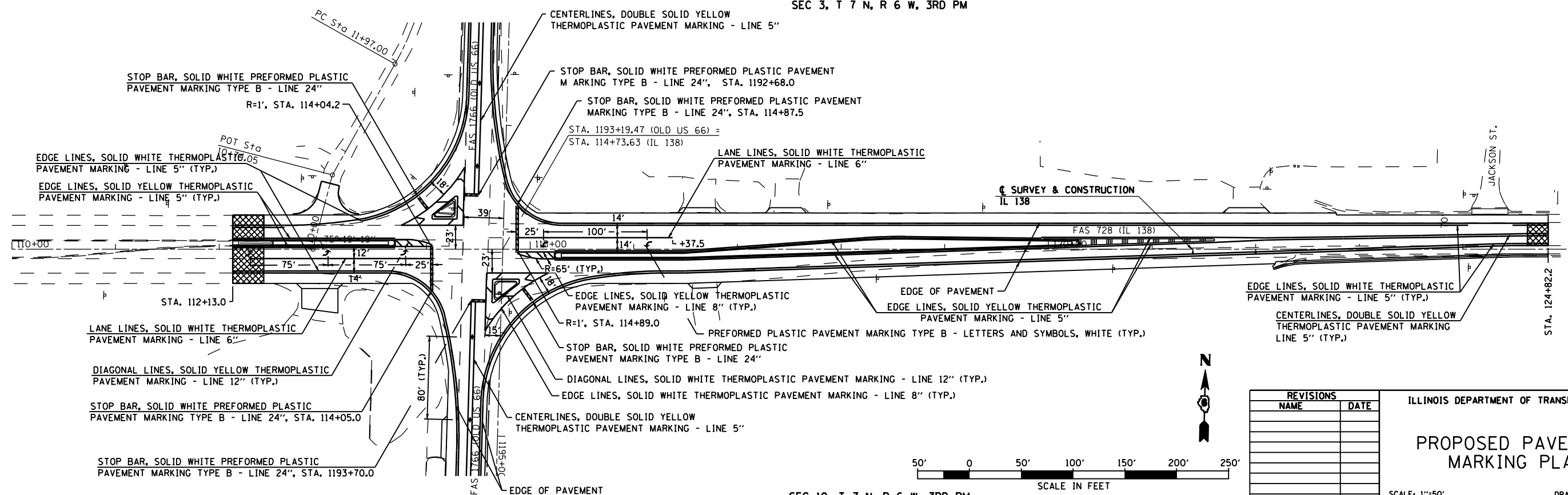

REVISIONS	
NAME	DATE

ILLINOIS DEPARTMENT OF TRANSPORTATION

**PROPOSED PAVEMENT MARKING PLAN**

SCALE: 1"=50'  
DATE: 2/8/2006

DRAWN BY: SGL  
CHECKED BY: JH

SEC 10, T 7 N, R 6 W, 3RD PM