

SEC 3, T 7 N, R 6 W, 3RD PM

F.A.S. RTE.	SECTION	COUNTY	TOTAL SHEETS	SHEET NO.
1766	RS,R	.	302	130
STA. 1139+00		TO STA. 1169+00		
FED. ROAD DIST. NO.	ILLINOIS	FED. AID PROJECT		
• MACOUPIN & MONTGOMERY COUNTIES				
CONTRACT NO. 72526				

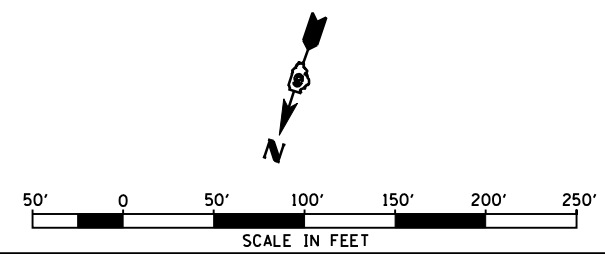
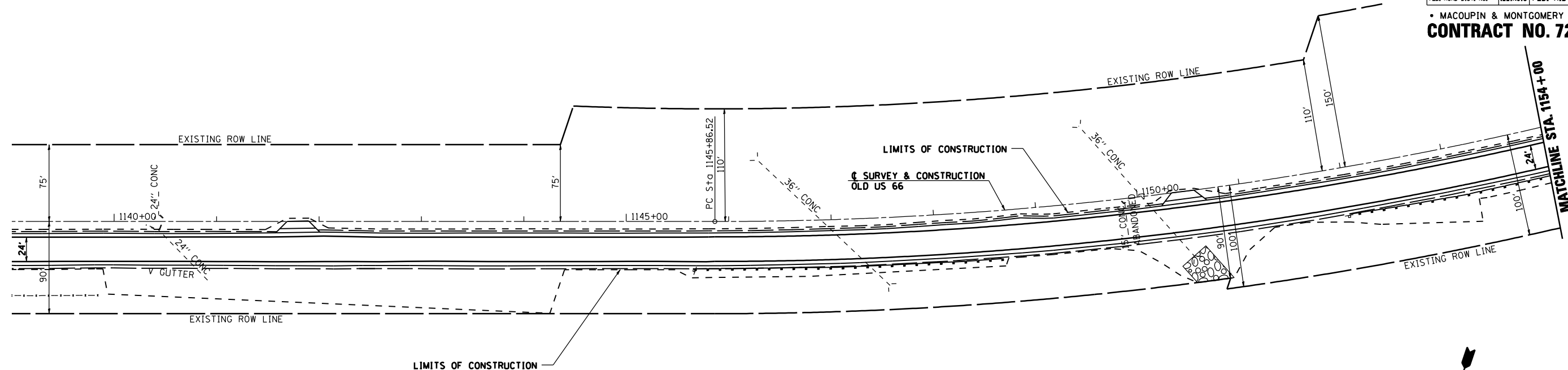

SEC 3, T 7 N, R 6 W, 3RD PM

EXIST. CURVE 224
 PI STA. = 1171+44.82
 $\Delta = 71^\circ 05' 53''$ (LT)
 $D = 1^\circ 36' 01''$
 $R = 3,580.11'$
 $T = 2,558.30'$
 $L = 4,442.55'$
 $E = 820.13'$
 $e = 2.0\%$
 P.C. STA. = 1145+86.52
 P.T. STA. = 1190+29.08
 SE ATTAINED STA 1144+33.52 to STA 1146+63.52
 SE REMOVED STA 1189+52.08 to STA 1191+82.08

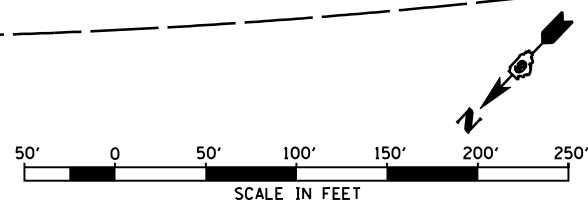
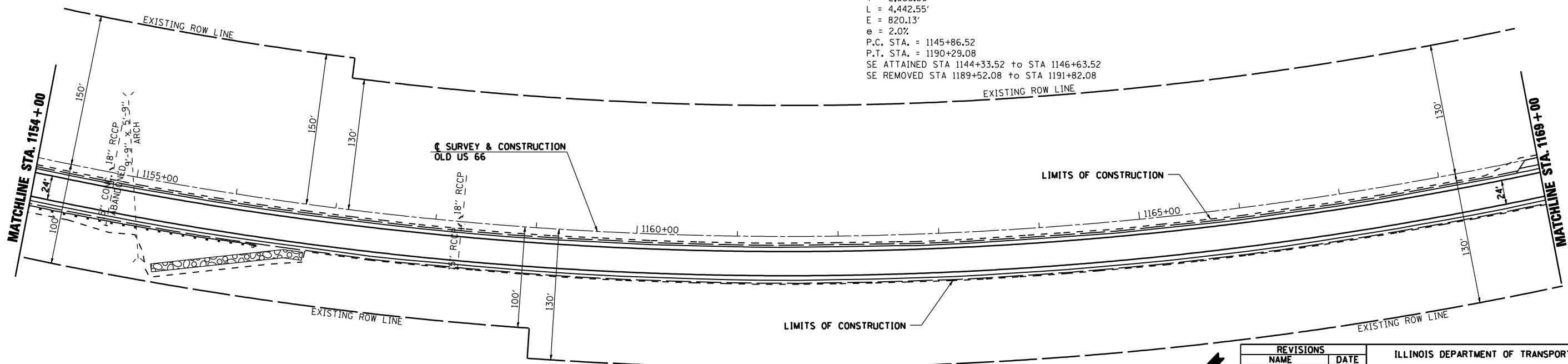

REVISIONS	
NAME	DATE

ILLINOIS DEPARTMENT OF TRANSPORTATION
STORMWATER POLLUTION PREVENTION PLAN
 SCALE: VERT. _____
 HORIZ. _____
 DATE 2/8/2006
 DRAWN BY TJD
 CHECKED BY AWM