

F.A.U. RTE.	SECTION	COUNTY	TOTAL SHEETS	SHEET NO.
8239	RS,R	MONTGOMERY	302	145
STA.		TO STA.		
FED. ROAD DIST. NO.	ILLINOIS	FED. AID PROJECT		

**CONTRACT NO. 72526**

**TRAFFIC SIGNAL QUANTITIES**

LOCATION: IL 138 & OLD US 66

QUANTITY	UNIT	ITEM
373.0	FOOT	CONDUIT IN TRENCH, 1 1/2" DIA., PVC
33.0	FOOT	CONDUIT IN TRENCH, 2" DIA., PVC
232.0	FOOT	CONDUIT, AUGERED, 1 1/2" DIA., PVC
80.0	FOOT	CONDUIT, AUGERED, 2" DIA., PVC
28.0	FOOT	CONDUIT ATTACHED TO STRUCTURE, 1 1/2" DIA., GALVANIZED STEEL
3	EACH	REMOVE EXISTING HANDHOLE
96.5	FOOT	REMOVE ELECTRIC CABLE FROM CONDUIT
1	EACH	JUNCTION BOX (SPECIAL)
2	EACH	HANDHOLE
406.0	FOOT	TRENCH AND BACKFILL FOR ELECTRICAL WORK
936.0	FOOT	ELECTRIC CABLE IN CONDUIT, SIGNAL NO. 14 2/C
2	EACH	SIGNAL HEAD, POLYCARBONATE, LED, 1-FACE, 1-SECTION, POST MOUNTED
2	EACH	REBUILD EXISTING SIGNAL HEAD FACE, 1-SECTION, LED

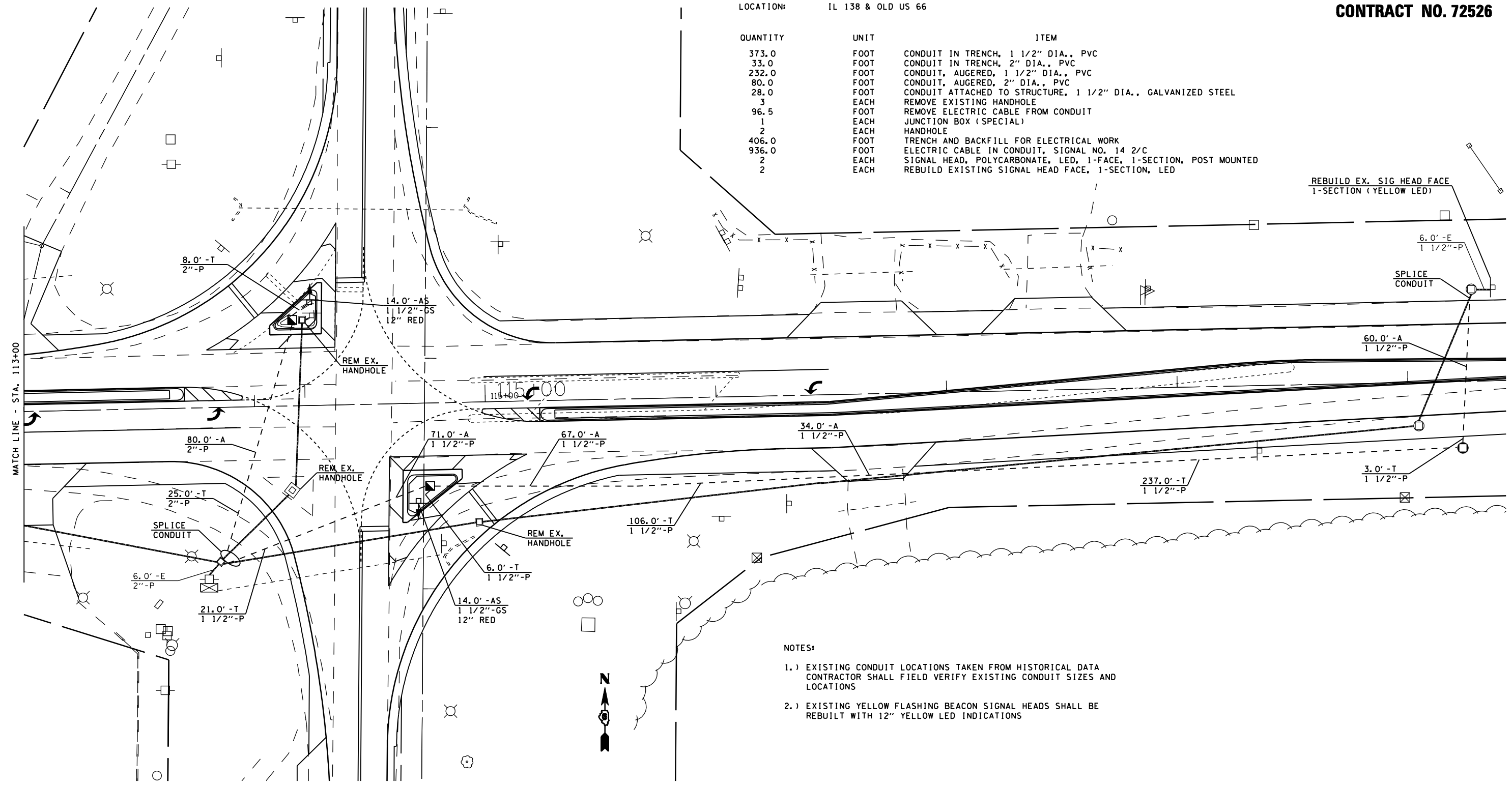

- NOTES:**
- 1.) EXISTING CONDUIT LOCATIONS TAKEN FROM HISTORICAL DATA CONTRACTOR SHALL FIELD VERIFY EXISTING CONDUIT SIZES AND LOCATIONS
  - 2.) EXISTING YELLOW FLASHING BEACON SIGNAL HEADS SHALL BE REBUILT WITH 12" YELLOW LED INDICATIONS

REVISIONS		ILLINOIS DEPARTMENT OF TRANSPORTATION
NAME	DATE	
		FLASHING BEACON PLAN SHEET IL 138 & OLD US 66
SCALE:	VERT. DEC '04	DRAWN BY KDA CHECKED BY