

| | | | | |
|--|---------|--------|--------------|-----------|
| RTE. | SECTION | COUNTY | TOTAL SHEETS | SHEET NO. |
| • | RS, R | •• | 302 | 156 |
| FED. ROAD DIST. NO. 6 ILLINOIS FED. AID PROJECT | | | | |
| ** FAU 8239, FAS 1767, FAS 1766 & SBI 16 (OLD US 66) | | | | |
| ** MONTGOMERY & MACOUPIN COUNTIES | | | | |

CONTRACT NO. 72526

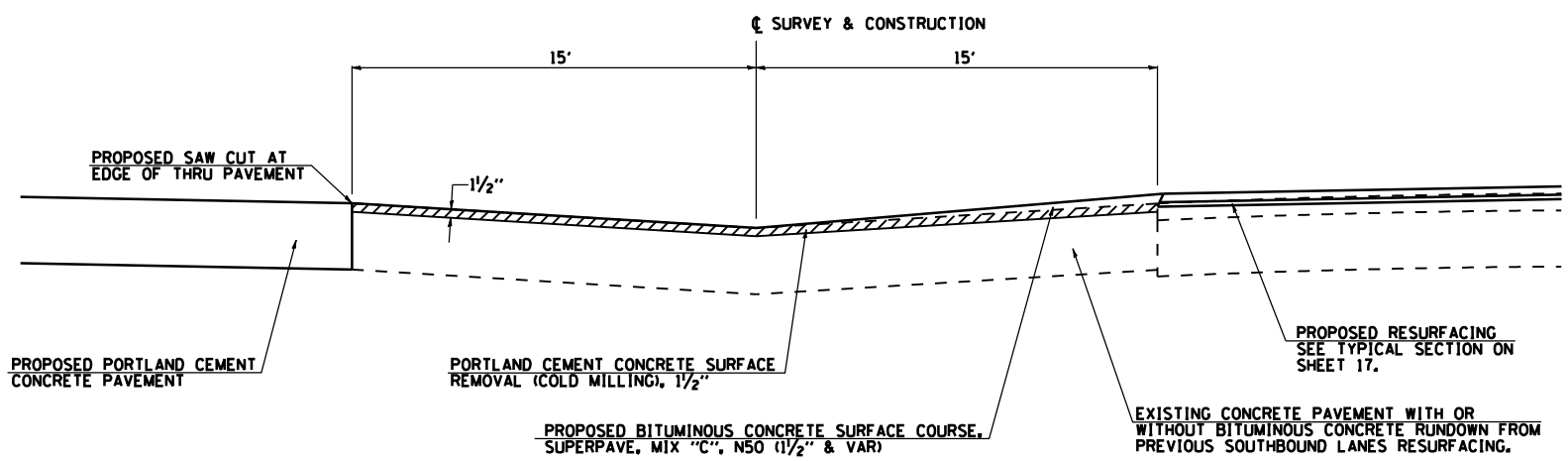

DETAIL OF CROSS-OVERS

- STA 689+52.55
- STA 699+69.44
- STA 718+43.48
- STA 729+44.90
- STA 744+85.19

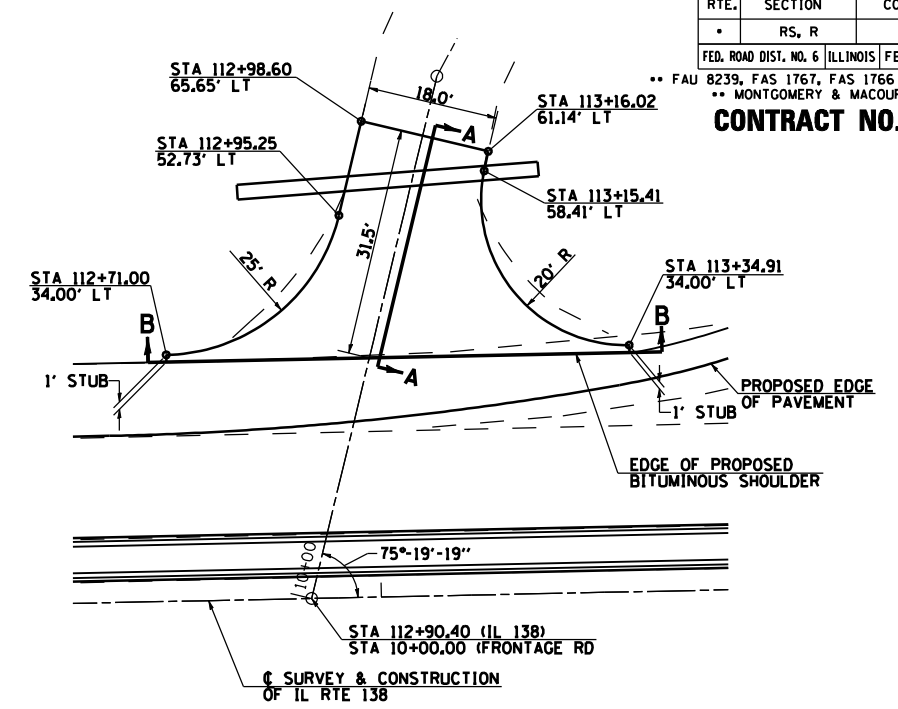

SIDEROAD DETAIL - STA 112+90.40 LT (IL 138)

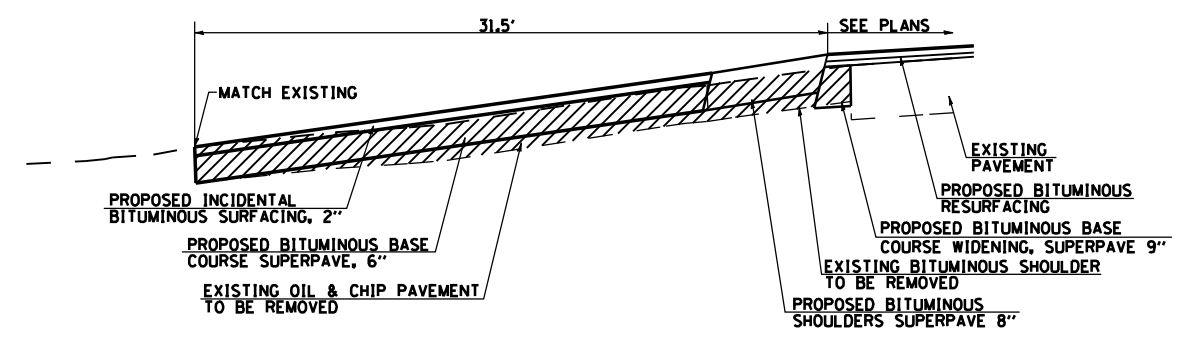

SECTION A-A

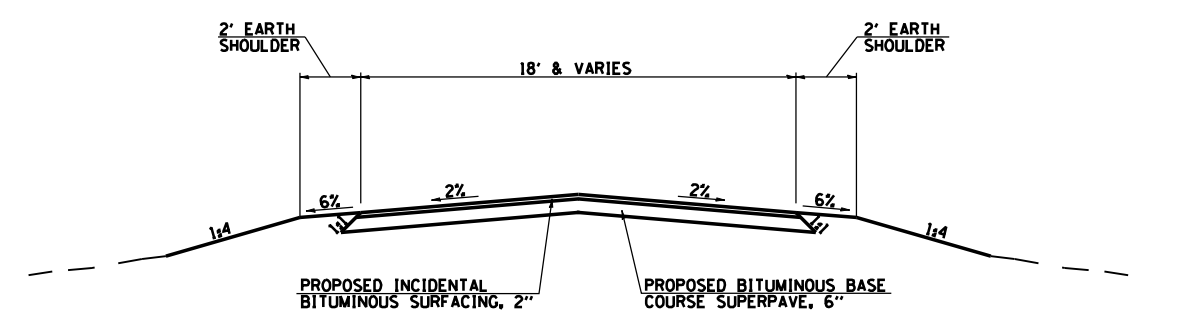

SECTION B-B

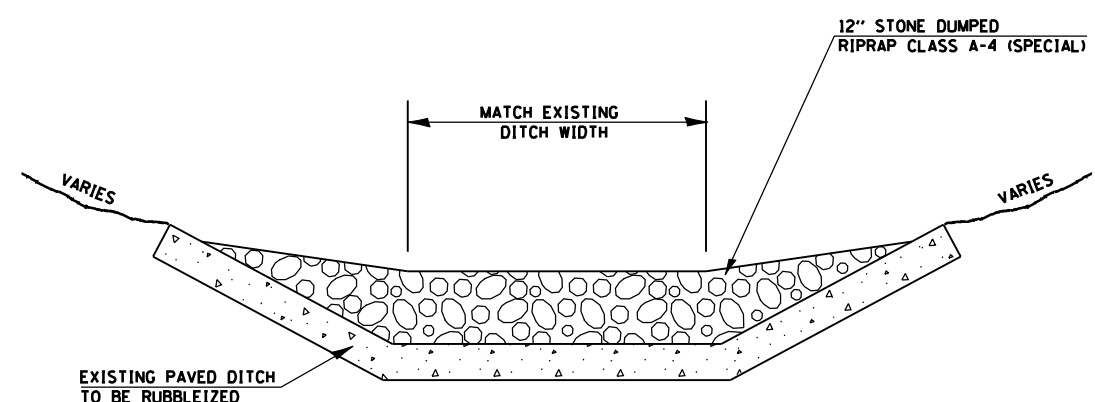

TYPICAL APPLICATION OF STONE DUMPED RIPRAP, CLASS A4 (SPECIAL)

| REVISIONS | |
|-----------|------|
| NAME | DATE |
| | |
| | |
| | |
| | |
| | |
| | |
| | |
| | |
| | |
| | |

ILLINOIS DEPARTMENT OF TRANSPORTATION
**CROSSOVER/SIDEROAD DETAIL
 RIPRAP OVER EXISTING PAVED DITCH**
 DRAWN BY TJD
 CHECKED BY AWM
 DATE 2/8/2006