

F.A.S. RTE.	SECTION	COUNTY	TOTAL SHEETS	SHEET NO.
1766	RS. R	•	302	226
STA. 1007+00		TO STA. 1010+00		
FED. ROAD DIST. NO.		ILLINOIS FED. AID PROJECT		
MACOUPIN & MONTGOMERY COUNTIES				
<b>CONTRACT NO. 72526</b>				

BY	DATE

FINAL SURVEY	SURVEYED
NOTE BOOK NO.	PLOTTED
	AREAS CHECKED

BY	DATE

ORIGINAL SURVEY	SURVEYED
NOTE BOOK NO.	PLOTTED
	AREAS CHECKED

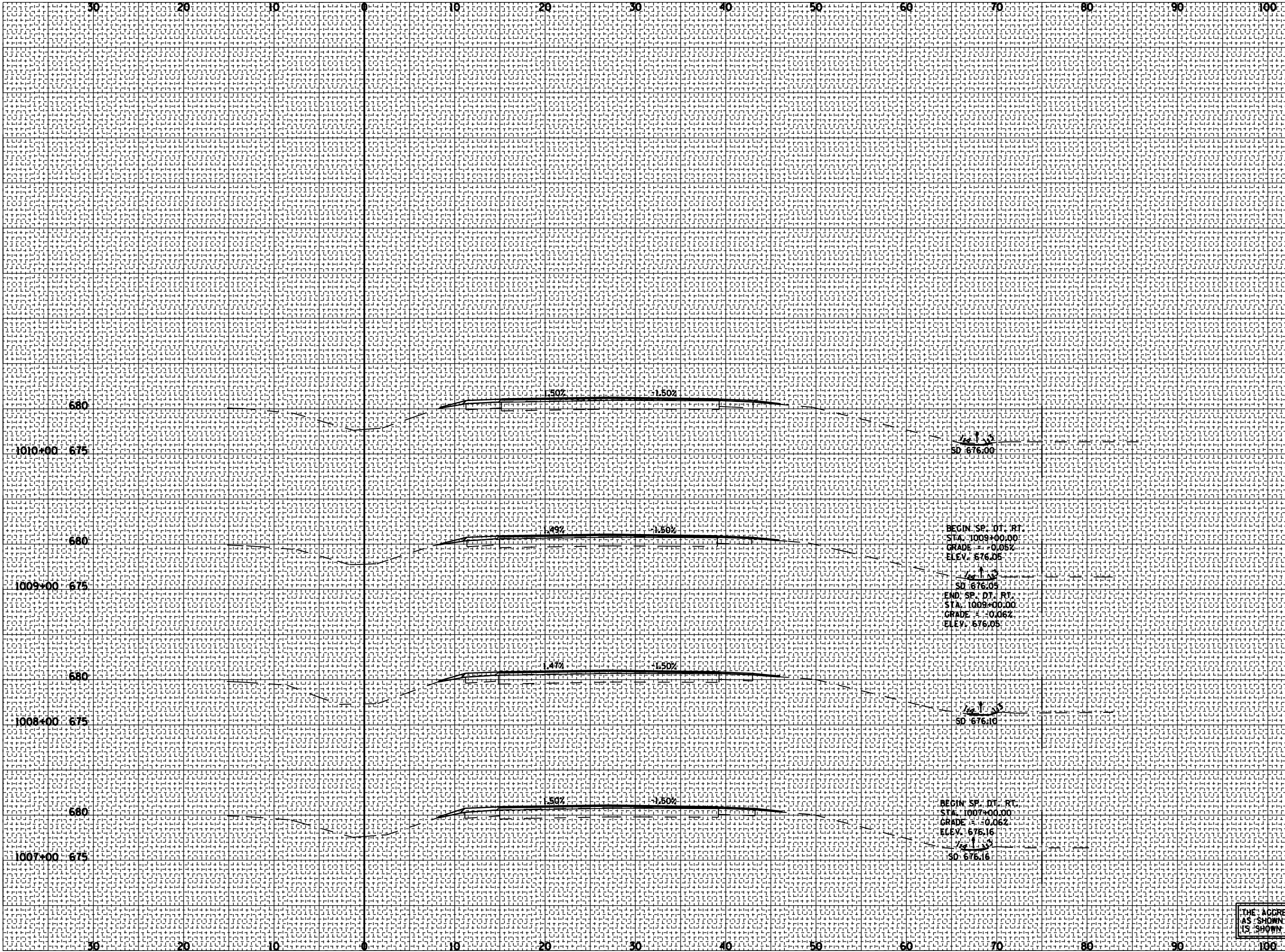

THE AGGREGATE SHOULDER ON THE LEFT SIDE SHALL BE 2' WIDE AS SHOWN IN THE TYPICAL SECTIONS RATHER THAN 3' WIDE AS IT IS SHOWN ON THIS SHEET.